



Hardware Included

1/4"-20 x 2 3/8" Binder Post
(x4) per Straight Bench
(x8) per Corner/Angle Bench

1/4"-20 x 11/16" Binder
Post & Cap
(x2) per Corner/Angle Bench

Spacer
(x4) per Straight Bench
(x8) per Corner/Angle Bench

1/4" Flat washer
(x4) per Straight Bench
(x10) per Corner/Angle Bench



Pact Bench Divider Assembly Instructions

Straight Back Bench

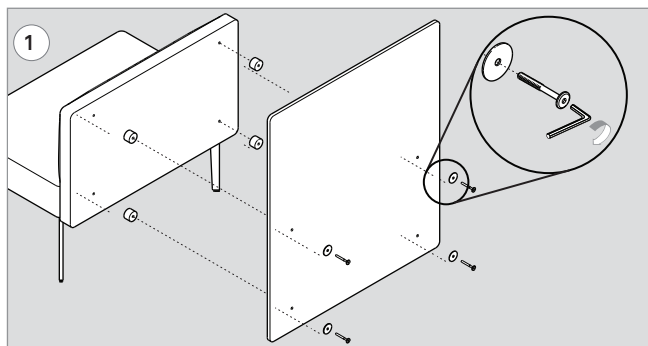

Using the 5/32" hex key, fasten divider to bench back with 1/4"-20 x 2 3/8" binder post (x4), spacer (x4) and 1/4" Flatwasher (x4).

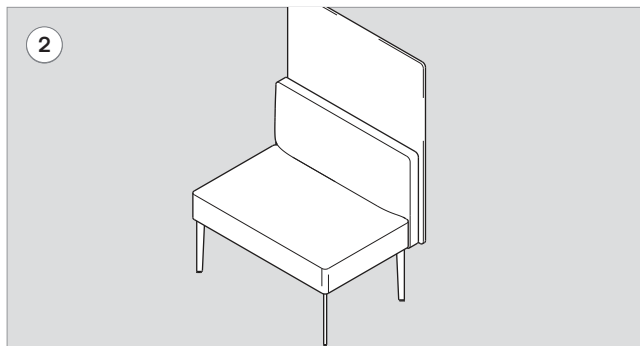

Place the assembled bench into its final position.

Corner/Angle Back Bench

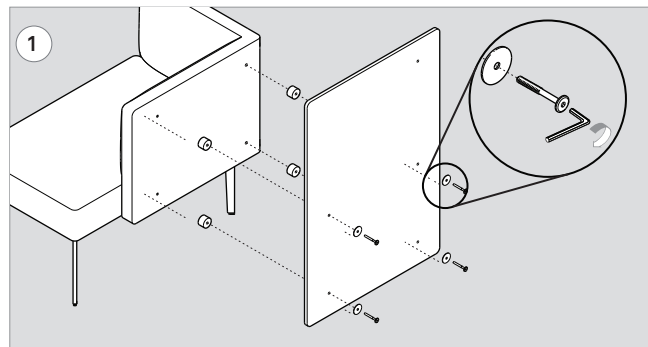

Using the 5/32" hex key, fasten divider to bench back with 1/4"-20 x 2 3/8" binder post (x4), spacer (x4) and 1/4" Flatwasher (x4).

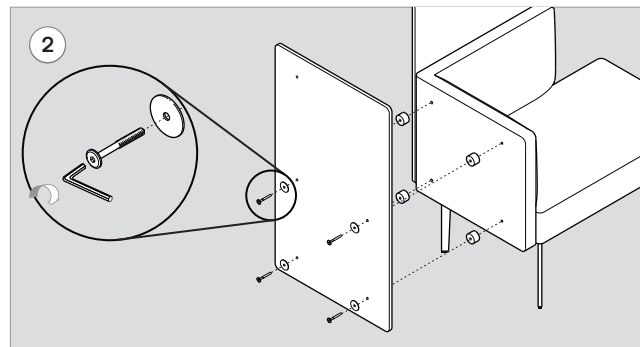

Using the 5/32" hex key, fasten divider to bench arm with 1/4"-20 x 2 3/8" binder post (x4), spacer (x4) and 1/4" Flatwasher (x4).

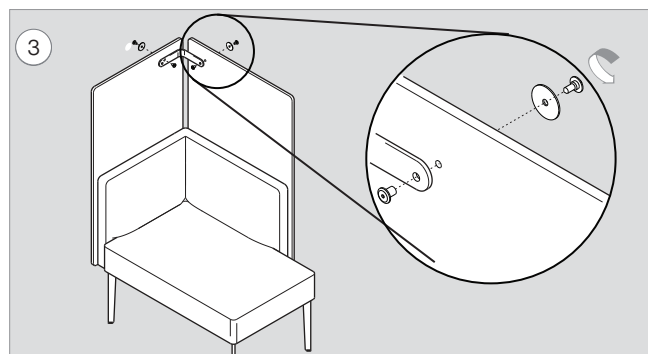

Using the 5/32" hex key, fasten bracket (x1) to divider (x2) with 1/4"-20 x 11/16" binder post and cap (x2), and 1/4" Flatwasher (x2).

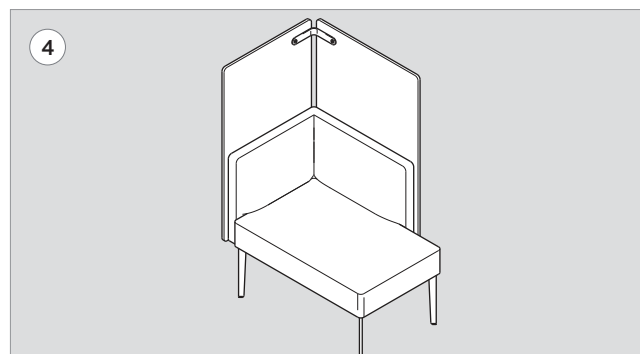

Place the assembled bench into its final position.