

# KEILHAUER

## Tool Required

5/32" Hex Allen Key

Phillips head screw driver



## Hardware Included

1/4"-20 x 2"  
Flat head cap screw  
(x8)

#6-32 x 3/4"  
Rounded head screw  
(x8)

1/4"-20 x 5/8"  
Button head cap screw  
(x6)

Glide  
(x4)



## Forsi Table Assembly Instructions

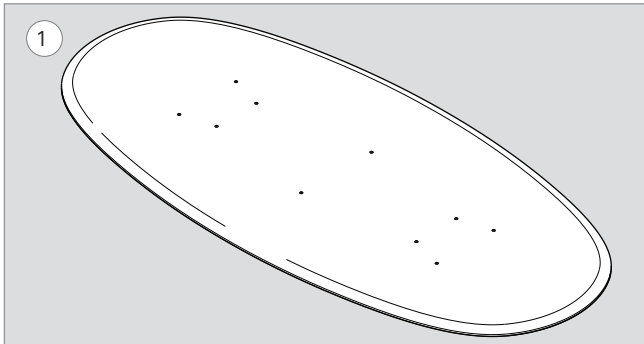

Place the table top upside down on a blanket.

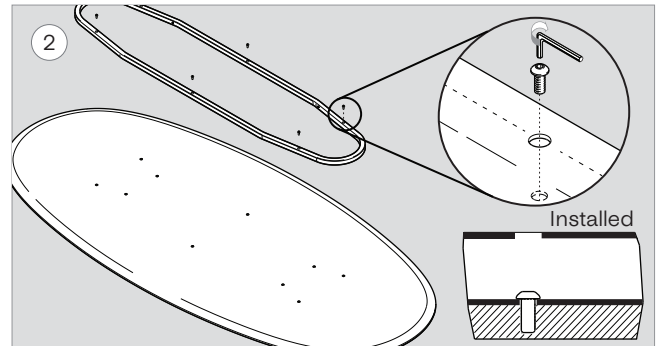

Using the 5/32" hex key, fasten the steel frame with 1/4"-20 x 5/8" button head cap screw (x6).

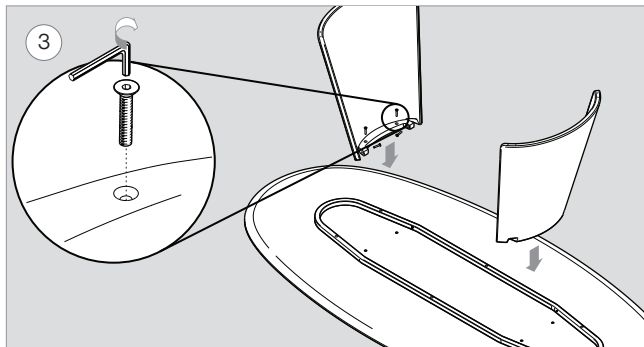

Install the table leg (x2) onto the table top and the steel frame at the four mount locations. Using the 5/32" hex key fasten with 1/4"-20 x 2" flat head cap screw (x8).

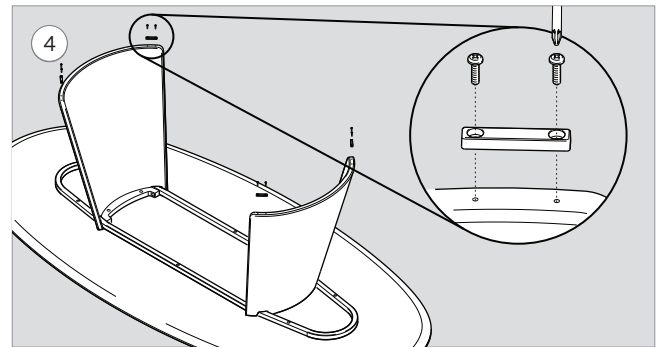

Using the Phillips head screw driver, install the glide (x4) using #6-32 x 3/4" rounded head screw (x8).

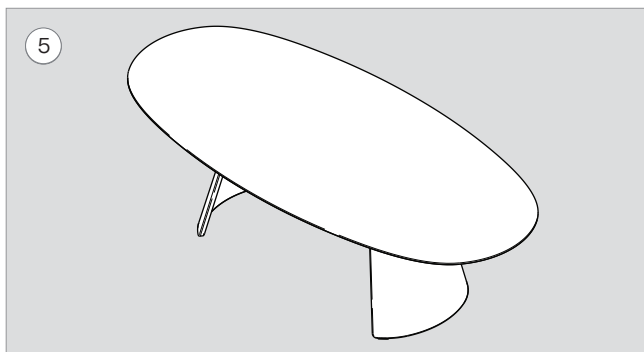

Place assembled table in its final position.

## Tool Required

Phillips head screw driver



## Hardware Included

#8-15 x 1/2"  
Quad head wood screw  
(x1)



Power Unit  
(x1)



Cable Clamp  
(x1)



Cable Mangement  
Track  
(x1)



## Forsi Power Table Assembly Instructions

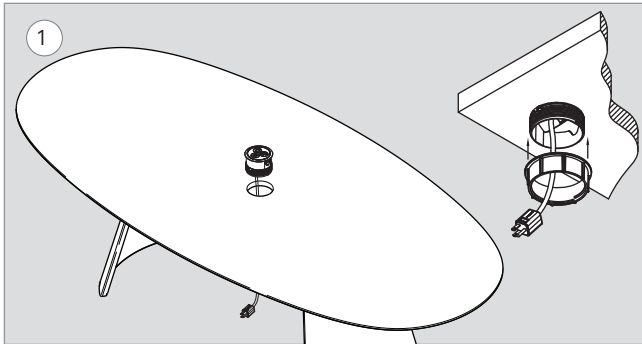

Install the power unit (x1) through the hole cut out of the table top. See supplied power unit installation instructions.

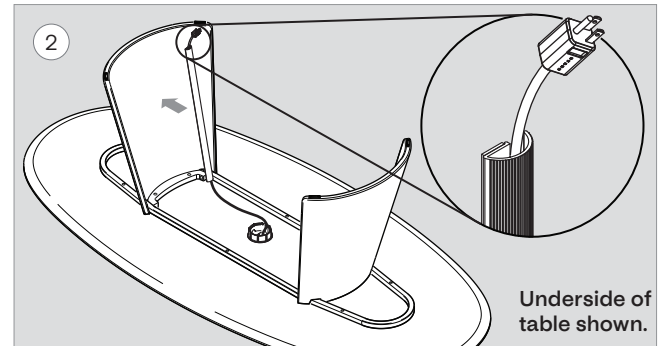

Remove the adhesive backing from the cable management track (x1) and press onto the center inside table leg. Feed the power cable into the cable management track.

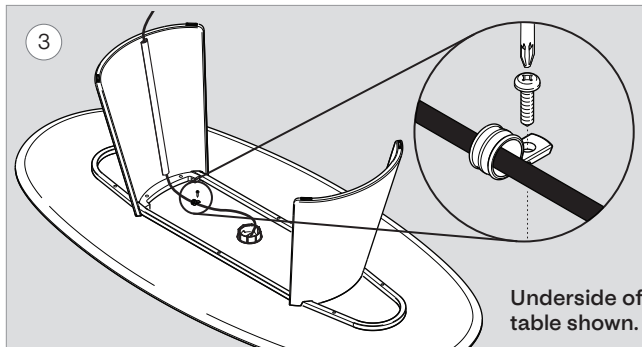

Using the Phillips head screw driver install the cable clamp (x1) with the #8-15 X 1/2" quad head wood screw.

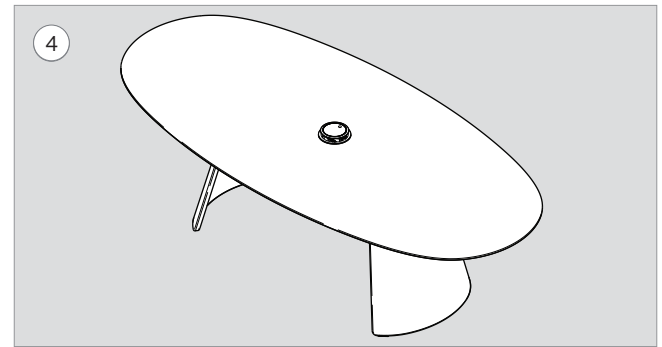

Place the assembled table in it's final position.