

## Architec Wall Mounted Sink # 0448450000

| < 25 " > |

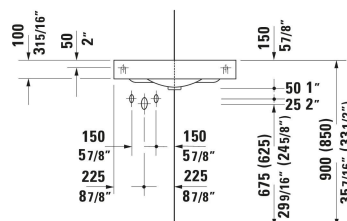
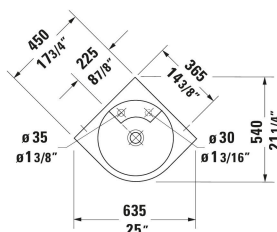

Wall Mounted Sink	Dimension	Weight	Order number
Quarter circle, Includes faucet deck: Yes, Number of faucet holes: 1, Overflow: No, Underside glazed, Back side glazed: No, 25 ", cUPC listed: Yes			
<b>Colors</b>			
00 White			
<b>Variant</b>			
<ul style="list-style-type: none"> <li>● White High Gloss, Semi-circular, Number of basins: 1 Middle, Number of faucet holes: 1 Middle, Soap dispenser position: Right</li> </ul>	25 "x5 7/8 "	26.455 lb	0448450000
<b>Infobox</b>			
Pop-up waste cannot be used			
<b>Spare parts</b>			
Sink Drain Sink, Material drain covers: Brass, Diameter: 2 7/8 " Ø 2 7/8 "		0.661 lb	005024

All drawings contain the necessary measurements which are subject to standard tolerances. They are stated in inch & mm and are non-binding. Exact measurements, in particular for customized installation scenarios, can only be taken from the finished ceramic piece.