

# ME by Starck Wall Mounted Sink # 233555..00 / 233555..30 / 233555..00 / 233555..30

| < 21 5/8 " > |

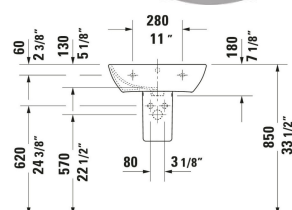
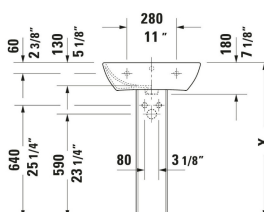
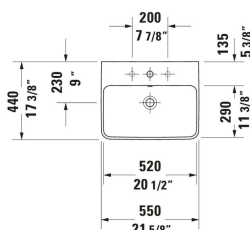

Wall Mounted Sink	Dimension	Weight	Order number
Rectangular, Includes faucet deck: Yes, Overflow: Yes, Underside glazed, Back side glazed: No, 21 5/8 "			
<b>Colors</b>			
00 White 32 White Satin Matte			
<b>Variant</b>			
● White High Gloss, Number of basins: 1 Middle, Number of faucet holes: 1 Middle, cUPC listed: No	21 5/8 "x7 1/8 "	34.172 lb	233555..00
●●● White High Gloss, Number of basins: 1 Middle, Number of faucet holes: 3 Left, Middle, Right, Soap dispenser position: Left, cUPC listed: No	21 5/8 "x7 1/8 "	34.172 lb	233555..30
● White Satin Matte, Number of basins: 1 Middle, Number of faucet holes: 1 Middle, cUPC listed: No	21 5/8 "x7 1/8 "	34.172 lb	233555..00
●●● White Satin Matte, Number of basins: 1 Middle, Number of faucet holes: 3 Left, Middle, Right, Soap dispenser position: Left, cUPC listed: No	21 5/8 "x7 1/8 "	34.172 lb	233555..30
<b>Suitable products</b>			
Pedestal Installation Type: Floorstanding, 6 7/8 x 8 1/4 "	6 7/8 x 8 1/4 "		085839
Sink Shroud White, Installation Type: Wall-mounted, Hardware included, 6 3/4 x 11 3/4 "	6 3/4 x 11 3/4 "		085840

All drawings contain the necessary measurements which are subject to standard tolerances. They are stated in inch & mm and are non-binding. Exact measurements, in particular for customized installation scenarios, can only be taken from the finished ceramic piece.