

## ME by Starck Urinal # 280931..92

| < 11 3/4 " > |

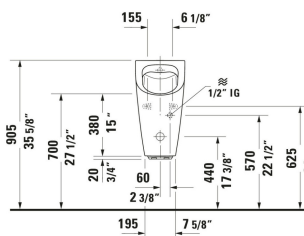
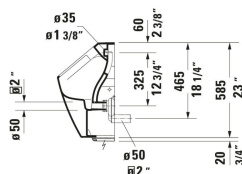
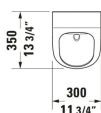

Urinal	Dimension	Weight	Order number
Electronic control: Battery operation, mains operation, Flushing rim: Rimless, Flush system: Siphonic, Flush system: Siphonic, Inlet supply position: Rear, Concealed inflow, Hardware included, Outlet: horizontal, Concealed outflow, Includes control unit, ADA: Yes, cC/IAPMO®: Yes			
<b>Colors</b>			
00 White 20 HygieneGlaze (an antibacterial ceramic glaze that provides almost indefinite effectiveness)			
<b>Variant</b>			
White High Gloss, cUPC listed: No	11 3/4 "x23 7/8 "	42.108 lb	280931..92
<b>Spare parts</b>			
Urinal Screen Material: Stainless Steel	8 x 11 "	0.198 lb	005042

All drawings contain the necessary measurements which are subject to standard tolerances. They are stated in inch & mm and are non-binding. Exact measurements, in particular for customized installation scenarios, can only be taken from the finished ceramic piece.