

Zencha Vessel Sink # 237342..79 / 237342..79 / 237342..79 / 237342..79

| < 16 1/2 " > |

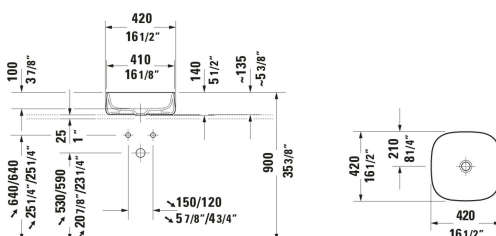

Vessel Sink	Dimension	Weight	Order number
DuraCeram®, Square, Number of basins: 1 Middle, Includes faucet deck: No, Overflow: No, Ground, Includes ceramic drain cover, Includes slotted waste, 16 1/2 "			
Colors			
00 White 13 Anthracite Matte 32 White Satin Matte 67 Grey Satin Matt			
Variant			
☒ White High Gloss	16 1/2 "x5 3/8 "	20.944 lb	237342..79
☒ Anthracite Matte	16 1/2 "x5 3/8 "	20.944 lb	237342..79
☒ White Satin Matte	16 1/2 "x5 3/8 "	20.944 lb	237342..79
☒ Gray Satin Matte	16 1/2 "x5 3/8 "	20.944 lb	237342..79
Suitable products			
Vanity Cabinet Number of drawers: 1, Includes vanity top: Yes, Faucet holes possible, Handle, Slow close, Lay-in compartment Optional, 31 1/2 x 21 5/8 "	31 1/2 x 21 5/8 "		DE4947
Vanity Cabinet Number of drawers: 1, Includes vanity top: Yes, Faucet holes possible, Handle, Slow close, Lay-in compartment Optional, 47 1/4 x 21 5/8 "	47 1/4 x 21 5/8 "		DE4949
Vanity Cabinet Number of drawers: 1, Number of drawers: 1, Includes vanity top: Yes, Faucet holes possible, Handle, Siphon cut-out: Yes, Panel: Yes, Slow close, Lay-in compartment Optional, 31 1/2 x 21 5/8 "	31 1/2 x 21 5/8 "		DE4967
Vanity Cabinet Number of drawers: 1, Number of drawers: 1, Includes vanity top: Yes, Faucet holes possible, Handle, Siphon cut-out: Yes, Panel: Yes, Slow close, Lay-in compartment Optional, 39 3/8 x 21 5/8 "	39 3/8 x 21 5/8 "		DE4968
Vanity Cabinet Number of drawers: 1, Number of drawers: 1, Includes vanity top: Yes, Faucet holes possible, Handle, Siphon cut-out: Yes, Panel: Yes, Slow close, Lay-in compartment Optional, 47 1/4 x 21 5/8 "	47 1/4 x 21 5/8 "		DE4969
Vanity Cabinet Number of drawers: 1, Number of drawers: 1, Includes vanity top: Yes, Faucet holes possible, Without handle, Slow close, Pressure inlet, Drawer organizer Optional, 51 1/8 x 21 5/8 "	51 1/8 x 21 5/8 "		ZE4818

Zencha Vessel Sink # 237342..79 / 237342..79 / 237342..79 /
237342..79

|< 16 1/2 " >|

All drawings contain the necessary measurements which are subject to standard tolerances. They are stated in inch & mm and are non-binding. Exact measurements, in particular for customized installation scenarios, can only be taken from the finished ceramic piece.