

C.1 Shower Trim # C15200013U10

|< 5 7/8 " >|



Shower Trim	Dimension	Weight	Order number
Number of outlets: 2, Water supply connection type: Rough In Valve, Thermostat cartridge, Temperature block (100.4 °F), Selection: Tub filler, Hand shower, Diverter: Shut-off and diverter valve, Number of outlets: 2, recommended operating pressure: 14.5038 - 72.519 psi, Flow rate: 5.44 gal/min, Escutcheon shape: Square, Including functional unit, Including trim parts			
Colors			
10 Chrome			
Variant			
Chrome, Flow rate: 5.42 gal/min, 5x5 7/8 ", cUPC listed: Yes	5 7/8 "x5 7/8 "	4.189 lb	C15200013U10
Required accessories			
Rough In Valve Shut-off valve: Yes	6 1/2 x 4 1/8 "	3.086 lb	GK0900001

All drawings contain the necessary measurements which are subject to standard tolerances. They are stated in inch & mm and are non-binding. Exact measurements, in particular for customized installation scenarios, can only be taken from the finished ceramic piece.

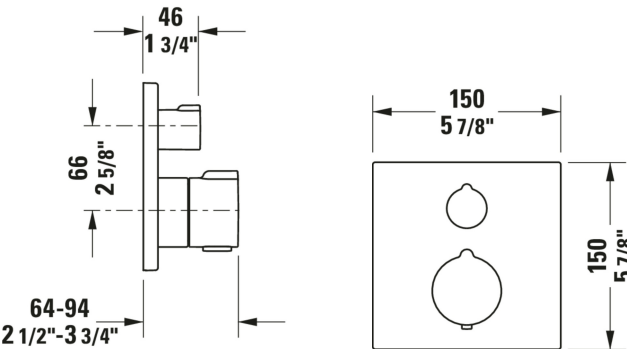

C.1 Shower Trim # C15200013U10

|< 5 7/8 " >|
