

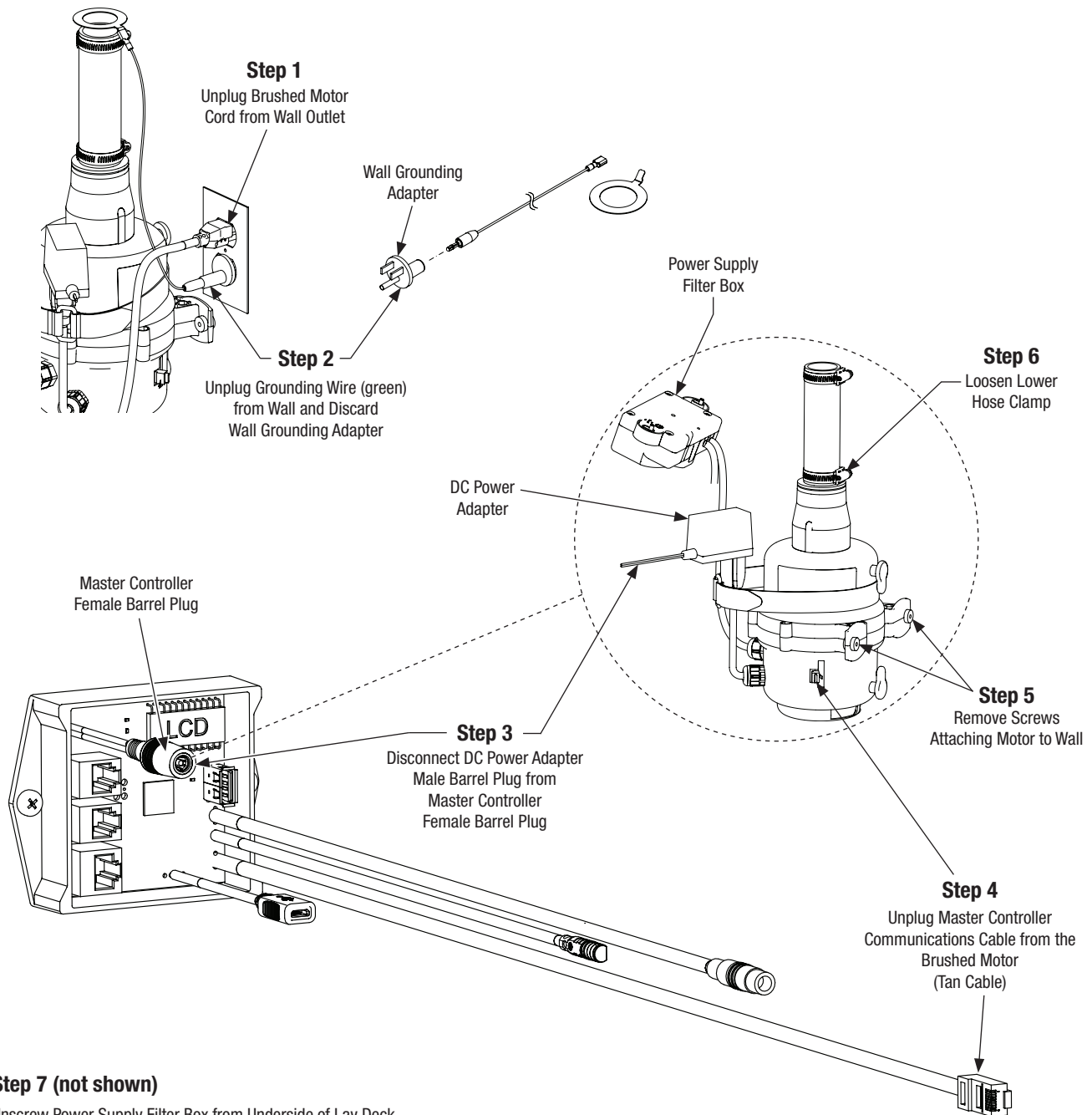

## Removing the Brushed Motor (S39-859)



### Step 7 (not shown)

Unscrew Power Supply Filter Box from Underside of Lav Deck.

### Step 8 (not shown)

Remove and Discard Brushed Motor along with DC Power Adapter



## Installing the Brushless Motor (S39-863)

### Step 1

Set Brushless Motor in place. Ensure Hose is Seated all the Over the Nozzle and Tighten Lower Hose Clamp.

### Step 5 (not shown)

Fasten Power Supply Filter Box to Underside of Lav Deck.

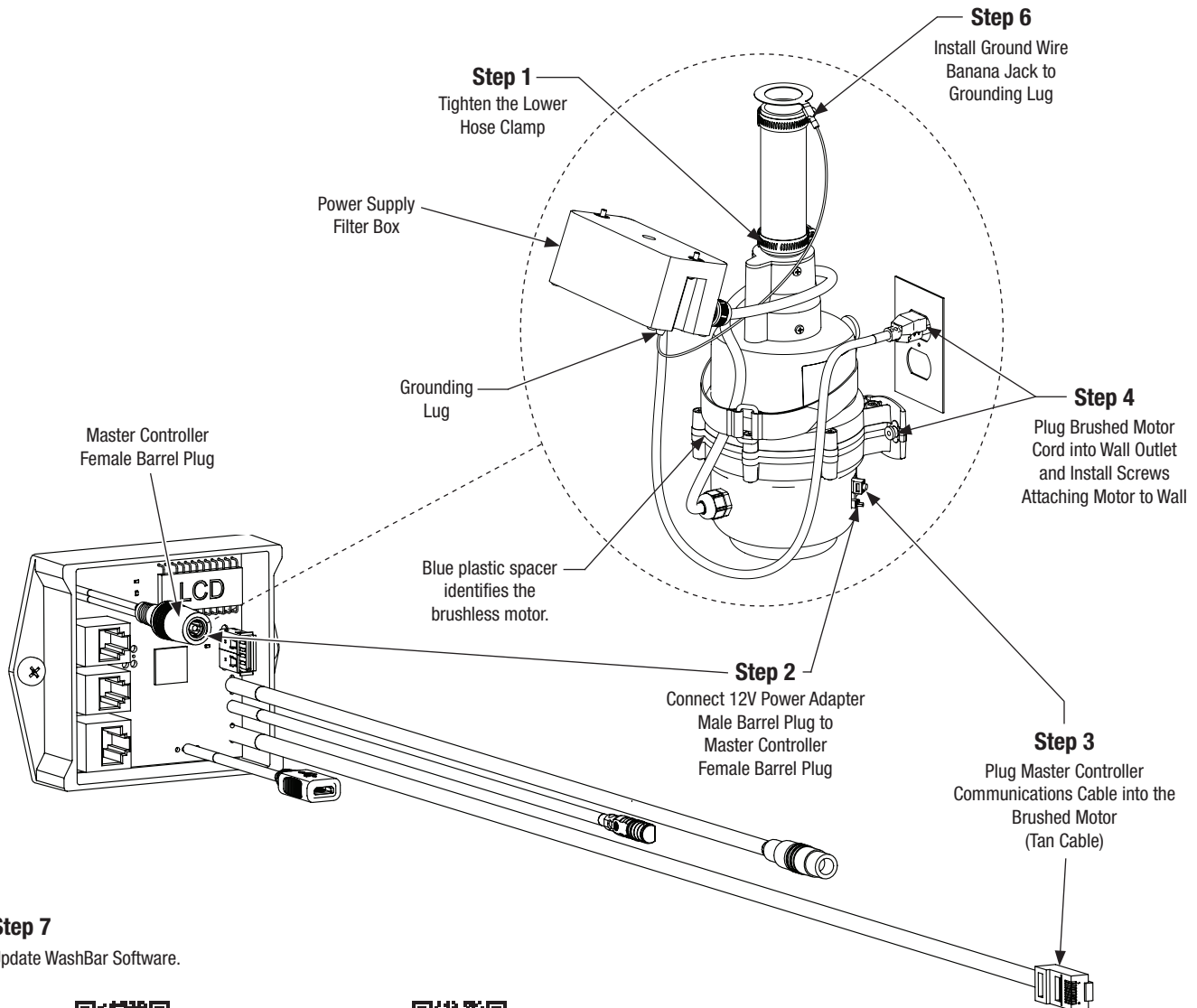

### Step 7

Update WashBar Software.



[Scan or click code to view Software Update Instructions](#)



[Scan or click code to view video of How to Update WashBar Software](#)