



A WATTS Brand

# Euro Style Privacy Sight Screens

## Phenolic LT – LOFT Series

### LOFT Series Features

- Modern minimalist design
- Flush surface construction
- Exclusive new Phenolic LT material
- Robust and durable
- Available in a range of standard and custom colors

### Construction

Solid "sandwich-type" construction 1.4" (36mm) thick with a 0.1" (3mm) solid grade face sheet laminate on both sides with a moisture-resistant, foam core. Sturdy aluminum brackets ensure the system's stability and resistance to warping. Phenolic LT materials are impact and scratch resistant. Anti-bacterial coating and non-porous surface reduce spread of germs. Panel sizes can be customized when wider than 15.7" (400mm). For accuracy, measurements should be taken to the closest millimeter. See the Support & Stabilization Spec table on page 3 for guidance.

### Sight Screens

Panels that are 24.1" (611mm) wide or larger are wall hung with a floor to ceiling post at front of panel. Posts are drilled into the floor and ceiling approximately 1.57" (40mm). Cover plates are provided to conceal screws.

Panels that are between 15.8" (401mm) and 24" (610) wide are wall hung with a continuous bracket and foot braced.

### Hardware

Screens shall be provided with all hardware and fastenings for a complete installation.

### Brackets

Continuous anodized aluminum brackets are provided for all sizes as shown.

### Feet

Feet are constructed of aluminum and match feet on the partitions.

### Product Compliance

#### Complies with

- ASTM D6578
- ASTM D2794
- ASTM E84 Class B



#### Listed by UL Environment to

- GreenGuard Gold



Verify all rough-in dimensions prior to installation.  
Consult local and national codes. Conformity and compliance to local and national codes is the responsibility of the installer.

Page 1 of 3 2/26/2024

This information is subject to change without notice.

Bradley\_Privacy-Sight-Screens\_LOFT

[View Latest Version](#)

#### Euro Style Sight Screen with Continuous Bracket and Floor to Ceiling Post

For panels that are 24.1" (611mm) or wider.

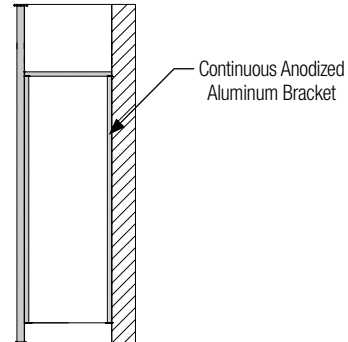

#### Wall-Hung and Foot-Braced Euro Style Sight Screen

For panels between 15.8" (401mm) and 24" (610mm) wide.

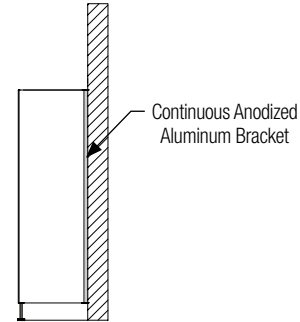

© 2024 Bradley

P.O. Box 309, Menomonee Falls, WI 53052-0309  
800 BRADLEY (800 272 3539) +1 262 251 6000  
bradleycorp.com



A WATTS Brand

# Euro Style Privacy Sight Screens

## Phenolic LT – LOFT Series

### Dimensions

(mm)

#### Top View

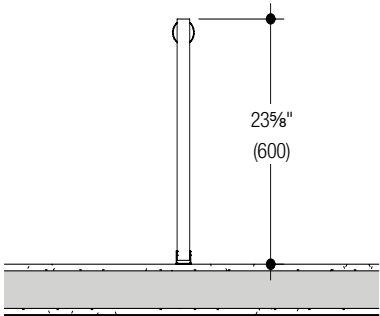

#### Front View

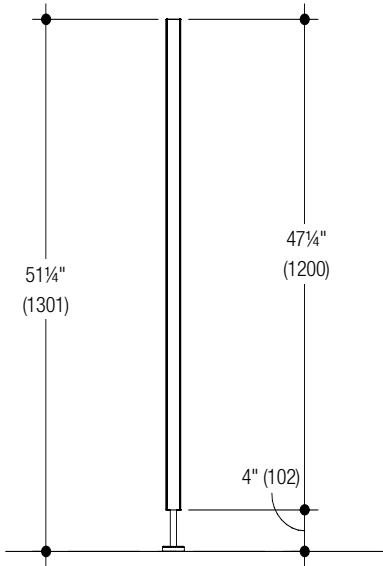

#### Side View

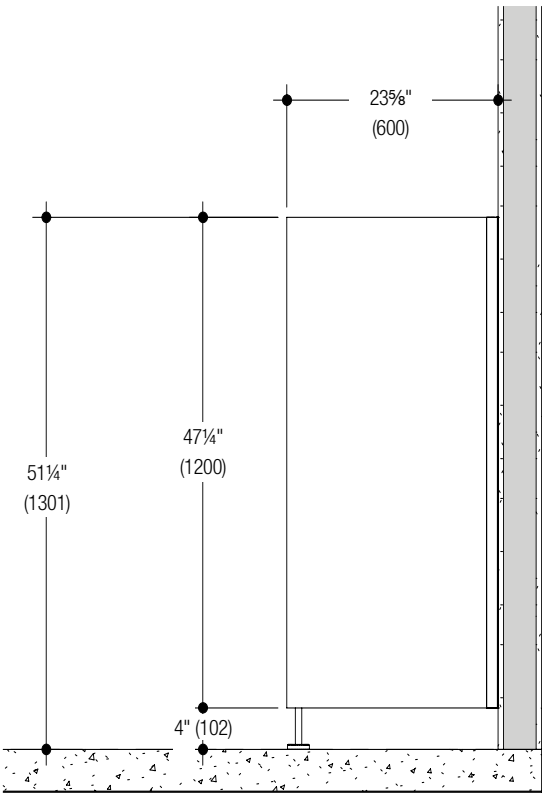

Verify all rough-in dimensions prior to installation.  
Consult local and national codes. Conformity and compliance  
to local and national codes is the responsibility of the installer.



A WATTS Brand

# Euro Style Privacy Sight Screens

## Phenolic LT – LOFT Series

### Standard Selections (select one)

#### Colors

**NOTE:** Click on any swatch to view as a larger image.

18074 - Atlantic	 Atlantic
35003 - Birch	 Birch
30013 - Dark Walnut	 Dark Walnut
12204 - Manhattan	 Manhattan
12231 - Slate Grey	 Slate Grey
70004 - Storm Cloud	 Storm Cloud
10140 - White	 White
Custom	Custom color: _____

#### Wall Brackets

Continuous Anodized Aluminum

#### Feet

Aluminum

### Support & Stabilization Specifications

Panel Width	15.8" (401mm) – 24" (610mm)	> 24.1" (611mm)
Application	Sight Screen	Sight Screen
Type of Bracket	Continuous	Continuous
Number of Brackets	1	1
1.57" (40mm) Support Post	No	Yes
Foot Brace	Yes	No
Maximum Screen Height	63" (1600mm)	108.3" (2750mm)
Maximum Support Post Height	n/a	118.1" (3000mm)
AFF	4" (101.6mm), 9" (229mm) or 12" (304.8mm)	Variable

Verify all rough-in dimensions prior to installation.  
Consult local and national codes. Conformity and compliance  
to local and national codes is the responsibility of the installer.