



A WATTS Brand

Euro Style Urinal Screens

Phenolic LT – LOFT Series

LOFT Series Features

- Modern minimalist design
- Flush surface construction
- Exclusive new Phenolic LT material
- Robust and durable
- Available in a range of standard and custom colors

Construction

Solid "sandwich-type" construction 1.4" (36mm) thick with a 0.1" (3mm) solid grade face sheet laminate on both sides with a moisture-resistant, foam core. Sturdy aluminum brackets ensure the system's stability and resistance to warping. Phenolic LT materials are impact and scratch resistant. Anti-bacterial coating and non-porous surface reduce spread of germs. Panel sizes can be customized when wider than 15.7" (400mm). For accuracy, measurements should be taken to the closest millimeter. See the Support & Stabilization Spec table on page 3 for guidance.

Sight Screens

Panels that are 24.1" (611mm) wide or larger are wall hung with a floor to ceiling post at front of panel. Posts are drilled into the floor and ceiling approximately 1.57" (40mm). Cover plates are provided to conceal screws.

Urinal Screens

Panels that are 15.8" (401mm) to 24" (610mm) may be wall hung with a continuous bracket and foot braced.

Panels up to 15.7" (400mm) wide and 35.4" (900mm) high are wall hung with 4 stirrup brackets.

Hardware

Screens shall be provided with all hardware and fastenings for a complete installation.

Brackets

Anodized aluminum continuous or stirrup brackets are provided, depending on width of screen.

Feet

Feet are constructed of aluminum and match the feet on the partitions.

Product Compliance

Complies with

- ASTM D6578
- ASTM D2794
- ASTM E84 Class B



Listed by UL Environment to

- GreenGuard Gold



Verify all rough-in dimensions prior to installation.
Consult local and national codes. Conformity and compliance to local and national codes is the responsibility of the installer.

Euro Style Urinal Screen with Continuous Bracket and Floor to Ceiling Post

For panels that are 24.1" (611mm) or wider.

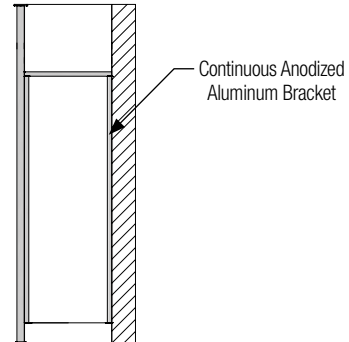

Wall-Hung and Foot-Braced Euro Style Urinal Screen

For panels between 15.8" (401mm) and 24" (610mm) wide.

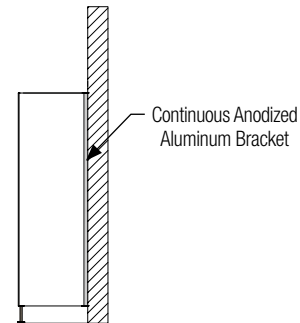

Wall-Hung Urinal Screen with Stirrup Brackets

For panels 15.7" (400mm) wide.

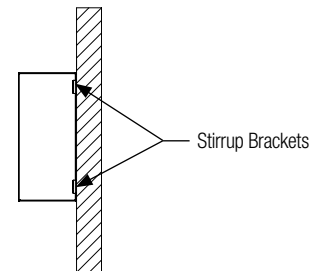

Note: Location of bracket drill holes is dependent on height of panel.



A WATTS Brand

Euro Style Urinal Screens

Phenolic LT – LOFT Series

Dimensions

(mm)

Top View

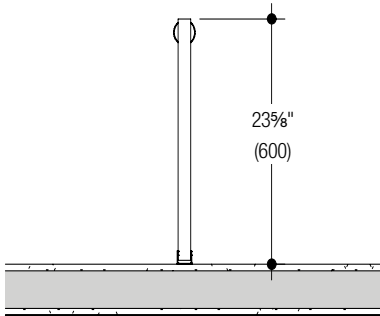

Front View

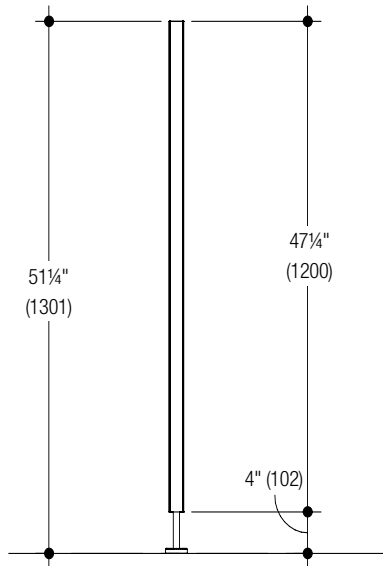

Side View

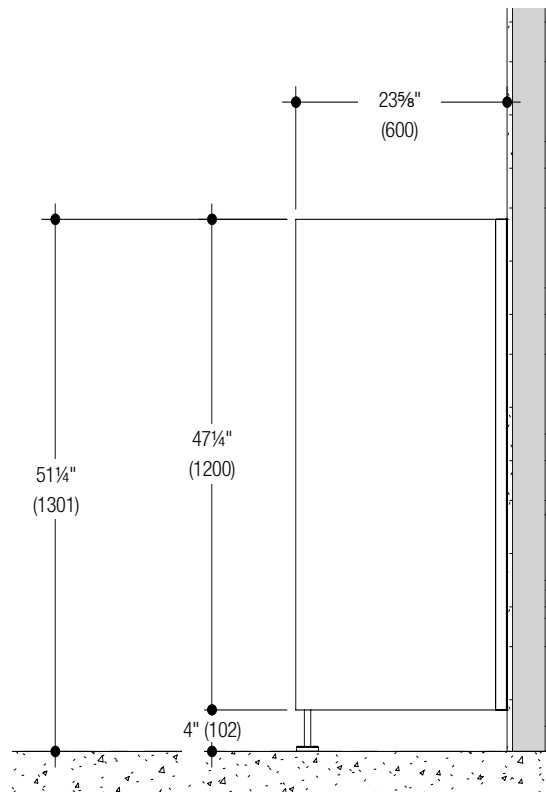

Verify all rough-in dimensions prior to installation.
Consult local and national codes. Conformity and compliance
to local and national codes is the responsibility of the installer.



A WATTS Brand



Euro Style Urinal Screens

Phenolic LT – LOFT Series

Standard Selections (select one)

Colors

NOTE: Click on any swatch to view as a larger image.

18074 - Atlantic	 Atlantic
35003 - Birch	 Birch
30013 - Dark Walnut	 Dark Walnut
12204 - Manhattan	 Manhattan
12231 - Slate Grey	 Slate Grey
70004 - Storm Cloud	 Storm Cloud
10140 - White	 White
Custom	Custom color: _____

Wall Brackets

Continuous Anodized Aluminum

Feet

Aluminum

Support & Stabilization Specifications

Panel Width	<15.7" (400mm)	15.8" (401mm) – 24" (610mm)	> 24.1" (611mm)
Application	Urinal Screen	Sight Screen	Sight Screen
Type of Bracket	Stirrup	Continuous	Continuous
Number of Brackets	4	1	1
1.57" (40mm) Support Post	No	No	Yes
Foot Brace	No	Yes	No
Maximum Screen Height	35.4" (900mm)	63" (1600mm)	108.3" (2750mm)
Maximum Support Post Height	n/a	n/a	118.1" (3000mm)
AFF	Variable	4" (101.6mm), 9" (229mm) or 12" (304.8mm)	Variable

Verify all rough-in dimensions prior to installation.
Consult local and national codes. Conformity and compliance
to local and national codes is the responsibility of the installer.