



# Soap Shank Kits – Verge™ Soap Dispensers Installation

P15-596 Crestt, P15-597 Metro, P15-598 Linea, P15-599 Zen

## Remove Existing Shank Assembly

1. Carefully disconnect the electrical connections and soap dispenser tubing from the control box and soap tank.

**IMPORTANT: When disconnecting sensor wire, be sure to pull apart at the connectors; DO NOT PULL ON WIRE.**

2. Remove and discard the wing nut and locking tab.
3. Remove the casting and shank assembly from the lavatory deck and set onto a non-scratch work surface.
4. Use the 3mm hex wrench to disengage the set screw and then separate the casting from the shank assembly.

*NOTE: The sensor wire will remain connected to the casting and shank assembly.*

5. Remove the two sensor wire screws and the sensor wire from the shank assembly.

*NOTE: The sensor wire end will tightly pass through the shank assembly.*

6. Discard the old shank assembly and gasket.

## Install New Shank Assembly

1. Carefully route the sensor wire through the shank assembly.
2. Install the two sensor wire screws that were previously removed.
3. Install the casting onto the shank assembly.
4. Use the 3mm hex wrench to lightly tighten the set screw.

*NOTE: Compress the set screw spring while tightening the set screw.*

5. Route the wires and tubing through the lavatory deck and then through the supplied locking tab. See illustration below.

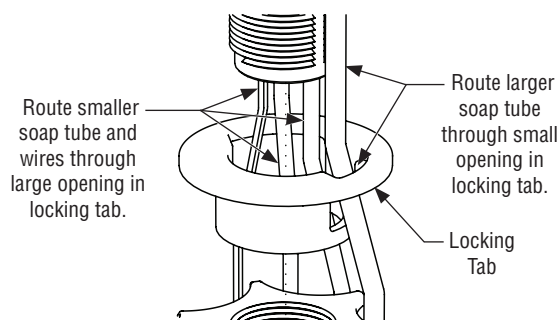

6. Align the locking tab with the slot on the shank. Slide the locking tab up to deck. The locking tab prevents the tubing and wires from being pinched when assembled.
7. Install and tighten the supplied wing nut (6 wing style) to a maximum torque of 75 in-lb.
8. Reconnect the soap dispenser tubing and electrical connections to the soap tank and control box.

*NOTE: For multi-feed soap systems, install the red drain plug into the shank fill port. Also the smaller soap tube is not used and does not need to be connected.*

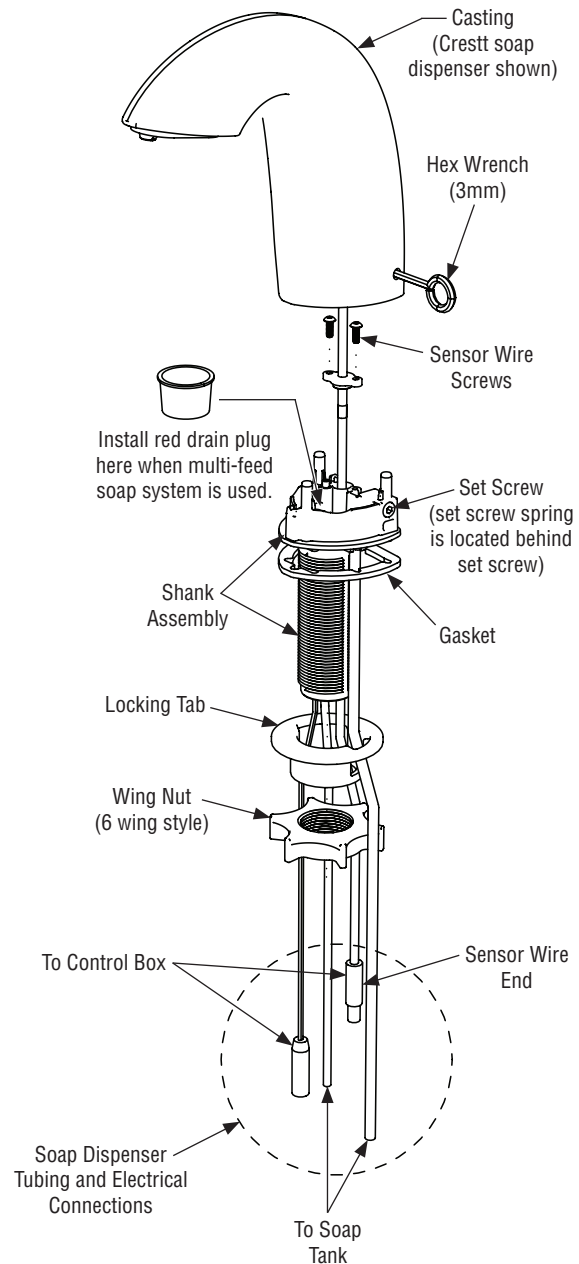

Scan the QR codes to access the individual and multi-feed soap system installation instructions.



P20-224



P20-225