



GSA prices effective October 7, 2024
(based on July 1, 2024, commercial price list)
Published March 2025

Workspaces Ethospace® System with Tu® Pedestals 10-Day or Less

General Services Administration Federal Supply Service Authorized Federal Supply Schedule Price List

Online access to contract ordering information, terms and conditions, up-to-date pricing, and the option to create an electronic delivery order is available through GSA Advantage!®, a menu-driven database system. The Internet address for GSA Advantage! is www.gsaadvantage.gov.

Office Furniture
FSC/PSC 7110/7125
Contract Number: GS-03F-036DA
UEI: Q2K3MSZ843D8
Contract Period: December 21, 2015—December 20, 2025

MillerKnoll, Inc.
855 East Main Avenue
Zeeland, Michigan 49464
(616) 654 3000 Phone
(616) 654 8278 Fax
www.HermanMiller.com/government

Business Size: Large

Contract Information

1a. Special Item Numbers (SIN)

SIN 33721

Furniture Systems, Computer Furniture, Filing and Storage, Tables and Accessories, Upholstered Seating and Multi-Purpose Seating, Project Management, Reconfiguration and Relocation Services, Design/Layout and Installation Services

SIN 33721P

Packaged Offices

SIN 337127

Modular Laboratory Furniture Systems

SIN 339113H

Healthcare Furniture

SIN OLM

Order-Level Materials (OLMs)

This SIN is only for products and/or services used in direct support of the purchase of new furniture. It requires approval from the ordering Contract Officer. Please contact your local MillerKnoll Inc. representative to discuss the appropriate use of this SIN.

SIN 532289

Leasing

Contact MillerKnoll Inc participating government dealer for current leasing information.

1b. Lowest Priced Model

SIN 33721:	BVP3.S	\$7.27
SIN 33127:	TW113	\$5.81
SIN 339113H:	CR900NR	\$483.80

1c. Service Rates

Project Management

Furniture Project Manager: \$64.75 per hour
Furniture Project Coordinator: \$49.00 per hour
Build-Out Project Manager: \$80.00 per hour

Reconfiguration and Relocation Services

Not to exceed \$55 per hour.

See * Additional Notes for Installation & Reconfiguration and Relocation Services.

Design/Layout

Not to exceed \$65 per hour.

Installation Services

Not to exceed \$55 per hour (\$82.50 per hour for after-hours Installation).

See * Additional Notes for Installation & Reconfiguration and Relocation Services.

2. Maximum Order

SIN 33721, 337127, NEW, OLM

\$250,000 net product value

SIN 33721P

\$250,000 net value

SIN 339113H

\$500,000 net product value

3. Minimum Order

\$100 net

4. Geographic Coverage

Continental U.S.

Orders for Alaska, Hawaii, and Puerto Rico will be shipped F.O.B. inland carrier point of exportation.

5. Point of Production

Zeeland, Ottawa County, Michigan

Spring Lake, Ottawa County, Michigan

Elland, Yorkshire, United Kingdom

Hildebran, Burke County, North Carolina, USA

6. Pricing

Prices shown are list. Discounts include Industrial Funding Fee.

SIN 33721

Standard Lead Time, Single Order Net Purchase \$100 - 250,000, includes approved Herman Miller Options Products.

Product Line	Discount From List
Action Office 1	73.8%
Action Office 2	73.8%
Aeron	64.5%
Ambit Workspace Solutions	74.3%
Asari Chair	53.7%
Aside	64.2%
Bay Work Pod	56.7%
C-Style Overhead Storage	73.8%
Canvas Office Landscape Channel	74.8%
Canvas Office Landscape Dock	74.8%
Canvas Metal Desk	74.8%
Canvas Office Landscape Metal Storage	74.8%
Canvas Office Landscape Private Office	74.8%
Canvas Office Landscape Wood Storage	74.8%
Canvas Office Landscape Vista	74.8%
Canvas Office Landscape Wall	74.8%
Caper	61.5%
Commend Nurses Station	73.3%
Cosm	61.7%
Eames® Aluminum Group	58.7%
Eames Conference & Dining Tables	73.6%
Easton Family	54.91%
Embody	59.7%
Energy Distribution Systems	73.8%
Ethospace System	73.8%
Everywhere™ Tables	73.8%
Exclave	61.7%

Contract Information

continued

Fuld	59.7%
Headway™ Tables	73.8%
Intent Solution	58.7%
Layout Studio®	60.7%
Lighting	73.8%
Lino	63.7%
Meridian Laterals	67.3%
Meridian Pedestals	64.2%
Meridian Towers	62.7%
Meridian Storage	62.7%
Mirra 2	61.7%
Motia Tables	73.8%
NaughtOne	50.0%
Nemschoff	54.91%
Nevi™ Tables	73.8%
Nevi Link	73.8%
OE1 Boundary	72.8%
OE1 Community Elements	61.7%
OE1 Micro Packs	73.8%
OE1 Storage	72.8%
OE1 Tables and Benching	73.8%
Overlay™	62.7%
Plex® Lounge Furniture	59.5%
Pronta Stacking Chair	57.7%
Public Office Landscape	61.7%
Renew™ Tables	73.8%
Renew Link	73.8%
Sayl	62.2%
Setu	59.7%
Swoop Lounge Furniture	60.7%
Thrive Portfolio	62.0%
Thrive Portfolio-CBS Products Extension	62.0%
Tu Lateral Files	74.3%
Tu Pedestals	73.8%
Tu Storage	74.3%
Tu Towers	74.3%
Tu Wood Cases	74.3%
Tu Wood Cubbies	74.3%
Tu Wood Credenzas	74.3%
Tu Wood Pedestals	74.3%
Tu Wood Towers	74.3%
Valor™ Family	54.91%
Verus	63.7%
Zeph	60.2%

Services

Please refer to section 19 for Terms and Conditions of Installation/ Reconfiguration and Relocation Services.

Project Management

Services under this SIN may be used only in conjunction with the purchase of new furniture. Please contact your local MillerKnoll Inc. representative to discuss the available labor categories (listed below). The hourly rates listed are “Not To Exceed” or “NTE” values.

Furniture Project Manager: \$64.75 per hour
Furniture Project Coordinator: \$49.00 per hour
Build-Out Project Manager: \$80.00 per hour

Reconfiguration and Relocation Services

Reconfiguration and Relocation Services will be provided by MillerKnoll Inc. or its participating dealer based on a fee not to exceed \$55 per hour.

See * Additional Notes for Installation & Reconfiguration and Relocation Services.

Design/Layout

Design service will be provided by MillerKnoll Inc. or its participating dealer based on a fee not to exceed \$65 per hour.

Installation Services

Installation Services will be provided by MillerKnoll Inc. or its participating dealer based on a fee not to exceed \$55 per hour (\$82.50 per hour for after-hours Installation).

See * Additional Notes for Installation & Reconfiguration and Relocation Services.

SIN 337127

Standard Lead Time, Single Order Net Purchase \$100 - 250,000, includes approved Herman Miller Options Products.

Product Line	Discount From List
Action Lab	58.5%
Compass System	58.5%
Co/Struc System	58.5%
Healthcare Carts	18.0%
Mora System	58.5%
Bedside Cabinets	58.5%

SIN 33721P

Packaged Office Furniture - Maximum Order \$250,000 (net).

Includes packaged furniture solutions for customers needing to furnish an office.

SIN 339113H

Standard Lead Time, Single Order Net Purchase \$100 - 500,000, includes approved Herman Miller Options Products.

Product Line	Discount From List
Nemschoff Healthcare Furniture	54.91%

7. Quantity Discounts

Reference item #6.

8. Payment Terms

Net 30 days

9. Foreign Items

None

10. Time of Delivery

- a. 90 day ARO
- b. Expedited delivery: Items listed in the 10-Day section of the catalogs are available for expedited delivery.
- c. Overnight/2-day delivery: Select items may be available for overnight or 2-day delivery. Contact MillerKnoll Inc. or a participating dealer for availability and rates.
- d. Urgent requirements: Agencies may contact contractor or participating dealer to request faster delivery.

Contract Information

continued

11. F.O.B.

F.O.B. destination except Alaska, Hawaii, and Puerto Rico, which will be shipped F.O.B. inland carrier point of exportation.

12. Ordering Address

a. MillerKnoll Inc.

Government Customer Care 0161
855 East Main Avenue
Zeeland MI 49464.

b. For supplies and services, the ordering procedures information on Blanket Purchase Agreements (BPA's) are found in Federal Acquisition Regulation (FAR) 8.405-3.

13. Payment Address.

MillerKnoll Inc.
22764 Network Place
Chicago, IL 60673-1227

14. Warranty

MillerKnoll Inc. commercial warranty applies.

15. Export Packing Charge

Prices supplied on request.

16. Rental Maintenance and Repair Terms

Not applicable

17. Terms and Conditions of Installation/Reconfiguration and Relocation Services

* Additional Notes for Installation & Reconfiguration and Relocation Services:

FOB Destination (Drop Ship): Price includes product delivery to the site, brought to the tailgate of the truck. The purchaser is responsible for unloading.

Prices effective up to the maximum order by SIN only. Above the MO, pricing shall be negotiated on a case-by-case basis between the client and local dealer.

Standard Services are Subject to the Following Conditions:

Installation will be performed during normal weekday working hours.

Adequate facilities for delivery, unloading, moving and staging/storing the product during the installation process shall be provided.

Service work will not be hindered by other trades.

Electric, heat, and adequate elevator service will be furnished without charge.

The immediate installation area shall be complete and free of debris including the carpet/flooring before installation commences.

Any work requiring a licensed electrician is the responsibility of the buyer.

Additional Charges May Apply For:

Major Metro Markets and any non-ground floor installation.

Major Metro Markets include large population centers and urban environments.

Installation in a clinical/medical environment.

Special restrictions or limits established by local laws, ordinances or the directions of the buyer, including but not limited to restrictions on transportations of materials, street access to the job site and/or dock facilities.

Installations outside of a 50 mile radius of the servicing dealer.

Local Prevailing Wage and/or Union Labor Rates.

Any additional charges shall be quoted by the dealer and approved by the buyer prior to performance of the work.

18. Terms and Conditions of Repair Parts

Not applicable

19. Service and Distribution Points

For service and distribution points nearest you, call (800) 851 1196.

20. Participating Dealers

Access Herman Miller web site for current list of participating dealers: www.HermanMiller.com/where-to-buy/contact-a-dealer/. Select your market by using the filter.

21. Preventive Maintenance

Not applicable

22a. Special Attributes.

2022

MillerKnoll earns its 15th consecutive perfect score in Human Rights Campaign Foundation's 2022 Corporate Equality Index.

2021

The OE1 Trolley and Micro Packs are both winners of the 2021 Archiproducts international design competition in the Office Category.

MillerKnoll is named to Michigan's Best and Brightest in Wellness List for 2021.

MillerKnoll is awarded Platinum Rating in CSR by EcoVadis.

OE1 is named winner of Wallpaper's "Most Futuristic Furniture" Category as part of their first-ever Smart Space Awards.

OE1 receives the Workplace category award from Fast Company's 2021 Innovation by Design Awards.

MillerKnoll is named to Fast Company's Annual List of the World's Most Innovative Companies for 2021.

MillerKnoll is recognized as a "Disclosure Leader" by the Chemical Footprint Project (CFP).

Contract Information

continued

MillerKnoll earns its 14th consecutive perfect score in Human Rights Campaign Foundation's 2021 Corporate Equality Index.

MillerKnoll is named to Newsweek's List of America's Most Responsible Companies 2021.

Great Lakes Women's Business Council awards MillerKnoll for "Excellence in Supplier Diversity" in the Best In Class category.

2020

Herman Miller is recognized with a 2020 FSC® Leadership Award for our commitment to responsible forestry management.

Herman Miller is named one of Investor's Business Daily Top 50 Best ESG (Environmental, Social, and Corporate Governance) Companies.

Working Mother names Herman Miller as one of the Best Companies for Dads.

Herman Miller is awarded Platinum Rating in CSR by EcoVadis.

Herman Miller is named Diversity Inc 2020 Noteworthy Company for recruitment efforts, employee development opportunities, leadership accountability, and supplier diversity.

Cosm, by Studio 7.5, receives an iF Gold Award in the Office and Industry category at the iF World Design Awards 2020.

Herman Miller earns its 13th consecutive perfect score in Human Rights Campaign Foundation's 2020 Corporate Equality Index.

2019

Mora System casework, designed by Collective Ten for Herman Miller, receives silver in the Industrial and Life Science Design/ Medical Furniture category at the European Product Design Awards.

Mora System casework is awarded GOOD DESIGN Award 2019, selected for design excellence and innovation.

National Minority Supplier Diversity Council (NMSDC) names Herman Miller as the 2019 Class 1 Corporation of the Year for leadership in supplier diversity.

TIME Magazine names Cosm to its list of 100 Best Inventions of 2019.

Herman Miller is named #12 Overall and #2 in Manufacturing on Investor's Business Daily Best ESG (Environmental, Social, Governance) Companies.

Herman Miller is recognized as a silver level Certified Veteran-Friendly Employer by the Michigan Veterans Affairs Agency for a commitment to veteran hiring, retention, and development.

For the second year in a row, Herman Miller receives a Gold Medal from EcoVadis in recognition of Corporate Social Responsibility achievement measured in categories of environment, labor and human rights, ethics, and sustainable procurement.

Herman Miller is named "Frontrunner" in Chemical Footprint Project by Clean Production Action for our chemical management policies and practices.

Herman Miller receives International Interior Design Association and Contract's best showroom design award in the "Large Showroom" category at NeoCon.

Herman Miller earns its 12th consecutive perfect score in Human Rights Campaign Foundation's 2019 Corporate Equality Index.

Cosm, designed by Studio 7.5 for Herman Miller, receives a Red Dot Best of the Best Product Design Award in the "Office Chairs" category.

Lino, designed by Sam Hecht and Kim Colin for Herman Miller, receives an iF Design Award in the Product Design category.

2018

Overlay, designed by Birsell+Seck, receives Interior Design Best of Year Award in the Partitions and Wall Systems category.

Herman Miller receives the "Corporation of the Year" in consumer products award from the Michigan Minority Supplier Development Council.

Herman Miller achieves the Advanced Excellence in Supplier Diversity Award from the Great Lakes Women's Business Council for doing business with women-owned suppliers.

Great Lakes Women's Business Council awards Herman Miller for "Excellence in Supplier Diversity" in the Advanced category.

WEConnect awards Herman Miller an Honorable Mention for global supplier diversity initiatives.

As one of the top-scoring companies in the industry for the 14th consecutive year, Herman Miller has qualified for inclusion in RobecoSAM's 2018 Sustainability Yearbook and receives the Silver Class distinction for excellent sustainability performance—economic, environmental, and social.

For the 11th consecutive year, Herman Miller receives a perfect score on the Human Rights Campaign Foundation's Corporate Equality Index and is designated as Best Place to Work for LGBT equality. This report evaluates U.S. companies in terms of diversity, particularly LGBT-related policies and practices.

Contract Information

continued

Herman Miller receives Gold Medal from EcoVadis in recognition of Corporate Social Sustainability achievement measured in categories of environment, labor and human rights, ethics, and sustainable procurement. EcoVadis operates the first web-based collaborative platform that allows companies to assess the environmental and social performance of their global suppliers.

Aeron receives Good Design Award from The Chicago Athenaeum Museum of Architecture and Design.

The Cosm Chair wins Mix Interiors "Product of the Year—Task" award.

2017

Herman Miller receives "Rising Star Award" from the Michigan Veterans Affairs Agency (MVAA) for exhibiting new and novel approaches to veteran recruitment and hiring.

Herman Miller is named the 2017 "Corporation of the Year" in the consumer products sector by the Michigan Minority Supplier Development Council (MMSDC).

Herman Miller receives a 2017 SEAL (Sustainability, Environmental Achievement and Leadership) Business Sustainability Award. SEAL Award winners are determined by a holistic methodology measuring applicants against established benchmarks that demonstrate impact and progress toward creating a healthy planet and a sustainable future.

Herman Miller earns the 4 Star Diversity Visionary Award. This award celebrates the diversity, equality, and inclusion work of Herman Miller. The award is presented at the annual Diversity Equity Inclusion Summit, held by the Grand Rapids Area Chamber of Commerce.

Herman Miller is named one of the Best and Brightest in Wellness for the 5th year in a row.

Herman Miller earns its 10th consecutive perfect score in Human Rights Campaign Foundation's 2017 Corporate Equality Index.

As one of the top-scoring companies in the industry for the 13th consecutive year, Herman Miller has qualified for inclusion in RobecoSAM's 2017 Sustainability Yearbook and receives the Bronze Class distinction for excellent economic, environmental, and social sustainability performance. The selection criteria for inclusion in the Yearbook becomes more rigorous each year, and only the top 15 percent of companies within each industry are selected.

Herman Miller once again earns the WorldatWork Seal of Distinction, a unique standard of excellence in work-life effectiveness that shows we provide a distinct, mutually beneficial workplace experience. Herman Miller is the only furniture manufacturer among the 160 companies across the U.S. and Canada honored with the award.

Herman Miller's Mora wins Nightingale Silver Award in the "Furniture Collections" category at the 2017 Healthcare Design Conference.

2016

Herman Miller earns 9th consecutive perfect score in Human Rights Campaign Foundation's Corporate Equality Index and is designated as Best Place to Work for LGBT equality.

Herman Miller is recognized as the Business of the Year at the Annual Meeting of the West Michigan Environmental Action Council (WMEAC) for being an outstanding partner in support of the growth of WMEAC's programs. WMEAC's award goes to the business with the greatest depth and breadth of support, unwavering dedication to environmental action in West Michigan, and a strong corporate commitment to environmental advocacy.

The 101 Best and Brightest Sustainable Companies once again (5th consecutive year) recognizes Herman Miller as an organization in Michigan (and for the first time, in the nation) that exhibits leadership and innovation in its approach to sustainability. This award celebrates those companies that are making their businesses more sustainable, the lives of their employees better, and the community, both locally and globally, more responsible as a whole.

Herman Miller is recognized by the Michigan Minority Supplier Development Council (MMSDC) as a "Corporation of the Year". Additionally, we are the only West Michigan company this year to receive an "Ambassadors Championing Excellence" Award from the MMSDC.

Herman Miller is recognized with "2016 Excellence in Supplier Diversity Award" from the Great Lakes Women's Business Council.

Herman Miller is recognized as a 2016 Healthiest 100 Workplace in America, ranking 49th in the country for our commitment to health and exceptional corporate wellness programming.

Herman Miller receives the Best and Brightest in Wellness Award for the 4th year in a row. This program is an innovative initiative that recognizes and celebrates quality and excellence in health awareness.

The Michigan Occupational Safety and Health Administration renews Herman Miller's "Star" status, the highest workplace safety and health designation, for the Hickory facility in Spring Lake.

Plex Lounge Furniture from Herman Miller receives #MetropolisLikes award at NeoCon 2016.

Plex Lounge Furniture from Herman Miller receives Interior Design HiP Award for Workplace Seating/Lounge at NeoCon 2016.

Herman Miller is named a 2016 Women on Boards Winning Company. Companies selected for this recognition are considered champions of board diversity as 20 percent or more of their board seats are occupied by women.

Herman Miller is selected for inclusion in the 2016 RobecoSAM Sustainability Yearbook for the 12th consecutive year.

Herman Miller again earns the WorldatWork Work-Life 2016 Seal of Distinction. This award identifies organizations that focus on programs that promote work-life balance and overall well-being.

Contract Information

continued

22b. Section 508 Compliance

Not applicable

23. Unique Entity ID: Q2K3MSZ843D8

24. Registered in System for Award Management (www.SAM.gov) Database

25. Cancellation

Prior to production, no cancellation charge will apply. After production, only actual cost incurred that the contractor can demonstrate if items are sold after 3 months.

26. Restocking Charges

Agencies must notify the contractor for authorization prior to returning any items. The customer agency will be required to pay all packaging and return freight charges. A restocking fee of 50% for Systems Furniture and 35% for all other product lines will be charged for any returned items.

Returns and restocking policy is not applicable to Options products, products under SIN 337127, 339113H, NaughtOne and Nemschoff products.

MillerKnoll Inc. Miscellaneous Information:

Federal ID Number: 38-0837640

Commercial and Government Entity Code (CAGE): 40636

Data Universal Numbering System (DUNS) 00-601-2801

Commercial Entity Code (CEC): 00702290J

Introduction	page 2
Ethospace® System 10-Day or Less	3
Walls	5
Work Surfaces	44
Storage	55
Lighting	61
Tu® Pedestals 10-Day or Less	63
Metal Pedestals	65
Metal Pedestal Accessories	72
Indices	75
By Name	75
By Number	77
Appendices	
10-Day or Less Order Information	
10-Day Keyed-Alike Information	
Stain-to-Match Program	
Proprietary Textiles Application Chart - 10-Day Workspaces	
Proprietary Textile Colors - 10-Day Workspaces	
For the latest materials information, refer to the Materials pages on HermanMiller.com.	

A Note on the Organization of This Book

There are a few signals that will help you understand the organization of this book. Once you know them, you should be able to find your way around easily.

Like a newspaper, this book is formatted with columns of text and illustrations that run vertically.

Information wraps from one column to the next and continues for as many pages as it needs to.

Black bars are clues.

A black bar at the top of a page signals the start of information about a product.

Specification Information, which always begins at the top of a column, includes a series of steps. Each step represents a decision you need to make in order to complete your product number. Steps must be followed sequentially. The number of pages needed to complete information on a product varies; some will be complete in one page; others may fill three or four pages. Just continue going through the steps until you run into the next product, signaled by the black bar at the top of the page.

Black tabs running along the outside edge of the page help you locate what section you are in or what section you want to go to. You can thumb forwards or backwards to find a section; tabs and text appear on both sides of the page.

The additional pages in the back of the book include the appendices and indices. They are signaled by a long black bar running along the outside edge of the page.

The index is presented two ways.

The first index is in alphabetical order by product name. It can be helpful if you are new to the products and numbering scheme or if you are looking for a type of product, such as work chair or round table.

The second index is by product number. It lists, in alphanumeric order, the base product number, typically a five-digit number.

General Information

This book is effective October 7, 2024, subject to change without notice. Products may be purchased from authorized Herman Miller dealers who will quote prices upon request. For more information about our products and services or to see a list of dealers, visit www.HermanMiller.com.

All prices are list prices. Additional services, such as planning services, design, storage, and installation, are not included and must be added to these prices when the additional services are requested.

Illustrations, specifications, and prices are based on the latest information at the time of publication. The right is reserved to make changes at any time without notice in prices, fabrics, finishes, materials, specifications, and models, and also to discontinue models and finishes.

For additional product information such as dimensional drawings and product descriptions, refer to the standard price books.

Service problems are normally handled by a Herman Miller authorized dealer. Where this cannot be accomplished on a local level, service problems should be referred to the Customer Care Representative for your region, Herman Miller, Inc., Zeeland, Michigan 49464.

Walls

Work Surfaces

Storage

Lighting

Bare Frame

E1109.

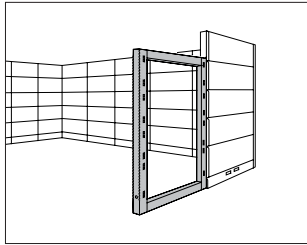

Specification Information

Step 1.

E1109.

Step 2. Height

30	30" high
38	38" high
46	46" high
54	54" high
62	62" high
70	70" high
86	86" high

Step 3. Width

24X	24" wide
30X	30" wide
36X	36" wide
42X	42" wide
48X	48" wide

Prices for Steps 1-3.

		24X	30X	36X	42X	48X
E1109.	30	\$321	337	356	384	436
	38	\$368	404	419	446	462
	46	\$396	436	454	460	465
	54	\$439	465	500	515	553
	62	\$462	493	526	544	572
	70	\$504	541	559	580	616
	86	\$554	596	616	639	678

Frame

E1109.

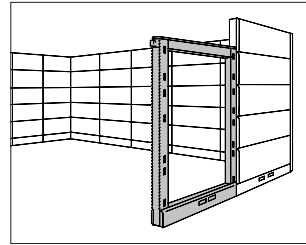

Specification Information

Step 1.

E1109.

Step 2. Height

30	30" high
38	38" high
46	46" high
54	54" high
62	62" high
70	70" high
86	86" high

Step 3. Width

24	24" wide
30	30" wide
36	36" wide
42	42" wide
48	48" wide

Step 4. Power

For 30" high (30) with 24" wide (24) or 30" wide (30)

N	(N) nonpowered with no receptacle locations
R	(R) nonpowered with 1 receptacle location per side (meets Chicago electrical code requirements)
J	(J) nonpowered with 2 receptacle and 1 communication port locations per side
G	(G) 4-circuit power with 2 receptacle and 1 communication port locations per side

For 38" high (38), 46" high (46), 54" high (54), 62" high (62), 70" high (70), or 86" high (86) with 24" wide (24) or 30" wide (30)

N	(N) nonpowered with no receptacle locations
R	(R) nonpowered with 1 receptacle location per side (meets Chicago electrical code requirements)
J	(J) nonpowered with 2 receptacle and 1 communication port locations per side
G	(G) 4-circuit power with 2 receptacle and 1 communication port locations per side

For 38" high (38), 46" high (46), 54" high (54), 62" high (62), 70" high (70), or 86" high (86) with 36" wide (36), 42" wide (42), or 48" wide (48)

N	(N) nonpowered with no receptacle locations
R	(R) nonpowered with receptacle locations (meets Chicago electrical code requirements)
J	(J) nonpowered with 2 receptacle and 1 communication port locations per side
G	(G) 4-circuit power with 2 receptacle and 1 communication port locations per side

For 30" high (30) with 36" wide (36), 42" wide (42), or 48" wide (48)

N	(N) nonpowered with no receptacle locations
R	(R) nonpowered with receptacle locations (meets Chicago electrical code requirements)
J	(J) nonpowered with 2 receptacle and 1 communication port locations per side
G	(G) 4-circuit power with 2 receptacle and 1 communication port locations per side

Prices for Steps 1-4.

	N	R	J	G
E1109. 30 24	\$597	615	615	898
30	\$676	690	690	967
36	\$746	766	766	1041
42	\$821	837	837	1121
48	\$898	911	911	1192
38 24	\$651	658	662	943
30	\$721	735	735	1024
36	\$796	814	814	1094
42	\$870	889	889	1170
48	\$943	958	958	1243
46 24	\$699	711	713	997
30	\$777	791	791	1070
36	\$849	859	859	1148
42	\$920	939	939	1218
48	\$997	1011	1011	1295
54 24	\$745	760	762	1040
30	\$820	833	833	1119
36	\$898	911	911	1192
42	\$967	985	985	1266
48	\$1040	1058	1058	1337
62 24	\$794	809	809	1090
30	\$856	883	887	1166
36	\$943	958	958	1243
42	\$1024	1034	1034	1312
48	\$1090	1104	1104	1387

70 24	\$845	855	855	1137
30	\$916	931	931	1213
36	\$991	1008	1008	1290
42	\$1064	1079	1079	1363
48	\$1137	1155	1155	1432
86 24	\$940	955	955	1241
30	\$1015	1028	1028	1307
36	\$1088	1101	1101	1385
42	\$1164	1176	1176	1457
48	\$1241	1247	1247	1529

Step 5. Top Cap Finish

NN	none	+\$0
HF	inner tone light	+\$18
LU	soft white	+\$18
MT	medium tone	+\$18

Step 6. Cable Management Finish

HF	inner tone light	+\$0
LU	soft white	+\$0
MT	medium tone	+\$0

Frame, Transaction Work Surface

E1116.

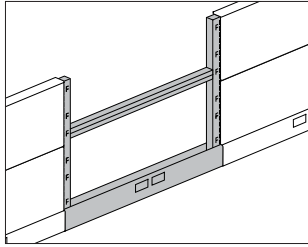

Specification Information

Step 1.

E1116.38

Step 2. Width

36	36" wide
48	48" wide
60	60" wide

Step 3. Power

N	(N) nonpowered with no receptacle locations
J	(J) nonpowered with 2 to 4 receptacle and 1 to 2 communication port locations per side
G	(G) 4-circuit power with 2 to 4 receptacle and 1 to 2 communication port locations per side

Prices for Steps 1-3.

		N	J	G
E1116.38	36	\$1165	1183	1489
	48	\$1307	1318	1612
	60	\$2027	2042	2328

Step 4. Cable Management Finish

HF	inner tone light	+\$0
LU	soft white	+\$0
MT	medium tone	+\$0

Stile Covers and Top Caps, Transaction Work Surface Frame

E1117.

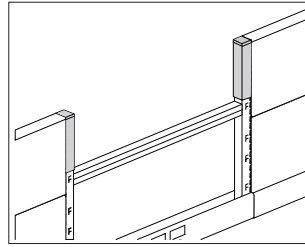

Specification Information

Step 1.

E1117.

Step 2. Type

S	standard
A	architectural

Prices for Steps 1-2.

E1117. S	\$184
A	\$742

Step 3. Finish

For standard (S)

8Q	folkstone grey (CP)	+\$0
91	white (CP)	+\$0
CL	cool grey neutral	+\$0
HF	inner tone light	+\$0
LU	soft white	+\$0
MT	medium tone	+\$0
SG	slate grey	+\$0
WL	warm stone (CP)	+\$0
WN	warm grey neutral	+\$0

For architectural (A)

8Q	folkstone grey (CP)	+\$0
91	white (CP)	+\$0
EH	metallic bronze	+\$0
HF	inner tone light	+\$0
LU	soft white	+\$0
MT	medium tone	+\$0
SG	slate grey	+\$0
WL	warm stone (CP)	+\$0

Side Cover

E1263.

Stacking Frame

E1112.

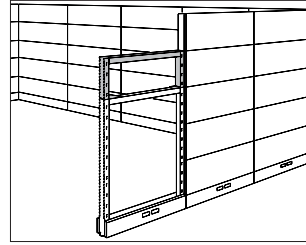
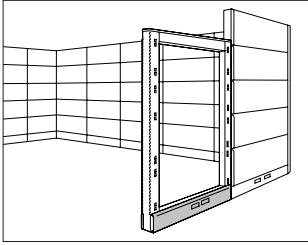

Ethospace® Walls

Specification Information

Step 1.

E126

Step 2. Base Type

3. plain base

Step 3. Width

24 24" wide

30 30" wide

36 36" wide

42 42" wide

48 48" wide

Step 4. Receptacle/Data Locations

For plain base (3.) with 24" wide (24) or 30" wide (30)

N (N) no receptacle locations

J (J) 2 receptacle and 1 communication port locations

R (R) 1 receptacle location (meets Chicago electrical code requirements)

For plain base (3.) with 36" wide (36), 42" wide (42), or 48" wide (48)

N (N) no receptacle locations

J (J) 2 receptacle and 1 communication port locations

R (R) 2 receptacle locations (meets Chicago electrical code requirements)

Prices for Steps 1-4.

	N	J	R
E1263. 24	\$104	108	128
30	\$108	119	157
36	\$125	133	168
42	\$139	150	175
48	\$148	163	199

Step 5. Surface Finish

HF	inner tone light	+\$0
LU	soft white	+\$0
MT	medium tone	+\$0

Specification Information

Step 1.

E1112.

Step 2. Width

24 24" wide

30 30" wide

36 36" wide

42 42" wide

48 48" wide

Prices for Steps 1-2.

E1112. 24	\$399
30	\$422
36	\$438
42	\$454
48	\$465

Draw Rod

E1120.

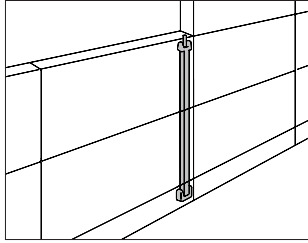

Specification Information

Step 1.

E1120.

Step 2. Height

30	30" high
38	38" high
46	46" high
54	54" high
62	62" high
70	70" high
86	86" high

Prices for Steps 1-2.

E1120.	30	\$53
	38	\$53
	46	\$54
	54	\$54
	62	\$60
	70	\$66
	86	\$67

Wall Strip

E1130.

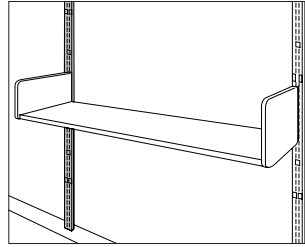

Specification Information

Step 1.

E1130.

Step 2. Height

64N	64" high
80N	80" high

Prices for Steps 1-2.

E1130.	64N	\$129
	80N	\$137

Tile Adapter

E1131.

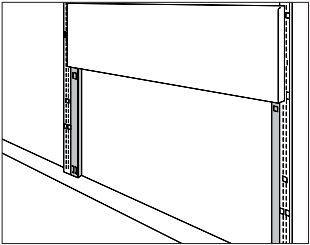

Specification Information

Step 1.
E1131.

Step 2. Height

- 08 8" high
- 16 16" high

Prices for Steps 1-2.

E1131. 08	\$56
16	\$95

Wall Fastener

X1192.

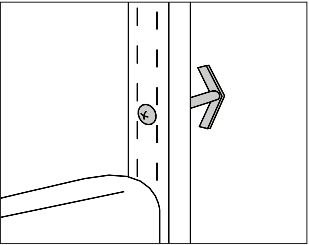

Specification Information

Step 1.
X1192.

Step 2. Size

- 1 no. 10, 1½" sheet metal screw
- 2 no. 10, 3" sheet metal screw
- 3 no. 10, 3" machine screw

Prices for Steps 1-2.

X1192. 1	\$52
2	\$52
3	\$89

Trim Strip

E1132.

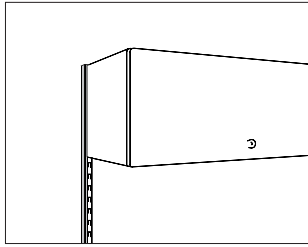

Specification Information

Step 1.

E1132.

Step 2. Height

64 64" high

80 80" high

Prices for Steps 1-2.

E1132.	64	\$139
	80	\$168

Step 3. Surface Finish

HF	inner tone light	+\$0
LU	soft white	+\$0
MT	medium tone	+\$0

Wall Start

E1210.

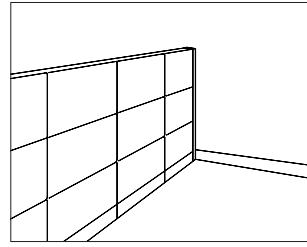

Specification Information

Step 1.

E1210.

Step 2. Height

30 30" high

38 38" high

46 46" high

54 54" high

62 62" high

70 70" high

86 86" high

Prices for Steps 1-2.

E1210.	30	\$312
	38	\$322
	46	\$323
	54	\$326
	62	\$357
	70	\$370
	86	\$405

Step 3. Surface Finish

HF	inner tone light	+\$0
LU	soft white	+\$0
MT	medium tone	+\$0

Wall Start Filler

E1212.

2-Way 90° Connector

E1220.

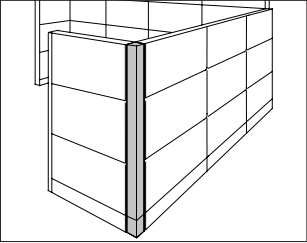
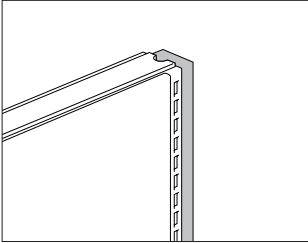

Specification Information	
Step 1.	
E1212.70	\$266

Specification Information	
Step 1.	
E1220.	

Step 2. Height	
30	30" high
38	38" high
46	46" high
54	54" high
62	62" high
70	70" high
86	86" high

Step 3. Surface Material	
S	vinyl
F	fabric

Step 4. Shape	
R	radius
S	square

Step 5. Power	
N	(N) nonpowered
E	(E) powered

Prices for Steps 1-5.						
			RN	RE	SN	SE
E1220.	30	S	\$397	470	419	486
		F	\$383	447	391	460
	38	S	\$436	504	452	519
		F	\$404	470	429	490
	46	S	\$463	536	484	552
		F	\$439	504	460	529
	54	S	\$493	567	519	587
		F	\$464	534	487	557
	62	S	\$520	596	542	608
		F	\$487	557	516	583
	70	S	\$542	612	569	639
		F	\$506	576	534	599
	86	S	\$608	684	640	707
		F	\$575	640	599	665

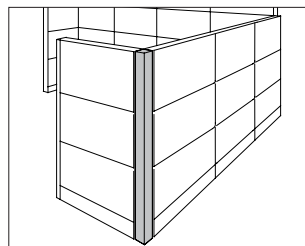

Step 6. Surface Finish

For vinyl (S)

See application chart and textiles list for fabric usage and numbers. First 2 digits of number indicate fabric line; remaining digit(s) indicate fabric color.

Vinyl-Textured Surface

HF	inner tone light	+\$0
LU	soft white	+\$0
MT	medium tone	+\$0

Step 7. Top Cap Finish

HF	inner tone light	+\$0
LU	soft white	+\$0
MT	medium tone	+\$0

Step 8. Cable Management Finish

HF	inner tone light	+\$0
LU	soft white	+\$0
MT	medium tone	+\$0

Step 9. Surface Finish

For fabric (F)

See application chart and textiles list for fabric usage and numbers. First 2 digits of number indicate fabric line; remaining digit(s) indicate fabric color.

Price Category 1	+\$0
Price Category 2	+\$7
Price Category 3	+\$20
Price Category 5	+\$42

Specification Information

Step 1.

E1224.

Step 2. Height

30	30" high
38	38" high
46	46" high
54	54" high
62	62" high
70	70" high
86	86" high

Step 3. Surface Material

SS	vinyl
VS	veneer squared radius

Step 4. Power

N	(N) nonpowered
E	(E) powered

Prices for Steps 1-4.

	N	E
E1224. 30 SS	\$419	486
VS	\$827	910
38 SS	\$452	519
VS	\$899	980
46 SS	\$484	552
VS	\$971	1060
54 SS	\$519	587
VS	\$1047	1131
62 SS	\$542	608
VS	\$1107	1189
70 SS	\$569	639
VS	\$1165	1246
86 SS	\$640	707
VS	\$1313	1392

Step 5. Surface Finish

Vinyl-Textured Surface

For vinyl (SS)

HF	inner tone light	+\$0
LU	soft white	+\$0
MT	medium tone	+\$0

2-Way 90° Connector, Monolithic

continued

Wood Veneer		
<i>For veneer squared radius (VS)</i>		
CHD	noble cherry	+\$55

Step 6. Top Cap Finish		
<i>For vinyl (SS)</i>		
HF	inner tone light	+\$0
LU	soft white	+\$0
MT	medium tone	+\$0

Spacer

E1222.

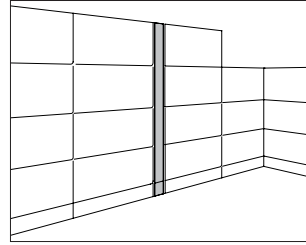

Specification Information

Step 1.

E1222.

Step 2. Height

30	30" high
38	38" high
46	46" high
54	54" high
62	62" high
70	70" high
86	86" high

Step 3. Surface Material

F	fabric
S	vinyl
V	veneer squared radius

Step 4. Power

N	(N) nonpowered
E	(E) powered

Prices for Steps 1-4.

		N	E
E1222.	30 F	\$436	502
	S	\$405	516
	V	\$868	946
	38 F	\$464	537
	S	\$474	549
	V	\$943	1019
	46 F	\$494	567
	S	\$506	581
	V	\$1002	1088
	54 F	\$529	598
	S	\$540	612
	V	\$1081	1158
	62 F	\$552	621
	S	\$566	638
	V	\$1140	1220
	70 F	\$575	646
	S	\$584	658
	V	\$1193	1276
	86 F	\$634	708
	S	\$653	722
	V	\$1339	1416

Step 5. Surface Finish

For vinyl (S)

HF	inner tone light	+\$0
LU	soft white	+\$0
MT	medium tone	+\$0
SG	slate grey	+\$0
WL	warm stone (CP)	+\$0
WN	warm grey neutral	+\$0

Wood Veneer

For veneer squared radius (V)

CHD	noble cherry	+\$63
------------	--------------	-------

Step 6. Surface Finish Side 2

For vinyl (S)

HF	inner tone light	+\$0
LU	soft white	+\$0
MT	medium tone	+\$0

Step 7. Top Cap Finish

For fabric (F) or vinyl (S)

HF	inner tone light	+\$0
LU	soft white	+\$0
MT	medium tone	+\$0

Step 8. Cable Management Finish

HF	inner tone light	+\$0
LU	soft white	+\$0
MT	medium tone	+\$0

Step 9. Surface Finish Side 1

For fabric (F)

See application chart and textiles list for fabric usage and numbers. First 2 digits of number indicate fabric line; remaining digit(s) indicate fabric color.

Price Category 1	+\$0
Price Category 2	+\$6
Price Category 3	+\$12
Price Category 5	+\$24

Step 10. Surface Finish Side 2

For fabric (F)

See application chart and textiles list for fabric usage and numbers. First 2 digits of number indicate fabric line; remaining digit(s) indicate fabric color.

Price Category 1	+\$0
Price Category 2	+\$6
Price Category 3	+\$12
Price Category 5	+\$24

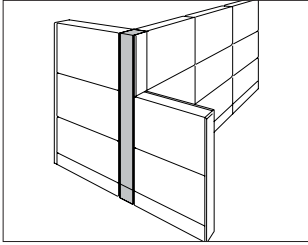
**Specification Information****Step 1.****E1230.****Step 2. Height**

30	30" high
38	38" high
46	46" high
54	54" high
62	62" high
70	70" high
86	86" high

Step 3. Surface Material

F	fabric
S	vinyl
V	veneer squared radius

Step 4. Power

N	(N) nonpowered
E	(E) powered

Prices for Steps 1-4.

	N	E
E1230. 30 F	\$540	604
S	\$529	596
V	\$879	958
38 F	\$581	646
S	\$569	634
V	\$985	1064
46 F	\$615	684
S	\$605	673
V	\$1051	1132
54 F	\$653	720
S	\$646	710
V	\$1114	1193
62 F	\$695	760
S	\$685	752
V	\$1201	1281
70 F	\$731	797
S	\$724	790
V	\$1286	1366
86 F	\$818	878
S	\$804	869
V	\$1447	1526

Step 5. Surface Finish**Vinyl-Textured Surface***For vinyl (S)*

HF	inner tone light	+\$0
LU	soft white	+\$0
MT	medium tone	+\$0

Wood Veneer*For veneer squared radius (V)*

CHD	noble cherry	+\$69
------------	--------------	-------

Step 6. Top Cap Finish*For fabric (F) or vinyl (S)*

HF	inner tone light	+\$0
LU	soft white	+\$0
MT	medium tone	+\$0

Step 7. Cable Management Finish

HF	inner tone light	+\$0
LU	soft white	+\$0
MT	medium tone	+\$0

Step 8. Surface Finish*For fabric (F)*

See application chart and textiles list for fabric usage and numbers. First 2 digits of number indicate fabric line; remaining digit(s) indicate fabric color.

Price Category 1	+\$0
Price Category 2	+\$7
Price Category 3	+\$16
Price Category 5	+\$25

3-Way 90° Connector, Monolithic

E1231.

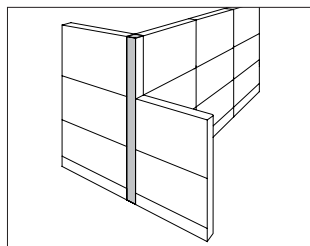

Specification Information

Step 1.

E1231.

Step 2. Height

30S	30" high
38S	38" high
46S	46" high
54S	54" high
62S	62" high
70S	70" high
86S	86" high

Step 3. Power

N	(N) nonpowered
E	(E) powered

Prices for Steps 1-3.

	N	E
E1231. 30S	\$564	624
38S	\$598	658
46S	\$640	705
54S	\$683	740
62S	\$724	786
70S	\$762	827
86S	\$834	914

Step 4. Surface Finish

Vinyl-Textured Surface

HF	inner tone light	+\$0
LU	soft white	+\$0
MT	medium tone	+\$0

Step 5. Top Cap Finish

HF	inner tone light	+\$0
LU	soft white	+\$0
MT	medium tone	+\$0

4-Way 90° Connector

E1240.

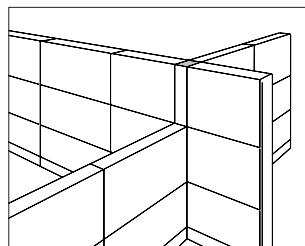

Specification Information

Step 1.

E1240.

Step 2. Height

30F	30" high
38F	38" high
46F	46" high
54F	54" high
62F	62" high
70F	70" high
86F	86" high

Step 3. Power

N	(N) nonpowered
E	(E) powered

Prices for Steps 1-3.

	N	E
E1240. 30F	\$577	662
38F	\$615	702
46F	\$654	742
54F	\$690	785
62F	\$728	819
70F	\$765	854
86F	\$847	947

Step 4. Top Cap Finish

NN	none	+\$0
HF	inner tone light	+\$0
LU	soft white	+\$0
MT	medium tone	+\$0

2-Way 90° Stacking Connector

E1220.

Spacer Stacking Connector

E1222.

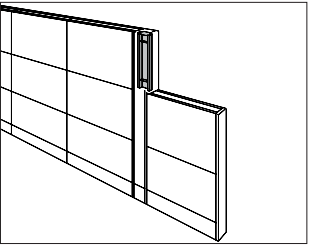
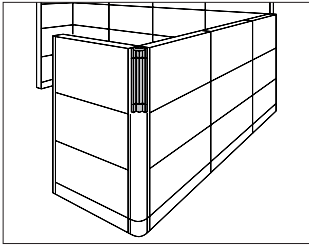

Specification Information	
Step 1.	
E1220.16	\$310

Specification Information	
Step 1.	
E1222.16	\$335

3-Way 90° Stacking Connector

E1230.

4-Way 90° Stacking Connector

E1240.

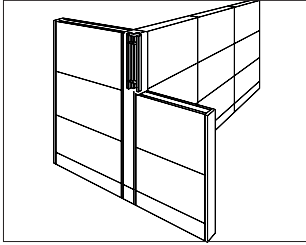

Specification Information

Step 1.

E1230.16

\$326

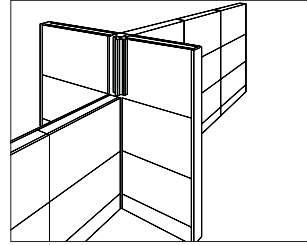

Specification Information

Step 1.

E1240.16

\$323

Stacking Frame Hardware Kit, Change of Height

E1293.
E1294.

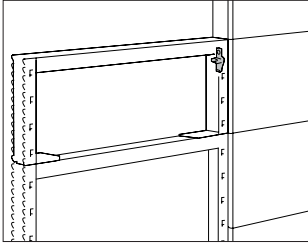

Specification Information

Step 1.

E129

Step 2. Connector Type

3. stacking frame to frame or 2-way 90° or 135° connector
4. stacking frame to spacer or 3- or 4-way 90° connector or 2-way 120° connector

Prices for Steps 1-2.

E1293.	\$43
E1294.	\$32

Bare Connector

E1219.

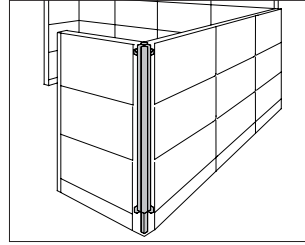

Specification Information

Step 1.

E1219.

Step 2. Height

30	30" high
38	38" high
46	46" high
54	54" high
62	62" high
70	70" high
86	86" high

Step 3. Configuration

- A 2-way 90° connector with draw rod
- B spacer
- C 3-way 90° connector

Prices for Steps 1-3.

	A	B	C
E1219. 30	\$247	311	370
38	\$269	326	382
46	\$297	345	404
54	\$322	367	436
62	\$344	384	462
70	\$368	402	492
86	\$391	418	559

2-Way 90° Connector Cover

E1270.

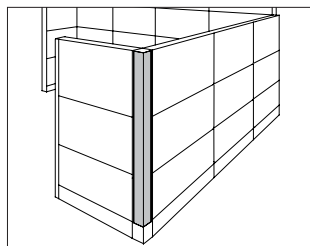

Specification Information

Step 1.

E1270.

Step 2. Height

30	30" high
38	38" high
46	46" high
54	54" high
62	62" high
70	70" high
86	86" high

Step 3. Surface Material

S	vinyl
F	fabric

Step 4. Shape

R	radius
S	square

Prices for Steps 1-4.

	R	S
E1270. 30 S	\$223	223
F	\$234	234
38 S	\$240	240
F	\$246	246
46 S	\$250	250
F	\$259	259
54 S	\$269	269
F	\$275	275
62 S	\$292	292
F	\$297	297
70 S	\$309	309
F	\$312	312
86 S	\$341	341
F	\$343	343

Step 5. Surface Finish

Vinyl-Textured Surface

For vinyl (S)

HF	inner tone light	+\$0
LU	soft white	+\$0
MT	medium tone	+\$0

For fabric (F)

Price Category 1	+\$0
Price Category 2	+\$10
Price Category 3	+\$20

Ethospace® Walls

2-Way 90° Connector Cover,
Monolithic

E1274.

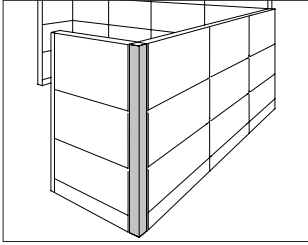

Specification Information

Step 1.

E1274.

Step 2. Height

30	30" high
38	38" high
46	46" high
54	54" high
62	62" high
70	70" high
86	86" high

Step 3. Surface Material

SS	vinyl
VS	veneer squared radius

Prices for Steps 1-3.

	SS	VS
E1274. 30	\$241	536
38	\$250	589
46	\$268	651
54	\$292	709
62	\$311	767
70	\$325	828
86	\$358	948

Step 4. Surface Finish

Vinyl-Textured Surface

For vinyl (SS)

HF	inner tone light	+\$0
LU	soft white	+\$0
MT	medium tone	+\$0

Wood Veneer

For veneer squared radius (VS)

CHD	noble cherry	+\$39
-----	--------------	-------

2-Way 90° Connector Cover,
Architectural

E1281.

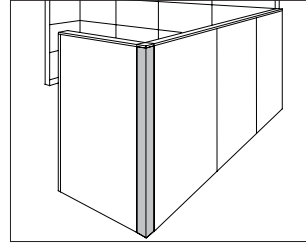

Specification Information

Step 1.

E1281.

Step 2. Height

30	30" high
38	38" high
46	46" high
54	54" high
62	62" high
70	70" high
86	86" high

Step 3. Surface Material

P	painted
F	fabric

Prices for Steps 1-3.

	P	F
E1281. 30	\$322	390
38	\$345	429
46	\$361	470
54	\$383	504
62	\$411	555
70	\$439	597
86	\$462	658

Step 4. Surface Finish

See application chart and textiles list for fabric usage and numbers. First 2 digits of number indicate fabric line; remaining digit(s) indicate fabric color.

For painted (P)

HF	inner tone light	+\$0
LU	soft white	+\$0
MT	medium tone	+\$0

For fabric (F)

Price Category 1	+\$0
Price Category 2	+\$10
Price Category 3	+\$20

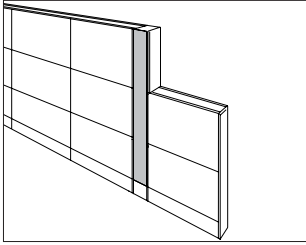
Specification Information
Step 1.
E1271.
Step 2. Height

30	30" high
38	38" high
46	46" high
54	54" high
62	62" high
70	70" high
86	86" high

Step 3. Surface Material

F	fabric
S	vinyl
V	veneer squared radius

Prices for Steps 1-3.

	F	S	V
E1271. 30	\$313	289	530
38	\$326	321	586
46	\$344	341	646
54	\$358	350	707
62	\$378	370	765
70	\$390	384	823
86	\$429	422	924

Step 4. Surface Finish
Vinyl-Textured Surface
For vinyl (S)

HF	inner tone light	+\$0
LU	soft white	+\$0
MT	medium tone	+\$0

Wood Veneer
For veneer squared radius (V)

CHD	noble cherry	+\$37
------------	--------------	-------

Step 5. Surface Finish Side 2
For vinyl (S)
Vinyl-Textured Surface

HF	inner tone light	+\$0
LU	soft white	+\$0
MT	medium tone	+\$0

Step 6. Surface Finish Side 1
For fabric (F)

See application chart and textiles list for fabric usage and numbers. First 2 digits of number indicate fabric line; remaining digit(s) indicate fabric color.

Price Category 1	+\$0
Price Category 2	+\$7
Price Category 3	+\$16
Price Category 5	+\$25

Step 7. Surface Finish Side 2
For fabric (F)

See application chart and textiles list for fabric usage and numbers. First 2 digits of number indicate fabric line; remaining digit(s) indicate fabric color.

Price Category 1	+\$0
Price Category 2	+\$7
Price Category 3	+\$16
Price Category 5	+\$25

Spacer/3-Way 90° Connector Cover, Architectural E1282.

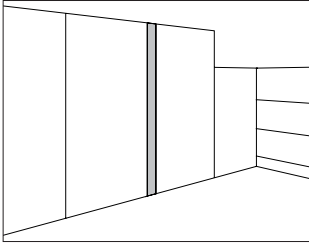

Specification Information

Step 1.

E1282.

Step 2. Height

30	30" high
38	38" high
46	46" high
54	54" high
62	62" high
70	70" high
86	86" high

Step 3. Surface Material

P	painted
F	fabric

Prices for Steps 1-3.

	P	F
E1282. 30	\$349	438
38	\$373	458
46	\$390	486
54	\$406	504
62	\$433	547
70	\$448	554
86	\$487	604

Step 4. Surface Finish

For painted (P)

HF	inner tone light	+\$0
LU	soft white	+\$0
MT	medium tone	+\$0

For fabric (F)

Price Category 1	+\$0
Price Category 2	+\$7
Price Category 3	+\$16

3-Way 90° Connector Cover E1272.

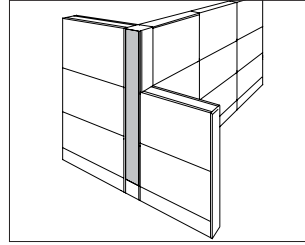

Specification Information

Step 1.

E1272.

Step 2. Height

30	30" high
38	38" high
46	46" high
54	54" high
62	62" high
70	70" high
86	86" high

Step 3. Surface Material

F	fabric
S	vinyl
V	veneer squared radius

Prices for Steps 1-3.

	F	S	V
E1272. 30	\$246	215	452
38	\$252	229	492
46	\$266	241	541
54	\$275	248	584
62	\$292	259	634
70	\$306	269	683
86	\$323	297	777

Step 4. Surface Finish

Vinyl-Textured Surface

For vinyl (S)

HF	inner tone light	+\$0
LU	soft white	+\$0
MT	medium tone	+\$0

For fabric (F)

Price Category 1	+\$0
Price Category 2	+\$7
Price Category 3	+\$16

Wood Veneer

For veneer squared radius (V)

CHD	noble cherry	+\$37
-----	--------------	-------

3-Way 90° Connector Cover, Monolithic

E1276.

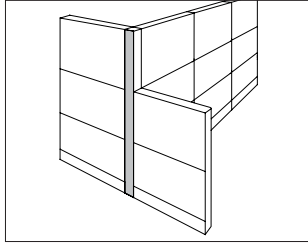

Specification Information

Step 1.

E1276.

Step 2. Height

30S	30" high
38S	38" high
46S	46" high
54S	54" high
62S	62" high
70S	70" high
86S	86" high

Prices for Steps 1-2.

E1276. 30S	\$240
38S	\$247
46S	\$260
54S	\$270
62S	\$292
70S	\$302
86S	\$323

Step 3. Surface Finish

Vinyl-Textured Surface

HF	inner tone light	+\$0
LU	soft white	+\$0
MT	medium tone	+\$0

Finished End

E1250.

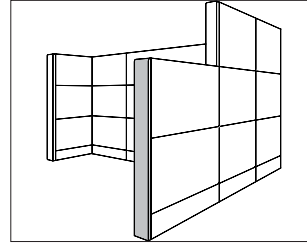

Specification Information

Step 1.

E1250.

Step 2. Height

30	30" high
38	38" high
46	46" high
54	54" high
62	62" high
70	70" high
86	86" high

Step 3. Shape

S	standard
A	painted architectural

Prices for Steps 1-3.

		S	A
E1250. 30		\$137	184
38		\$142	190
46		\$144	201
54		\$153	212
62		\$163	235
70		\$166	259
86		\$189	289

Step 4. Surface Finish

HF	inner tone light	+\$0
LU	soft white	+\$0
MT	medium tone	+\$0
WN	warm grey neutral	+\$0

Finished End, Change of Height

E1251.

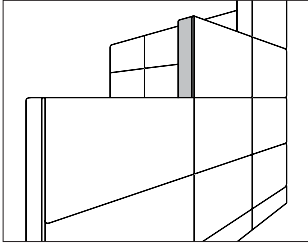

Specification Information

Step 1.

E1251.

Step 2. Height

08	8" high
16	16" high
24	24" high
32	32" high

Step 3. Shape

For 8" high (08), 16" high (16), 24" high (24), or 32" high (32)

A	paint architectural
S	standard
V	veneer squared radius

Prices for Steps 1-3.

	A	S	V
E1251. 08	\$139	105	302
16	\$164	111	348
24	\$189	129	383
32	\$201	137	425

Step 4. Surface Finish

For painted architectural (A) or standard (S)

HF	inner tone light	+\$0
LU	soft white	+\$0
MT	medium tone	+\$0
WN	warm grey neutral	+\$0

Wood Veneer

For veneer squared radius (V)

CHD	noble cherry	+\$17
-----	--------------	-------

Frame Top Cap

E1260.

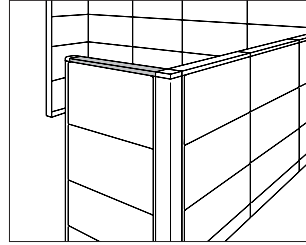

Specification Information

Step 1.

E1260.

Step 2. Width

24	24" wide
30	30" wide
36	36" wide
42	42" wide
48	48" wide

Step 3. Shape

For 24" wide (24), 30" wide (30), 36" wide (36), 42" wide (42), or 48" wide (48)

V	veneer squared radius
S	standard
A	paint architectural

Prices for Steps 1-3.

	V	S	A
E1260. 24	\$350	51	132
30	\$378	52	148
36	\$406	53	176
42	\$425	55	197
48	\$452	59	215

Step 4. Surface Finish

For standard (S) or painted architectural (A)

HF	inner tone light	+\$0
LU	soft white	+\$0
MT	medium tone	+\$0
WN	warm grey neutral	+\$0

Wood Veneer

For veneer squared radius (V)

CHD	noble cherry	+\$18
-----	--------------	-------

Connector Top Cap

E1261.

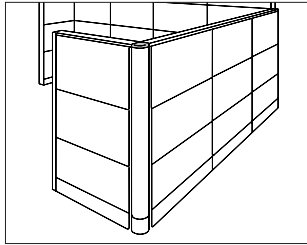

Specification Information

Step 1.

E1261.

Step 2. Configuration

- 1 spacer
- 2 2-way 90° radius-shaped connector
- 5 2-way 90° square-shaped connector
- 3 3-way 90° connector
- 4 4-way 90° connector

Step 3. Shape

For spacer (1), 2-way 90° radius-shaped connector (2), 3-way 90° connector (3), or 4-way 90° connector (4)

- A painted architectural
- S standard
- V veneer squared radius

For 2-way 90° square-shaped connector (5)

- S standard
- A painted architectural

Prices for Steps 1-3.

	A	S	V
E1261. 1	\$142	70	193
2	\$142	70	193
5	\$142	70	—
3	\$142	70	193
4	\$142	70	193

Step 4. Surface Finish

For standard (S)

- HF inner tone light +\$0
- LU soft white +\$0
- MT medium tone +\$0

For painted architectural (A)

- HF inner tone light +\$0
- LU soft white +\$0
- MT medium tone +\$0

Wood Veneer

For veneer squared radius (V)

- CHD noble cherry +\$10

Power Entry, External Direct Connect, 4 Circuit

E1322.

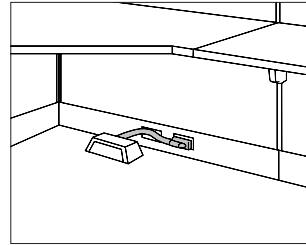

Specification Information

Step 1.

E1322.

Step 2. Length

- 06E 6' long
- 24E 24' long

Prices for Steps 1-2.

E1322. 06E	\$327
24E	\$676

Power Entry, Internal Direct Connect, 4 Circuit E1325.

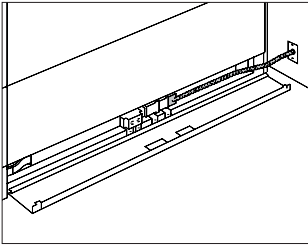

Specification Information	
Step 1.	
E1325.6E	\$362

Base Power Entry, Junction Box, 4 Circuit E1323.

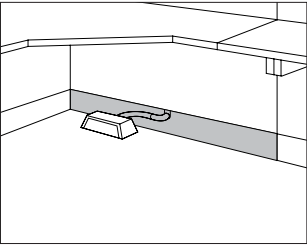

Specification Information	
Step 1.	
E132	

Step 2. Base Option	
3.	plain base

Step 3. Width	
24E	24" wide
30E	30" wide
36E	36" wide
42E	42" wide
48E	48" wide

Prices for Steps 1-3.	
E1323. 24E	\$665
30E	\$695
36E	\$719
42E	\$768
48E	\$818

Step 4. Surface Finish	
HF	inner tone light +\$0
LU	soft white +\$0
MT	medium tone +\$0

Ceiling Power Entry, Internal Direct Connect

E1331.

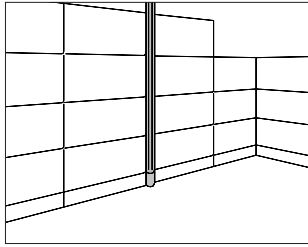

Specification Information

Step 1.

E1331.

Step 2. Height

46	46" high
54	54" high
62	62" high
70	70" high
86	86" high

Step 3. Attachment

C connector- or frame-attached

Step 4. Power

N	(N) nonpowered
E	(E) 4-circuit power

Prices for Steps 1-4.

	N	E
E1331. 46 C	\$983	1556
54 C	\$1038	1612
62 C	\$1081	1655
70 C	\$1119	1692
86 C	\$1205	1777

Step 5. Surface Finish

HF	inner tone light	+\$0
LU	soft white	+\$0
MT	medium tone	+\$0

Step 6. Cable Management Finish

HF	inner tone light	+\$0
LU	soft white	+\$0
MT	medium tone	+\$0

Baseline Harness, 4 Circuit

E1354.
E1355.

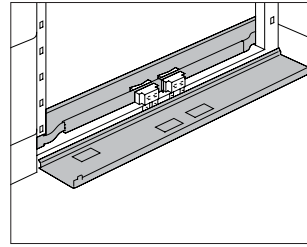

Specification Information

Step 1.

E135

Step 2. Side Covers

4.	no side covers
5.	side covers

Step 3. Frame Width

24	24" wide
30	30" wide
36	36" wide
42	42" wide
48	48" wide

Step 4. Power Connection

For no side covers (4.) with 24" wide (24), 30" wide (30), 36" wide (36), or 42" wide (42)

E standard

For no side covers (4.) with 48" wide (48)

E standard

For side covers (5.)

E standard

Prices for Steps 1-4.

	E
E1354. 24	\$250
30	\$265
36	\$272
42	\$293
48	\$309
E1355. 24	\$433
30	\$433
36	\$433
42	\$444
48	\$444

Step 5. Cable Management Finish

For side covers (5.)

HF	inner tone light	+\$0
LU	soft white	+\$0
MT	medium tone	+\$0

Pass-Through Harness, Frame

E1342.

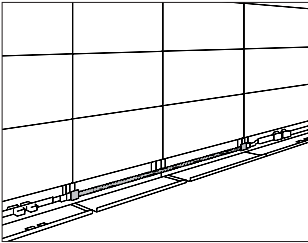

Specification Information	
Step 1.	
E1342.	

Step 2. Length	
24E	24" long
30E	30" long
36E	36" long
42E	42" long
48E	48" long

Prices for Steps 1-2.		
E1342.	24E	\$258
	30E	\$269
	36E	\$284
	42E	\$302
	48E	\$314

Pass-Through Harness, Connector

E1356.

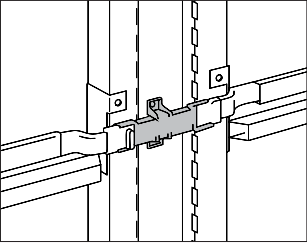

Specification Information	
Step 1.	
E1356.	

Step 2. Configuration	
AE	2-way 90° connector
BE	spacer
CE	3-way 90° connector
DE	4-way 90° connector

Prices for Steps 1-2.		
E1356.	AE	\$368
	BE	\$383
	CE	\$391
	DE	\$404

Beltline Harness, 4 Circuit

E1353.

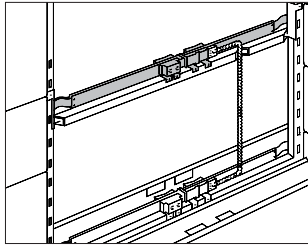

Specification Information

Step 1.

E1353.

Step 2. Frame Width

24	24"-wide frame
30	30"-wide frame
36	36"-wide frame
42	42"-wide frame
48	48"-wide frame

Step 3. Power Connection

For 24"-wide frame (24), 30"-wide frame (30), 36"-wide frame (36), or 42"-wide frame (42)

E standard

For 48"-wide frame (48)

E standard

Prices for Steps 1-3.

	E
E1353. 24	\$368
30	\$383
36	\$390
42	\$402
48	\$411

Tile-Height Harness, 4 Circuit

E1357.

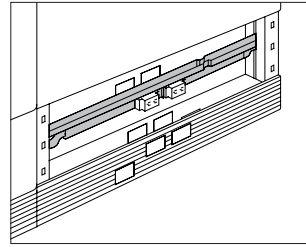

Specification Information

Step 1.

E1357.

Step 2. Frame Width

24E	24"-wide frame
30E	30"-wide frame
36E	36"-wide frame
42E	42"-wide frame
48E	48"-wide frame

Prices for Steps 1-2.

E1357. 24E	\$368
30E	\$383
36E	\$390
42E	\$402
48E	\$411

Power Jumper, 4 Circuit

E1341.

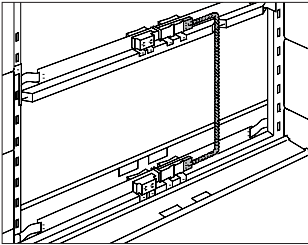

Specification Information

Step 1.
E1341.

Step 2. Configuration

- 3E 4th 8" tile above base
- 5E 6th 8" tile above base

Prices for Steps 1-2.

E1341. 3E	\$208
5E	\$248

Baseline Box Assembly, H-Style Frame

EW400.

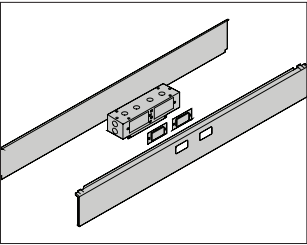

Specification Information

Step 1.
EW400.

Step 2. Width

- 24 24" wide
- 30 30" wide
- 36 36" wide
- 42 42" wide
- 48 48" wide

Prices for Steps 1-2.

EW400. 24	\$436
30	\$448
36	\$464
42	\$486
48	\$520

Step 3. Bezel Finish

HF	inner tone light	+\$0
LU	soft white	+\$0
MT	medium tone	+\$0

Receptacle, 4 Circuit, 15 Amp

E1311.

Connect™-S300

Y1323.

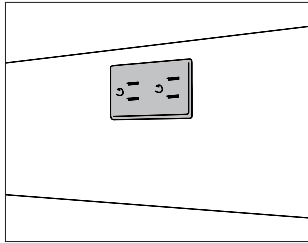

Specification Information

Step 1.

E1311.

Step 2. Type

A	duplex, circuit a
B	duplex, circuit b
C	duplex, circuit c
DN	duplex, circuit d
BI	duplex, circuit b, isolated ground
CI	duplex, circuit c, isolated ground
D	duplex, circuit d, isolated ground
CS	duplex, 3 circuit, circuit c, isolated ground

Prices for Steps 1-2.

E1311. A	\$370
B	\$370
C	\$370
DN	\$370
BI	\$370
CI	\$370
D	\$370
CS	\$370

Step 3. Surface Finish

HF	inner tone light	+\$0
LU	soft white	+\$0
MT	medium tone	+\$0

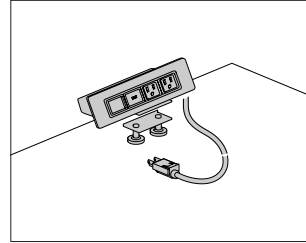

Specification Information

Step 1.

Y1323.

Step 2. Configuration

3	2 simplex receptacles, 2 data openings
4	3 simplex receptacles, 3 data openings
5	2 simplex receptacles, 1 data opening, 1 charging USB port
6	3 simplex receptacles, 2 data opening, 1 charging USB port

Step 3. Power Type

A	power cord with plug end
B	conduit with open end, for hard-wiring

Step 4. Cord/Conduit Length

03	3' cord/conduit
06	6' cord/conduit
10	10' cord/conduit
20	20' cord/conduit

Step 5. Attachment

G	grommet mount
S	surface clamp

Prices for Steps 1-5.

			03G	03S	06G	06S	10G	10S
Y1323. 3	A		\$415	415	415	415	433	433
	B		\$493	493	493	493	510	510
	4	A	\$517	517	517	517	530	530
		B	\$599	599	599	599	613	613
	5	A	\$580	580	580	580	597	597
		B	\$662	662	662	662	674	674
	6	A	\$681	681	681	681	699	699
		B	\$764	764	764	764	778	778
							20G	20S
Y1323. 3	A						\$504	504
	B						\$578	578
	4	A					\$606	606
		B					\$681	681
	5	A					\$668	668
		B					\$773	773
	6	A					\$768	768
		B					\$879	879

Ethospace® Walls

Step 6. Finish		
0H	black	+\$0
0I	silver	+\$0
0J	white	+\$0

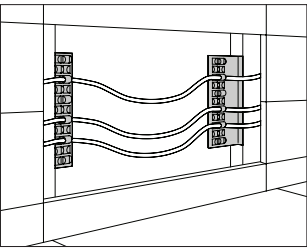

Specification Information	
Step 1.	
E1396.	\$144

Communication Port Faceplate
Reducer

G1189.

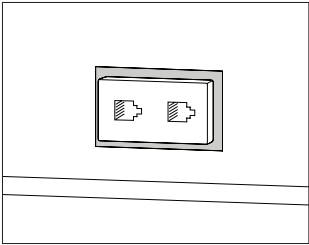

Specification Information

Step 1.

G1189.A

\$84

Communication Port Faceplate
Extender

G1189.

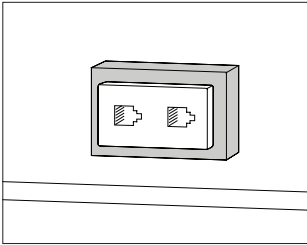

Specification Information

Step 1.

G1189.B

\$111

Step 2. Surface Finish

8Q	folkstone grey (CP)	+\$0
CL	cool grey neutral	+\$0
HF	inner tone light	+\$0
MT	medium tone	+\$0
WL	warm stone (CP)	+\$0
WN	warm grey neutral	+\$0

Beltline Bezel, H-Style Frame

G1510.

Face Tile

E1420.

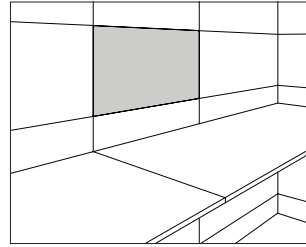
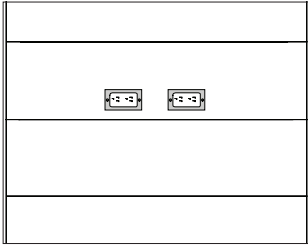

Ethospace® Walls

Specification Information

Step 1.

G1510. \$93

Step 2. Surface Finish

HF	inner tone light	+\$0
LU	soft white	+\$0
MT	medium tone	+\$0

Specification Information

Step 1.

E1420.

Step 2. Height

08	8" high
16	16" high
24	24" high

Step 3. Width

For 8" high (08), 16" high (16), or 24" high (24)

24	24" wide
30	30" wide
36	36" wide
42	42" wide
48	48" wide

Step 4. Surface Material

For 8" high (08) with 24" wide (24), 30" wide (30), 36" wide (36), 42" wide (42), or 48" wide (48)

P	painted
F	fabric

For 16" high (16)

P	painted
F	fabric

For 24" high (24)

P	painted
F	fabric

Prices for Steps 1-4.

		P	F
E1420.	08 24	\$95	125
	30	\$100	131
	36	\$107	147
	42	\$123	169
	48	\$129	179
	16 24	\$102	165
	30	\$108	173
	36	\$119	192
	42	\$133	203
	48	\$141	221

Face Tile *continued*

Floor-Length Face Tile

E1420.

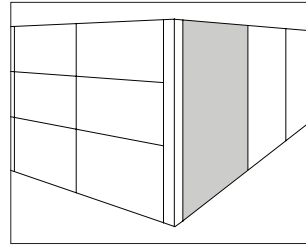

Ethospace® Walls

24	24	\$164	199
30		\$173	214
36		\$186	240
42		\$201	250
48		\$221	272

Step 5. Surface Finish

For 8" high (08) with painted (P)

HF	inner tone light	+\$0
LU	soft white	+\$0
MT	medium tone	+\$0

For 16" high (16) with painted (P)

HF	inner tone light	+\$0
LU	soft white	+\$0
MT	medium tone	+\$0

For 24" high (24) with painted (P)

HF	inner tone light	+\$0
LU	soft white	+\$0
MT	medium tone	+\$0

For 8" high (08) with fabric (F)

Price Category 1	+\$0
Price Category 2	+\$6
Price Category 3	+\$11

For 16" high (16) with fabric (F)

Price Category 1	+\$0
Price Category 2	+\$18
Price Category 3	+\$30

For 24" high (24) with fabric (F)

Price Category 1	+\$0
Price Category 2	+\$25
Price Category 3	+\$44

Specification Information

Step 1.

E1420.

Step 2. Height

22	22" high
30	30" high

Step 3. Width

24	24" wide
30	30" wide
36	36" wide
42	42" wide
48	48" wide

Step 4. Surface Material

P	painted
F	fabric

Prices for Steps 1-4.

	P	F
E1420. 22 24	\$184	201
30	\$198	214
36	\$211	234
42	\$220	246
48	\$246	270
30 24	\$193	211
30	\$214	241
36	\$240	259
42	\$258	281
48	\$275	311

Step 5. Surface Finish

For 22" high (22) with painted (P)

HF	inner tone light	+\$0
LU	soft white	+\$0
MT	medium tone	+\$0

For 30" high (30) with painted (P)

HF	inner tone light	+\$0
LU	soft white	+\$0
MT	medium tone	+\$0

For 22" high (22) with fabric (F)

Price Category 1	+\$0
Price Category 2	+\$18
Price Category 3	+\$30

For 30" high (30) with fabric (F)

Price Category 1	+\$0
Price Category 2	+\$25
Price Category 3	+\$44

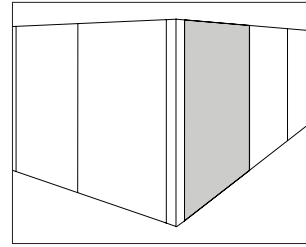

Specification Information

Step 1.

E1445.

Step 2. Height

16	16" high
24	24" high
30	30" high
32	32" high

Step 3. Width

24F	24" wide
30F	30" wide
36F	36" wide
42F	42" wide
48F	48" wide

Prices for Steps 1-3.

	24F	30F	36F	42F	48F
E1445. 16	\$281	297	312	325	339
24	\$339	357	381	392	419
30	\$383	411	430	452	476
32	\$416	442	463	484	515

Step 4. Surface Finish

See application chart and textiles list for fabric usage and numbers. First 2 digits of number indicate fabric line; remaining digit(s) indicate fabric color.

For 16" high (16)

Price Category 1	+\$0
Price Category 2	+\$18
Price Category 3	+\$30

For 24" high (24) or 30" high (30)

Price Category 1	+\$0
Price Category 2	+\$25
Price Category 3	+\$44

For 32" high (32)

Price Category 1	+\$0
Price Category 2	+\$34
Price Category 3	+\$59

Tackable Tile

E1422.

Cable Access Tile

E1436.

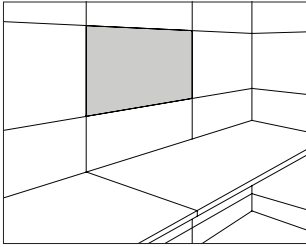

Specification Information

Step 1.

E1422.16

Step 2. Width

24	24" wide
30	30" wide
36	36" wide
42	42" wide
48	48" wide

Prices for Steps 1-2.

E1422.16	24	\$201
	30	\$221
	36	\$247
	42	\$281
	48	\$310

Step 3. Surface Finish

See application chart and textiles list for fabric usage and numbers. First 2 digits of number indicate fabric line; remaining digit(s) indicate fabric color.

Price Category 1	+\$0
Price Category 2	+\$18
Price Category 3	+\$30

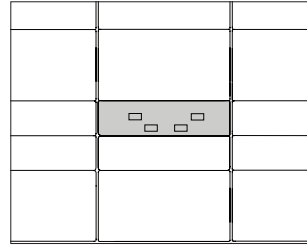

Specification Information

Step 1.

E1436.08

Step 2. Width

24	24" wide
30	30" wide
36	36" wide
42	42" wide
48	48" wide

Step 3. Surface Material

P	painted
F	fabric

Prices for Steps 1-3.

		P	F
E1436.08	24	\$186	214
	30	\$220	250
	36	\$230	266
	42	\$245	286
	48	\$252	301

Step 4. Receptacle Filler Finish

HF	inner tone light	+\$0
LU	soft white	+\$0
MT	medium tone	+\$0

Step 5. Surface Finish

For painted (P)

HF	inner tone light	+\$0
LU	soft white	+\$0
MT	medium tone	+\$0

For fabric (F)

Price Category 1	+\$0
Price Category 2	+\$6
Price Category 3	+\$12

Cable Channel Tile

E1433.

Open Tile

E1440.

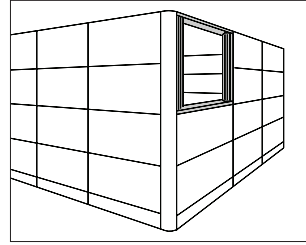
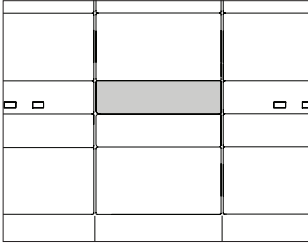

Ethospace® Walls

Specification Information

Step 1.

E1433.08

Step 2. Width

24	24" wide
30	30" wide
36	36" wide
42	42" wide
48	48" wide

Step 3. Surface Material

P	printed
F	fabric

Prices for Steps 1-3.

		P	F
E1433.08	24	\$173	199
	30	\$202	245
	36	\$215	252
	42	\$235	272
	48	\$246	295

Step 4. Surface Finish

For painted (P)

HF	inner tone light	+\$0
LU	soft white	+\$0
MT	medium tone	+\$0

For fabric (F)

Price Category 1	+\$0
Price Category 2	+\$6
Price Category 3	+\$12

Specification Information

Step 1.

E1440.

Step 2. Height

16	16" high
-----------	----------

Step 3. Width

24	24" wide
30	30" wide
36	36" wide
42	42" wide
48	48" wide

Step 4. Tile Position

For 16" high (16)

T	top
M	middle/bottom

Prices for Steps 1-4.

		T	M
E1440. 16	24	\$378	302
	30	\$442	358
	36	\$491	391
	42	\$528	427
	48	\$575	462

Step 5. Frame Finish

HF	inner tone light	+\$0
LU	soft white	+\$0
MT	medium tone	+\$0

Open Tile, Squared Stile

E1444.

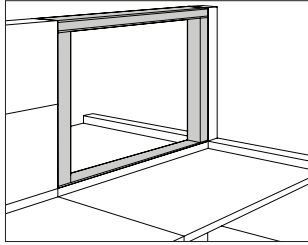

Specification Information

Step 1.

E1444.

Step 2. Height

16	16" high
32	32" high
48	48" high

Step 3. Width

24	24" wide
30	30" wide
36	36" wide
42	42" wide
48	48" wide

Step 4. Tile Position

T	top
M	middle/bottom

Prices for Steps 1-4.

		T	M
E1444.	16 24	\$380	281
	30	\$440	331
	36	\$490	362
	42	\$529	392
	48	\$575	427
	32 24	\$504	381
	30	\$576	430
	36	\$634	476
	42	\$687	516
	48	\$747	566
	48 24	\$639	480
	30	\$696	520
	36	\$762	575
	42	\$830	616
	48	\$890	665

Step 5. Frame Finish

HF	inner tone light	+\$0
LU	soft white	+\$0
MT	medium tone	+\$0

Perforated Tile, Squares

E1441.

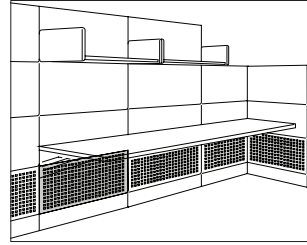

Specification Information

Step 1.

E1441.

Step 2. Height

16	16" high
----	----------

Step 3. Width

24P	24" wide
30P	30" wide
36P	36" wide
42P	42" wide
48P	48" wide

Prices for Steps 1-3.

	24P	30P	36P	42P	48P
E1441. 16	\$130	139	163	171	186

Step 4. Surface Finish

HF	inner tone light	+\$0
LU	soft white	+\$0
MT	medium tone	+\$0

Rail Tile

E1425.

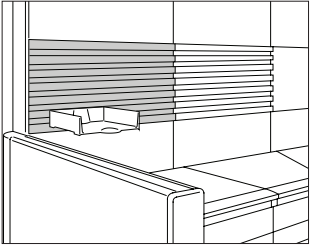

Specification Information

Step 1.
E1425.

Step 2. Height

16 16" high

Step 3. Width

24 24" wide
30 30" wide
36 36" wide
42 42" wide
48 48" wide

Prices for Steps 1-3.

	24	30	36	42	48
E1425. 16	\$325	361	391	435	463

Step 4. Surface Finish

HF inner tone light +\$0
LU soft white +\$0
MT medium tone +\$0

Tool Bar

E3610.

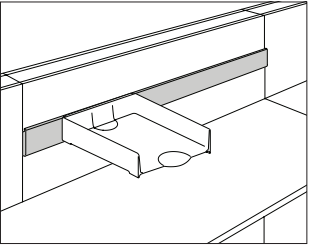

Specification Information

Step 1.
E3610.

Step 2. Width

24 24" wide
30 30" wide
36 36" wide
42 42" wide
48 48" wide

Prices for Steps 1-2.

E3610. 24	\$125
30	\$142
36	\$164
42	\$176
48	\$193

Step 3. Surface Finish

HF inner tone light +\$0
LU soft white +\$0
MT medium tone +\$0

Marker/Eraser Holder

Y7231.

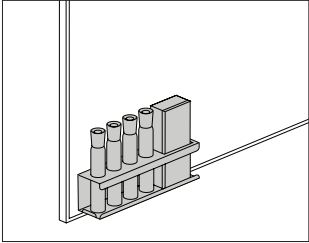

Specification Information		
Step 1.		
Y7231.		\$191
Step 2. Finish		
613	silver (CP)	+\$0
UBK	ultra black (CP)	+\$0
91	white (CP)	+\$0
BK	black	+\$0

Rectangular Surface

EWS10.

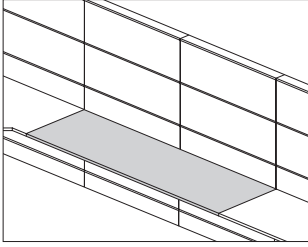

Ethospace® Work Surfaces

Specification Information

Step 1.

EW

Step 2. Edge

S10. squared-edge

Step 3. Depth

For squared-edge (S10.)

24 24" deep

30 30" deep

Step 4. Width

24 24" wide

30 30" wide

36 36" wide

42 42" wide

48 48" wide

60 60" wide

66 66" wide

72 72" wide

Step 5. Surface Material

For squared-edge (S10.)

L high-pressure laminate top/thermoplastic edge

Step 6. Attachment

For 24" deep (24) or 30" deep (30) with 24" wide (24), 30" wide (30), 66" wide (66), or 72" wide (72)

F Ethospace® frame attached surface

For 24" deep (24) or 30" deep (30) with 36" wide (36), 42" wide (42), 48" wide (48), or 60" wide (60)

D surface attachment bracket

F Ethospace® frame attached surface

Prices for Steps 1-6.

		LD	LF
EWS10. 24	24	—	\$307
	30	—	\$349
	36	\$468	402
	42	\$498	442
	48	\$528	491
	60	\$686	653
	66	—	\$710
	72	—	\$765
30	24	—	\$336
	30	—	\$429
	36	\$528	499
	42	\$561	567
	48	\$624	601
	60	\$802	765
	66	—	\$808
	72	—	\$902

Step 7. Top Finish

76	light brown walnut	+\$0
8Q	folkstone grey (CP)	+\$0
91	white (CP)	+\$0
98	studio white (CP)	+\$0
CL	cool grey neutral	+\$0
HF	inner tone light	+\$0
HP	light anigre	+\$0
LBA	clear on ash (CP)	+\$0
LBR	phantom ecru	+\$0
LBS	phantom cocoa	+\$0
LBU	medium matte walnut (CP)	+\$0
LBV	warm grey teak	+\$0
LBB	oak on ash (CP)	+\$0
LBC	walnut on ash (CP)	+\$0
LBF	neutral twill	+\$0
LBJ	graphite twill	+\$0
LBQ	white twill	+\$0
LT	light tone	+\$0
LU	soft white	+\$0
WL	warm stone (CP)	+\$0
WN	warm grey neutral	+\$0

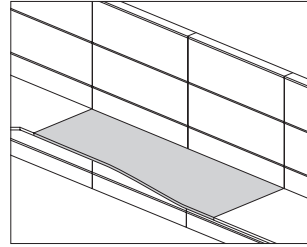

Step 8. Edge Finish

76	light brown walnut	+\$0
8Q	folkstone grey (CP)	+\$0
91	white (CP)	+\$0
98	studio white (CP)	+\$0
CL	cool grey neutral	+\$0
HF	inner tone light	+\$0
HP	light anigre	+\$0
LBA	clear on ash (CP)	+\$0
LBR	phantom ecru	+\$0
LBS	phantom cocoa	+\$0
LBU	medium matte walnut (CP)	+\$0
LBV	warm grey teak	+\$0
LBB	oak on ash (CP)	+\$0
LBC	walnut on ash (CP)	+\$0
LBF	neutral twill	+\$0
LBJ	graphite twill	+\$0
LBQ	white twill	+\$0
LU	soft white	+\$0
WL	warm stone (CP)	+\$0
WN	warm grey neutral	+\$0

Specification Information

Step 1.

EW

Step 2. Edge

S12. squared-edge

Step 3. Depth

24	24" deep left, 30" deep right
30	30" deep left, 24" deep right

Step 4. Width

30	30" wide
36	36" wide
42	42" wide
48	48" wide
60	60" wide

Step 5. Surface Material

For squared-edge (S12.)

L high-pressure laminate top/thermoplastic edge

Step 6. Attachment

F Ethospace® frame attached surface

Prices for Steps 1-6.

	LF
EWS12. 24 30	\$470
36	\$500
42	\$585
48	\$672
60	\$700
30 30	\$470
36	\$500
42	\$585
48	\$672
60	\$700

Step 7. Top Finish

76	light brown walnut	+\$0
8Q	folkstone grey (CP)	+\$0
91	white (CP)	+\$0
98	studio white (CP)	+\$0
CL	cool grey neutral	+\$0
HF	inner tone light	+\$0
HP	light anigre	+\$0
LBA	clear on ash (CP)	+\$0
LBR	phantom ecru	+\$0
LBS	phantom cocoa	+\$0
LBU	medium matte walnut (CP)	+\$0
LBV	warm grey teak	+\$0
LBB	oak on ash (CP)	+\$0
LBC	walnut on ash (CP)	+\$0
LBF	neutral twill	+\$0
LBJ	graphite twill	+\$0
LBQ	white twill	+\$0
LT	light tone	+\$0
LU	soft white	+\$0
WL	warm stone (CP)	+\$0
WN	warm grey neutral	+\$0

Step 8. Edge Finish

76	light brown walnut	+\$0
8Q	folkstone grey (CP)	+\$0
91	white (CP)	+\$0
98	studio white (CP)	+\$0
CL	cool grey neutral	+\$0
HF	inner tone light	+\$0
HP	light anigre	+\$0
LBA	clear on ash (CP)	+\$0
LBR	phantom ecru	+\$0
LBS	phantom cocoa	+\$0
LBU	medium matte walnut (CP)	+\$0
LBV	warm grey teak	+\$0
LBB	oak on ash (CP)	+\$0
LBC	walnut on ash (CP)	+\$0
LBF	neutral twill	+\$0
LBJ	graphite twill	+\$0
LBQ	white twill	+\$0
LU	soft white	+\$0
WL	warm stone (CP)	+\$0
WN	warm grey neutral	+\$0

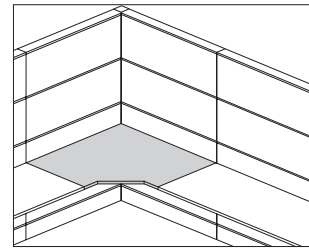

Specification Information

Step 1.

EW

Step 2. Edge

S20. squared-edge

Step 3. Depth

24 24" deep

30 30" deep

Step 4. Width

For 24" deep (24)

36 36" wide

42 42" wide

48 48" wide

For 30" deep (30)

42 42" wide

48 48" wide

Step 5. Surface Material

For squared-edge (S20.)

L high-pressure laminate top/thermoplastic edge

Step 6. Attachment

F Ethospace® frame attached surface

Prices for Steps 1-6.

	LF
EWS20. 24 36	\$520
42	\$641
48	\$758
30 42	\$799
48	\$901

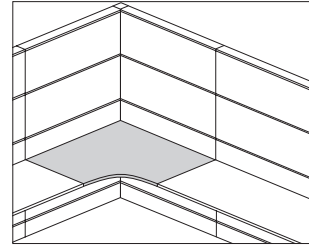

Step 7. Top Finish

76	light brown walnut	+\$0
8Q	folkstone grey (CP)	+\$0
91	white (CP)	+\$0
98	studio white (CP)	+\$0
CL	cool grey neutral	+\$0
HF	inner tone light	+\$0
HP	light anigre	+\$0
LBA	clear on ash (CP)	+\$0
LBR	phantom ecru	+\$0
LBS	phantom cocoa	+\$0
LBU	medium matte walnut (CP)	+\$0
LBV	warm grey teak	+\$0
LBB	oak on ash (CP)	+\$0
LBC	walnut on ash (CP)	+\$0
LBF	neutral twill	+\$0
LBJ	graphite twill	+\$0
LBQ	white twill	+\$0
LT	light tone	+\$0
LU	soft white	+\$0
WL	warm stone (CP)	+\$0
WN	warm grey neutral	+\$0

Step 8. Edge Finish

76	light brown walnut	+\$0
8Q	folkstone grey (CP)	+\$0
91	white (CP)	+\$0
98	studio white (CP)	+\$0
CL	cool grey neutral	+\$0
HF	inner tone light	+\$0
HP	light anigre	+\$0
LBA	clear on ash (CP)	+\$0
LBR	phantom ecru	+\$0
LBS	phantom cocoa	+\$0
LBU	medium matte walnut (CP)	+\$0
LBV	warm grey teak	+\$0
LBB	oak on ash (CP)	+\$0
LBC	walnut on ash (CP)	+\$0
LBF	neutral twill	+\$0
LBJ	graphite twill	+\$0
LBQ	white twill	+\$0
LU	soft white	+\$0
WL	warm stone (CP)	+\$0
WN	warm grey neutral	+\$0

Specification Information

Step 1.

EW

Step 2. Edge

S21. squared-edge

Step 3. Depth

24 24" deep

30 30" deep

Step 4. Width

For 24" deep (24)

36 36" wide

42 42" wide

48 48" wide

For 30" deep (30)

42 42" wide

48 48" wide

Step 5. Surface Material

For squared-edge (S21.)

L high-pressure laminate top/thermoplastic edge

Step 6. Attachment

F Ethospace® frame attached surface

Prices for Steps 1-6.

	LF
EWS21. 24 36	\$520
42	\$641
48	\$758
30 42	\$799
48	\$901

Step 7. Top Finish

LU	soft white	+\$0
76	light brown walnut	+\$0
8Q	folkstone grey (CP)	+\$0
91	white (CP)	+\$0
98	studio white (CP)	+\$0
CL	cool grey neutral	+\$0
HF	inner tone light	+\$0
HP	light anigre	+\$0
LBA	clear on ash (CP)	+\$0
LBR	phantom ecru	+\$0
LBS	phantom cocoa	+\$0
LBU	medium matte walnut (CP)	+\$0
LBV	warm grey teak	+\$0
LBB	oak on ash (CP)	+\$0
LBC	walnut on ash (CP)	+\$0
LBF	neutral twill	+\$0
LBJ	graphite twill	+\$0
LBQ	white twill	+\$0
LT	light tone	+\$0
WL	warm stone (CP)	+\$0
WN	warm grey neutral	+\$0

Step 8. Edge Finish

76	light brown walnut	+\$0
8Q	folkstone grey (CP)	+\$0
91	white (CP)	+\$0
98	studio white (CP)	+\$0
CL	cool grey neutral	+\$0
HF	inner tone light	+\$0
HP	light anigre	+\$0
LBA	clear on ash (CP)	+\$0
LBR	phantom ecru	+\$0
LBS	phantom cocoa	+\$0
LBU	medium matte walnut (CP)	+\$0
LBV	warm grey teak	+\$0
LBB	oak on ash (CP)	+\$0
LBC	walnut on ash (CP)	+\$0
LBF	neutral twill	+\$0
LBJ	graphite twill	+\$0
LBQ	white twill	+\$0
LU	soft white	+\$0
WL	warm stone (CP)	+\$0
WN	warm grey neutral	+\$0

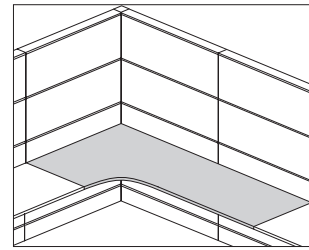

Specification Information

Step 1.

EW

Step 2. Edge

S22. squared-edge, 24" deep

Step 3. Width

4260	42" wide left x 60" wide right
4872	48" wide left x 72" wide right
6042	60" wide left x 42" wide right
7248	72" wide left x 48" wide right

Step 4. Surface Material

For squared-edge, 24" deep (S22.)

L high-pressure laminate top/thermoplastic edge

Step 5. Attachment

F Ethospace® frame attached surface

Prices for Steps 1-5.

	F
EWS22. 4260 L	\$1208
4872 L	\$1392
6042 L	\$1208
7248 L	\$1433

Extended Corner Surface,
Rectangular End *continued*

Squared-Edge Corner Wedge

Y2091.

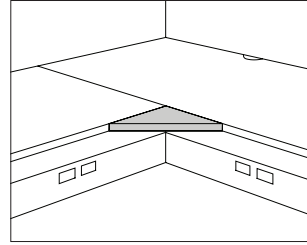

Step 6. Top Finish

76	light brown walnut	+\$0
8Q	folkstone grey (CP)	+\$0
91	white (CP)	+\$0
98	studio white (CP)	+\$0
CL	cool grey neutral	+\$0
HF	inner tone light	+\$0
HP	light anigre	+\$0
LBA	clear on ash (CP)	+\$0
LBR	phantom ecru	+\$0
LBS	phantom cocoa	+\$0
LBU	medium matte walnut (CP)	+\$0
LBV	warm grey teak	+\$0
LBB	oak on ash (CP)	+\$0
LBC	walnut on ash (CP)	+\$0
LBF	neutral twill	+\$0
LBJ	graphite twill	+\$0
LBQ	white twill	+\$0
LT	light tone	+\$0
LU	soft white	+\$0
WL	warm stone (CP)	+\$0
WN	warm grey neutral	+\$0

Step 7. Edge Finish

76	light brown walnut	+\$0
8Q	folkstone grey (CP)	+\$0
91	white (CP)	+\$0
98	studio white (CP)	+\$0
CL	cool grey neutral	+\$0
HF	inner tone light	+\$0
HP	light anigre	+\$0
LBA	clear on ash (CP)	+\$0
LBR	phantom ecru	+\$0
LBS	phantom cocoa	+\$0
LBU	medium matte walnut (CP)	+\$0
LBV	warm grey teak	+\$0
LBB	oak on ash (CP)	+\$0
LBC	walnut on ash (CP)	+\$0
LBF	neutral twill	+\$0
LBJ	graphite twill	+\$0
LBQ	white twill	+\$0
LU	soft white	+\$0
WL	warm stone (CP)	+\$0
WN	warm grey neutral	+\$0

Specification Information

Step 1.

Y2091.

Step 2. Surface Material

L	high-pressure laminate top/thermoplastic edge
U	high-pressure laminate/universal edge

Prices for Steps 1-2.

Y2091. L	\$180
U	\$171

Step 3. Top Finish

125	natural maple (CP)	+\$0
126	natural cherry (CP)	+\$0
127	walnut (CP)	+\$0
139	light ash (CP)	+\$0
140	warm ash (CP)	+\$0
UBK	ultra black (CP)	+\$0
76	light brown walnut	+\$0
8Q	folkstone grey (CP)	+\$0
91	white (CP)	+\$0
98	studio white (CP)	+\$0
CL	cool grey neutral	+\$0
HF	inner tone light	+\$0
HP	light anigre	+\$0
LBA	clear on ash (CP)	+\$0
LBR	phantom ecru	+\$0
LBS	phantom cocoa	+\$0
LBU	medium matte walnut (CP)	+\$0
LBV	warm grey teak	+\$0
LBB	oak on ash (CP)	+\$0
LBC	walnut on ash (CP)	+\$0
LBF	neutral twill	+\$0
LBJ	graphite twill	+\$0
LBQ	white twill	+\$0
LT	light tone	+\$0
LU	soft white	+\$0
WL	warm stone (CP)	+\$0
WN	warm grey neutral	+\$0

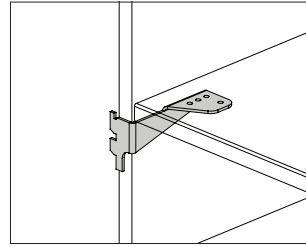

Step 4. Edge Finish

For high-pressure laminate top/thermoplastic edge (L)

125	natural maple (CP)	+\$0
126	natural cherry (CP)	+\$0
127	walnut (CP)	+\$0
139	light ash (CP)	+\$0
140	warm ash (CP)	+\$0
G1	graphite (CP)	+\$0
UBK	ultra black (CP)	+\$0
76	light brown walnut	+\$0
8Q	folkstone grey (CP)	+\$0
91	white (CP)	+\$0
98	studio white (CP)	+\$0
CL	cool grey neutral	+\$0
HF	inner tone light	+\$0
HP	light anigre	+\$0
LBA	clear on ash (CP)	+\$0
LBR	phantom ecru	+\$0
LBS	phantom cocoa	+\$0
LBU	medium matte walnut (CP)	+\$0
LBV	warm grey teak	+\$0
LBB	oak on ash (CP)	+\$0
LBC	walnut on ash (CP)	+\$0
LBF	neutral twill	+\$0
LBJ	graphite twill	+\$0
LBQ	white twill	+\$0
LU	soft white	+\$0
WL	warm stone (CP)	+\$0
WN	warm grey neutral	+\$0

Specification Information

Step 1.

E2931.

Step 2. Position

L left

R right

Prices for Steps 1-2.

E2931. L	\$106
R	\$106

Step 3. Finish

HF	inner tone light	+\$0
LU	soft white	+\$0
MT	medium tone	+\$0

Work Surface Support Panel, End, Glides

E2290.

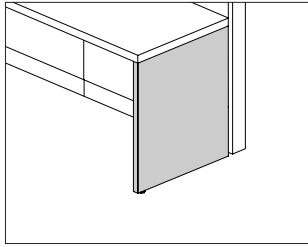

Specification Information

Step 1.

E2290.

Step 2. Depth

24 24" deep

30 30" deep

Step 3. Work Surface Edge

For 24" deep (24) or 30" deep (30)

S squared-edge

Step 4. Surface Material

L thermally-fused laminate

Prices for Steps 1-4.

	L
E2290. 24 S	\$557
30 S	\$586

Step 5. Surface Finish

Solid-Color Laminate

HF	inner tone light	+\$0
LU	soft white	+\$0

Step 6. Hardware Cover Finish

8Q	folkstone grey (CP)	+\$0
91	white (CP)	+\$0
CL	cool grey neutral	+\$0
HF	inner tone light	+\$0
LU	soft white	+\$0
MT	medium tone	+\$0
SG	slate grey	+\$0
WL	warm stone (CP)	+\$0
WN	warm grey neutral	+\$0

Work Surface Support Panel, Mid-Run, Glides

E2291.

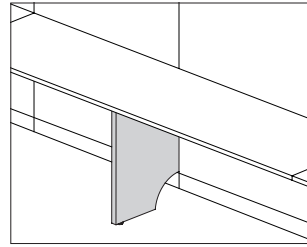

Specification Information

Step 1.

E2291.

Step 2. Size

20 for 24" and 30" deep surfaces

Step 3. Surface Material

W veneer

Prices for Steps 1-3.

	W
E2291. 20	\$988

Step 4. Surface Finish

CHD	noble cherry	+\$42
2U	light brown walnut	+\$47
40	dark brown walnut	+\$47
EW	medium matte walnut	+\$47
UL	natural maple	+\$47

Step 5. Bracket Finish

HF	inner tone light	+\$0
LU	soft white	+\$0
MT	medium tone	+\$0

Stiffener

FV696.

Cord Cleat

G1331.

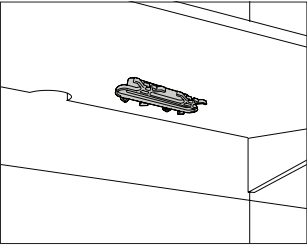
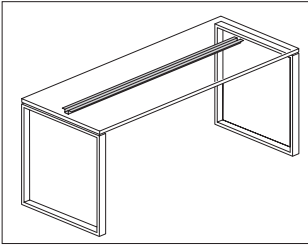

Specification Information

Step 1.

FV696.

Step 2. Width

34	33 ⁷ / ₈ " wide
39	38 ⁵ / ₈ " wide
43	43 ¹ / ₄ " wide
48	48" wide
57	57 ³ / ₈ " wide
62	62 ¹ / ₈ " wide
67	66 ³ / ₄ " wide
71	71 ¹ / ₂ " wide
81	80 ⁷ / ₈ " wide

Prices for Steps 1-2.

FV696.	34	\$101
	39	\$103
	43	\$103
	48	\$103
	57	\$103
	62	\$103
	67	\$103
	71	\$103
	81	\$103

Specification Information

Step 1.

G1331. \$35

Surface Ganging Bracket

FT29B.

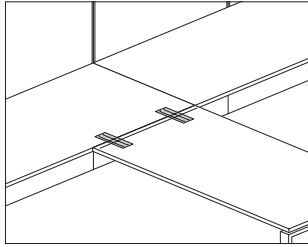

Specification Information

Step 1.

FT29B.

Step 2. Type

- 1 single
- 2 pair

Prices for Steps 1-2.

FT29B. 1	\$37
2	\$63

Squared-Edge Transaction Surface, Rectangular End

E2812.

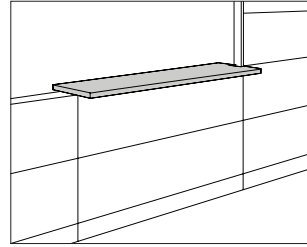

Specification Information

Step 1.

E2812.

Step 2. Width

- 24L 24" wide
- 30L 30" wide
- 36L 36" wide
- 42L 42" wide
- 48L 48" wide

Step 3. Finished End Cutout

- N no cutout
- C cutout on one end

Prices for Steps 1-3.

	N	C
E2812. 24L	\$439	520
30L	\$448	542
36L	\$490	577
42L	\$505	599
48L	\$518	616

Step 4. Top Finish

76	light brown walnut	+\$0
8Q	folkstone grey (CP)	+\$0
91	white (CP)	+\$0
98	studio white (CP)	+\$0
CL	cool grey neutral	+\$0
HF	inner tone light	+\$0
HP	light anigre	+\$0
LBA	clear on ash (CP)	+\$0
LBR	phantom ecru	+\$0
LBS	phantom cocoa	+\$0
LBU	medium matte walnut (CP)	+\$0
LBV	warm grey teak	+\$0
LBB	oak on ash (CP)	+\$0
LBC	walnut on ash (CP)	+\$0
LBF	neutral twill	+\$0
LBJ	graphite twill	+\$0
LBQ	white twill	+\$0
LT	light tone	+\$0
LU	soft white	+\$0
WL	warm stone (CP)	+\$0
WN	warm grey neutral	+\$0

Squared-Edge Transaction Surface,
Rectangular End *continued*

Ethospace® Work Surfaces

Step 5. Edge Finish		
76	light brown walnut	+\$0
8Q	folkstone grey (CP)	+\$0
91	white (CP)	+\$0
98	studio white (CP)	+\$0
CL	cool grey neutral	+\$0
HF	inner tone light	+\$0
HP	light anigre	+\$0
LBA	clear on ash (CP)	+\$0
LBR	phantom ecru	+\$0
LBS	phantom cocoa	+\$0
LBU	medium matte walnut (CP)	+\$0
LBV	warm grey teak	+\$0
LBB	oak on ash (CP)	+\$0
LBC	walnut on ash (CP)	+\$0
LBF	neutral twill	+\$0
LBJ	graphite twill	+\$0
LBQ	white twill	+\$0
LU	soft white	+\$0
WL	warm stone (CP)	+\$0
WN	warm grey neutral	+\$0

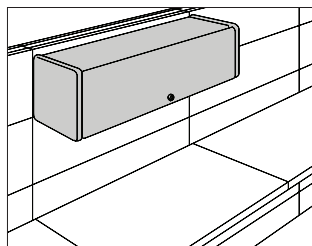

Specification Information

Step 1.

E321

Step 2. Depth/Door Material

2. 13" deep and painted or fabric door

Step 3. Width

24 24" wide
30 30" wide
36 36" wide
42 42" wide
48 48" wide

Step 4. Door Material

For 13" deep and painted or fabric door (2.)

P painted door
F fabric door

Step 5. Lock

For lock (), skip this step.*

lock

Prices for Steps 1-5.

		*
E3212. 24 P		\$736
F		\$759
30 P		\$778
F		\$801
36 P		\$835
F		\$861
42 P		\$899
F		\$924
48 P		\$951
F		\$973

Step 6. Lock Option

KA keyed alike +\$0
KD keyed differently +\$0

Step 7. Case Finish

HF inner tone light +\$0
LU soft white +\$0
MT medium tone +\$0

Step 8. Door Finish

For 13" deep and painted or fabric door (2.) with painted door (P)

HF inner tone light +\$0
LU soft white +\$0
MT medium tone +\$0

Step 9. End Panel Option

For 13" deep and painted or fabric door (2.)

SM for Ethospace® on module +\$0

Step 10. Door Finish

For 24" wide (24), 30" wide (30), 36" wide (36), 42" wide (42), or 48" wide (48) with fabric door (F)

See application chart and textiles list for fabric usage and numbers. First 2 digits of number indicate fabric line; remaining digit(s) indicate fabric color.

Price Category 1 +\$0
 Price Category 2 +\$24
 Price Category 3 +\$49

B-Style Shelf

E3231.

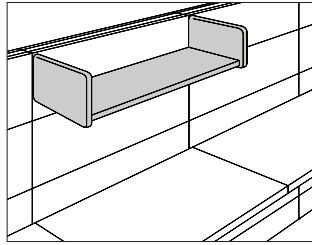

Specification Information

Step 1.

E323

Step 2. Height/Depth

1. 15½" high x 13" deep

Step 3. Width

24 24" wide

30 30" wide

36 36" wide

42 42" wide

48 48" wide

Prices for Steps 1-3.

E3231. 24	\$307
30	\$316
36	\$333
42	\$349
48	\$358

Step 4. Surface Finish

HF	inner tone light	+\$0
LU	soft white	+\$0
MT	medium tone	+\$0

Step 5. End Panel Option

SM	on module	+\$0
-----------	-----------	------

B-Style Storage/Display Shelf

E3232.

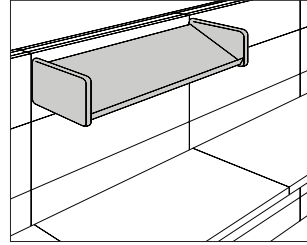

Specification Information

Step 1.

E3232.

Step 2. Width

24 24" wide

30 30" wide

36 36" wide

42 42" wide

48 48" wide

Prices for Steps 1-2.

E3232. 24	\$275
30	\$287
36	\$301
42	\$322
48	\$339

Step 3. Surface Finish

HF	inner tone light	+\$0
LU	soft white	+\$0
MT	medium tone	+\$0

C-Style Flipper Door Unit

X3750.

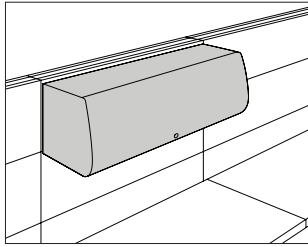

Specification Information

Step 1.

X3750.

Step 2. Width

24	24" wide
30	30" wide
36	36" wide
42	42" wide
48	48" wide

Step 3. Mechanism

SP standard mechanism

Step 4. Lift Handle

N no lift handle

Prices for Steps 1-4.

	N
X3750. 24 SP	\$1073
30 SP	\$1141
36 SP	\$1210
42 SP	\$1295
48 SP	\$1388

Step 5. Lock Option

KA	keyed alike	+\$0
KD	keyed differently	+\$0

Step 6. Attachment Bracket

AO	for Action Office® system	+\$0
E1	for Ethospace® System	+\$0
F8	for Canvas	+\$0
OM	for Ethospace® off module	+\$0

Step 7. Case/Lift Handle Finish

611	beige mist metallic (CP)	+\$0
613	silver (CP)	+\$0
UBK	ultra black (CP)	+\$0
8Q	folkstone grey (CP)	+\$0
91	white (CP)	+\$0
EH	metallic bronze	+\$0
HF	inner tone light	+\$0
LT	light tone	+\$0
LU	soft white	+\$0
MT	medium tone	+\$0
WL	warm stone (CP)	+\$0
WN	warm grey neutral	+\$0

Step 8. Door Finish

611	beige mist metallic (CP)	+\$0
613	silver (CP)	+\$0
UBK	ultra black (CP)	+\$0
8Q	folkstone grey (CP)	+\$0
91	white (CP)	+\$0
EH	metallic bronze	+\$0
HF	inner tone light	+\$0
LT	light tone	+\$0
LU	soft white	+\$0
MT	medium tone	+\$0
WL	warm stone (CP)	+\$0
WN	warm grey neutral	+\$0

Ethospace® Storage

C-Style Flipper Door

X3710.

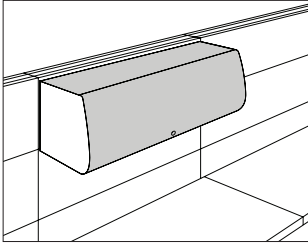

Ethospace® Storage

Specification Information

Step 1.

X3710.

Step 2. Width

24SP	24" wide
30SP	30" wide
36SP	36" wide
42SP	42" wide
48SP	48" wide

Step 3. Lift Handle

N	no lift handle
----------	----------------

Prices for Steps 1-3.

	N
X3710. 24SP	\$673
30SP	\$717
36SP	\$783
42SP	\$844
48SP	\$905

Step 4. Lock Option

KA	keyed alike	+\$0
KD	keyed differently	+\$0

Step 5. Top/Lift Handle Finish

611	beige mist metallic (CP)	+\$0
613	silver (CP)	+\$0
UBK	ultra black (CP)	+\$0
8Q	folkstone grey (CP)	+\$0
91	white (CP)	+\$0
EH	metallic bronze	+\$0
HF	inner tone light	+\$0
LT	light tone	+\$0
LU	soft white	+\$0
MT	medium tone	+\$0
WL	warm stone (CP)	+\$0
WN	warm grey neutral	+\$0

Step 6. Door Finish

611	beige mist metallic (CP)	+\$0
613	silver (CP)	+\$0
UBK	ultra black (CP)	+\$0
8Q	folkstone grey (CP)	+\$0
91	white (CP)	+\$0
EH	metallic bronze	+\$0
HF	inner tone light	+\$0
LT	light tone	+\$0
LU	soft white	+\$0
MT	medium tone	+\$0
WL	warm stone (CP)	+\$0
WN	warm grey neutral	+\$0

C-Style Shelf

X3730.

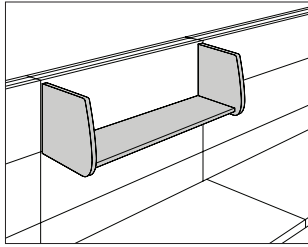

Specification Information

Step 1.

X3730.

Step 2. Width

24	24" wide
30	30" wide
36	36" wide
42	42" wide
48	48" wide

Prices for Steps 1-2.

X3730.	24	\$445
	30	\$462
	36	\$483
	42	\$510
	48	\$532

Step 3. Attachment Bracket

AO	for Action Office® system	+\$0
E1	for Ethospace® System	+\$0
F8	for Canvas	+\$0
OM	for Ethospace® off module	+\$0

Step 4. Surface Finish

611	beige mist metallic (CP)	+\$0
613	silver (CP)	+\$0
UBK	ultra black (CP)	+\$0
8Q	folkstone grey (CP)	+\$0
91	white (CP)	+\$0
HF	inner tone light	+\$0
LT	light tone	+\$0
MT	medium tone	+\$0
EH	metallic bronze	+\$0
WL	warm stone (CP)	+\$0
LU	soft white	+\$0
WN	warm grey neutral	+\$0
611	beige mist metallic (CP)	+\$0
613	silver (CP)	+\$0
UBK	ultra black (CP)	+\$0

Component Brace

X3910.

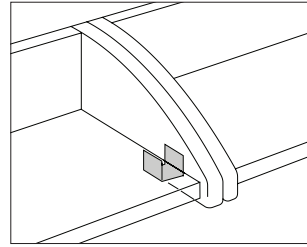

Specification Information

Step 1.

X3910.

Step 2. Usage

1	for C-/E-style flipper unit/shelf
2	for utility shelf (E3234.)

Prices for Steps 1-2.

X3910.	1	\$75
	2	\$75

Step 3. Surface Finish

For C-/E-style flipper unit/shelf (1)

98	studio white (CP)	+\$0
-----------	-------------------	------

Shelf Divider, Angled

G7330.

Coat Hook

E3922.

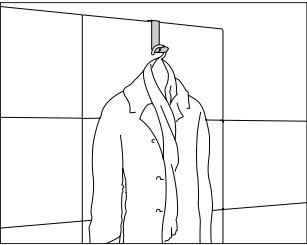
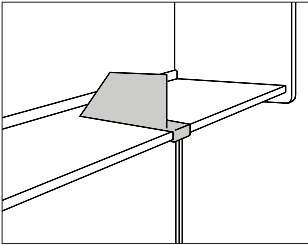

Specification Information

Step 1.	
G7330.	\$393

Step 2. Surface Finish		
8Q	folkstone grey (CP)	+\$0
91	white (CP)	+\$0
HF	inner tone light	+\$0
LT	light tone	+\$0
LU	soft white	+\$0
MT	medium tone	+\$0
SG	slate grey	+\$0
WL	warm stone (CP)	+\$0
WN	warm grey neutral	+\$0
EH	metallic bronze	+\$0

Specification Information

Step 1.	
E3922.	\$129

Step 2. Finish		
HF	inner tone light	+\$0

Ethospace® Storage

Under Shelf LED Task Light

G6170.

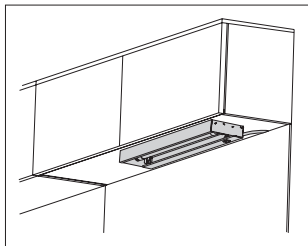

Specification Information

Step 1.

G6170.

Step 2. Width

30	30" wide
36	36" wide
42	42" wide
48	48" wide

Step 3. Bracket Option

S	for Action Office® or Ethospace® Systems or Canvas
Q	for C-style storage or E3234.

Prices for Steps 1-3.

	S	Q
G6170. 30	\$506	506
36	\$519	519
42	\$535	535
48	\$547	547

Step 4. Surface Finish

For Action Office® or Ethospace® Systems or Canvas (S) or C-style storage or E3234. (Q)

8Q	folkstone grey (CP)	+\$0
91	white (CP)	+\$0
BK	black	+\$0
CL	cool grey neutral	+\$0
EH	metallic bronze	+\$0
HF	inner tone light	+\$0
LT	light tone	+\$0
LU	soft white	+\$0
MT	medium tone	+\$0
WL	warm stone (CP)	+\$0
WN	warm grey neutral	+\$0

Metal Pedestals



W-Pull Freestanding Pedestal

LW100.

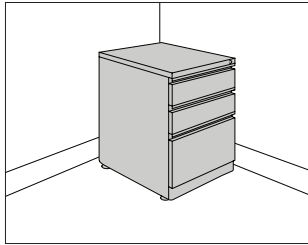

Specification Information

Step 1.

LW100.

Step 2. Depth

20	20" deep
24	24" deep
28	28" deep

Step 3. Configuration

BBF	box/box/file
FF	file/file

Prices for Steps 1-3.

	BBF	FF
LW100. 20	\$823	754
24	\$841	775
28	\$945	872

Step 4. Slides

For 20" deep (20) with box/box/file (BBF)

SR	¾-extension roller slides on box drawer, full-extension ball bearing on file drawer	+\$0
-----------	---	------

For 24" deep (24) or 28" deep (28) with box/box/file (BBF)

SR	¾-extension roller slides on box drawer, full-extension ball bearing on file drawer	+\$0
-----------	---	------

For 20" deep (20) with file/file (FF)

SB	full-extension ball-bearing	+\$0
-----------	-----------------------------	------

For 24" deep (24) or 28" deep (28) with file/file (FF)

SB	full-extension ball-bearing	+\$0
-----------	-----------------------------	------

Step 5. Paint/Steel Type

SS	smooth paint on smooth steel	+\$0
XS	textured paint on smooth steel	+\$0

Step 6. Surface Finish

For smooth paint on smooth steel (SS)

SNA	satin aluminum	+\$60
SNB	satin bronze	+\$60
SNC	satin carbon	+\$60

For smooth paint on smooth steel (SS)

611	beige mist metallic (CP)	+\$0
613	silver (CP)	+\$0
UBK	ultra black (CP)	+\$0
8Q	folkstone grey (CP)	+\$0
98	studio white (CP)	+\$0
EH	metallic bronze	+\$0
HF	inner tone light	+\$0
LT	light tone	+\$0
LU	soft white	+\$0
MT	medium tone	+\$0
WL	warm stone (CP)	+\$0

Sand Texture Paint

For textured paint on smooth steel (XS)

UBK	ultra black (CP)	+\$0
91	white (CP)	+\$0
98	studio white (CP)	+\$0
BK	black	+\$0
CL	cool grey neutral	+\$0
G1	graphite (CP)	+\$0
WN	warm grey neutral	+\$0

Step 7. Lock

KA	keyed alike	+\$0
KC	keyed differently, chrome	+\$0
KD	keyed differently, black	+\$0

Step 8. Base Height

1F	standard height	+\$0
2F	raised height	+\$0

Step 9. Drawer Interior

For 20" deep (20) or 24" deep (24) with box/box/file (BBF)

NN	none	+\$0
3M	drawer divider in one box drawer, pencil tray in one box drawer, 2 file converters in file drawer	+\$25

For 28" deep (28) with box/box/file (BBF)

NN	none	+\$0
3M	drawer divider in one box drawer, pencil tray in one box drawer, 2 file converters in file drawer	+\$25

For 20" deep (20) or 24" deep (24) with file/file (FF)

NN	none	+\$0
1M	2 file converters in each file drawer	+\$25

For 28" deep (28) with file/file (FF)

NN	none	+\$0
1M	2 file converters in each file drawer	+\$25

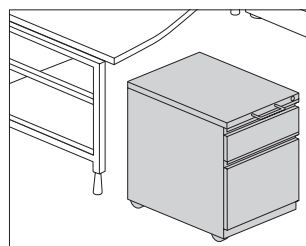
**Specification Information****Step 1.****LW110.****Step 2. Depth**

20	20" deep
24	24" deep

Step 3. Configuration*For 20" deep (20)*

BBF	box/box/file
BF	box/file
FF	file/file

For 24" deep (24)

BBF	box/box/file
FF	file/file

Prices for Steps 1-3.

	BBF	BF	FF
LW110. 20	\$886	747	806
24	\$892	—	818

Step 4. Slides*For box/box/file (BBF)*

SR	¾-extension roller slides on box drawer, full-extension ball bearing on file drawer	+\$0
SB	full-extension ball-bearing	+\$50

For box/file (BF)

SR	¾-extension roller slides on box drawer, full-extension ball bearing on file drawer	+\$0
-----------	---	------

For file/file (FF)

SB	full-extension ball-bearing	+\$0
-----------	-----------------------------	------

Step 5. Paint/Steel Type

SS	smooth paint on smooth steel	+\$0
XS	textured paint on smooth steel	+\$0

W-Pull Mobile Pedestal *continued*

Step 6. Surface Finish

For smooth paint on smooth steel (SS)

SNA	satin aluminum	+\$60
SNB	satin bronze	+\$60
SNC	satin carbon	+\$60

For smooth paint on smooth steel (SS)

611	beige mist metallic (CP)	+\$0
613	silver (CP)	+\$0
UBK	ultra black (CP)	+\$0
8Q	folkstone grey (CP)	+\$0
98	studio white (CP)	+\$0
EH	metallic bronze	+\$0
HF	inner tone light	+\$0
LT	light tone	+\$0
LU	soft white	+\$0
MT	medium tone	+\$0
WL	warm stone (CP)	+\$0

Sand Texture Paint

For textured paint on smooth steel (XS)

UBK	ultra black (CP)	+\$0
91	white (CP)	+\$0
98	studio white (CP)	+\$0
BK	black	+\$0
CL	cool grey neutral	+\$0
G1	graphite (CP)	+\$0
WN	warm grey neutral	+\$0

Step 7. Lock

KA	keyed alike	+\$0
KC	keyed differently, chrome	+\$0
KD	keyed differently, black	+\$0

Step 8. Drawer Interior

For box/box/file (BBF)

NN	none	+\$0
3M	drawer divider in one box drawer, pencil tray in one box drawer, 2 file converters in file drawer	+\$25

For box/file (BF)

NN	none	+\$0
5M	pencil tray in box drawer, 2 file converters in file drawer	+\$20

For file/file (FF)

NN	none	+\$0
1M	2 file converters in each file drawer	+\$25

Step 9. Handle

HN	no hand grip	+\$0
H1	hand grip only	+\$48

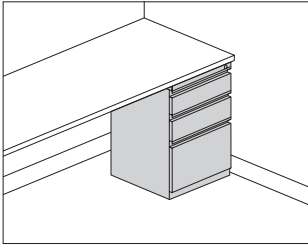
**Specification Information****Step 1.****LW140.****Step 2. Depth****24** 24" deep**28** 28" deep**Step 3. Configuration****BBF** box/box/file**FF** file/file**Prices for Steps 1-3.**

	BBF	FF
LW140. 24	\$786	718
28	\$916	842

Step 4. Slides*For 24" deep (24) or 28" deep (28) with box/box/file (BBF)***SB** full-extension ball-bearing +\$50*For 24" deep (24) or 28" deep (28) with file/file (FF)***SB** full-extension ball-bearing +\$0**Step 5. Paint/Steel Type****SS** smooth paint on smooth steel +\$0**XS** textured paint on smooth steel +\$0**Step 6. Surface Finish***For smooth paint on smooth steel (SS)***SNA** satin aluminum +\$60**SNB** satin bronze +\$60**SNC** satin carbon +\$60**SNL** satin steel +\$92*For smooth paint on smooth steel (SS)***611** beige mist metallic (CP) +\$0**613** silver (CP) +\$0**UBK** ultra black (CP) +\$0**8Q** folkstone grey (CP) +\$0**98** studio white (CP) +\$0**EH** metallic bronze +\$0**HF** inner tone light +\$0**LT** light tone +\$0**LU** soft white +\$0**MT** medium tone +\$0**WL** warm stone (CP) +\$0**Sand Texture Paint***For textured paint on smooth steel (XS)***UBK** ultra black (CP) +\$0**91** white (CP) +\$0**98** studio white (CP) +\$0**BK** black +\$0**CL** cool grey neutral +\$0**G1** graphite (CP) +\$0**WN** warm grey neutral +\$0**Step 7. Lock****KA** keyed alike +\$0**KD** keyed differently, black +\$0**KC** keyed differently, chrome +\$0**Step 8. Base Height****2F** 27¼" high (raised height) +\$0**Step 9. Drawer Interior***For 24" deep (24) with box/box/file (BBF)***NN** none +\$0**3M** drawer divider in one box drawer, pencil tray in one box drawer, 2 file converters in file drawer +\$25*For 28" deep (28) with box/box/file (BBF)***NN** none +\$0**3M** drawer divider in one box drawer, pencil tray in one box drawer, 2 file converters in file drawer +\$25*For 24" deep (24) with file/file (FF)***NN** none +\$0**1M** 2 file converters in each file drawer +\$25

W-Pull Surface-Attached Pedestal

continued

For 28" deep (28) with file/file (FF)

NN	none	+\$0
1M	2 file converters in each file drawer	+\$25

W-Pull Support Pedestal

LW150.

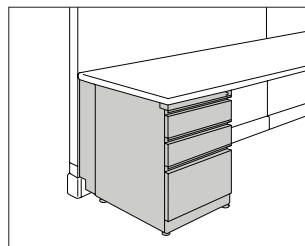

Specification Information

Step 1.

LW150.

Step 2. Depth

20	20" deep
24	24" deep
28	28" deep

Step 3. Configuration

BBF	box/box/file
FF	file/file

Prices for Steps 1-3.

	BBF	FF
LW150. 20	\$875	814
24	\$916	873
28	\$966	926

Step 4. Slides

For 20" deep (20) with box/box/file (BBF)

SR	¾-extension roller slides on box drawer, full-extension ball bearing on file drawer	+\$0
-----------	---	------

For 24" deep (24) or 28" deep (28) with box/box/file (BBF)

SR	¾-extension roller slides on box drawer, full-extension ball bearing on file drawer	+\$0
-----------	---	------

For 20" deep (20) with file/file (FF)

SB	full-extension ball-bearing	+\$0
-----------	-----------------------------	------

For 24" deep (24) or 28" deep (28) with file/file (FF)

SB	full-extension ball-bearing	+\$0
-----------	-----------------------------	------

Step 5. Paint/Steel Type

SS	smooth paint on smooth steel	+\$0
XS	textured paint on smooth steel	+\$0

Step 6. Surface Finish

For smooth paint on smooth steel (SS)

SNA	satin aluminum	+\$60
SNB	satin bronze	+\$60
SNC	satin carbon	+\$60

Tu® Metal Pedestals

For smooth paint on smooth steel (SS)

611	beige mist metallic (CP)	+\$0
613	silver (CP)	+\$0
UBK	ultra black (CP)	+\$0
8Q	folkstone grey (CP)	+\$0
98	studio white (CP)	+\$0
EH	metallic bronze	+\$0
HF	inner tone light	+\$0
LT	light tone	+\$0
LU	soft white	+\$0
MT	medium tone	+\$0
WL	warm stone (CP)	+\$0

Sand Texture Paint

For textured paint on smooth steel (XS)

UBK	ultra black (CP)	+\$0
91	white (CP)	+\$0
98	studio white (CP)	+\$0
BK	black	+\$0
CL	cool grey neutral	+\$0
G1	graphite (CP)	+\$0
WN	warm grey neutral	+\$0

Step 7. Attachment Bracket

For smooth paint on smooth steel (SS)

1A	for Action Office® Series 1 and 2 radiused-edge work surface	+\$0
2A	for Action Office® Series 1 and 2 squared-edge work surface	+\$0
E1	for Ethospace® System	+\$0
F8	for Canvas Office Landscape®	+\$0

For textured paint on smooth steel (XS)

1A	for Action Office® Series 1 and 2 radiused-edge work surface	+\$0
2A	for Action Office® Series 1 and 2 squared-edge work surface	+\$0
F8	for Canvas Office Landscape®	+\$0

Step 8. Lock

KA	keyed alike	+\$0
KC	keyed differently, chrome	+\$0
KD	keyed differently, black	+\$0

Step 9. Drawer Interior

For 20" deep (20) or 24" deep (24) with box/box/file (BBF)

NN	none	+\$0
3M	drawer divider in one box drawer, pencil tray in one box drawer, 2 file converters in file drawer	+\$25

For 28" deep (28) with box/box/file (BBF)

NN	none	+\$0
3M	drawer divider in one box drawer, pencil tray in one box drawer, 2 file converters in file drawer	+\$25

For 20" deep (20) or 24" deep (24) with file/file (FF)

NN	none	+\$0
1M	2 file converters in each file drawer	+\$25

For 28" deep (28) with file/file (FF)

NN	none	+\$0
1M	2 file converters in each file drawer	+\$25

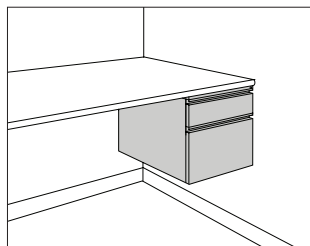

Specification Information

Step 1.

LW130.20BF \$556

Step 2. Slides

SR ¾-extension roller slides on box drawer, full-extension ball bearing on file drawer +\$0

Step 3. Paint/Steel Type

SS smooth paint on smooth steel +\$0

XS textured paint on smooth steel +\$0

Step 4. Surface Finish

For smooth paint on smooth steel (SS)

SNA satin aluminum +\$60

SNB satin bronze +\$60

SNC satin carbon +\$60

For smooth paint on smooth steel (SS)

611 beige mist metallic (CP) +\$0

613 silver (CP) +\$0

UBK ultra black (CP) +\$0

8Q folkstone grey (CP) +\$0

98 studio white (CP) +\$0

EH metallic bronze +\$0

HF inner tone light +\$0

LT light tone +\$0

LU soft white +\$0

MT medium tone +\$0

WL warm stone (CP) +\$0

Sand Texture Paint

For textured paint on smooth steel (XS)

UBK ultra black (CP) +\$0

91 white (CP) +\$0

98 studio white (CP) +\$0

BK black +\$0

CL cool grey neutral +\$0

G1 graphite (CP) +\$0

WN warm grey neutral +\$0

Step 5. Lock

KA keyed alike +\$0

KC keyed differently, chrome +\$0

KD keyed differently, black +\$0

Step 6. Drawer Interior

NN none +\$0

5M pencil tray in box drawer, 2 file converters in file drawer +\$20

File Drawer Organizer

LG901

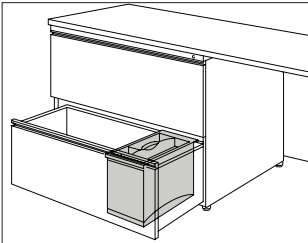

Specification Information	
Step 1.	
LG901	\$127

Drawer Divider, Tu® Pedestal

LG903.

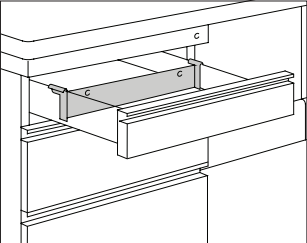

Specification Information	
Step 1.	
LG903.	
Step 2. Usage	
3	for pencil drawer
6	for box drawer
Prices for Steps 1-2.	
LG903. 3	\$24
6	\$25

Stationery Divider, Tu® Pedestal

LG905

Utility Tray, Tu® Pedestal

LG906

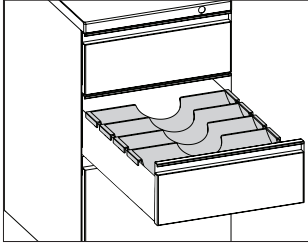

Specification Information

Step 1.

LG905

\$85

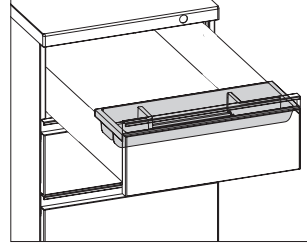

Specification Information

Step 1.

LG906

\$32

Tu® Metal Pedestals

File Converter, Tu® Pedestal

LG907

File Compressor, Tu® Pedestal

LG908

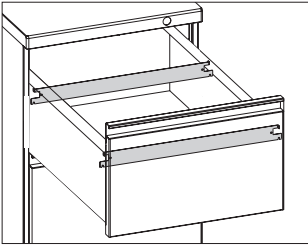

Specification Information	
Step 1.	
LG907	\$44

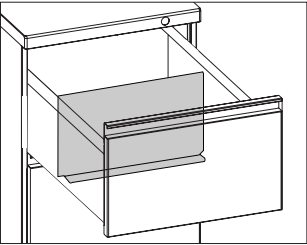

Specification Information	
Step 1.	
LG908	\$70

Index by Product Name

Ethospace® System 10-Day or Less	
2-Way 90° Connector	page(s) 12
2-Way 90° Connector Cover	21
2-Way 90° Connector Cover, Architectural	22
2-Way 90° Connector Cover, Monolithic	22
2-Way 90° Connector, Monolithic	13
2-Way 90° Stacking Connector	18
3-Way 90° Connector	16
3-Way 90° Connector Cover	24
3-Way 90° Connector Cover, Monolithic	25
3-Way 90° Connector, Monolithic	17
3-Way 90° Stacking Connector	19
4-Way 90° Connector	17
4-Way 90° Stacking Connector	19
Architectural Cladding, Fabric	38
Bare Connector	20
Bare Frame	5
Baseline Box Assembly, H-Style Frame	32
Baseline Harness, 4 Circuit	29
Base Power Entry, Junction Box, 4 Circuit	28
Beltline Bezel, H-Style Frame	36
Beltline Harness, 4 Circuit	31
B-Style Flipper Door Unit	55
B-Style Shelf	56
B-Style Storage/Display Shelf	56
Cable Access Tile	39
Cable Channel Tile	40
Cable Manager, Extra Capacity	34
Ceiling Power Entry, Internal Direct Connect	29
Coat Hook	60
Communication Port Faceplate Extender	35
Communication Port Faceplate Reducer	35
Component Brace	59
Concave Corner Surface	47
Connector Top Cap	27
Connect™ S300	33
Cord Cleat	52
Corner Surface	46
C-Style Flipper Door	58
C-Style Flipper Door Unit	57
C-Style Shelf	59
Curvilinear Surface	45
Draw Rod	9
Extended Corner Surface, Rectangular End	48
Face Tile	36
Finished End	25
Finished End, Change of Height	26

Floor-Length Face Tile	37
Frame	5
Frame Top Cap	26
Frame, Transaction Work Surface	7
Marker/Eraser Holder	43
Open Tile	40
Open Tile, Squared Stile	41
Pass-Through Harness, Connector	30
Pass-Through Harness, Frame	30
Perforated Tile, Squares	41
Power Entry, External Direct Connect, 4 Circuit	27
Power Entry, Internal Direct Connect, 4 Circuit	28
Power Jumper, 4 Circuit	32
Rail Tile	42
Receptacle, 4 Circuit, 15 Amp	33
Rectangular Surface	44
Shelf Divider, Angled	60
Side Cover	8
Spacer	14
Spacer/3-Way 90° Connector Cover, Architectural	24
Spacer Connector Cover	23
Spacer Stacking Connector	18
Squared-Edge Corner Wedge	49
Squared-Edge Transaction Surface, Rectangular End	53
Stacking Frame	8
Stacking Frame Hardware Kit, Change of Height	20
Stiffener	52
Stile Covers and Top Caps, Transaction Work Surface Frame	7
Surface Ganging Bracket	53
Tackable Tile	39
Tile Adapter	10
Tile-Height Harness, 4 Circuit	31
Tool Bar	42
Trim Strip	11
Under Shelf LED Task Light	61
Wall Fastener	10
Wall Start	11
Wall Start Filler	12
Wall Strip	9
Work Surface Support Bracket	50
Work Surface Support Panel, End, Glides	51
Work Surface Support Panel, Mid-Run, Glides	51
Tu® Pedestals 10-Day or Less	
Drawer Divider, Tu® Pedestal	page(s) 72
File Compressor, Tu® Pedestal	74
File Converter, Tu® Pedestal	74
File Drawer Organizer	72

Index: Product Name

Stationery Divider, Tu® Pedestal	73
Utility Tray, Tu® Pedestal	73
W-Pull Freestanding Pedestal	65
W-Pull Mobile Pedestal	66
W-Pull Support Pedestal	69
W-Pull Surface-Attached Pedestal	68
W-Pull Suspended Pedestal	71

Index by Product Number

E1109.	Bare Frame	page(s) 5	E1357.	Tile-Height Harness, 4 Circuit	31
E1109.	Frame	5	E1396.	Cable Manager, Extra Capacity	34
E1112.	Stacking Frame	8	E1420.	Face Tile	36
E1116.	Frame, Transaction Work Surface	7	E1420.	Floor-Length Face Tile	37
E1117.	Stile Covers and Top Caps, Transaction Work Surface Frame	7	E1422.	Tackable Tile	39
E1120.	Draw Rod	9	E1425.	Rail Tile	42
E1130.	Wall Strip	9	E1433.	Cable Channel Tile	40
E1131.	Tile Adapter	10	E1436.	Cable Access Tile	39
E1132.	Trim Strip	11	E1440.	Open Tile	40
E1210.	Wall Start	11	E1441.	Perforated Tile, Squares	41
E1212.	Wall Start Filler	12	E1444.	Open Tile, Squared Stile	41
E1219.	Bare Connector	20	E1445.	Architectural Cladding, Fabric	38
E1220.	2-Way 90° Connector	12	E2290.	Work Surface Support Panel, End, Glides	51
E1220.	2-Way 90° Stacking Connector	18	E2291.	Work Surface Support Panel, Mid-Run, Glides	51
E1222.	Spacer	14	E2812.	Squared-Edge Transaction Surface, Rectangular End	53
E1222.	Spacer Stacking Connector	18	E2931.	Work Surface Support Bracket	50
E1224.	2-Way 90° Connector, Monolithic	13	E3212.	B-Style Flipper Door Unit	55
E1230.	3-Way 90° Connector	16	E3231.	B-Style Shelf	56
E1230.	3-Way 90° Stacking Connector	19	E3232.	B-Style Storage/Display Shelf	56
E1231.	3-Way 90° Connector, Monolithic	17	E3610.	Tool Bar	42
E1240.	4-Way 90° Connector	17	E3922.	Coat Hook	60
E1240.	4-Way 90° Stacking Connector	19	EW400.	Baseline Box Assembly, H-Style Frame	32
E1250.	Finished End	25	EWS10.	Rectangular Surface	44
E1251.	Finished End, Change of Height	26	EWS12.	Curvilinear Surface	45
E1260.	Frame Top Cap	26	EWS20.	Corner Surface	46
E1261.	Connector Top Cap	27	EWS21.	Concave Corner Surface	47
E1263.	Side Cover	8	EWS22.	Extended Corner Surface, Rectangular End	48
E1270.	2-Way 90° Connector Cover	21	FT29B.	Surface Ganging Bracket	53
E1271.	Spacer Connector Cover	23	FV696.	Stiffener	52
E1272.	3-Way 90° Connector Cover	24	G1189.	Communication Port Faceplate Extender	35
E1274.	2-Way 90° Connector Cover, Monolithic	22	G1189.	Communication Port Faceplate Reducer	35
E1276.	3-Way 90° Connector Cover, Monolithic	25	G1331.	Cord Cleat	52
E1281.	2-Way 90° Connector Cover, Architectural	22	G1510.	Beltline Bezel, H-Style Frame	36
E1282.	Spacer/3-Way 90° Connector Cover, Architectural	24	G6170.	Under Shelf LED Task Light	61
E1293.	Stacking Frame Hardware Kit, Change of Height	20	G7330.	Shelf Divider, Angled	60
E1294.			LG901.	File Drawer Organizer	72
E1311.	Receptacle, 4 Circuit, 15 Amp	33	LG903.	Drawer Divider, Tu® Pedestal	72
E1322.	Power Entry, External Direct Connect, 4 Circuit	27	LG905.	Stationery Divider, Tu® Pedestal	73
E1323.	Base Power Entry, Junction Box, 4 Circuit	28	LG906.	Utility Tray, Tu® Pedestal	73
E1325.	Power Entry, Internal Direct Connect, 4 Circuit	28	LG907.	File Converter, Tu® Pedestal	74
E1331.	Ceiling Power Entry, Internal Direct Connect	29	LG908.	File Compressor, Tu® Pedestal	74
E1341.	Power Jumper, 4 Circuit	32	LW100.	W-Pull Freestanding Pedestal	65
E1342.	Pass-Through Harness, Frame	30	LW110.	W-Pull Mobile Pedestal	66
E1353.	Beltline Harness, 4 Circuit	31	LW130.	W-Pull Suspended Pedestal	71
E1354.	Baseline Harness, 4 Circuit	29	LW140.	W-Pull Surface-Attached Pedestal	68
E1355.			LW150.	W-Pull Support Pedestal	69
E1356.	Pass-Through Harness, Connector	30	X1192.	Wall Fastener	10

Index: Product Number

X3710.	C-Style Flipper Door	58
X3730.	C-Style Shelf	59
X3750.	C-Style Flipper Door Unit	57
X3910.	Component Brace	59
Y1323.	Connect™-S300	33
Y2091.	Squared-Edge Corner Wedge	49
Y7231.	Marker/Eraser Holder	43

10-Day or Less Order Information

GSA

10-Day or Less Program

10-day or less products are designed for established Herman Miller dealers with pre-approved credit.

Products are distributed from multiple West Michigan manufacturing facilities. These include Holland, Spring Lake, and Zeeland. Orders will be shipped within 10 business days or less from the date of Herman Miller acknowledgement.

Ordering Procedures

1. Please place orders through Order Manager. If this is not available to you, place orders through mail or fax. Verbal purchase orders will not be accepted.
Order Entry fax number for Meridian® Filing and Storage:
(616) 846 9236.
Order Entry fax number for all other products:
(616) 654 3085.
2. Orders must be clearly marked “10-day or less program” and include only 10-day or less products. Orders not marked this way will be processed under standard lead times. Orders for standard lead times must be placed on a separate purchase order.
3. Only fabrics and finishes listed with each product are available through the 10-day or less program.
4. For any 10-day or less project over \$250,000 list price, please contact your Customer Care representative within 48 hours of order entry to reserve lead time.
5. For more information, contact your Customer Care representative at: (866) 854 3048 ext 3400.

Shipments and Delivery

Per Herman Miller Terms and Conditions.

Changes and Cancellation

Per Herman Miller Terms and Conditions.



10-Day Keyed-Alike Information

GSA

Keyed-Alike Locks

All components with locks may be specified keyed alike. Products with keyed-alike locks will be shipped with lock chassis installed. Installation of lock cylinders will be on-site according to instructions provided. Herman Miller, Inc. will not be responsible for lock cylinder installation.

When specifying product keyed-alike, include separate lines on your order for the lock cylinders.

For Action Office® and Ethospace® products, list cylinder part number and key number (232092-XXX); select a key number (or numbers) between 226 and 427, excluding numbers 408 and 412.

For Meridian® Storage, see the following chart.

Keyed-alike locks are field installed.

To order keyed-alike locks for Action Office® Series 1 and 2 door panels, please contact Customer Care.

A master key can be used to open any lock on an attached or freestanding component. In addition, a removal key or lock change tool is required to remove lock plugs. Customers interested in ordering master keys, removal keys, or lock change tools should contact Customer Care.

For Meridian Storage, specify as follows:

Specification Code	Key Number	Color	Lock Series
KA	232092-XXX ¹	black	UM series 226-427
KA	1B2JK7-XXX ¹	chrome	UM series 226-427

Key Number:
XXX¹ = a key number between 226 and 427 (excluding 408 and 412)



Stain-to-Match Program

GSA

Stain-to-Match Program

Program Overview

The Stain-to-Match program gives you the option of using veneer finishes that are not listed in the standard offering. The program allows Herman Miller to match a customer's existing recut or natural veneer, or create a new finish that is unique to an installation.

Specific information on approval, ordering, pricing, and warranty for the Stain-to-Match program is listed below. Questions and requests for assistance may be directed to Herman Miller Options at:

(800) 654 3910

Ordering Products with Stain-to-Match Veneers

1. Fill out the Options Stain-to-Match Request Form and send along with a color sample (2" x 3" minimum) to the Herman Miller Options Applications Team at the address provided on the form. The form can be found on Omni.
2. Within 7-10 working days, Herman Miller Options will send a sample of the color-matched stain on Herman Miller veneer to the requester for the customer's signed approval.
3. If the sample meets the customer's approval, sign the reverse side of the sample, scan and email the approval to: options@hermanmiller.com.
4. After the stain has been approved, a formal quotation with special number and pricing can be provided, or the product can be specified through the Vary Easy program, if available. Work with the Options team on final product needs and how to specify.
5. A purchase order can then be placed.

Stain-to-Match Warranty

Herman Miller warrants its products to be free from defects in craftsmanship from the date of delivery for the applicable warranty period. Herman Miller is responsible for the physical properties of the veneers available through the Stain-to-Match program, which include:

- STA: Stain-to-Match on Recut Ash
- STC: Stain-to-Match on Cherry
- STD: Stain-to-Match on Oak
- STK: Stain-to-Match on Reltech Anigre (Geiger)
- STP: Stain-to-Match on Maple
- STU: Stain-to-Match on Walnut (Geiger)

See your specification tool for product specific finish offering limitations.



Proprietary Textiles Application Chart — 10-Day Workspaces

GSA

- Available

Application Note: Herman Miller cannot guarantee material/pattern alignment in adjacent products. For example, a fabric's pattern may not align from one screen to the next, or from one panel to the next.

	Action Office® Panels/Connectors	B-Style Tackboards	E-Style Storage	Ethospace® Tiles/Connectors	Canvas Office Landscape™ Tiles	Seating
Price Category 1						
2V__ Chain	•	•	•	•	22	
8T__ Crossing (85__)	5	2	•	•	•	6
3DE__ Dex	2	2	•	•	•	•
2I__ Grasscloth	•	•	•	•	•	
MN__ Monologue	2	2	•	•	•	•
5T__ Resonance	•	•	•	•	•	
22F__ Slant	10	•	•	•	•	
235__ Tailored	•		•	•	•	•
1WS__ Whisper	2	2	•	•	•	•
Price Category 2						
3AR__ Aristo	2	2	•	•	•	•
51__ Cord	•	•	•	•	•	
92__ Crepe	2	•	•	•	•	•
4N__ Horizon	2	2	•	•	•	
1HA__ Medley	2	2	•	•	•	•
8R__ Twist (5S__)	4	2	•	•	•	6
Price Category 3						
47__ Ground Cloth®	•	•	•	•	•	
ZM2__ Meld - Maharam	2	2	•	•	•	•
8W__ Strands	•	•	•	•	•	

- 2 Available on all products except 54" and 60" wide.
- 4 Not available on Action Office acoustical panels and not available on 54" and 60" wide products.
- 5 Not available on Action Office acoustical panels.
- 6 Available on seating products in select colors. See the "Proprietary Textile Colors-10-Day Seating" appendix.

- 10 Not available on Action Office connectors, cable management, and spacers.
- 22 Not available as railroaded application option for Chain (2V__).



Proprietary Textile Colors — 10-Day Workspaces

GSA

Price Category 1

Chain	
66" wide	
100% recycled polyester	
with 12% ocean bound plastic	
2V01	Pearl ¹
2V02	Oyster
2V03	Wheat
2V04	Linen
2V05	Wicker
2V06	Bamboo
2V07	Sage
2V08	Spring Wood ¹
2V09	Iceberg ¹

Crossing	
54" wide	
86% antimony-free polyester	
14% polyester	
8T03	Wicker
8T04	Porcelain
8T05	Warm Grey
8T10	Tomato
8T17	Cerulean
8T18	Indigo
8T19	Shale
8T22	Tin
8T23	Graphite
8T24	Black

Crossing	
For systems products only.	
54" wide	
86% antimony-free polyester	
14% polyester	
8501	Ivory
8502	Oyster

Dex	
54" wide	
67% recycled polyester	
33% polyester	
3DE01	Frost
3DE02	Silver Pine
3DE03	Stone
3DE04	Shale
3DE05	Charcoal
3DE06	Gossamer
3DE07	Pine

Grasscloth	
66" wide	
100% recycled polyester	
with 11% ocean bound plastic	
2I01	Silver Birch
2I02	Pampas ¹
2I03	Sedge
2I07	Lea ¹
2I08	Taro
2I09	Steam Grey ¹
2I13	Gravel

Monologue	
54" wide	
56% recycled polyester	
44% polyester	
1MN01	Linen
1MN02	Alabaster
1MN04	Folkstone
1MN05	Silver Pine
1MN06	Slate
1MN07	Seed
1MN09	Persimmon
1MN11	Meadow
1MN12	Blue Sky
1MN13	Blue Spruce
1MN14	Deep Sea

Resonance	
66" wide	
100% polyester	
5T04	Greige
5T05	Porcelain
5T06	Alabaster
5T15	Iris
5T28	Sugar
5T54	Saltbush

Slant	
66" wide	
51% polyester	
49% recycled polyester	
22F04	Pesto
22F06	Neptune
22F07	Blueberry
22F10	Pumpkin
22F12	Silver Birch
22F13	Blue Stone
22F15	Shale

Tailored	
54" wide	
56% polyester	
44% recycled polyester	
23502	Sugar
23508	Cobalt
23509	Cadet
23510	Fog
23511	Graphite
23512	Black

Whisper	
54" wide	
73% recycled polyester	
27% polyester,	
with 11.3% ocean bound plastic	
1WS01	Sand Dollar
1WS02	Pebble
1WS03	Silver Birch
1WS04	Iceberg
1WS05	Silver Pine
1WS06	Carbon
1WS07	Cumin
1WS12	Willow
1WS13	Sea Grass
1WS14	Pool
1WS15	Blueberry
1WS16	Glacier
1WS17	Grey
1WS18	Canyon

¹ Temporary extended lead-time.

Proprietary Textile Colors — 10-Day Workspaces

continued

GSA

Price Category 2

Appendix: Proprietary Textile Colors — 10-Day Workspaces

Aristo	
54" wide	
88% recycled polyester	
12% polyester	
Acrylic backing	

3AR01	Forest Moss
3AR02	Light Brindle
3AR03	Mink
3AR06	Cherry
3AR10	Waterfall
3AR11	Cadet
3AR12	Tin
3AR13	Pewter
3AR14	Grey Brindle
3AR15	Grey Black

Cord	
66" wide	
51% antimony-free polyester	
49% polyester	

5101	Ivory
5102	White Ash
5103	Linen
5104	Bamboo
5105	Sepia
5107	Sesame
5109	Bayou
5111	Spring Wood
5112	Summer White

Crepe	
54" wide	
100% recycled polyester	
with 43.6% ocean bound plastic	

9201	Licorice
9203	Smoke
9223	Cadet
9241	Beachglass
9249	Stone
9251	Fog
9252	Slate Grey
9261	Shale
9262	Graphite
9265	Mineral
9266	Persimmon
9267	Juniper
9268	Glacier
9269	Cascade
9270	Navy

Horizon	
54" wide	
65% antimony-free polyester	
35% polyester	

4N01	Rye Grass ¹
4N02	Sugar Pine ¹
4N04	White Ash ¹
4N05	Spring Wood ¹
4N09	Oat Grass ¹

Medley	
54" wide	
50% recycled polyester	
50% polyester	

1HA01	Stone
1HA02	Trail
1HA03	Charcoal
1HA04	Cinder
1HA06	Papaya
1HA07	Chutney
1HA09	Feather Grey
1HA11	Loden
1HA13	Bayou
1HA14	Blue Grotto
1HA15	Blueberry
1HA22	Khaki
1HA23	Pewter

Twist	
54" wide	
80% antimony-free polyester	
13% recycled polyester	
7% polyester	

8R05	Wicker
8R10	Poppy
8R14	Tin
8R15	Shale
8R16	Graphite
8R17	Birch
8R18	Sepia
8R22	Blueberry
8R23	Green Apple
8R26	Gunmetal
8R35	Waterfall
8R37	Carbon Dark

Twist	
For systems products only.	
54" wide	
80% antimony-free polyester	
13% recycled polyester	
7% polyester	

5S03	Oyster
------	--------

1 Temporary extended lead-time.

Proprietary Textile Colors — 10-Day Workspaces

continued

GSA

Price Category 3

Ground Cloth®	
66" wide	
100% polyester	
4701	Vapor Grey
4721	Warm White
4722	Fog
4723	Straw
4724	Red Orange
4726	Green Apple
4727	Caribbean
4728	Midnight
4729	Cappuccino

Meld – Maharam	
54" wide	
68% post-consumer recycled polyester	
32% polyester	
PFOA-Free stain resistant	
ZM202/466387-202	Panda
ZM204/466387-204	Knight
ZM205/466387-205	Quill
ZM239/466387-239	Isle

Strands	
66" wide	
100% recycled polyester	
8W01	Pebble
8W02	Porcelain
8W03	Taupe ¹
8W05	Khaki
8W08	Tin

1 Temporary extended lead-time.

For more information about our products and services or to see a list of dealers, please visit us at HermanMiller.com or call (800) 851 1196.

© 2025 Herman Miller, Inc., Zeeland, Michigan

Distribution Rights

Working together since 1956, Herman Miller and Vitra are the authentic sources of designs by Charles and Ray Eames, Alexander Girard, and George Nelson. All the designs shown in this book are protected by law. Herman Miller has obtained all rights to make and sell these designs. Also, Herman Miller holds exclusive worldwide manufacturing and distribution rights for these products with the following exceptions:

Charles and Ray Eames, George Nelson, and Alexander Girard—Worldwide distribution rights for furniture in all areas except Europe and the Middle East. For those areas, please contact Vitra.

Isamu Noguchi—Worldwide distribution rights for the Noguchi Rudder Table. Distribution rights for the Noguchi Table in North America and Central America only. For all other areas, please contact Vitra.

Magis—Exclusive distribution rights in the US and Canada. For all other areas, please contact Magis.

® HermanMiller, ●, Action Office, Aeron, Aside, Canvas Office Landscape, Caper, Cosm, Co/Struc, Eames, Embody, Ethospace, Exclave, Fine-Tune, FlexFront, Formcoat, Ground Cloth, Intent, Layout Studio, Lino, Maharam, Meridian, Mirra, Motia, Nelson, Pellicle, Perspectives, Plex, PostureFit, PostureFit SL, Sayl, Setu, Tu, Verus, Y-Tower and Zeph are among the registered trademarks of Herman Miller, Inc., and its owned subsidiaries.

™ AireWeave, Bubbletack, Canvas Vista, Cellular Suspension, Commend, Compass, Connect, DOT, Durawrap, Everywhere, Flex-Edge, Headway, Hopsak 2, Iota, Keyless Entry, Latitude, Lyris 2, Mora, Multiscrim, Nevi, OE1, OE1 Workspace Collection, Overlay, Renew, Stackable, Swoop, Thrive, TriFlex, Twist and Valor are among the trademarks of Herman Miller, Inc., and its owned subsidiaries.

Chemsurf® is a registered trademark of Wilsonart International.

Corian® is a registered trademark of E.I. du Pont de Nemours and Company Corporation.

FLEXNET™ is a trademark of Milliken & Company.

Floor Saver Glide® is a registered trademark of Carpin Manufacturing, Inc.

Forest Stewardship Council® is a registered trademark of the Forest Stewardship Council A.C. (FSC). We are FSC® certified (FSC® C102895).

FSC® is a registered trademark of the Forest Stewardship Council A.C. (FSC).

MicrobeCare™ is a trademark of Parasol Medical LLC.

Microsoft® and Natural® Keyboard are registered trademarks of Microsoft Corporation.

Place Textiles® is a registered trademark of Place Textiles.