



GSA prices effective October 7, 2024
(based on July 1, 2024, commercial price list)
Published February 2025

Workspaces

Commend™ Nurses Station

General Services Administration Federal Supply Service Authorized Federal Supply Schedule Price List

Online access to contract ordering information, terms and conditions, up-to-date pricing, and the option to create an electronic delivery order is available through GSA Advantage!®, a menu-driven database system. The Internet address for GSA Advantage! is www.gsaadvantage.gov.

Office Furniture
FSC/PSC 7110/7125
Contract Number: GS-03F-036DA
UEI: Q2K3MSZ843D8
Contract Period: December 21, 2015—December 20, 2025

MillerKnoll, Inc.
855 East Main Avenue
Zeeland, Michigan 49464
(616) 654 3000 Phone
(616) 654 8278 Fax
www.HermanMiller.com/government

Business Size: Large

Contract Information

1a. Special Item Numbers (SIN)

SIN 33721

Furniture Systems, Computer Furniture, Filing and Storage, Tables and Accessories, Upholstered Seating and Multi-Purpose Seating, Project Management, Reconfiguration and Relocation Services, Design/Layout and Installation Services

SIN 33721P

Packaged Offices

SIN 337127

Modular Laboratory Furniture Systems

SIN 339113H

Healthcare Furniture

SIN OLM

Order-Level Materials (OLMs)

This SIN is only for products and/or services used in direct support of the purchase of new furniture. It requires approval from the ordering Contract Officer. Please contact your local MillerKnoll Inc. representative to discuss the appropriate use of this SIN.

SIN 532289

Leasing

Contact MillerKnoll Inc participating government dealer for current leasing information.

1b. Lowest Priced Model

SIN 33721:	BVP3.S	\$7.27
SIN 33127:	TW113	\$5.81
SIN 339113H:	CR900NR	\$483.80

1c. Service Rates

Project Management

Furniture Project Manager: \$64.75 per hour
Furniture Project Coordinator: \$49.00 per hour
Build-Out Project Manager: \$80.00 per hour

Reconfiguration and Relocation Services

Not to exceed \$55 per hour.

See * Additional Notes for Installation & Reconfiguration and Relocation Services.

Design/Layout

Not to exceed \$65 per hour.

Installation Services

Not to exceed \$55 per hour (\$82.50 per hour for after-hours Installation).

See * Additional Notes for Installation & Reconfiguration and Relocation Services.

2. Maximum Order

SIN 33721, 337127, NEW, OLM

\$250,000 net product value

SIN 33721P

\$250,000 net value

SIN 339113H

\$500,000 net product value

3. Minimum Order

\$100 net

4. Geographic Coverage

Continental U.S.

Orders for Alaska, Hawaii, and Puerto Rico will be shipped F.O.B. inland carrier point of exportation.

5. Point of Production

Zeeland, Ottawa County, Michigan

Spring Lake, Ottawa County, Michigan

Elland, Yorkshire, United Kingdom

Hildebran, Burke County, North Carolina, USA

6. Pricing

Prices shown are list. Discounts include Industrial Funding Fee.

SIN 33721

Standard Lead Time, Single Order Net Purchase \$100 - 250,000, includes approved Herman Miller Options Products.

Product Line	Discount From List
Action Office 1	73.8%
Action Office 2	73.8%
Aeron	64.5%
Ambit Workspace Solutions	74.3%
Asari Chair	53.7%
Aside	64.2%
Bay Work Pod	56.7%
C-Style Overhead Storage	73.8%
Canvas Office Landscape Channel	74.8%
Canvas Office Landscape Dock	74.8%
Canvas Metal Desk	74.8%
Canvas Office Landscape Metal Storage	74.8%
Canvas Office Landscape Private Office	74.8%
Canvas Office Landscape Wood Storage	74.8%
Canvas Office Landscape Vista	74.8%
Canvas Office Landscape Wall	74.8%
Caper	61.5%
Commend Nurses Station	73.3%
Cosm	61.7%
Eames® Aluminum Group	58.7%
Eames Conference & Dining Tables	73.6%
Easton Family	54.91%
Embody	59.7%
Energy Distribution Systems	73.8%
Ethospace System	73.8%
Everywhere™ Tables	73.8%
Exclave	61.7%

Contract Information

continued

Fuld	59.7%
Headway™ Tables	73.8%
Intent Solution	58.7%
Layout Studio®	60.7%
Lighting	73.8%
Lino	63.7%
Meridian Laterals	67.3%
Meridian Pedestals	64.2%
Meridian Towers	62.7%
Meridian Storage	62.7%
Mirra 2	61.7%
Motia Tables	73.8%
NaughtOne	50.0%
Nemschoff	54.91%
Nevi™ Tables	73.8%
Nevi Link	73.8%
OE1 Boundary	72.8%
OE1 Community Elements	61.7%
OE1 Micro Packs	73.8%
OE1 Storage	72.8%
OE1 Tables and Benching	73.8%
Overlay™	62.7%
Plex® Lounge Furniture	59.5%
Pronta Stacking Chair	57.7%
Public Office Landscape	61.7%
Renew™ Tables	73.8%
Renew Link	73.8%
Sayl	62.2%
Setu	59.7%
Swoop Lounge Furniture	60.7%
Thrive Portfolio	62.0%
Thrive Portfolio-CBS Products Extension	62.0%
Tu Lateral Files	74.3%
Tu Pedestals	73.8%
Tu Storage	74.3%
Tu Towers	74.3%
Tu Wood Cases	74.3%
Tu Wood Cubbies	74.3%
Tu Wood Credenzas	74.3%
Tu Wood Pedestals	74.3%
Tu Wood Towers	74.3%
Valor™ Family	54.91%
Verus	63.7%
Zeph	60.2%

Services

Please refer to section 19 for Terms and Conditions of Installation/ Reconfiguration and Relocation Services.

Project Management

Services under this SIN may be used only in conjunction with the purchase of new furniture. Please contact your local MillerKnoll Inc. representative to discuss the available labor categories (listed below). The hourly rates listed are “Not To Exceed” or “NTE” values.

Furniture Project Manager: \$64.75 per hour
Furniture Project Coordinator: \$49.00 per hour
Build-Out Project Manager: \$80.00 per hour

Reconfiguration and Relocation Services

Reconfiguration and Relocation Services will be provided by MillerKnoll Inc. or its participating dealer based on a fee not to exceed \$55 per hour.

See * Additional Notes for Installation & Reconfiguration and Relocation Services.

Design/Layout

Design service will be provided by MillerKnoll Inc. or its participating dealer based on a fee not to exceed \$65 per hour.

Installation Services

Installation Services will be provided by MillerKnoll Inc. or its participating dealer based on a fee not to exceed \$55 per hour (\$82.50 per hour for after-hours Installation).

See * Additional Notes for Installation & Reconfiguration and Relocation Services.

SIN 337127

Standard Lead Time, Single Order Net Purchase \$100 - 250,000, includes approved Herman Miller Options Products.

Product Line	Discount From List
Action Lab	58.5%
Compass System	58.5%
Co/Struc System	58.5%
Healthcare Carts	18.0%
Mora System	58.5%
Bedside Cabinets	58.5%

SIN 33721P

Packaged Office Furniture - Maximum Order \$250,000 (net).

Includes packaged furniture solutions for customers needing to furnish an office.

SIN 339113H

Standard Lead Time, Single Order Net Purchase \$100 - 500,000, includes approved Herman Miller Options Products.

Product Line	Discount From List
Nemschoff Healthcare Furniture	54.91%

7. Quantity Discounts

Reference item #6.

8. Payment Terms

Net 30 days

9. Foreign Items

None

10. Time of Delivery

- a. 90 day ARO
- b. Expedited delivery: Items listed in the 10-Day section of the catalogs are available for expedited delivery.
- c. Overnight/2-day delivery: Select items may be available for overnight or 2-day delivery. Contact MillerKnoll Inc. or a participating dealer for availability and rates.
- d. Urgent requirements: Agencies may contact contractor or participating dealer to request faster delivery.

Contract Information

continued

11. F.O.B.

F.O.B. destination except Alaska, Hawaii, and Puerto Rico, which will be shipped F.O.B. inland carrier point of exportation.

12. Ordering Address

a. MillerKnoll Inc.

Government Customer Care 0161
855 East Main Avenue
Zeeland MI 49464.

b. For supplies and services, the ordering procedures information on Blanket Purchase Agreements (BPA's) are found in Federal Acquisition Regulation (FAR) 8.405-3.

13. Payment Address.

MillerKnoll Inc.
22764 Network Place
Chicago, IL 60673-1227

14. Warranty

MillerKnoll Inc. commercial warranty applies.

15. Export Packing Charge

Prices supplied on request.

16. Rental Maintenance and Repair Terms

Not applicable

17. Terms and Conditions of Installation/Reconfiguration and Relocation Services

* Additional Notes for Installation & Reconfiguration and Relocation Services:

FOB Destination (Drop Ship): Price includes product delivery to the site, brought to the tailgate of the truck. The purchaser is responsible for unloading.

Prices effective up to the maximum order by SIN only. Above the MO, pricing shall be negotiated on a case-by-case basis between the client and local dealer.

Standard Services are Subject to the Following Conditions:

Installation will be performed during normal weekday working hours.

Adequate facilities for delivery, unloading, moving and staging/storing the product during the installation process shall be provided.

Service work will not be hindered by other trades.

Electric, heat, and adequate elevator service will be furnished without charge.

The immediate installation area shall be complete and free of debris including the carpet/flooring before installation commences.

Any work requiring a licensed electrician is the responsibility of the buyer.

Additional Charges May Apply For:

Major Metro Markets and any non-ground floor installation.

Major Metro Markets include large population centers and urban environments.

Installation in a clinical/medical environment.

Special restrictions or limits established by local laws, ordinances or the directions of the buyer, including but not limited to restrictions on transportations of materials, street access to the job site and/or dock facilities.

Installations outside of a 50 mile radius of the servicing dealer.

Local Prevailing Wage and/or Union Labor Rates.

Any additional charges shall be quoted by the dealer and approved by the buyer prior to performance of the work.

18. Terms and Conditions of Repair Parts

Not applicable

19. Service and Distribution Points

For service and distribution points nearest you, call (800) 851 1196.

20. Participating Dealers

Access Herman Miller web site for current list of participating dealers: www.HermanMiller.com/where-to-buy/contact-a-dealer/. Select your market by using the filter.

21. Preventive Maintenance

Not applicable

22a. Special Attributes.

2022

MillerKnoll earns its 15th consecutive perfect score in Human Rights Campaign Foundation's 2022 Corporate Equality Index.

2021

The OE1 Trolley and Micro Packs are both winners of the 2021 Archiproducts international design competition in the Office Category.

MillerKnoll is named to Michigan's Best and Brightest in Wellness List for 2021.

MillerKnoll is awarded Platinum Rating in CSR by EcoVadis.

OE1 is named winner of Wallpaper's "Most Futuristic Furniture" Category as part of their first-ever Smart Space Awards.

OE1 receives the Workplace category award from Fast Company's 2021 Innovation by Design Awards.

MillerKnoll is named to Fast Company's Annual List of the World's Most Innovative Companies for 2021.

MillerKnoll is recognized as a "Disclosure Leader" by the Chemical Footprint Project (CFP).

Contract Information

continued

MillerKnoll earns its 14th consecutive perfect score in Human Rights Campaign Foundation's 2021 Corporate Equality Index.

MillerKnoll is named to Newsweek's List of America's Most Responsible Companies 2021.

Great Lakes Women's Business Council awards MillerKnoll for "Excellence in Supplier Diversity" in the Best In Class category.

2020

Herman Miller is recognized with a 2020 FSC® Leadership Award for our commitment to responsible forestry management.

Herman Miller is named one of Investor's Business Daily Top 50 Best ESG (Environmental, Social, and Corporate Governance) Companies.

Working Mother names Herman Miller as one of the Best Companies for Dads.

Herman Miller is awarded Platinum Rating in CSR by EcoVadis.

Herman Miller is named Diversity Inc 2020 Noteworthy Company for recruitment efforts, employee development opportunities, leadership accountability, and supplier diversity.

Cosm, by Studio 7.5, receives an iF Gold Award in the Office and Industry category at the iF World Design Awards 2020.

Herman Miller earns its 13th consecutive perfect score in Human Rights Campaign Foundation's 2020 Corporate Equality Index.

2019

Mora System casework, designed by Collective Ten for Herman Miller, receives silver in the Industrial and Life Science Design/Medical Furniture category at the European Product Design Awards.

Mora System casework is awarded GOOD DESIGN Award 2019, selected for design excellence and innovation.

National Minority Supplier Diversity Council (NMSDC) names Herman Miller as the 2019 Class 1 Corporation of the Year for leadership in supplier diversity.

TIME Magazine names Cosm to its list of 100 Best Inventions of 2019.

Herman Miller is named #12 Overall and #2 in Manufacturing on Investor's Business Daily Best ESG (Environmental, Social, Governance) Companies.

Herman Miller is recognized as a silver level Certified Veteran-Friendly Employer by the Michigan Veterans Affairs Agency for a commitment to veteran hiring, retention, and development.

For the second year in a row, Herman Miller receives a Gold Medal from EcoVadis in recognition of Corporate Social Responsibility achievement measured in categories of environment, labor and human rights, ethics, and sustainable procurement.

Herman Miller is named "Frontrunner" in Chemical Footprint Project by Clean Production Action for our chemical management policies and practices.

Herman Miller receives International Interior Design Association and Contract's best showroom design award in the "Large Showroom" category at NeoCon.

Herman Miller earns its 12th consecutive perfect score in Human Rights Campaign Foundation's 2019 Corporate Equality Index.

Cosm, designed by Studio 7.5 for Herman Miller, receives a Red Dot Best of the Best Product Design Award in the "Office Chairs" category.

Lino, designed by Sam Hecht and Kim Colin for Herman Miller, receives an iF Design Award in the Product Design category.

2018

Overlay, designed by Birsell+Seck, receives Interior Design Best of Year Award in the Partitions and Wall Systems category.

Herman Miller receives the "Corporation of the Year" in consumer products award from the Michigan Minority Supplier Development Council.

Herman Miller achieves the Advanced Excellence in Supplier Diversity Award from the Great Lakes Women's Business Council for doing business with women-owned suppliers.

Great Lakes Women's Business Council awards Herman Miller for "Excellence in Supplier Diversity" in the Advanced category.

WEConnect awards Herman Miller an Honorable Mention for global supplier diversity initiatives.

As one of the top-scoring companies in the industry for the 14th consecutive year, Herman Miller has qualified for inclusion in RobecoSAM's 2018 Sustainability Yearbook and receives the Silver Class distinction for excellent sustainability performance—economic, environmental, and social.

For the 11th consecutive year, Herman Miller receives a perfect score on the Human Rights Campaign Foundation's Corporate Equality Index and is designated as Best Place to Work for LGBT equality. This report evaluates U.S. companies in terms of diversity, particularly LGBT-related policies and practices.

Contract Information

continued

Herman Miller receives Gold Medal from EcoVadis in recognition of Corporate Social Sustainability achievement measured in categories of environment, labor and human rights, ethics, and sustainable procurement. EcoVadis operates the first web-based collaborative platform that allows companies to assess the environmental and social performance of their global suppliers.

Aeron receives Good Design Award from The Chicago Athenaeum Museum of Architecture and Design.

The Cosm Chair wins Mix Interiors “Product of the Year—Task” award.

2017

Herman Miller receives “Rising Star Award” from the Michigan Veterans Affairs Agency (MVAA) for exhibiting new and novel approaches to veteran recruitment and hiring.

Herman Miller is named the 2017 “Corporation of the Year” in the consumer products sector by the Michigan Minority Supplier Development Council (MMSDC).

Herman Miller receives a 2017 SEAL (Sustainability, Environmental Achievement and Leadership) Business Sustainability Award. SEAL Award winners are determined by a holistic methodology measuring applicants against established benchmarks that demonstrate impact and progress toward creating a healthy planet and a sustainable future.

Herman Miller earns the 4 Star Diversity Visionary Award. This award celebrates the diversity, equality, and inclusion work of Herman Miller. The award is presented at the annual Diversity Equity Inclusion Summit, held by the Grand Rapids Area Chamber of Commerce.

Herman Miller is named one of the Best and Brightest in Wellness for the 5th year in a row.

Herman Miller earns its 10th consecutive perfect score in Human Rights Campaign Foundation’s 2017 Corporate Equality Index.

As one of the top-scoring companies in the industry for the 13th consecutive year, Herman Miller has qualified for inclusion in RobecoSAM’s 2017 Sustainability Yearbook and receives the Bronze Class distinction for excellent economic, environmental, and social sustainability performance. The selection criteria for inclusion in the Yearbook becomes more rigorous each year, and only the top 15 percent of companies within each industry are selected.

Herman Miller once again earns the WorldatWork Seal of Distinction, a unique standard of excellence in work-life effectiveness that shows we provide a distinct, mutually beneficial workplace experience. Herman Miller is the only furniture manufacturer among the 160 companies across the U.S. and Canada honored with the award.

Herman Miller’s Mora wins Nightingale Silver Award in the “Furniture Collections” category at the 2017 Healthcare Design Conference.

2016

Herman Miller earns 9th consecutive perfect score in Human Rights Campaign Foundation’s Corporate Equality Index and is designated as Best Place to Work for LGBT equality.

Herman Miller is recognized as the Business of the Year at the Annual Meeting of the West Michigan Environmental Action Council (WMEAC) for being an outstanding partner in support of the growth of WMEAC’s programs. WMEAC’s award goes to the business with the greatest depth and breadth of support, unwavering dedication to environmental action in West Michigan, and a strong corporate commitment to environmental advocacy.

The 101 Best and Brightest Sustainable Companies once again (5th consecutive year) recognizes Herman Miller as an organization in Michigan (and for the first time, in the nation) that exhibits leadership and innovation in its approach to sustainability. This award celebrates those companies that are making their businesses more sustainable, the lives of their employees better, and the community, both locally and globally, more responsible as a whole.

Herman Miller is recognized by the Michigan Minority Supplier Development Council (MMSDC) as a “Corporation of the Year”. Additionally, we are the only West Michigan company this year to receive an “Ambassadors Championing Excellence” Award from the MMSDC.

Herman Miller is recognized with “2016 Excellence in Supplier Diversity Award” from the Great Lakes Women’s Business Council.

Herman Miller is recognized as a 2016 Healthiest 100 Workplace in America, ranking 49th in the country for our commitment to health and exceptional corporate wellness programming.

Herman Miller receives the Best and Brightest in Wellness Award for the 4th year in a row. This program is an innovative initiative that recognizes and celebrates quality and excellence in health awareness.

The Michigan Occupational Safety and Health Administration renews Herman Miller’s “Star” status, the highest workplace safety and health designation, for the Hickory facility in Spring Lake.

Plex Lounge Furniture from Herman Miller receives #MetropolisLikes award at NeoCon 2016.

Plex Lounge Furniture from Herman Miller receives Interior Design HiP Award for Workplace Seating/Lounge at NeoCon 2016.

Herman Miller is named a 2016 Women on Boards Winning Company. Companies selected for this recognition are considered champions of board diversity as 20 percent or more of their board seats are occupied by women.

Herman Miller is selected for inclusion in the 2016 RobecoSAM Sustainability Yearbook for the 12th consecutive year.

Herman Miller again earns the WorldatWork Work-Life 2016 Seal of Distinction. This award identifies organizations that focus on programs that promote work-life balance and overall well-being.

Contract Information

continued

22b. Section 508 Compliance

Not applicable

23. Unique Entity ID: Q2K3MSZ843D8

24. Registered in System for Award Management (www.SAM.gov) Database

25. Cancellation

Prior to production, no cancellation charge will apply. After production, only actual cost incurred that the contractor can demonstrate if items are sold after 3 months.

26. Restocking Charges

Agencies must notify the contractor for authorization prior to returning any items. The customer agency will be required to pay all packaging and return freight charges. A restocking fee of 50% for Systems Furniture and 35% for all other product lines will be charged for any returned items.

Returns and restocking policy is not applicable to Options products, products under SIN 337127, 339113H, NaughtOne and Nemschoff products.

MillerKnoll Inc. Miscellaneous Information:

Federal ID Number: 38-0837640

Commercial and Government Entity Code (CAGE): 40636

Data Universal Numbering System (DUNS) 00-601-2801

Commercial Entity Code (CEC): 00702290J

Introduction	page 2
Commend™ Nurses Station	3
Infrastructure	5
Cladding	13
Surfaces	34
Supports	58
Screen	68
Storage	74
Energy Distribution	78
Indices	83
By Name	83
By Number	85
Appendices	
20-Day or Less/Assigned Lead-Time Order Information	
Textiles Application Chart-Healthcare Workspaces	
Textile Colors-Healthcare Workspaces	
For the latest materials information, refer to the Materials pages on HermanMiller.com.	

A Note on the Organization of This Book

There are a few signals that will help you understand the organization of this book. Once you know them, you should be able to find your way around easily.

Like a newspaper, this book is formatted with columns of text and illustrations that run vertically.

Information wraps from one column to the next and continues for as many pages as it needs to.

Black bars are clues.

A black bar at the top of a page signals the start of information about a product.

This information is divided into two sections, each signaled by a black bar. Product Information includes a description, additional notes, and dimensional drawings. Specification Information, which always begins at the top of a column, includes a series of steps. Each step represents a decision you need to make in order to complete your product number. Steps must be followed sequentially. The number of pages needed to complete information on a product varies; some will be complete in one page; others may fill three or four pages. Just continue going through the steps until you run into the next product, signaled by the black bar at the top of the page.

Black tabs running along the outside edge of the page help you locate what section you are in or what section you want to go to. You can thumb forwards or backwards to find a section; tabs and text appear on both sides of the page.

The additional pages in the back of the book include the appendices and indices. They are signaled by a long black bar running along the outside edge of the page.

The index is presented two ways.

The first index is in alphabetical order by product name. It can be helpful if you are new to the products and numbering scheme or if you are looking for a type of product, such as work chair or round table.

The second index is by product number. It lists, in alphanumeric order, the base product number, typically a five-digit number.

General Information

This book is effective October 7, 2024, subject to change without notice. Products may be purchased from authorized Herman Miller dealers who will quote prices upon request. For more information about our products and services or to see a list of dealers, visit www.HermanMiller.com.

All prices are list prices. Additional services, such as planning services, design, storage, and installation, are not included and must be added to these prices when the additional services are requested.

Illustrations, specifications, and prices are based on the latest information at the time of publication. The right is reserved to make changes at any time without notice in prices, fabrics, finishes, materials, specifications, and models, and also to discontinue models and finishes.

Dimensions shown in the drawings are engineering drawing dimensions rounded up to the nearest 1/8". Product is shipped set up or knocked down. Products that include "Shipped knocked down" in the description require some assembly. If this statement does not appear in the description, the product is shipped assembled.

Service problems are normally handled by a Herman Miller authorized dealer. Where this cannot be accomplished on a local level, service problems should be referred to the Customer Care Representative for your region, Herman Miller, Inc., Zeeland, Michigan 49464.

20-Day or Less/Assigned Lead-Time Shipments

All products and options in this price book not designated by an Assigned Program icon  will ship in **20 business days or less** after being acknowledged by Herman Miller.

Products and options designated by an  are on the assigned lead-time program and may ship in 20 days, less than 20 days, or more than 20 days from order acknowledgement.

Infrastructure

Cladding

Surfaces

Supports

Screen

Storage

Energy Distribution

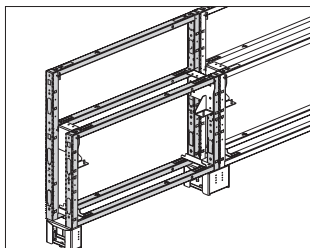

Product Information

Description

This frame accepts cladding on both sides to conceal the structure. It can be used mid-run or as end-of-run. Frame includes frame-to-frame brackets, interior light seals and all necessary hardware. Frame has no base options. Frame feet and appropriate end panels are ordered separately.

Notes

When frame is used as end-of-run, Commend loop leg (HQ540.) is required.
Order the following products separately:

- Commend frame feet (HQ125.)

Order the following optional products separately:

- Commend end panel (HQ500.)
- Commend change of height end panel (HQ505.)
- Commend seismic anchors (HQ140.)
- Commend floor anchors (HQ150.)
- Commend junction box (HQ790.)

Frames accept multiple junction boxes (HQ790.) based on frame width.

Order junction boxes separately.

Frame Width—Junction box quantity

03—2

04—2

05—2

06—4

07—4

08—4

Dimensions

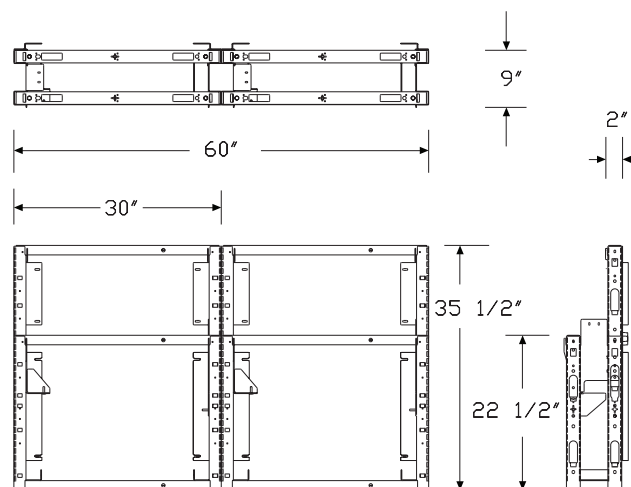

Specification Information

Step 1.

HQ100.

Step 2. Height

30 30" high

42 42" high

Step 3. Width

03 3' wide

04 4' wide

05 5' wide

06 6' wide

07 7' wide

08 8' wide

Prices for Steps 1-3.

	03	04	05	06	07	08
HQ100. 30	\$1259	1385	2392	2517	2642	2727
42	\$1595	1721	2937	3060	3187	3313

Commend™ Corner Frame

HQ110.

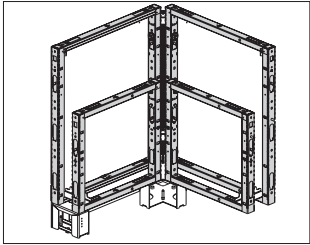

Product Information
Description
This corner frame accepts cladding on both sides to conceal the structure. It can be used mid-run or as end-of-run. Frame includes corner protector, frame-to-frame brackets, interior light seals and all necessary hardware. Frame has no base options. Frame feet and appropriate end panels are ordered separately.
Notes
Corner protector is anodized and stands proud of exterior cladding to protect corner upon impact.
When no work surface is used, frame accepts Commend corner utility shelf (HQ411.), ordered separately.
Order the following products separately:
• Commend frame feet (HQ125.)
Order the following optional products separately:
• Commend end panel (HQ500.)
• Commend change of height end panel (HQ505.)
• Commend seismic anchor bracket (HQ140.)
• Commend floor anchor bracket (HQ150.)
• Commend junction box (HQ790.)
Corner frame accepts up to 2 junction boxes (HQ790.), ordered separately.
Dimensions

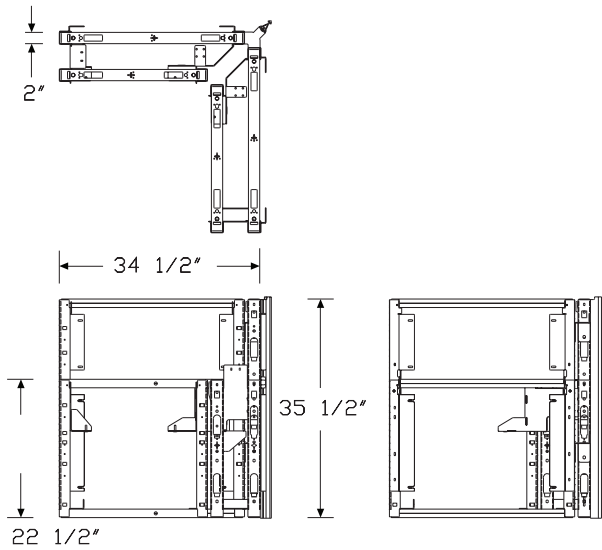

Specification Information
Step 1.
HQ110.
Step 2. Height
30 30" high
42 42" high
Step 3. Width
03 3' wide x 3' wide
Prices for Steps 1-3.
HQ110. 30
42
Step 4. Corner Protector
AN anodized

Commend™ Corner Close Out Frame HQ120.

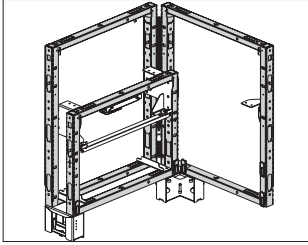

Product Information

Description

This corner closeout frame accepts cladding on both sides to conceal the structure. It is used as an end-of-run support. It allows for a larger work surface than the corner frame, giving the user 6" more usable surface. Frame includes corner protector, frame-to-frame brackets, interior light seals and all necessary hardware. Frame has no base options. Frame feet and appropriate end panels are ordered separately.

Notes

Only available in 42" height.

Handedness is determined from interior/user side of the application.

Corner protector is anodized and stands proud of exterior cladding to protect corner upon impact.

Order the following products separately:

- Commend frame feet (HQ125.)
- Commend end panel (HQ500.)

Order the following optional products separately:

- Commend seismic anchor bracket (HQ140.)
- Commend floor anchor bracket (HQ150.)
- Commend change of height end panel (HQ505.)
- Commend junction box (HQ790.)
- Commend cable trough (HQ791.)

Corner close out frame accepts up to 2 junction boxes (HQ790.), ordered separately.

Dimensions

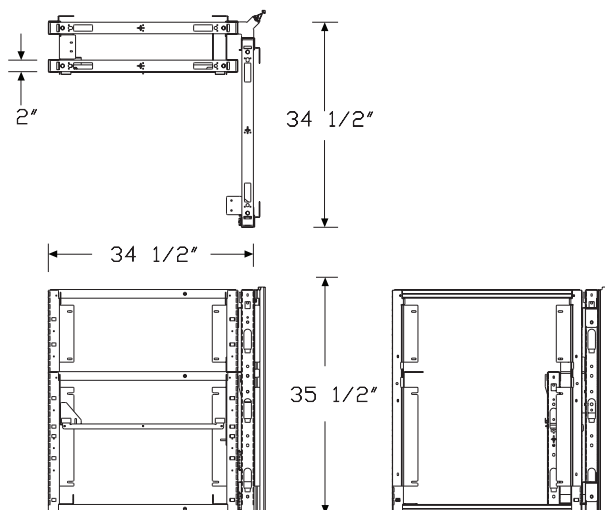

Specification Information

Step 1.

HQ120.

Step 2. Height

42 42" high

Step 3. Width

3L 3' wide x 3' wide, return frame left side

3R 3' wide x 3' wide, return frame right side

Prices for Steps 1-3.

	3L	3R
HQ120. 42	\$4696	4696

Step 4. Corner Protector

AN	anodized	+\$0
----	----------	------

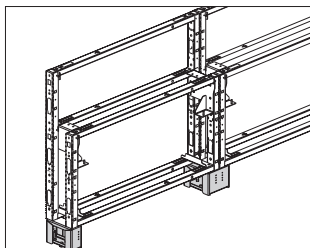

Product Information

Description

These feet attach to the underside of the frame to support the system and have 1½" of leveling adjustment. Feet are concealed behind the toe kick. Attachment hardware included.

Notes

See planning guide for rules for use of each type of foot.

Order the following products separately:

- Commend frame (HQ100.)
- Commend corner frame (HQ110.)
- Commend corner close out frame (HQ120.)
- Commend toe kick (HQ205.)
- Commend corner toe kick (HQ215.)

Order the following optional products separately:

- Commend seismic anchor bracket (HQ140.)
- Commend floor anchor bracket (HQ150.)

Dimensions

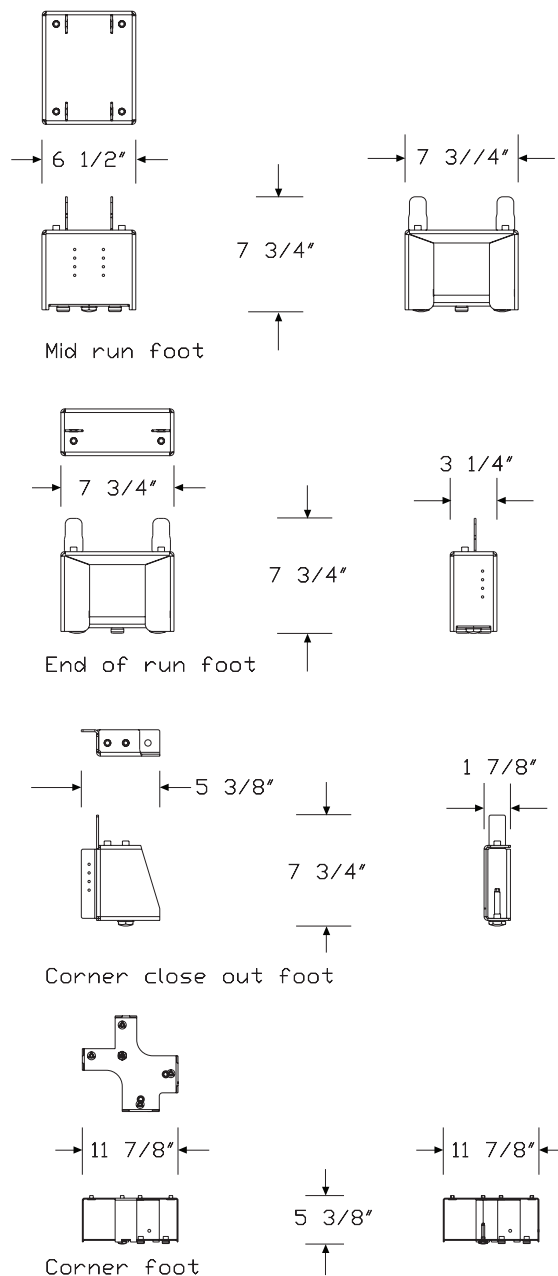

Specification Information

Step 1.

HQ125.

Step 2. Type

- C corner, single foot
- E end of run, single foot
- K corner closeout feet
- M mid run, single foot shared between frames

Step 3. Handedness

For corner closeout feet (K)

- L left hand
- R right-hand

For corner, single foot (C), end of run, single foot (E), or mid run, single foot shared between frames (M)

- N nonhanded

Prices for Steps 1-3.

	L	N	R
HQ125. C	—	\$568	—
E	—	\$515	—
K	\$1133	—	1133
M	—	\$568	—

Commend™ Seismic Anchor Bracket

HQ140.

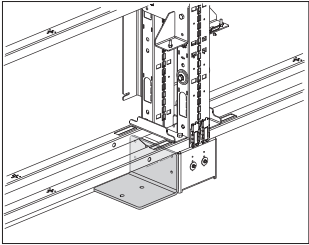

Product Information
Description This bracket fastens the frame foot to the floor when necessary for seismic locations. Bracket finish is black. Anchor hardware not included.
Notes Anchor hardware is field supplied.
Dimensions

Specification Information
Step 1. HQ140.
\$246

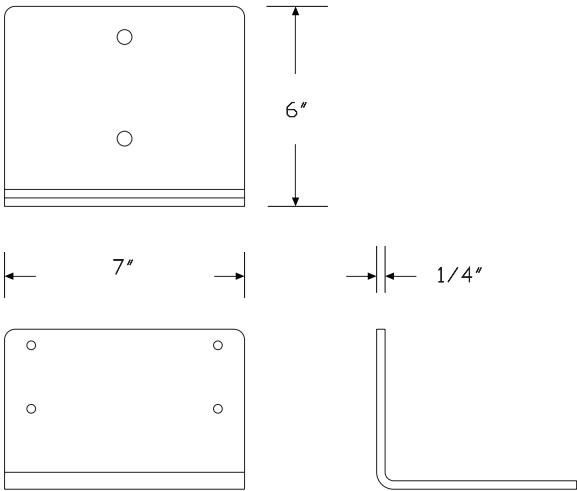

Commend™ Floor Anchor Bracket

HQ150.

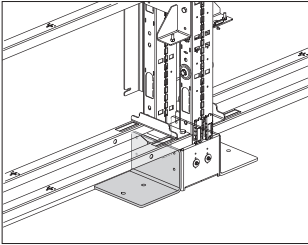

Commend™ Infrastructure

Product Information

Description

This bracket fastens the frame foot to the floor. Bracket finish is black. Anchor hardware not included.

Notes

Anchor hardware is field supplied.

For areas requiring seismic bracing, order Commend seismic anchor bracket (HQ140.).

Dimensions

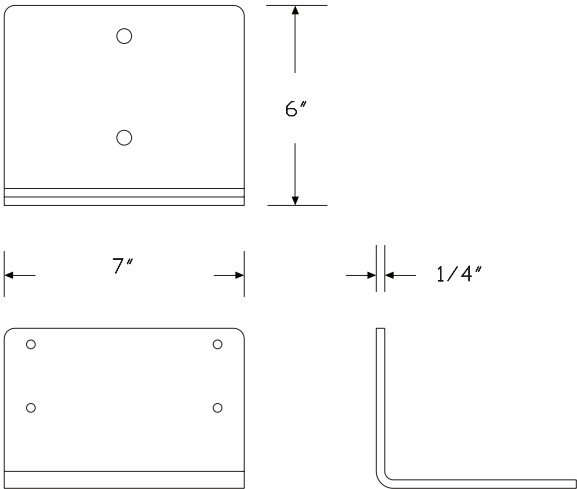

Specification Information

Step 1.

HQ150. \$262

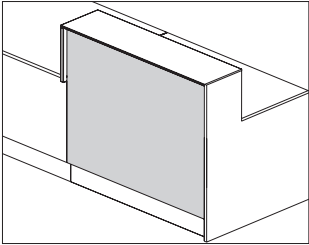

Product Information

Description
This exterior cladding attaches to the approach side of the frame and conceals the structure. 1-piece or 2-piece cladding covers the overall frame height and comes in high-pressure laminate or Corian®. 2-piece cladding includes horizontal light seal for use between cladding pieces. Attachment hardware included.

- Notes**
Specify width and height of cladding to match width and height of frame.
When specifying 2-piece cladding (C2), both pieces will be the same material.
For Corian cladding in 6', 7', and 8' widths (06, 07, 08), 1-piece cladding is not available for 42"-high frames.
For solid color laminate, specify horizontal (HRG) grain direction.
Order the following products separately:
- Commend frame (HQ100.)
 - Commend toe kick (HQ205.)

Dimensions

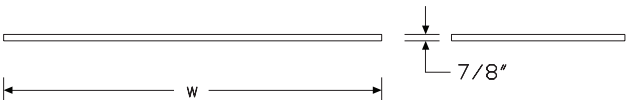

For 30" high frame, 1 Piece Cladding

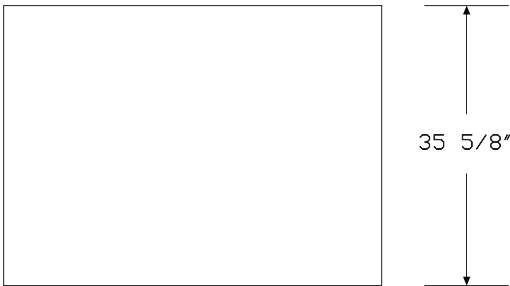

For 42" high frame, 1 Piece Cladding

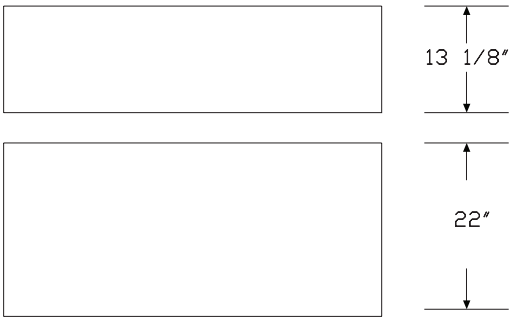

For 42" high frame, 2 Piece Cladding

Commend™ Cladding

Specification Information					
Step 1.					
HQ200.					
Step 2. Frame Height					
30	30" high				
42	42" high				
Step 3. Frame Width					
03	3' wide				
04	4' wide				
05	5' wide				
06	6' wide				
07	7' wide				
08	8' wide				
Step 4. Cladding Material					
K	corian				
H	high-pressure laminate/thermoplastic edge				
Step 5. Cladding Configuration					
<i>For 30" high (30) with 3' wide (03), 4' wide (04), 5' wide (05), 6' wide (06), 7' wide (07), or 8' wide (08) with corian (K) or high-pressure laminate/thermoplastic edge (H)</i>					
C1	one piece cladding, one finish				
<i>For 42" high (42) with 3' wide (03), 4' wide (04), or 5' wide (05) with corian (K)</i>					
C1	one piece cladding, one finish				
C2	two piece cladding, two finishes				
<i>For 42" high (42) with 3' wide (03), 4' wide (04), 5' wide (05), 6' wide (06), 7' wide (07), or 8' wide (08) with high-pressure laminate/thermoplastic edge (H)</i>					
C1	one piece cladding, one finish				
C2	two piece cladding, two finishes				
<i>For 42" high (42) with 6' wide (06), 7' wide (07), or 8' wide (08) with corian (K)</i>					
C2	two piece cladding, two finishes				
Prices for Steps 1-5.					
		KC1	KC2	HC1	HC2
HQ200. 30 03		\$2852	—	833	—
04		\$3857	—	940	—
05		\$4865	—	1008	—
06		\$5869	—	1133	—
07		\$6876	—	1259	—
08		\$7881	—	1385	—

42 03	\$3857	5199	1133	2173
04	\$4865	6205	1218	2306
05	\$5869	7211	1469	2433
06	—	\$8216	1595	2601
07	—	\$9223	1721	2642
08	—	\$10898	1913	2727

Step 6. Grain Direction

For 3' wide (03), 4' wide (04), or 5' wide (05) with high-pressure laminate/thermoplastic edge (H)

HRG	horizontal grain	+\$0
VTG	vertical grain	+\$0

For 6' wide (06), 7' wide (07), or 8' wide (08) with high-pressure laminate/thermoplastic edge (H)

HRG	horizontal grain	+\$0
-----	------------------	------

Step 7. Cladding Material Finish

For corian (K) with one piece cladding, one finish (C1)

1S	savannah	+\$530
1U	sahara	+\$113
4I	sandstone	+\$113
58	cameo white	+\$0
ANC	antarctica	+\$530
CQ	glacier white	+\$0
CRT	concrete	+\$946
DVC	dove	+\$946
OQ	silt	+\$530
QB	bisque	+\$0
SVG	silver gray	+\$0

For high-pressure laminate/thermoplastic edge (H) with one piece cladding, one finish (C1)

125	natural maple (CP)	+\$0
126	natural cherry (CP)	+\$0
127	walnut (CP)	+\$0
139	light ash (CP)	+\$0
140	warm ash (CP)	+\$0
76	light brown walnut	+\$0
8Q	folkstone grey (CP)	+\$0
91	white (CP)	+\$0
98	studio white (CP)	+\$0
CL	cool grey neutral	+\$0
HF	inner tone light	+\$0
HP	light anigre	+\$0
LBA	clear on ash (CP)	+\$0
LBB	oak on ash (CP)	+\$0
LBC	walnut on ash (CP)	+\$0
LBF	neutral twill	+\$0
LBJ	graphite twill	+\$0
LBQ	white twill	+\$0
LBR	phantom ecru	+\$0
LBS	phantom cocoa	+\$0
LBU	medium matte walnut (CP)	+\$0
LBV	warm grey teak	+\$0
LT	light tone	+\$0
LU	soft white	+\$0
WL	warm stone (CP)	+\$0
WN	warm grey neutral	+\$0

Step 8. Edge Finish

For high-pressure laminate/thermoplastic edge (H) with one piece cladding, one finish (C1)

125	natural maple (CP)	+\$0
126	natural cherry (CP)	+\$0
127	walnut (CP)	+\$0
139	light ash (CP)	+\$0
140	warm ash (CP)	+\$0
76	light brown walnut	+\$0
8Q	folkstone grey (CP)	+\$0
91	white (CP)	+\$0
98	studio white (CP)	+\$0
CL	cool grey neutral	+\$0
G1	graphite (CP)	+\$0
HF	inner tone light	+\$0
HP	light anigre	+\$0
LBA	clear on ash (CP)	+\$0
LBB	oak on ash (CP)	+\$0
LBC	walnut on ash (CP)	+\$0
LBF	neutral twill	+\$0
LBJ	graphite twill	+\$0
LBQ	white twill	+\$0
LBR	phantom ecru	+\$0
LBS	phantom cocoa	+\$0
LBU	medium matte walnut (CP)	+\$0
LBV	warm grey teak	+\$0
LU	soft white	+\$0
WL	warm stone (CP)	+\$0

Step 9. Lower Cladding Material Finish

For corian (K) with two piece cladding, two finishes (C2)

1S	savannah	+\$530
1U	sahara	+\$113
4I	sandstone	+\$113
58	cameo white	+\$0
ANC	antarctica	+\$530
CQ	glacier white	+\$0
CRT	concrete	+\$946
DVC	dove	+\$946
IQ	aurora	+\$530
OQ	silt	+\$530
QB	bisque	+\$0
SVG	silver gray	+\$0

For high-pressure laminate/thermoplastic edge (H) with two piece cladding, two finishes (C2)

125	natural maple (CP)	+\$0
126	natural cherry (CP)	+\$0
127	walnut (CP)	+\$0
139	light ash (CP)	+\$0
140	warm ash (CP)	+\$0
76	light brown walnut	+\$0
8Q	folkstone grey (CP)	+\$0
91	white (CP)	+\$0
98	studio white (CP)	+\$0
CL	cool grey neutral	+\$0
HF	inner tone light	+\$0
HP	light anigre	+\$0
LBA	clear on ash (CP)	+\$0
LBB	oak on ash (CP)	+\$0
LBC	walnut on ash (CP)	+\$0
LBF	neutral twill	+\$0
LBJ	graphite twill	+\$0
LBQ	white twill	+\$0
LBR	phantom ecru	+\$0
LBS	phantom cocoa	+\$0
LBU	medium matte walnut (CP)	+\$0
LBV	warm grey teak	+\$0
LT	light tone	+\$0
LU	soft white	+\$0
WL	warm stone (CP)	+\$0
WN	warm grey neutral	+\$0

Step 10. Lower Cladding Edge Finish

For high-pressure laminate/thermoplastic edge (H) with two piece cladding, two finishes (C2)

125	natural maple (CP)	+\$0
126	natural cherry (CP)	+\$0
127	walnut (CP)	+\$0
139	light ash (CP)	+\$0
140	warm ash (CP)	+\$0
76	light brown walnut	+\$0
8Q	folkstone grey (CP)	+\$0
91	white (CP)	+\$0
98	studio white (CP)	+\$0
CL	cool grey neutral	+\$0
G1	graphite (CP)	+\$0
HF	inner tone light	+\$0
HP	light anigre	+\$0
LBA	clear on ash (CP)	+\$0
LBB	oak on ash (CP)	+\$0
LBC	walnut on ash (CP)	+\$0
LBF	neutral twill	+\$0
LBJ	graphite twill	+\$0
LBQ	white twill	+\$0
LBR	phantom ecru	+\$0
LBS	phantom cocoa	+\$0
LBU	medium matte walnut (CP)	+\$0
LBV	warm grey teak	+\$0
LU	soft white	+\$0
WL	warm stone (CP)	+\$0
WN	warm grey neutral	+\$0

Step 11. Upper Cladding Material Finish

For corian (K) with two piece cladding, two finishes (C2)

1S	savannah	+\$256
1U	sahara	+\$55
4I	sandstone	+\$55
58	cameo white	+\$0
ANC	antarctica	+\$256
CQ	glacier white	+\$0
CRT	concrete	+\$457
DVC	dove	+\$457
OQ	silt	+\$256
QB	bisque	+\$0
SVG	silver gray	+\$0

For high-pressure laminate/thermoplastic edge (H) with two piece cladding, two finishes (C2)

125	natural maple (CP)	+\$0
126	natural cherry (CP)	+\$0
127	walnut (CP)	+\$0
139	light ash (CP)	+\$0
140	warm ash (CP)	+\$0
76	light brown walnut	+\$0
8Q	folkstone grey (CP)	+\$0
91	white (CP)	+\$0
98	studio white (CP)	+\$0
CL	cool grey neutral	+\$0
HF	inner tone light	+\$0
HP	light anigre	+\$0
LBA	clear on ash (CP)	+\$0
LBB	oak on ash (CP)	+\$0
LBC	walnut on ash (CP)	+\$0
LBF	neutral twill	+\$0
LBJ	graphite twill	+\$0
LBQ	white twill	+\$0
LBR	phantom ecru	+\$0
LBS	phantom cocoa	+\$0
LBU	medium matte walnut (CP)	+\$0
LBV	warm grey teak	+\$0
LT	light tone	+\$0
LU	soft white	+\$0
WL	warm stone (CP)	+\$0
WN	warm grey neutral	+\$0

Step 12. Upper Cladding Edge Finish

For high-pressure laminate/thermoplastic edge (H) with two piece cladding, two finishes (C2)

125	natural maple (CP)	+\$0
126	natural cherry (CP)	+\$0
127	walnut (CP)	+\$0
139	light ash (CP)	+\$0
140	warm ash (CP)	+\$0
76	light brown walnut	+\$0
8Q	folkstone grey (CP)	+\$0
91	white (CP)	+\$0
98	studio white (CP)	+\$0
CL	cool grey neutral	+\$0
G1	graphite (CP)	+\$0
HF	inner tone light	+\$0
HP	light anigre	+\$0
LBA	clear on ash (CP)	+\$0
LBB	oak on ash (CP)	+\$0
LBC	walnut on ash (CP)	+\$0
LBF	neutral twill	+\$0
LBJ	graphite twill	+\$0
LBQ	white twill	+\$0
LBR	phantom ecru	+\$0
LBS	phantom cocoa	+\$0
LBU	medium matte walnut (CP)	+\$0
LBV	warm grey teak	+\$0
LU	soft white	+\$0
WL	warm stone (CP)	+\$0
WN	warm grey neutral	+\$0

Step 13. Light Seal

8Q	folkstone grey (CP)	+\$0
-----------	---------------------	------

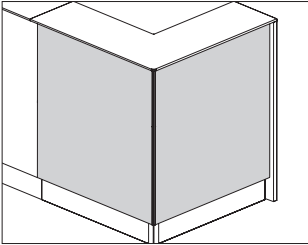

Product Information

Description

This corner exterior cladding attaches to the approach side of the corner frame or corner close out frame and conceals the structure. It comes with all necessary components to conceal both exterior sides of the corner frame. 1-piece or 2-piece cladding covers the overall frame height and comes in high-pressure laminate or Corian®. 2-piece cladding includes horizontal light seal for use between cladding pieces. Attachment hardware included.

Notes

For solid color laminate, specify horizontal (HRG) grain direction.
Order the following products separately:

- Commend corner frame (HQ110.)
- Commend corner close out frame (HQ120.)
- Commend corner toe kick (HQ215.)

Dimensions

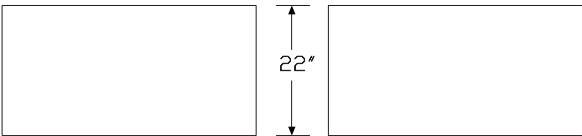
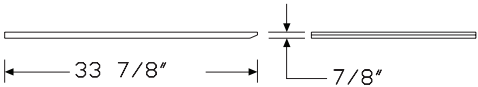

For 30" high frame, 1 Piece Cladding, Quantity 2

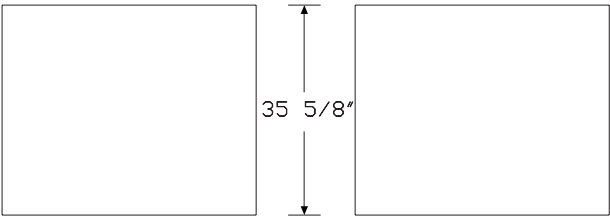

For 42" high frame, 1 Piece Cladding, Quantity 2

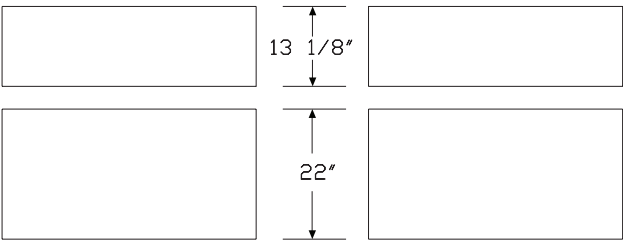

For 42" high frame, 2 Piece Cladding, Quantity 2

Commend™ Corner Exterior Cladding

continued

Specification Information

Step 1.

HQ210.

Step 2. Frame Height

30 30" high

42 42" high

Step 3. Frame Width

03 3' wide x 3' wide

Step 4. Cladding Material

K corian

H high-pressure laminate/thermoplastic edge

Step 5. Cladding Configuration

For 30" high (30)

C1 one piece cladding, one finish

For 42" high (42)

C1 one piece cladding, one finish

C2 two piece cladding, two finishes

Prices for Steps 1-5.

	KC1	KC2	HC1	HC2
HQ210. 30 03	\$5032	—	1678	—
42 03	\$6843	8971	2098	2937

Step 6. Grain Direction

For high-pressure laminate/thermoplastic edge (H)

HRG horizontal grain +\$0

VTG vertical grain +\$0

Step 7. Cladding Material Finish

For corian (K) with one piece cladding, one finish (C1)

1S	savannah	+\$548
1U	sahara	+\$117
4I	sandstone	+\$117
58	cameo white	+\$0
ANC	antarctica	+\$548
CQ	glacier white	+\$0
CRT	concrete	+\$978
DVC	dove	+\$978
IQ	aurora	+\$548
OQ	silt	+\$548
QB	bisque	+\$0
SVG	silver gray	+\$0

For high-pressure laminate/thermoplastic edge (H) with one piece cladding, one finish (C1)

125	natural maple (CP)	+\$0
126	natural cherry (CP)	+\$0
127	walnut (CP)	+\$0
139	light ash (CP)	+\$0
140	warm ash (CP)	+\$0
76	light brown walnut	+\$0
8Q	folkstone grey (CP)	+\$0
91	white (CP)	+\$0
98	studio white (CP)	+\$0
CL	cool grey neutral	+\$0
HF	inner tone light	+\$0
HP	light anigre	+\$0
LBA	clear on ash (CP)	+\$0
LBB	oak on ash (CP)	+\$0
LBC	walnut on ash (CP)	+\$0
LBF	neutral twill	+\$0
LBJ	graphite twill	+\$0
LBQ	white twill	+\$0
LBR	phantom ecru	+\$0
LBS	phantom cocoa	+\$0
LBU	medium matte walnut (CP)	+\$0
LBV	warm grey teak	+\$0
LT	light tone	+\$0
LU	soft white	+\$0
WL	warm stone (CP)	+\$0
WN	warm grey neutral	+\$0

Commend™ Cladding

Commend™ Corner Exterior Cladding

continued

Commend™ Cladding

Step 8. Edge Finish

For high-pressure laminate/thermoplastic edge (H) with one piece cladding, one finish (C1)

125	natural maple (CP)	+\$0
126	natural cherry (CP)	+\$0
127	walnut (CP)	+\$0
139	light ash (CP)	+\$0
140	warm ash (CP)	+\$0
76	light brown walnut	+\$0
8Q	folkstone grey (CP)	+\$0
91	white (CP)	+\$0
98	studio white (CP)	+\$0
CL	cool grey neutral	+\$0
G1	graphite (CP)	+\$0
HF	inner tone light	+\$0
HP	light anigre	+\$0
LBA	clear on ash (CP)	+\$0
LBB	oak on ash (CP)	+\$0
LBC	walnut on ash (CP)	+\$0
LBF	neutral twill	+\$0
LBJ	graphite twill	+\$0
LBQ	white twill	+\$0
LBR	phantom ecru	+\$0
LBS	phantom cocoa	+\$0
LBU	medium matte walnut (CP)	+\$0
LBV	warm grey teak	+\$0
LU	soft white	+\$0
WL	warm stone (CP)	+\$0
WN	warm grey neutral	+\$0

Step 9. Lower Cladding Material Finish

For corian (K) with two piece cladding, two finishes (C2)

1S	savannah	+\$548
1U	sahara	+\$117
4I	sandstone	+\$117
58	cameo white	+\$0
ANC	antarctica	+\$548
CQ	glacier white	+\$0
CRT	concrete	+\$978
DVC	dove	+\$978
IQ	aurora	+\$548
OQ	silt	+\$548
QB	bisque	+\$0
SVG	silver gray	+\$0

For high-pressure laminate/thermoplastic edge (H) with two piece cladding, two finishes (C2)

125	natural maple (CP)	+\$0
126	natural cherry (CP)	+\$0
127	walnut (CP)	+\$0
139	light ash (CP)	+\$0
140	warm ash (CP)	+\$0
76	light brown walnut	+\$0
8Q	folkstone grey (CP)	+\$0
91	white (CP)	+\$0
98	studio white (CP)	+\$0
CL	cool grey neutral	+\$0
HF	inner tone light	+\$0
HP	light anigre	+\$0
LBA	clear on ash (CP)	+\$0
LBB	oak on ash (CP)	+\$0
LBC	walnut on ash (CP)	+\$0
LBF	neutral twill	+\$0
LBJ	graphite twill	+\$0
LBQ	white twill	+\$0
LBR	phantom ecru	+\$0
LBS	phantom cocoa	+\$0
LBU	medium matte walnut (CP)	+\$0
LBV	warm grey teak	+\$0
LT	light tone	+\$0
LU	soft white	+\$0
WL	warm stone (CP)	+\$0
WN	warm grey neutral	+\$0

Commend™ Corner Exterior Cladding

continued

Step 10. Lower Cladding Edge Finish

For high-pressure laminate/thermoplastic edge (H) with two piece cladding, two finishes (C2)

125	natural maple (CP)	+\$0
126	natural cherry (CP)	+\$0
127	walnut (CP)	+\$0
139	light ash (CP)	+\$0
140	warm ash (CP)	+\$0
76	light brown walnut	+\$0
8Q	folkstone grey (CP)	+\$0
91	white (CP)	+\$0
98	studio white (CP)	+\$0
CL	cool grey neutral	+\$0
G1	graphite (CP)	+\$0
HF	inner tone light	+\$0
HP	light anigre	+\$0
LBA	clear on ash (CP)	+\$0
LBB	oak on ash (CP)	+\$0
LBC	walnut on ash (CP)	+\$0
LBF	neutral twill	+\$0
LBJ	graphite twill	+\$0
LBQ	white twill	+\$0
LBR	phantom ecru	+\$0
LBS	phantom cocoa	+\$0
LBU	medium matte walnut (CP)	+\$0
LBV	warm grey teak	+\$0
LU	soft white	+\$0
WL	warm stone (CP)	+\$0
WN	warm grey neutral	+\$0

For high-pressure laminate/thermoplastic edge (H) with two piece cladding, two finishes (C2)

125	natural maple (CP)	+\$0
126	natural cherry (CP)	+\$0
127	walnut (CP)	+\$0
139	light ash (CP)	+\$0
140	warm ash (CP)	+\$0
76	light brown walnut	+\$0
8Q	folkstone grey (CP)	+\$0
91	white (CP)	+\$0
98	studio white (CP)	+\$0
CL	cool grey neutral	+\$0
HF	inner tone light	+\$0
HP	light anigre	+\$0
LBA	clear on ash (CP)	+\$0
LBB	oak on ash (CP)	+\$0
LBC	walnut on ash (CP)	+\$0
LBF	neutral twill	+\$0
LBJ	graphite twill	+\$0
LBQ	white twill	+\$0
LBR	phantom ecru	+\$0
LBS	phantom cocoa	+\$0
LBU	medium matte walnut (CP)	+\$0
LBV	warm grey teak	+\$0
LT	light tone	+\$0
LU	soft white	+\$0
WL	warm stone (CP)	+\$0
WN	warm grey neutral	+\$0

Commend™ Cladding

Step 11. Upper Cladding Material Finish

For corian (K) with two piece cladding, two finishes (C2)

1S	savannah	+\$197
1U	sahara	+\$42
4I	sandstone	+\$42
58	cameo white	+\$0
ANC	antarctica	+\$197
CQ	glacier white	+\$0
CRT	concrete	+\$352
DVC	dove	+\$352
OQ	silt	+\$197
QB	bisque	+\$0

Commend™ Corner Exterior Cladding

continued

Commend™ Cladding

Step 12. Upper Cladding Edge Finish

For high-pressure laminate/thermoplastic edge (H) with two piece cladding, two finishes (C2)

125	natural maple (CP)	+\$0
126	natural cherry (CP)	+\$0
127	walnut (CP)	+\$0
139	light ash (CP)	+\$0
140	warm ash (CP)	+\$0
76	light brown walnut	+\$0
8Q	folkstone grey (CP)	+\$0
91	white (CP)	+\$0
98	studio white (CP)	+\$0
CL	cool grey neutral	+\$0
G1	graphite (CP)	+\$0
HF	inner tone light	+\$0
HP	light anigre	+\$0
LBA	clear on ash (CP)	+\$0
LBB	oak on ash (CP)	+\$0
LBC	walnut on ash (CP)	+\$0
LBF	neutral twill	+\$0
LBJ	graphite twill	+\$0
LBQ	white twill	+\$0
LBR	phantom ecru	+\$0
LBS	phantom cocoa	+\$0
LBU	medium matte walnut (CP)	+\$0
LBV	warm grey teak	+\$0
LU	soft white	+\$0
WL	warm stone (CP)	+\$0
WN	warm grey neutral	+\$0

Step 13. Light Seal

8Q	folkstone grey (CP)	+\$0
----	---------------------	------

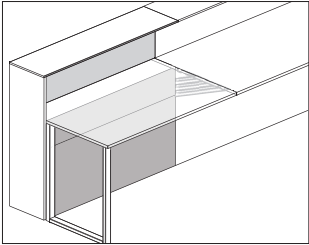

Product Information
Description
This interior cladding attaches to the user side of the frame and conceals the structure. 2-piece or 3-piece cladding covers the overall frame height. Interior cladding is metal and comes with standard power knockouts. Attachment hardware included.
Notes
Specify width and height of cladding to match width and height of frame.
30"-high cladding has 2 pieces to cover overall interior frame height.
42"-high cladding has 3 pieces to cover overall interior frame height.
For 42"-high frames with a work surface (HQ300.42xWS), mid-level cladding is inset 1" at each end to allow for installation of cantilevers.
For 42"-high frames with a utility shelf (HQ300.42xUS), mid-level cladding is flush at seams and does not allow for installation of cantilevers.
Receptacles for power access are field supplied.
Order the following products separately:
• Commend frame (HQ100.)
• Commend work surface (HQ400.) or Commend utility shelf (HQ401.)
Order optional products separately:
• Commend cable trough (HQ791.)
• Commend tackable fabric back panel (HQ305.)

Dimensions

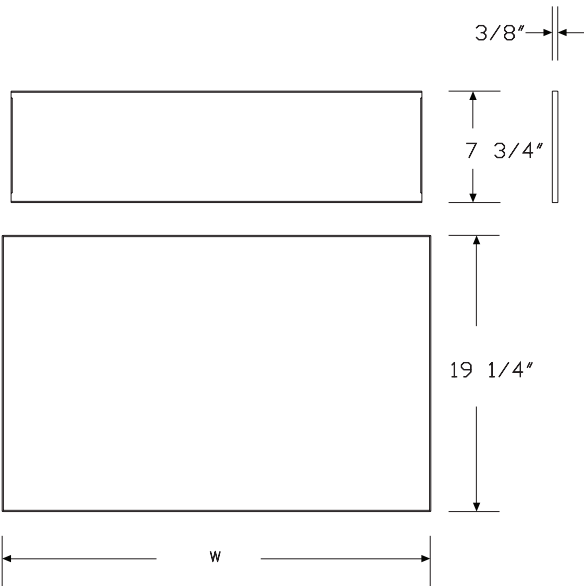

For 30" high frame, 2 Piece cladding

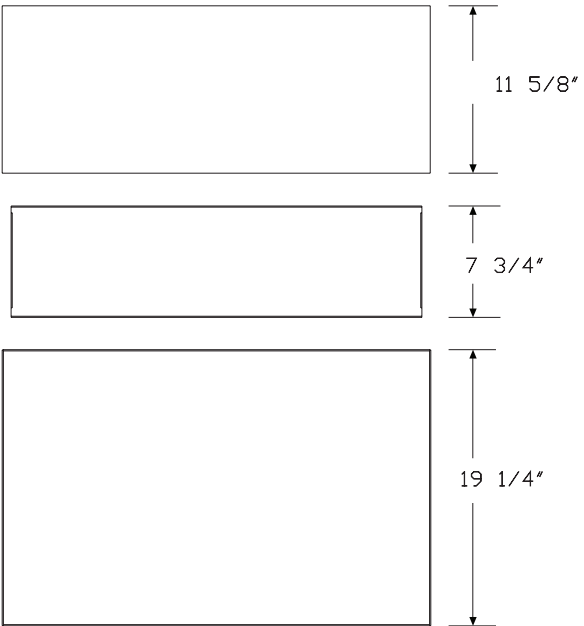

For 42" high frame, 3 Piece cladding

Commend™ Cladding

Specification Information

Step 1.

HQ300.

Step 2. Frame Height

30 30" high
42 42" high

Step 3. Frame Width

03 3' wide
04 4' wide
05 5' wide
06 6' wide
07 7' wide
08 8' wide

Step 4. Interior Surface

For 30" high (30)

WS for use with a work surface

For 42" high (42)

US for use with a utility shelf

WS for use with a work surface

Step 5. Cladding Material

M metal

Prices for Steps 1-5.

	USM	WSM
HQ300. 30 03	—	\$547
04	—	\$587
05	—	\$840
06	—	\$882
07	—	\$966
08	—	\$1008
42 03	\$589	589
04	\$690	690
05	\$924	924
06	\$1050	1050
07	\$1175	1175
08	\$1342	1342

Step 6. Cladding Material Finish

Metallic Paint

611	beige mist metallic (CP)	+\$0
613	silver (CP)	+\$0
SNA	satin aluminum	+\$30
SNB	satin bronze	+\$30
SNC	satin carbon	+\$30

Smooth Paint

8Q	folkstone grey (CP)	+\$0
91	white (CP)	+\$0
98	studio white (CP)	+\$0
G1	graphite (CP)	+\$0
WL	warm stone (CP)	+\$0
WN	warm grey neutral	+\$0

Commend™ Corner Interior Cladding HQ310.

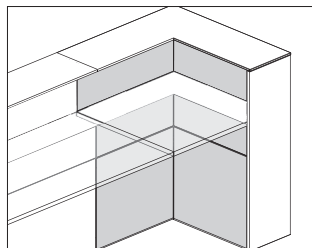

Product Information

Description

This corner interior cladding attaches to the user side of the corner frame and conceals the structure. 2-piece or 3-piece cladding covers the overall frame height. Corner interior cladding is metal and comes with standard power knockouts. Attachment hardware included.

Notes

Specify width and height of cladding to match width and height of frame.

30"-high cladding has 2 pieces to cover overall interior frame height.

42"-high cladding has 3 pieces to cover overall interior frame height.

For 42"-high corner frames with a work surface (HQ310.4203WS), mid-level cladding is inset 1" at outer ends to allow for installation of cantilevers.

For 42"-high corner frames with a utility shelf (HQ310.4203US), mid-level cladding is flush at seams and does not allow for installation of cantilevers.

Receptacles for power access are field supplied.

Order the following products separately:

- Commend corner frame (HQ110.)
- Commend corner work surface (HQ410.) or Commend corner utility shelf (HQ411.)

Order optional products separately:

- Commend junction boxes (HQ790.CO)
- Commend cable trough (HQ791.CO)
- Commend corner tackable fabric back panel (HQ315.)

Dimensions

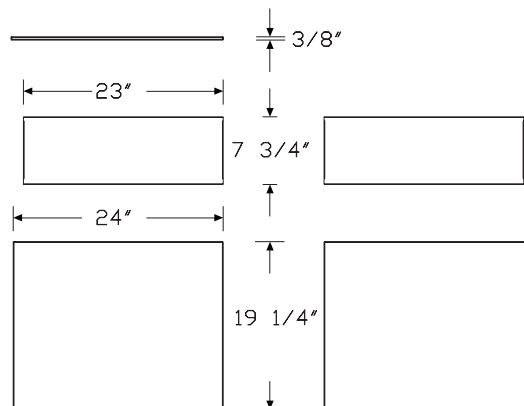

For 30" high frame 2 piece cladding,
Quantity 2 of each piece

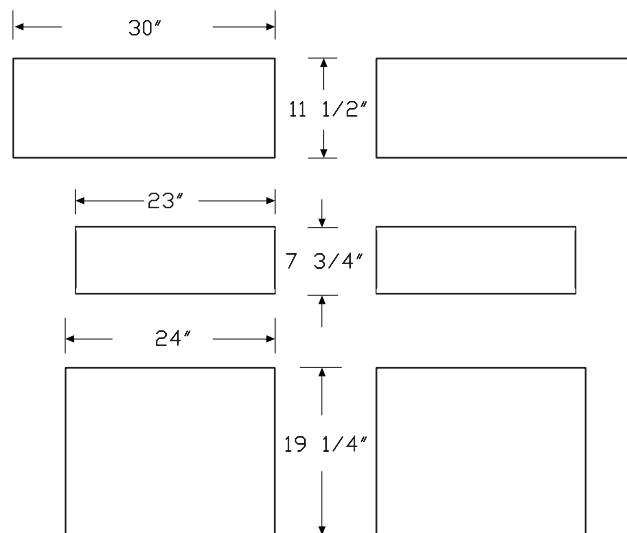

For 42" high frame 3 piece cladding,
Quantity 2 of each piece

Commend™ Corner Interior Cladding

continued

Commend™ Cladding

Specification Information

Step 1.

HQ310.

Step 2. Frame Height	
30	30" high
42	42" high

Step 3. Frame Width	
03	3' wide x 3' wide

Step 4. Interior Surface

For 30" high (30)	
WS	for use with a work surface

For 42" high (42)	
US	for use with a utility shelf
WS	for use with a work surface

Step 5. Cladding Material	
M	metal

Prices for Steps 1-5.			
		USM	WSM
HQ310.	30 03	—	\$656
	42 03	\$860	860

Step 6. Cladding Material Finish

Metallic Paint		
611	beige mist metallic (CP)	+\$0
613	silver (CP)	+\$0

Smooth Paint		
8Q	folkstone grey (CP)	+\$0
91	white (CP)	+\$0
98	studio white (CP)	+\$0
G1	graphite (CP)	+\$0
WL	warm stone (CP)	+\$0
WN	warm grey neutral	+\$0

Commend™ Corner Close Out Interior Cladding HQ320.

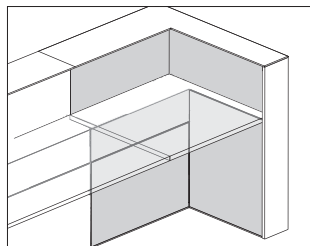

Product Information

Description

This corner close out interior cladding attaches to the user side of the corner close out frame and conceals the structure. 3-piece cladding covers the overall frame height. Corner interior cladding is metal and comes with standard power knockouts. Attachment hardware included.

Notes

Specify width and height of cladding to match width and height of frame.

42"-high cladding has 3 pieces to cover overall interior frame height.

Mid-level corner close out cladding is inset 1" at outer ends to allow for installation of cantilevers.

Receptacles for power access are field supplied.

Order the following products separately:

- Commend corner close out frame (HQ120.)
- Commend corner close out work surface (HQ420.)

Order optional products separately:

- Commend junction box (HQ790.CC)
- Commend cable trough (HQ791.CC)
- Commend corner close out tackable fabric back panel (HQ325.)

Dimensions

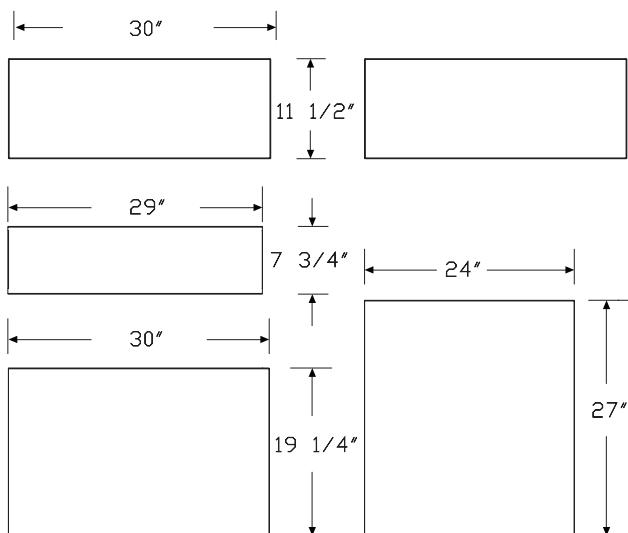

For 42" high corner close out frame
5 piece cladding

Specification Information

Step 1.

HQ320.

Step 2. Frame Height

42 42" high

Step 3. Frame Width

3L 3' wide x 3' wide, return frame left side

3R 3' wide x 3' wide, return frame right side

Step 4. Cladding Material

M metal

Prices for Steps 1-4.

	M
HQ320. 42 3L	\$860
3R	\$860

Step 5. Cladding Material Finish

Metallic Paint

611	beige mist metallic (CP)	+\$0
613	silver (CP)	+\$0
SNA	satin aluminum	+\$30
SNB	satin bronze	+\$30
SNC	satin carbon	+\$30

Smooth Paint

8Q	folkstone grey (CP)	+\$0
91	white (CP)	+\$0
98	studio white (CP)	+\$0
G1	graphite (CP)	+\$0
WL	warm stone (CP)	+\$0
WN	warm grey neutral	+\$0

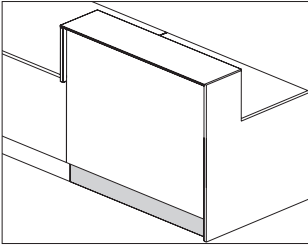

Product Information

Description

This toe kick is a continuous piece of protection at the base of the frame that conceals the structural feet and glides. It is available in brushed stainless or high-pressure laminate. Attachment hardware and brackets included.

Notes

Specify width of toe kick to match width of frame.
Laminate toe kick available as solid-color laminate only.
Order the following products separately:

- Commend frame (HQ100.)
- Commend exterior cladding (HQ200.)

Dimensions

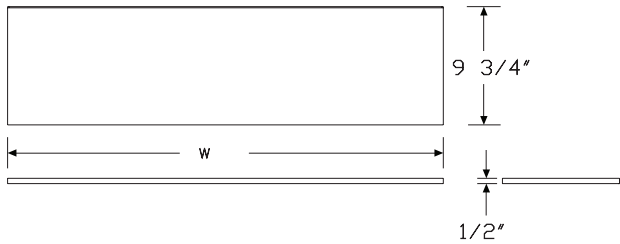

Specification Information

Step 1.

HQ205.

Step 2. Frame Width

03	3' wide
04	4' wide
05	5' wide
06	6' wide
07	7' wide
08	8' wide

Step 3. Toe Kick Material

BRS	brushed stainless
H	high-pressure laminate/thermoplastic edge

Prices for Steps 1-3.

	BRS	H
HQ205. 03	\$1277	589
04	\$1411	674
05	\$1840	924
06	\$1914	966
07	\$2013	1008
08	\$2116	1092

Step 4. Surface Finish

For high-pressure laminate/thermoplastic edge (H)

8Q	folkstone grey (CP)	+\$0
91	white (CP)	+\$0
98	studio white (CP)	+\$0
BK	black	+\$0
CL	cool grey neutral	+\$0
LU	soft white	+\$0
UBK	ultra black (CP)	+\$0
WL	warm stone (CP)	+\$0
WN	warm grey neutral	+\$0

HQ215.

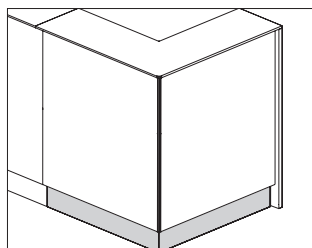

Description

Notes

Order the following products separately:

- Commend corner frame (HQ110.)
- Commend corner close out frame (HQ120.)
- Commend corner exterior cladding (HQ210.)

Technical drawing of a rectangular plate. The dimensions are indicated as $32 \frac{1}{2}"$ (width) and $9 \frac{3}{4}"$ (height).

Step 1.

HQ215.

Step 2. Frame Width

03 3' wide x 3' wide

Step 3. Toe Kick Material

BRS brushed stainless

H high-pressure laminate/thermoplastic edge

Prices for Steps 1-3.

	BRS	H
HQ215. 03	\$2204	1342

Step 4. Surface Finish

For high-pressure laminate/thermoplastic edge (H)

8Q	folkstone grey (CP)	+\$0
91	white (CP)	+\$0
98	studio white (CP)	+\$0
BK	black	+\$0
CL	cool grey neutral	+\$0
LU	soft white	+\$0
UBK	ultra black (CP)	+\$0
WL	warm stone (CP)	+\$0
WN	warm grey neutral	+\$0

Commend™ Tackable Fabric Back Panel

HQ305.

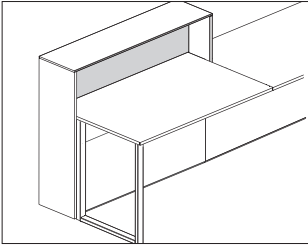

Product Information	
Description	
This tackable fabric back panel is an optional component that attaches magnetically to the metal interior cladding above the work surface on a 42"-high frame.	
Notes	
Specify width of panel to match width of frame.	
For back panels wider than 4', 2 panels will be used to cover the overall width.	
Order interior cladding (HQ300.) separately.	
When specifying tackable fabric, horizontal (R) option, fabric direction is horizontal (railroaded). Specify all back panels within the workstation the same.	
Tackable fabric back panel accepts Customer's Own Material (COM).	
Yardage is estimated for nondirectional, 54"-wide fabrics.	
For tackable fabric option (T):	
Width—Yardage	
03—0.44	
04—0.44	
05—0.88	
06—0.88	
07—0.88	
08—0.88	
For tackable fabric, horizontal option (R):	
Width—Yardage	
03—1.20	
04—1.58	
05—1.01	
06—1.20	
07—1.39	
08—1.58	
For information on multiple quantities or directional fabrics, contact COM Department. See Order Information in appendices.	

Dimensions	

Commend™ Cladding

Commend™ Tackable Fabric Back Panel *continued*

Specification Information

Step 1.

HQ305.

Step 2. Frame Width

03	3' wide
04	4' wide
05	5' wide
06	6' wide
07	7' wide
08	8' wide

Step 3. Surface Material

T	tackable fabric
R	tackable fabric, horizontal

Prices for Steps 1-3.

	T	R
HQ305. 03	\$358	358
04	\$409	409
05	\$568	568
06	\$626	626
07	\$693	693
08	\$736	736

Step 4. Fabric Finish

Price Category 1	+\$0
Price Category 2	+\$8
Price Category 3	+\$16
Price Category 5	+\$54
Price Category B	+\$35
Price Category C	+\$48
Price Category D	+\$60
Price Category E	+\$73
Price Category F	+\$94

Commend™ Corner Tackable Fabric Back Panel

HQ315.

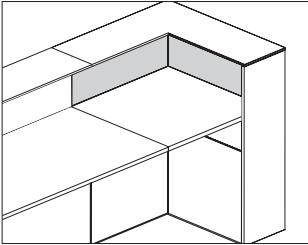

Product Information

Description

These corner tackable fabric back panels are optional components that attach magnetically to the metal interior cladding above the work surface on a 42"-high corner frame. Product includes 2 panels, 1 for each interior side of the corner frame.

Notes

Order corner interior cladding (HQ310.) separately.
When specifying tackable fabric, horizontal (R) option, fabric direction is horizontal (railroaded). Specify all back panels within the workstation the same.
Corner tackable fabric back panels accept Customer's Own Material (COM). Yardage is estimated for nondirectional, 54"-wide fabrics.
For tackable fabric option (T):
Width—Yardage
03—0.88
For tackable fabric, horizontal option (R):
Width—Yardage
03—1.20
For information on multiple quantities or directional fabrics, contact COM Department. See Order Information in appendices.

Dimensions

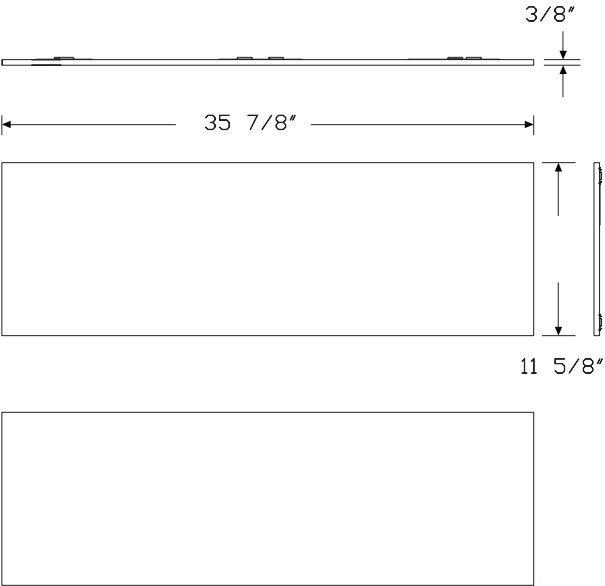

Specification Information

Step 1.

HQ315.

Step 2. Frame Width

03 3' wide x 3' wide

Step 3. Surface Material

T tackable fabric

R tackable fabric, horizontal

Prices for Steps 1-3.

	T	R
HQ315. 03	\$626	626

Step 4. Fabric Finish

Price Category 1	+\$0
Price Category 2	+\$17
Price Category 3	+\$31
Price Category 5	+\$109
Price Category B	+\$70
Price Category C	+\$96
Price Category D	+\$120
Price Category E	+\$146
Price Category F	+\$187

Commend™ Corner Closeout Tackable Fabric Back Panel

HQ325.

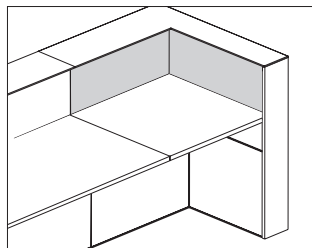

Product Information

Description

These corner close out tackable fabric back panels are optional components that attach magnetically to the metal interior cladding above the work surface on a 42"-high corner close out frame. Product includes 2 panels, 1 for each interior side of the corner close out frame.

Notes

Order corner close out interior cladding (HQ320.) separately.

When specifying tackable fabric, horizontal (R) option, fabric direction is horizontal (railroaded). Specify all back panels within the workstation the same.

Corner tackable fabric back panels accept Customer's Own Material (COM).

Yardage is estimated for nondirectional, 54"-wide fabrics.

For tackable fabric option (T):

Width—Yardage

03—0.88

For tackable fabric, horizontal option (R):

Width—Yardage

03—1.20

For information on multiple quantities or directional fabrics, contact COM Department. See Order Information in appendices.

Dimensions

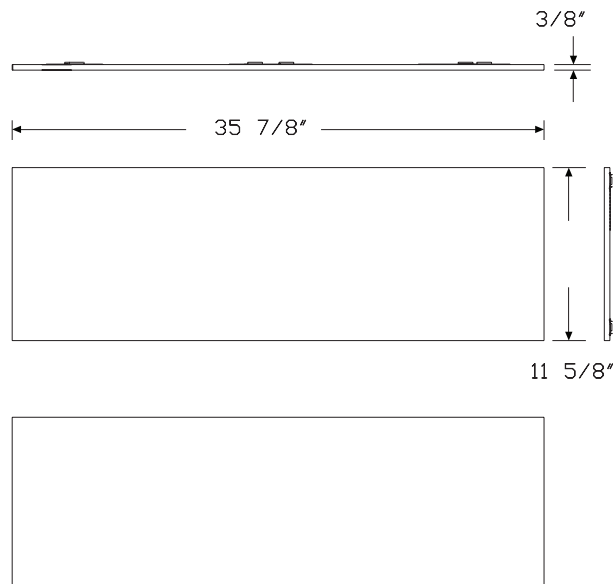

Specification Information

Step 1.

HQ325.

Step 2. Frame Width

03 3' wide x 3' wide

Step 3. Surface Material

T tackable fabric

R tackable fabric, horizontal

Prices for Steps 1-3.

	T	R
HQ325. 03	\$626	626

Step 4. Fabric Finish

Price Category 1	+\$0
Price Category 2	+\$17
Price Category 3	+\$31
Price Category 5	+\$109
Price Category B	+\$70
Price Category C	+\$96
Price Category D	+\$120
Price Category E	+\$146
Price Category F	+\$187

Commend™ Cladding

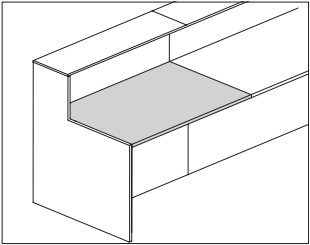

Product Information

Description

This surface attaches to the frame and comes in laminate or Corian®. It includes frame attachment connectors and 1 work surface ganging plate to connect surfaces end-to-end. Work surfaces 4' wide and wider include a stiffener. Surface is 1" thick with a squared edge and is available with or without cutouts for Logic Mini power components, ordered separately.

Notes

Specify width and height of work surface to match width and height of frame. Work surfaces for use with 30"-high frames allow for 36" of usable surface depth.

Work surfaces for use with 42"-high frames allow for 30" of usable surface depth.

Grain direction on work surface runs the width of surface.

Cantilevers (FT290.) are required at every work surface-to-work surface connection. Order separately.

For surface widths greater than 4', cantilevers are necessary for mid-worksurface support. Order separately.

When cutouts are specified, Logic Mini Grommet (Y1412.1) is required. Order separately.

Surface does not allow clearance for Logic Mini Surface Clamp at the back edge of work surface.

Surface does not allow clearance for surface-clamp-mounted monitor arm assemblies. For monitor arm mounting use grommet mount or through-surface mount.

Order the following products separately:

- Surface cantilever (FT290.24)

Order the following optional products separately:

- Logic mini (Y1414.)
- Logic mini grommet (Y1412.1)

Dimensions

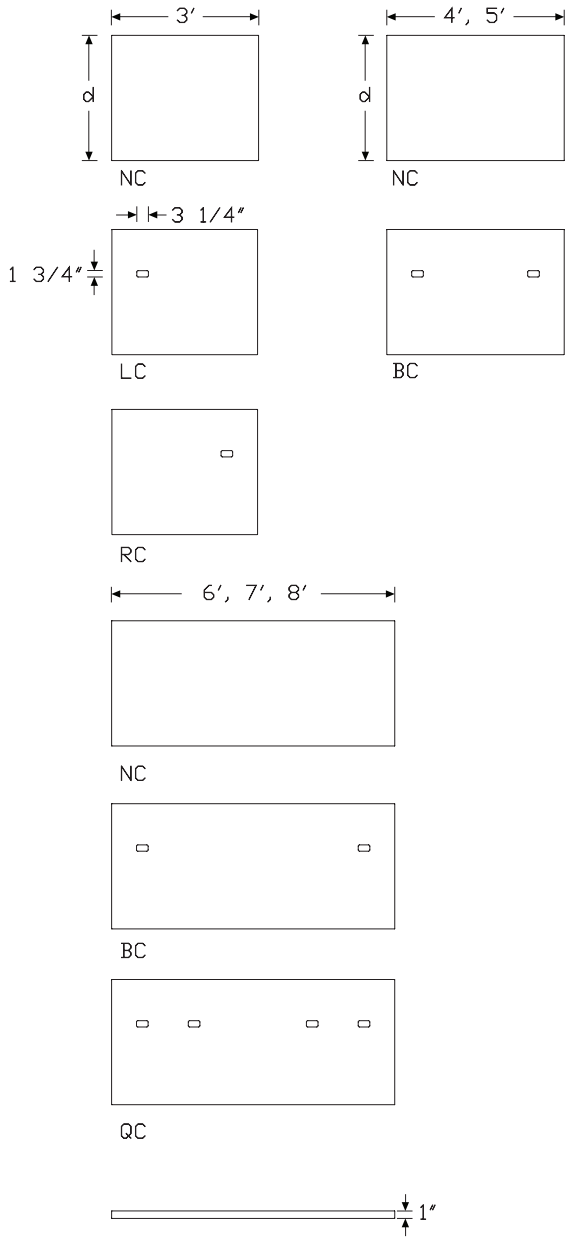

Specification Information**Step 1.****HQ400.****Step 2. Frame Height****30** 30" high**42** 42" high**Step 3. Edge****S** squared-edge**Step 4. Width****03** 3' wide**04** 4' wide**05** 5' wide**06** 6' wide**07** 7' wide**08** 8' wide**Step 5. Depth***For 30" high (30) with 3' wide (03), 4' wide (04), 5' wide (05), 6' wide (06), 7' wide (07), or 8' wide (08)***36** 36" deep*For 42" high (42) with 3' wide (03), 4' wide (04), 5' wide (05), 6' wide (06), 7' wide (07), or 8' wide (08)***30** 30" deep**Step 6. Location in Run***For 36" deep (36)***RE** work surface end of run, right**LE** work surface end of run, left**MD** work surface mid run, for use with no end panel**FS** single work surface, for use with end panels on both ends*For 30" deep (30)***NN** no selection**Step 7. Cutouts***For 3' wide (03)***NC** no cutout**LC** 1 cutout left**RC** 1 cutout right*For 4' wide (04) or 5' wide (05)***NC** no cutout**BC** 2 cutouts, one near each end*For 6' wide (06), 7' wide (07), or 8' wide (08)***NC** no cutout**BC** 2 cutouts, one near each end**QC** 4 cutouts, one near each end 2 near center**Step 8. Surface Material****K** corian**H** high-pressure laminate/thermoplastic edge**Prices for Steps 1-8.**

	0330NNNCK	0330NNNCH	0330NNLCK	0330NNLCH	0330NNRCK	0330NNRCH
HQ400. 42 S	\$3579	656	3626	707	3626	707
	0336RENCK	0336RENCH	0336RELCK	0336RELCH	0336RERCK	0336RERCH
HQ400. 30 S	\$3658	1092	3714	1142	3714	1142
	0336LENCK	0336LENCH	0336LELCK	0336LELCH	0336LERCK	0336LERCH
HQ400. 30 S	\$3658	1092	3714	1142	3714	1142
	0336MDNCK	0336MDNCH	0336MDLCK	0336MDLCH	0336MDRCK	0336MDRCH
HQ400. 30 S	\$3658	1092	3714	1142	3714	1142
	0336FSNCK	0336FSNCH	0336FSLCK	0336FSLCH	0336FSRCK	0336FSRCH
HQ400. 30 S	\$3658	1092	3714	1142	3714	1142
	0430NNNCK	0430NNNCH	0430NNBCK	0430NNBCH	0436RENCK	0436RENCH
HQ400. 30 S	—	—	—	—	\$4876	1169
42 S	\$4705	747	4834	848	—	—
	0436REBCK	0436REBCH	0436LENCK	0436LENCH	0436LEBCK	0436LEBCH
HQ400. 30 S	\$4978	1268	4876	1169	4978	1268
	0436MDNCK	0436MDNCH	0436MDBCK	0436MDBCH	0436FSNCK	0436FSNCH
HQ400. 30 S	\$4876	1169	4978	1268	4876	1169
	0436FSBCK	0436FSBCH	0530NNNCK	0530NNNCH	0530NNBCK	0530NNBCH
HQ400. 30 S	\$4978	1268	—	—	—	—
42 S	—	—	\$5079	822	5183	924
	0536RENCK	0536RENCH	0536REBCK	0536REBCH	0536LENCK	0536LENCH
HQ400. 30 S	\$6094	1201	6197	1302	6094	1201

	0536LEBCK	0536LEBCH	0536MDNCK	0536MDNCH	0536MDBCK	0536MDBCH
HQ400. 30 S	\$6197	1302	6094	1201	6197	1302
	0536FSNCK	0536FSNCH	0536FSBCK	0536FSBCH	0630NNNCK	0630NNNCH
HQ400. 30 S	\$6094	1201	6197	1302	—	—
42 S	—	—	—	—	\$6094	1092
	0630NNBCK	0630NNBCH	0630NNQCK	0630NNQCH	0636RENCK	0636RENCH
HQ400. 30 S	—	—	—	—	\$7313	1342
42 S	\$6197	1192	6427	1293	—	—
	0636REBCK	0636REBCH	0636REQCK	0636REQCH	0636LENCK	0636LENCH
HQ400. 30 S	\$7416	1445	7518	1545	7313	1342
	0636LEBCK	0636LEBCH	0636LEQCK	0636LEQCH	0636MDNCK	0636MDNCH
HQ400. 30 S	\$7416	1445	7518	1545	7313	1342
	0636MDBCK	0636MDBCH	0636MDQCK	0636MDQCH	0636FSNCK	0636FSNCH
HQ400. 30 S	\$7416	1445	7518	1545	7313	1342
	0636FSBCK	0636FSBCH	0636FSQCK	0636FSQCH	0730NNNCK	0730NNNCH
HQ400. 30 S	\$7416	1445	7518	1545	—	—
42 S	—	—	—	—	\$7110	1125
	0730NNBCK	0730NNBCH	0730NNQCK	0730NNQCH	0736RENCK	0736RENCH
HQ400. 30 S	—	—	—	—	\$8531	1428
42 S	\$7212	1225	7315	1326	—	—
	0736REBCK	0736REBCH	0736REQCK	0736REQCH	0736LENCK	0736LENCH
HQ400. 30 S	\$8583	1527	8685	1629	8531	1428
	0736LEBCK	0736LEBCH	0736LEQCK	0736LEQCH	0736MDNCK	0736MDNCH
HQ400. 30 S	\$8583	1527	8685	1629	8531	1428
	0736MDBCK	0736MDBCH	0736MDQCK	0736MDQCH	0736FSNCK	0736FSNCH
HQ400. 30 S	\$8583	1527	8685	1629	8531	1428
	0736FSBCK	0736FSBCH	0736FSQCK	0736FSQCH	0830NNNCK	0830NNNCH
HQ400. 30 S	\$8583	1527	8685	1629	—	—
42 S	—	—	—	—	\$8125	1158
	0830NNBCK	0830NNBCH	0830NNQCK	0830NNQCH	0836RENCK	0836RENCH
HQ400. 30 S	—	—	—	—	\$9750	1595
42 S	\$8227	1259	8330	1360	—	—
	0836REBCK	0836REBCH	0836REQCK	0836REQCH	0836LENCK	0836LENCH
HQ400. 30 S	\$9852	1694	9956	1796	9750	1595

	0836LEBCK	0836LEBCH	0836LEQCK	0836LEQCH	0836MDNCK	0836MDNCH
HQ400. 30 S	\$9852	1694	9956	1796	9750	1595
	0836MDBCK	0836MDBCH	0836MDQCK	0836MDQCH	0836FSNCK	0836FSNCH
HQ400. 30 S	\$9852	1694	9956	1796	9750	1595
			0836FSBCK	0836FSBCH	0836FSQCK	0836FSQCH
HQ400. 30 S			\$9852	1694	9956	1796

Step 9. Surface Finish

For corian (K)

1S	savannah	+\$664
1U	sahara	+\$142
4I	sandstone	+\$142
58	cameo white	+\$0
ANC	antarctica	+\$664
CQ	glacier white	+\$0
CRT	concrete	+\$1185
DVC	dove	+\$1185
IQ	aurora	+\$664
OQ	silt	+\$664
QB	bisque	+\$0
SVG	silver gray	+\$0

For high-pressure laminate/thermoplastic edge (H)

125	natural maple (CP)	+\$0
126	natural cherry (CP)	+\$0
127	walnut (CP)	+\$0
139	light ash (CP)	+\$0
140	warm ash (CP)	+\$0
76	light brown walnut	+\$0
8Q	folkstone grey (CP)	+\$0
91	white (CP)	+\$0
98	studio white (CP)	+\$0
CL	cool grey neutral	+\$0
HF	inner tone light	+\$0
HP	light anigre	+\$0
LBA	clear on ash (CP)	+\$0
LBB	oak on ash (CP)	+\$0
LBC	walnut on ash (CP)	+\$0
LBF	neutral twill	+\$0
LBJ	graphite twill	+\$0
LBQ	white twill	+\$0
LBR	phantom ecru A	+\$0
LBS	phantom cocoa A	+\$0
LBU	medium matte walnut (CP) A	+\$0
LBV	warm grey teak A	+\$0
LT	light tone	+\$0
LU	soft white	+\$0
WL	warm stone (CP)	+\$0
WN	warm grey neutral	+\$0

Step 10. Edge Finish

For high-pressure laminate/thermoplastic edge (H)

125	natural maple (CP)	+\$0
126	natural cherry (CP)	+\$0
127	walnut (CP)	+\$0
139	light ash (CP)	+\$0
140	warm ash (CP)	+\$0
76	light brown walnut	+\$0
8Q	folkstone grey (CP)	+\$0
91	white (CP)	+\$0
98	studio white (CP)	+\$0
CL	cool grey neutral	+\$0
G1	graphite (CP)	+\$0
HF	inner tone light	+\$0
HP	light anigre	+\$0
LBA	clear on ash (CP)	+\$0
LBB	oak on ash (CP)	+\$0
LBC	walnut on ash (CP)	+\$0
LBF	neutral twill	+\$0
LBJ	graphite twill	+\$0
LBQ	white twill	+\$0
LBR	phantom ecru	+\$0
LBS	phantom cocoa	+\$0
LBU	medium matte walnut (CP)	+\$0
LBV	warm grey teak	+\$0
LU	soft white	+\$0
WL	warm stone (CP)	+\$0
WN	warm grey neutral	+\$0

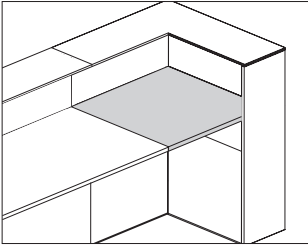

Product Information

Description

This surface attaches to the corner frame and comes in laminate or Corian®. It includes frame attachment connectors and 1 work surface ganging plate to connect surfaces end-to-end. Surface is 1" thick with a squared edge and is available with or without cutouts for Logic Mini power components, ordered separately.

Notes

Work surfaces for use with 30"-high frames allow for 36" of usable surface depth.

Work surfaces for use with 42"-high frames allow for 30" of usable surface depth.

Cantilevers (FT290.) are required at every work surface-to-work surface connection. Order separately.

When cutouts are specified, Logic Mini Grommet (Y1412.1) is required.

Order separately.

Surface does not allow clearance for Logic Mini Surface Clamp at the back edge of work surface.

Surface does not allow clearance for surface-clamp-mounted monitor arm assemblies. For monitor arm mounting use grommet mount or through-surface mount.

Order the following products separately:

- Surface cantilever (FT290.24)

Order the following optional products separately:

- Logic mini (Y1414.)
- Logic mini grommet (Y1412.1)

Dimensions

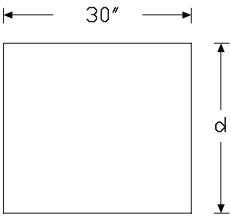

NC3N

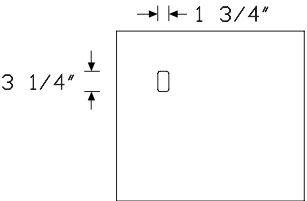

CC3L

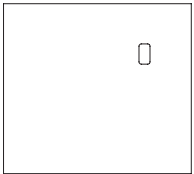

CC3R



Commend™ Corner Work Surface

continued

Specification Information

Step 1.

HQ410.

Step 2. Frame Height

30 30" high

42 42" high

Step 3. Edge

S squared-edge

Step 4. Depth

For 30" high (30)

36 36" deep

For 42" high (42)

30 30" deep

Step 5. Cutouts

NC no cutout

CC cutout

Step 6. Handedness

For no cutout (NC)

3N 3' wide x 3' wide, non - handed

For cutout (CC)

3L 3' wide x 3' wide, left

3R 3' wide x 3' wide, right

Step 7. Surface Material

K corian

H high-pressure laminate/thermoplastic edge

Prices for Steps 1-7.

	30NC3NK	30NC3NH	30CC3LK	30CC3LH	30CC3RK	30CC3RH
HQ410. 42 S	\$3599	707	3658	757	3658	757
	36NC3NK	36NC3NH	36CC3LK	36CC3LH	36CC3RK	36CC3RH
HQ410. 30 S	\$3658	975	3710	1027	3710	1027

Step 8. Surface Finish

For corian (K)

1S	savannah	+\$398
1U	sahara	+\$85
4I	sandstone	+\$85
58	cameo white	+\$0
ANC	antarctica	+\$398
CQ	glacier white	+\$0
CRT	concrete	+\$711
DVC	dove	+\$711
IQ	aurora	+\$398
OQ	silt	+\$398
QB	bisque	+\$0
SVG	silver gray	+\$0

For high-pressure laminate/thermoplastic edge (H)

125	natural maple (CP)	+\$0
126	natural cherry (CP)	+\$0
127	walnut (CP)	+\$0
139	light ash (CP)	+\$0
140	warm ash (CP)	+\$0
76	light brown walnut	+\$0
8Q	folkstone grey (CP)	+\$0
91	white (CP)	+\$0
98	studio white (CP)	+\$0
CL	cool grey neutral	+\$0
HF	inner tone light	+\$0
HP	light anigre	+\$0
LBA	clear on ash (CP)	+\$0
LBB	oak on ash (CP)	+\$0
LBC	walnut on ash (CP)	+\$0
LBF	neutral twill	+\$0
LBJ	graphite twill	+\$0
LBQ	white twill	+\$0
LBR	phantom ecru A	+\$0
LBS	phantom cocoa A	+\$0
LBU	medium matte walnut (CP) A	+\$0
LBV	warm grey teak A	+\$0
LT	light tone	+\$0
LU	soft white	+\$0
WL	warm stone (CP)	+\$0
WN	warm grey neutral	+\$0

Commend™ Surfaces

Commend™ Corner Work Surface

continued

Commend™ Surfaces

Step 9. Edge Finish

For high-pressure laminate/thermoplastic edge (H)

125	natural maple (CP)	+\$0
126	natural cherry (CP)	+\$0
127	walnut (CP)	+\$0
139	light ash (CP)	+\$0
140	warm ash (CP)	+\$0
76	light brown walnut	+\$0
8Q	folkstone grey (CP)	+\$0
91	white (CP)	+\$0
98	studio white (CP)	+\$0
CL	cool grey neutral	+\$0
G1	graphite (CP)	+\$0
HF	inner tone light	+\$0
HP	light anigre	+\$0
LBA	clear on ash (CP)	+\$0
LBB	oak on ash (CP)	+\$0
LBC	walnut on ash (CP)	+\$0
LBF	neutral twill	+\$0
LBJ	graphite twill	+\$0
LBQ	white twill	+\$0
LBR	phantom ecru	+\$0
LBS	phantom cocoa	+\$0
LBU	medium matte walnut (CP)	+\$0
LBV	warm grey teak	+\$0
LU	soft white	+\$0
WL	warm stone (CP)	+\$0
WN	warm grey neutral	+\$0

Commend™ Corner Close Out Work Surface HQ420.

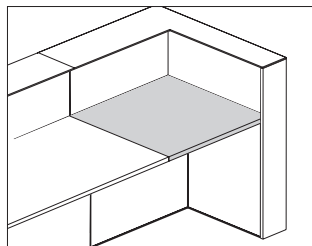

Product Information

Description

This surface attaches to the corner close out frame and comes in laminate or Corian®. It includes frame attachment connectors and 1 work surface ganging plate to connect surfaces end-to-end. Surface is 1" thick with a squared edge and is available with or without cutouts for Logic Mini power components, ordered separately.

Notes

Corner close out work surface allows for 30"×36" of usable surface depth.

The corner close out frame comes in 42" height only.

Corner close out work surface provides 6" more usable surface than the corner work surface.

Handedness is determined from interior/user side of the application.

Cantilevers (FT290.) are required at every work surface-to-work surface connection. Order separately.

When cutouts are specified, Logic Mini Grommet (Y1412.1) is required.

Order separately.

Surface does not allow clearance for Logic Mini Surface Clamp at the back edge of work surface.

Surface does not allow clearance for surface-clamp-mounted monitor arm assemblies. For monitor arm mounting use grommet mount or through-surface mount.

Order the following products separately:

- Surface cantilever (FT290.24)

Order the following optional products separately:

- Logic mini (Y1414.)
- Logic mini grommet (Y1412.1)

Dimensions

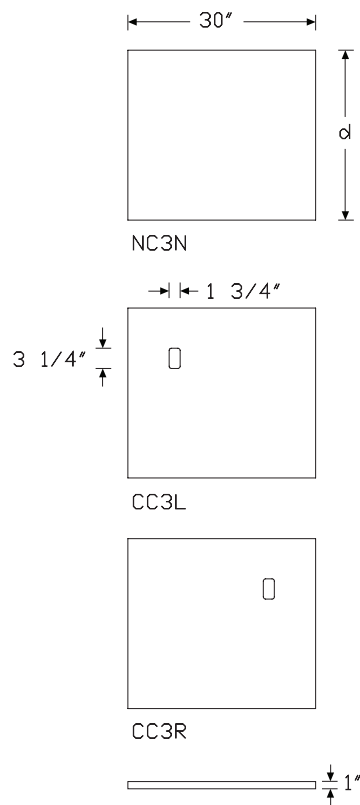

Commend™ Corner Close Out Work Surface *continued*

Commend™ Surfaces

Specification Information						
Step 1.						
HQ420.						
Step 2. Frame Height						
42	42" high					
Step 3. Edge						
S	squared-edge					
Step 4. Cutouts						
NC	no cutout					
CC	cutout					
Step 5. Handedness						
For no cutout (NC)						
3N	3' wide x 3' wide, non - handed					
For cutout (CC)						
3L	3' wide x 3' wide, left					
3R	3' wide x 3' wide, right					
Step 6. Surface Material						
K	corian					
H	high-pressure laminate/thermoplastic edge					
Prices for Steps 1-6.						
	NC3NK	NC3NH	CC3LK	CC3LH	CC3RK	CC3RH
HQ420. 42 S	\$3582	785	3641	837	3641	837
Step 7. Surface Finish						
For corian (K)						
1S	savannah	+\$392				
1U	sahara	+\$84				
4I	sandstone	+\$84				
58	cameo white	+\$0				
ANC	antarctica	+\$392				
CQ	glacier white	+\$0				
CRT	concrete	+\$700				
DVC	dove	+\$700				
IQ	aurora	+\$392				
OQ	silt	+\$392				
QB	bisque	+\$0				
SVG	silver gray	+\$0				

For high-pressure laminate/thermoplastic edge (H)		
125	natural maple (CP)	+\$0
126	natural cherry (CP)	+\$0
127	walnut (CP)	+\$0
139	light ash (CP)	+\$0
140	warm ash (CP)	+\$0
76	light brown walnut	+\$0
8Q	folkstone grey (CP)	+\$0
91	white (CP)	+\$0
98	studio white (CP)	+\$0
CL	cool grey neutral	+\$0
HF	inner tone light	+\$0
HP	light anigre	+\$0
LBA	clear on ash (CP)	+\$0
LBB	oak on ash (CP)	+\$0
LBC	walnut on ash (CP)	+\$0
LBF	neutral twill	+\$0
LBJ	graphite twill	+\$0
LBQ	white twill	+\$0
LBR	phantom ecru A	+\$0
LBS	phantom cocoa A	+\$0
LBU	medium matte walnut (CP) A	+\$0
LBV	warm grey teak A	+\$0
LT	light tone	+\$0
LU	soft white	+\$0
WL	warm stone (CP)	+\$0
WN	warm grey neutral	+\$0

Commend™ Corner Close Out Work Surface *continued*

Step 8. Edge Finish

For high-pressure laminate/thermoplastic edge (H)

125	natural maple (CP)	+\$0
126	natural cherry (CP)	+\$0
127	walnut (CP)	+\$0
139	light ash (CP)	+\$0
140	warm ash (CP)	+\$0
76	light brown walnut	+\$0
8Q	folkstone grey (CP)	+\$0
91	white (CP)	+\$0
98	studio white (CP)	+\$0
CL	cool grey neutral	+\$0
G1	graphite (CP)	+\$0
HF	inner tone light	+\$0
HP	light anigre	+\$0
LBA	clear on ash (CP)	+\$0
LBB	oak on ash (CP)	+\$0
LBC	walnut on ash (CP)	+\$0
LBF	neutral twill	+\$0
LBJ	graphite twill	+\$0
LBQ	white twill	+\$0
LBR	phantom ecru	+\$0
LBS	phantom cocoa	+\$0
LBU	medium matte walnut (CP)	+\$0
LBV	warm grey teak	+\$0
LU	soft white	+\$0
WL	warm stone (CP)	+\$0
WN	warm grey neutral	+\$0

Commend™ Approach Peninsula Work Surface

HQ430.

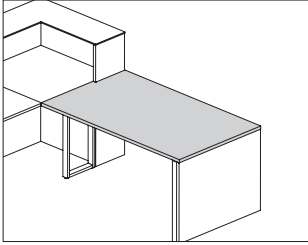

Product Information

Description

This surface attaches to a frame at the end of a run. It is 1" thick with a squared edge and is available in laminate or Corian®. Surfaces 4' and 5' wide include a stiffener. Surface includes frame attachment connectors and 1 work surface ganging plate to connect peninsula surface to work surface.

Notes

3' wide surface does not require a stiffener.

Handedness is determined from interior/user side of the application.

5' wide surface only available in laminate.

Grain direction on peninsula surface runs the width of surface.

Order the following products separately:

- Commend loop leg (HQ540.)

Order the following optional products separately:

- Commend end panel (HQ500.)
- Commend peninsula modesty panel (HQ630.)

Dimensions

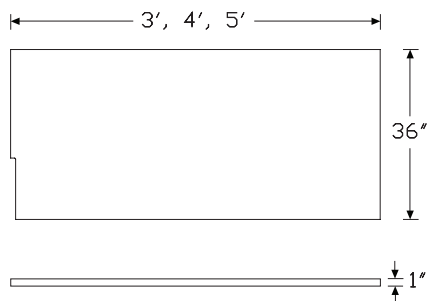

Specification Information

Step 1.

HQ430.

Step 2. Frame Height

30	30" high
42	42" high

Step 3. Edge

S	squared-edge
---	--------------

Step 4. Depth

36	36" deep
----	----------

Step 5. Width

03	3' wide
04	4' wide
05	5' wide

Step 6. Location in Run

EL	end of run left
ER	end of run right

Step 7. End Support Type

LN	for use with loop leg with no panel
LP	for use with loop leg with panel

Step 8. Surface Material

For 3' wide (03) or 4' wide (04)

K	corian
H	high-pressure laminate/thermoplastic edge

For 5' wide (05)

H	high-pressure laminate/thermoplastic edge
---	---

Prices for Steps 1-8.

	3603ELLNK	3603ELLNH	3603ELLPK	3603ELLPH	3603ERLNK	3603ERLNH
HQ430. 30 S	\$4646	837	4646	837	4646	837
42 S	\$4646	837	4646	837	4646	837
	3603ERLPK	3603ERLPH	3604ELLNK	3604ELLNH	3604ELLPK	3604ELLPH
HQ430. 30 S	\$4646	837	4848	870	4848	870
42 S	\$4646	837	4848	870	4848	870
	3604ERLNK	3604ERLNH	3604ERLPK	3604ERLPH	3605ELLNH	3605ELLPH
HQ430. 30 S	\$4848	870	4848	870	903	903

Commend™ Approach Peninsula
Work Surface *continued*

42 S	\$4848	870	4848	870	903	903
				3605ERLNH	3605ERLPH	
HQ430, 30 S				\$903	903	
42 S				\$903	903	

Step 9. Surface Finish

For corian (K)

1S	savannah	+\$530
1U	sahara	+\$114
4I	sandstone	+\$114
58	cameo white	+\$0
ANC	antarctica	+\$530
CQ	glacier white	+\$0
CRT	concrete	+\$947
DVC	dove	+\$947
IQ	aurora	+\$530
OQ	silt	+\$530
QB	bisque	+\$0
SVG	silver gray	+\$0

For high-pressure laminate/thermoplastic edge (H)

125	natural maple (CP)	+\$0
126	natural cherry (CP)	+\$0
127	walnut (CP)	+\$0
139	light ash (CP)	+\$0
140	warm ash (CP)	+\$0
76	light brown walnut	+\$0
8Q	folkstone grey (CP)	+\$0
91	white (CP)	+\$0
98	studio white (CP)	+\$0
CL	cool grey neutral	+\$0
HF	inner tone light	+\$0
HP	light anigre	+\$0
LBA	clear on ash (CP)	+\$0
LBB	oak on ash (CP)	+\$0
LBC	walnut on ash (CP)	+\$0
LBF	neutral twill	+\$0
LBJ	graphite twill	+\$0
LBQ	white twill	+\$0
LBR	phantom ecru A	+\$0
LBS	phantom cocoa A	+\$0
LBU	medium matte walnut (CP) A	+\$0
LBV	warm grey teak A	+\$0
LT	light tone	+\$0
LU	soft white	+\$0
WL	warm stone (CP)	+\$0
WN	warm grey neutral	+\$0

Commend™ Approach Peninsula

Work Surface *continued*

Commend™ Surfaces

Step 10. Edge Finish

For high-pressure laminate/thermoplastic edge (H)

125	natural maple (CP)	+\$0
126	natural cherry (CP)	+\$0
127	walnut (CP)	+\$0
139	light ash (CP)	+\$0
140	warm ash (CP)	+\$0
76	light brown walnut	+\$0
8Q	folkstone grey (CP)	+\$0
91	white (CP)	+\$0
98	studio white (CP)	+\$0
CL	cool grey neutral	+\$0
G1	graphite (CP)	+\$0
HF	inner tone light	+\$0
HP	light anigre	+\$0
LBA	clear on ash (CP)	+\$0
LBB	oak on ash (CP)	+\$0
LBC	walnut on ash (CP)	+\$0
LBF	neutral twill	+\$0
LBJ	graphite twill	+\$0
LBQ	white twill	+\$0
LBR	phantom ecru	+\$0
LBS	phantom cocoa	+\$0
LBU	medium matte walnut (CP)	+\$0
LBV	warm grey teak	+\$0
LU	soft white	+\$0
WL	warm stone (CP)	+\$0
WN	warm grey neutral	+\$0

Commend™ Work Peninsula Surface HQ435.

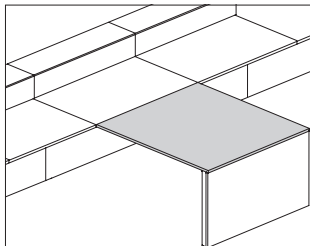

Product Information

Description

This surface attaches perpendicularly to the width of a work surface. It is 1" thick with a squared edge and is available in laminate or Corian®. Surfaces 4' and 5' wide include a stiffener. Surface includes frame attachment connectors and 1 work surface ganging plate to connect peninsula surface to work surface.

Notes

3' wide surface does not require a stiffener.

Handedness is determined from interior/user side of the application.

5' wide surface only available in laminate.

Grain direction on peninsula surface runs the width of surface.

Order the following products separately:

- Commend loop leg (HQ540.)

Order the following optional products separately:

- Commend end panel (HQ500.)

Dimensions

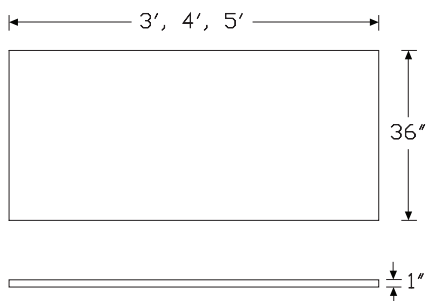

Specification Information

Step 1.

HQ435.

Step 2. Edge

S squared-edge

Step 3. Width

03 3' wide

04 4' wide

05 5' wide

Step 4. Depth

36 36" deep

Step 5. End Support Type

LN for use with loop leg with no panel

LP for use with loop leg with panel

Step 6. Surface Material

For 3' wide (03) or 4' wide (04)

K corian

H high-pressure laminate/thermoplastic edge

For 5' wide (05)

H high-pressure laminate/thermoplastic edge

Prices for Steps 1-6.

		36LNK	36LNH	36LPK	36LPH
HQ435. S	03	\$4646	837	4646	837
	04	\$4848	862	4848	862
	05	—	\$903	—	903

Commend™ Work Peninsula Surface

continued

Commend™ Surfaces

Step 7. Surface Finish

For corian (K)

1S	savannah	+\$530
1U	sahara	+\$114
4I	sandstone	+\$114
58	cameo white	+\$0
ANC	antarctica	+\$530
CQ	glacier white	+\$0
CRT	concrete	+\$947
DVC	dove	+\$947
IQ	aurora	+\$530
OQ	silt	+\$530
QB	bisque	+\$0
SVG	silver gray	+\$0

For high-pressure laminate/thermoplastic edge (H)

125	natural maple (CP)	+\$0
126	natural cherry (CP)	+\$0
127	walnut (CP)	+\$0
139	light ash (CP)	+\$0
140	warm ash (CP)	+\$0
76	light brown walnut	+\$0
8Q	folkstone grey (CP)	+\$0
91	white (CP)	+\$0
98	studio white (CP)	+\$0
CL	cool grey neutral	+\$0
HF	inner tone light	+\$0
HP	light anigre	+\$0
LBA	clear on ash (CP)	+\$0
LBB	oak on ash (CP)	+\$0
LBC	walnut on ash (CP)	+\$0
LBF	neutral twill	+\$0
LBJ	graphite twill	+\$0
LBQ	white twill	+\$0
LBR	phantom ecru A	+\$0
LBS	phantom cocoa A	+\$0
LBU	medium matte walnut (CP) A	+\$0
LBV	warm grey teak A	+\$0
LT	light tone	+\$0
LU	soft white	+\$0
WL	warm stone (CP)	+\$0
WN	warm grey neutral	+\$0

Step 8. Edge Finish

For high-pressure laminate/thermoplastic edge (H)

125	natural maple (CP)	+\$0
126	natural cherry (CP)	+\$0
127	walnut (CP)	+\$0
139	light ash (CP)	+\$0
140	warm ash (CP)	+\$0
76	light brown walnut	+\$0
8Q	folkstone grey (CP)	+\$0
91	white (CP)	+\$0
98	studio white (CP)	+\$0
CL	cool grey neutral	+\$0
G1	graphite (CP)	+\$0
HF	inner tone light	+\$0
HP	light anigre	+\$0
LBA	clear on ash (CP)	+\$0
LBB	oak on ash (CP)	+\$0
LBC	walnut on ash (CP)	+\$0
LBF	neutral twill	+\$0
LBJ	graphite twill	+\$0
LBQ	white twill	+\$0
LBR	phantom ecru	+\$0
LBS	phantom cocoa	+\$0
LBU	medium matte walnut (CP)	+\$0
LBV	warm grey teak	+\$0
LU	soft white	+\$0
WL	warm stone (CP)	+\$0
WN	warm grey neutral	+\$0

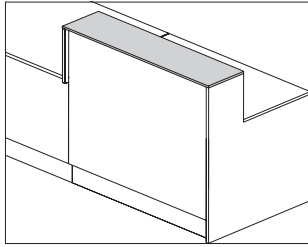

Product Information

Description

This transaction surface attaches to a 42"-high frame. It is 1" thick with a thin profile edge and comes in Corian® only. Corian seaming is to be done in the field. Attachment hardware included.

Notes

Specify raw edge where the 2 Corian edges meet to allow for seaming in the field.

Seaming kit included when raw edge is specified.

Transaction surface must match width of frame.

Handedness is determined from interior/user side of the application.

Order the following products separately:

- Commend frame (HQ100.)

Dimensions

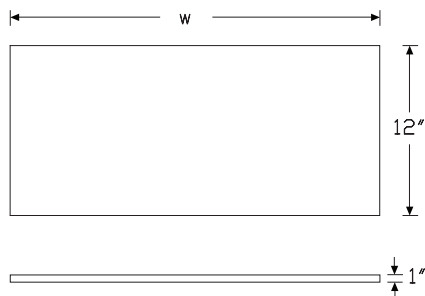

Specification Information

Step 1.

HQ405.

Step 2. Approach / User Edge Profile

T thin profile top

Step 3. Depth

12 12" deep

Step 4. Frame Width

03 3' wide

04 4' wide

05 5' wide

06 6' wide

07 7' wide

08 8' wide

Step 5. Surface Material

K corian

Step 6. End Edge Detail

BF both end edges finished

BR both end edges raw

LF left finished - right raw edge

RF right finished - left raw edge

Prices for Steps 1-6.

		03KBF	03KBR	03KLF	03KRF	04KBF	04KBR
HQ405. T 12		\$3691	3523	3606	3606	4194	4025
		04KLF	04KRF	05KBF	05KBR	05KLF	05KRF
HQ405. T 12		\$4110	4110	4361	4194	4277	4277
		06KBF	06KBR	06KLF	06KRF	07KBF	07KBR
HQ405. T 12		\$4696	4529	4612	4612	5450	5283
		07KLF	07KRF	08KBF	08KBR	08KLF	08KRF
HQ405. T 12		\$5367	5367	6205	5953	6037	6037

Commend™ Transaction Surface

continued

Commend™ Surfaces

Step 7. Surface Finish		
1S	savannah	+\$475
1U	sahara	+\$102
4I	sandstone	+\$102
58	cameo white	+\$0
ANC	antarctica	+\$475
CQ	glacier white	+\$0
CRT	concrete	+\$848
DVC	dove	+\$848
IQ	aurora	+\$475
OQ	silt	+\$475
QB	bisque	+\$0
SVG	silver gray	+\$0

Commend™ Corner Transaction Surface

HQ415.

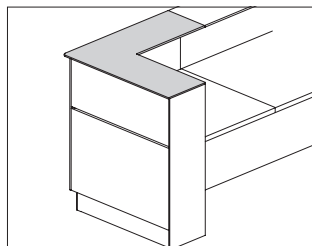

Product Information

Description

This corner transaction surface attaches to a 42"-high corner frame. It is 1" thick with a thin profile edge and comes in Corian® only. Corian seaming is to be done in the field. Attachment hardware included.

Notes

Specify raw edge where the 2 Corian edges meet to allow for seaming in the field.

Seaming kit included when raw edge is specified.

Handedness is determined from interior/user side of the application.

Order the following products separately:

- Commend corner frame (HQ110.)

Dimensions

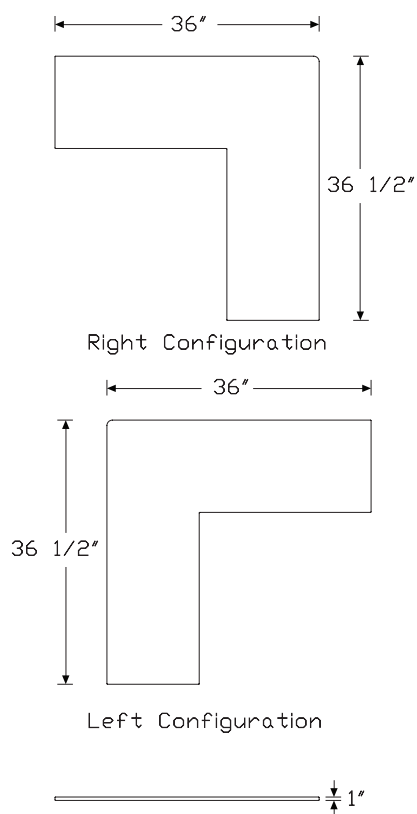

Specification Information

Step 1.

HQ415.

Step 2. Approach / User Edge Profile

T thin profile top

Step 3. Depth

12 12" deep

Step 4. Frame Width

03 3' wide x 3' wide

Step 5. Surface Material

K corian

Step 6. End Edge Detail

BF both end edges finished

BR both end edges raw

LF left finished - right raw edge

RF right finished - left raw edge

Prices for Steps 1-6.

	03KBF	03KBR	03KLF	03KRKF
HQ415. T 12	\$4468	4288	4379	4379

Step 7. Surface Finish

1S	savannah	+\$457
1U	sahara	+\$98
4I	sandstone	+\$98
58	cameo white	+\$0
ANC	antarctica	+\$457
CQ	glacier white	+\$0
CRT	concrete	+\$815
DVC	dove	+\$815
IQ	aurora	+\$457
OQ	silt	+\$457
QB	bisque	+\$0
SVG	silver gray	+\$0

Commend™ Corner Close Out Transaction Surface

HQ425.

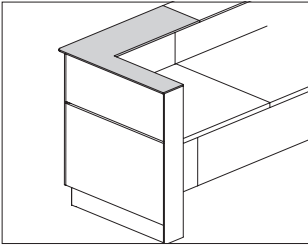

Product Information
Description This corner close out transaction surface attaches to a 42"-high corner close out frame. It is 1" thick with a thin profile edge and comes in Corian® only. Corian seaming is to be done in the field. Attachment hardware included.
Notes Specify raw edge where the 2 Corian edges meet to allow for seaming in the field. Seaming kit included when raw edge is specified. Handedness is determined from interior/user side of the application. Order the following products separately: • Commend corner close out frame (HQ120.)

Dimensions

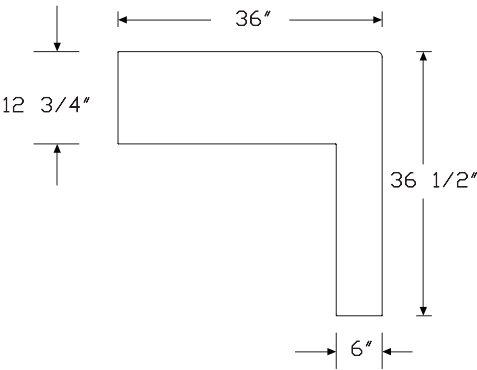

Right Configuration

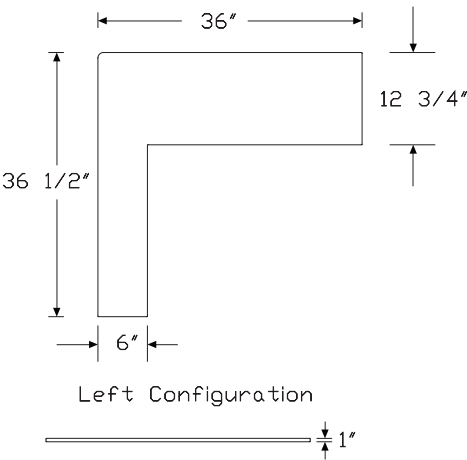

Left Configuration

Commend™ Surfaces

Commend™ Corner Close Out Transaction Surface *continued*

Specification Information

Step 1.

HQ425.

Step 2. Approach / User Edge Profile

T thin profile top

Step 3. Depth

12 12" deep

Step 4. Frame Width

3L 3' wide x 3' wide, return frame left side

3R 3' wide x 3' wide, return frame right side

Step 5. Surface Material

K corian

Step 6. End Edge Detail

For 3' wide x 3' wide, return frame left side (3L)

BF both end edges finished

LF left finished - right raw edge

For 3' wide x 3' wide, return frame right side (3R)

BF both end edges finished

RF right finished - left raw edge

Prices for Steps 1-6.

	3LKBFBF	3LKLFBF	3RKBFBF	3RKRFBF
HQ425. T 12	\$3932	3842	3932	3842

Step 7. Surface Finish

1S	savannah	+\$402
1U	sahara	+\$86
4I	sandstone	+\$86
58	cameo white	+\$0
ANC	antarctica	+\$402
CQ	glacier white	+\$0
CRT	concrete	+\$718
DVC	dove	+\$718
IQ	aurora	+\$402
OQ	silt	+\$402
QB	bisque	+\$0
SVG	silver gray	+\$0

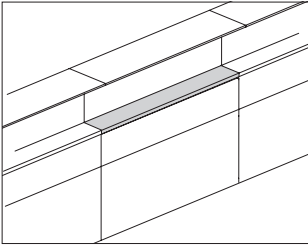

Product Information

Description

This surface conceals a 42"-high frame when a work surface is not desired. Shelf provides 6" of surface. It is 1" thick with a squared edge. Attachment hardware included.

Notes

Grain direction runs the width of the shelf only.
Width of utility shelf must match width of frame.
When using utility shelf, order interior cladding for use with utility shelf (HQ300.42xxUS) separately.

Dimensions

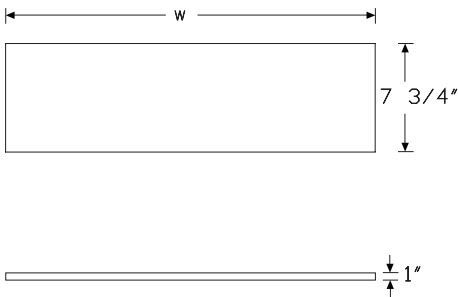

Specification Information

Step 1.

HQ401.

Step 2. Shelf Edge

S squared-edge

Step 3. Frame Width

- 03 3' wide
- 04 4' wide
- 05 5' wide
- 06 6' wide
- 07 7' wide
- 08 8' wide

Step 4. Surface Material

- K corian
- H high-pressure laminate/thermoplastic edge

Prices for Steps 1-4.

		K	H
HQ401. S	03	\$1813	345
	04	\$2225	420
	05	\$2613	552
	06	\$3134	659
	07	\$3540	801
	08	\$3932	860

Step 5. Shelf Finish

For corian (K)

1S	savannah	+\$267
1U	sahara	+\$57
4I	sandstone	+\$57
58	cameo white	+\$0
ANC	antarctica	+\$267
CQ	glacier white	+\$0
CRT	concrete	+\$477
DVC	dove	+\$477
IQ	aurora	+\$267
OQ	silt	+\$267
QB	bisque	+\$0
SVG	silver gray	+\$0

For high-pressure laminate/thermoplastic edge (H)

125	natural maple (CP)	+\$0
126	natural cherry (CP)	+\$0
127	walnut (CP)	+\$0
139	light ash (CP)	+\$0
140	warm ash (CP)	+\$0
76	light brown walnut	+\$0
8Q	folkstone grey (CP)	+\$0
91	white (CP)	+\$0
98	studio white (CP)	+\$0
CL	cool grey neutral	+\$0
HF	inner tone light	+\$0
HP	light anigre	+\$0
LBA	clear on ash (CP)	+\$0
LBB	oak on ash (CP)	+\$0
LBC	walnut on ash (CP)	+\$0
LBF	neutral twill	+\$0
LBJ	graphite twill	+\$0
LBQ	white twill	+\$0
LBR	phantom ecru	+\$0
LBS	phantom cocoa	+\$0
LBU	medium matte walnut (CP)	+\$0
LBV	warm grey teak	+\$0
LT	light tone	+\$0
LU	soft white	+\$0
WL	warm stone (CP)	+\$0
WN	warm grey neutral	+\$0

Step 6. Edge Finish

For high-pressure laminate/thermoplastic edge (H)

125	natural maple (CP)	+\$0
126	natural cherry (CP)	+\$0
127	walnut (CP)	+\$0
139	light ash (CP)	+\$0
140	warm ash (CP)	+\$0
76	light brown walnut	+\$0
8Q	folkstone grey (CP)	+\$0
91	white (CP)	+\$0
98	studio white (CP)	+\$0
CL	cool grey neutral	+\$0
G1	graphite (CP)	+\$0
HF	inner tone light	+\$0
HP	light anigre	+\$0
LBA	clear on ash (CP)	+\$0
LBB	oak on ash (CP)	+\$0
LBC	walnut on ash (CP)	+\$0
LBF	neutral twill	+\$0
LBJ	graphite twill	+\$0
LBQ	white twill	+\$0
LBR	phantom ecru	+\$0
LBS	phantom cocoa	+\$0
LBU	medium matte walnut (CP)	+\$0
LBV	warm grey teak	+\$0
LU	soft white	+\$0
WL	warm stone (CP)	+\$0
WN	warm grey neutral	+\$0

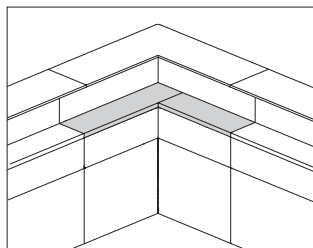

Description

Notes

Surface to be field cut.

Order the following product separately:

- Commend wall filler (HQ130.)

Dimensions

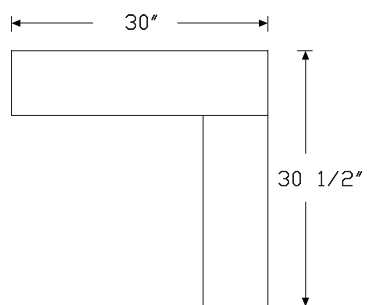

Right Configuration

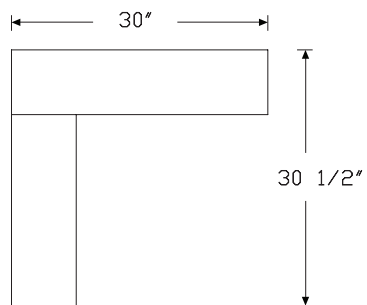

Left Configuration

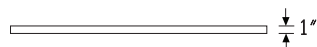

Step 1.

HQ411.

Step 2. Frame Width

03 3' wide x 3' wide

Step 3. Shelf Edge

S squared-edge

Step 4. Handedness

L left

R right

Step 5. Surface Material

K corian

H high-pressure laminate/thermoplastic edge

Prices for Steps 1-5.

	LK	LH	RK	RH
HQ411. 03 S	\$2344	659	2344	659

Step 6. Shelf Finish

For corian (K)

1S	savannah	+\$240
1U	sahara	+\$51
4I	sandstone	+\$51
58	cameo white	+\$0
ANC	antarctica	+\$240
CQ	glacier white	+\$0
CRT	concrete	+\$428
DVC	dove	+\$428
IQ	aurora	+\$240
OQ	silt	+\$240
QB	bisque	+\$0
SVG	silver gray	+\$0

Commend™ Corner Utility Shelf

continued

For high-pressure laminate/thermoplastic edge (H)

125	natural maple (CP)	+\$0
126	natural cherry (CP)	+\$0
127	walnut (CP)	+\$0
139	light ash (CP)	+\$0
140	warm ash (CP)	+\$0
76	light brown walnut	+\$0
8Q	folkstone grey (CP)	+\$0
91	white (CP)	+\$0
98	studio white (CP)	+\$0
CL	cool grey neutral	+\$0
HF	inner tone light	+\$0
HP	light anigre	+\$0
LBA	clear on ash (CP)	+\$0
LBB	oak on ash (CP)	+\$0
LBC	walnut on ash (CP)	+\$0
LBF	neutral twill	+\$0
LBJ	graphite twill	+\$0
LBQ	white twill	+\$0
LBR	phantom ecru	+\$0
LBS	phantom cocoa	+\$0
LBU	medium matte walnut (CP)	+\$0
LBV	warm grey teak	+\$0
LT	light tone	+\$0
LU	soft white	+\$0
WL	warm stone (CP)	+\$0
WN	warm grey neutral	+\$0

Step 7. Edge Finish

For high-pressure laminate/thermoplastic edge (H)

125	natural maple (CP)	+\$0
126	natural cherry (CP)	+\$0
127	walnut (CP)	+\$0
139	light ash (CP)	+\$0
140	warm ash (CP)	+\$0
76	light brown walnut	+\$0
8Q	folkstone grey (CP)	+\$0
91	white (CP)	+\$0
98	studio white (CP)	+\$0
CL	cool grey neutral	+\$0
G1	graphite (CP)	+\$0
HF	inner tone light	+\$0
HP	light anigre	+\$0
LBA	clear on ash (CP)	+\$0
LBB	oak on ash (CP)	+\$0
LBC	walnut on ash (CP)	+\$0
LBF	neutral twill	+\$0
LBJ	graphite twill	+\$0
LBQ	white twill	+\$0
LBR	phantom ecru	+\$0
LBS	phantom cocoa	+\$0
LBU	medium matte walnut (CP)	+\$0
LBV	warm grey teak	+\$0
LU	soft white	+\$0
WL	warm stone (CP)	+\$0
WN	warm grey neutral	+\$0

Commend™ Surfaces

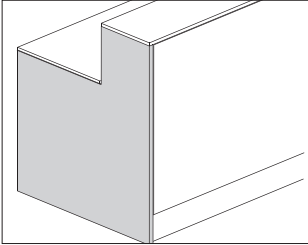

Product Information

Description
This panel attaches at the end of a run to conceal the frame. It is available in high-pressure laminate or Corian®. Corian end panels are to be field cut to site-specific floor conditions to minimize gaps between bottom of panel and floor. Laminate end panel condition from bottom of panel to floor to be adjusted with structural glides. End panel attachment hardware included.

Notes
36"-deep end panel that caps frame and extends full depth of work surface (FS, FT) is only available in Corian.
36"-deep end panels (FS, FT) require loop leg (HQ540.).
Handedness is determined from interior/user side of the application.
Order the following product separately for frame (HQ100.):
• Commend loop leg (HQ540.)

Dimensions

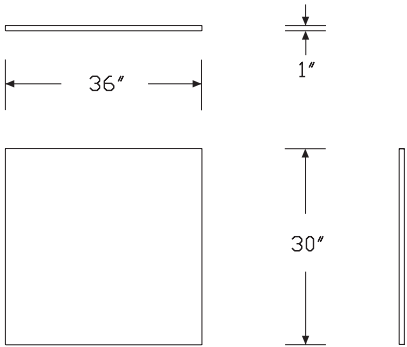
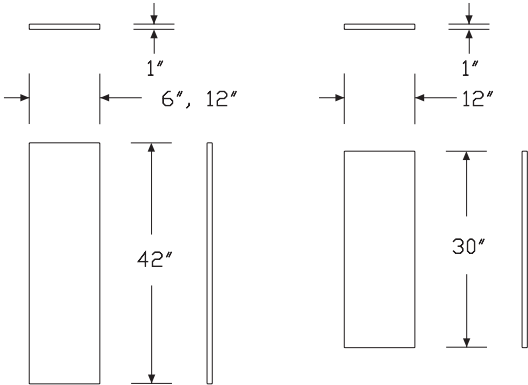
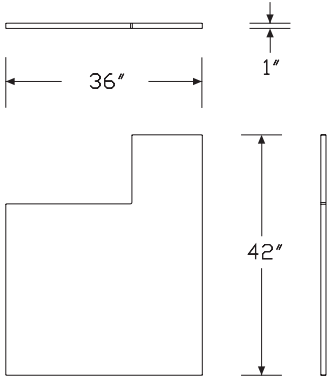

Commend™ Supports

Specification Information**Step 1.****HQ500.****Step 2. Frame Height****30** 30" high**42** 42" high**Step 3. End Panel Depth***For 30" high (30)***CS** 12" deep end panel caps the frame**FS** 36" deep end panel extends the full depth of the work surface and frame**WS** 12" deep end panel for use with wall filler*For 42" high (42)***CE** 6" deep end panel corner close out, caps the frame**CT** 12" deep end panel caps the frame**FT** 36" deep end panel caps the frame extends full depth of the work surface**WT** 12" deep end panel for use with wall filler**Step 4. Handedness****L** left**R** right**Step 5. Surface Material**

For 6" deep end panel corner close out, caps the frame (CE), 12" deep end panel caps the frame (CS), 12" deep end panel caps the frame (CT), 36" deep end panel extends the full depth of the work surface and frame (FS), 12" deep end panel for use with wall filler (WS), or 12" deep end panel for use with wall filler (WT)

K corian**H** high-pressure laminate/thermoplastic edge

For 36" deep end panel caps the frame extends full depth of the work surface (FT)

K corian**Prices for Steps 1-5.**

	LK	LH	RK	RH
HQ500. 30 CS	\$2861	589	2861	589
FS	\$4293	882	4293	882
WS	\$2861	589	2861	589

42 CE	\$2200	653	2200	653
CT	\$3282	674	3282	674
FT	\$5367	—	5367	—
WT	\$3282	674	3282	674

Step 6. Grain Direction*For high-pressure laminate/thermoplastic edge (H)***HRG** horizontal grain +\$0**VTG** vertical grain +\$0**Step 7. Surface Finish***For corian (K)***1S** savannah +\$357**1U** sahara +\$77**4I** sandstone +\$77**58** cameo white +\$0**ANC** antarctica +\$357**CQ** glacier white +\$0**CRT** concrete +\$638**DVC** dove +\$638**IQ** aurora +\$357**OQ** silt +\$357**QB** bisque +\$0**SVG** silver gray +\$0

For high-pressure laminate/thermoplastic edge (H)

125	natural maple (CP)	+\$0
126	natural cherry (CP)	+\$0
127	walnut (CP)	+\$0
139	light ash (CP)	+\$0
140	warm ash (CP)	+\$0
76	light brown walnut	+\$0
8Q	folkstone grey (CP)	+\$0
91	white (CP)	+\$0
98	studio white (CP)	+\$0
CL	cool grey neutral	+\$0
HF	inner tone light	+\$0
HP	light anigre	+\$0
LBA	clear on ash (CP)	+\$0
LBB	oak on ash (CP)	+\$0
LBC	walnut on ash (CP)	+\$0
LBF	neutral twill	+\$0
LBJ	graphite twill	+\$0
LBQ	white twill	+\$0
LBR	phantom ecru A	+\$0
LBS	phantom cocoa A	+\$0
LBU	medium matte walnut (CP) A	+\$0
LBV	warm grey teak A	+\$0
LT	light tone	+\$0
LU	soft white	+\$0
WL	warm stone (CP)	+\$0
WN	warm grey neutral	+\$0

Step 8. Edge Finish

For high-pressure laminate/thermoplastic edge (H)

125	natural maple (CP)	+\$0
126	natural cherry (CP)	+\$0
127	walnut (CP)	+\$0
139	light ash (CP)	+\$0
140	warm ash (CP)	+\$0
76	light brown walnut	+\$0
8Q	folkstone grey (CP)	+\$0
91	white (CP)	+\$0
98	studio white (CP)	+\$0
CL	cool grey neutral	+\$0
G1	graphite (CP)	+\$0
HF	inner tone light	+\$0
HP	light anigre	+\$0
LBA	clear on ash (CP)	+\$0
LBB	oak on ash (CP)	+\$0
LBC	walnut on ash (CP)	+\$0
LBF	neutral twill	+\$0
LBJ	graphite twill	+\$0
LBQ	white twill	+\$0
LBR	phantom ecru	+\$0
LBS	phantom cocoa	+\$0
LBU	medium matte walnut (CP)	+\$0
LBV	warm grey teak	+\$0
LU	soft white	+\$0
WL	warm stone (CP)	+\$0
WN	warm grey neutral	+\$0

Commend™ Change of Height End Panel

HQ505.

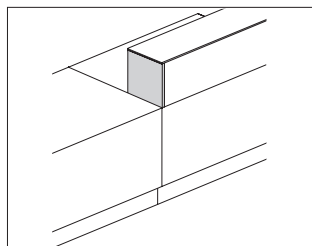

Product Information

Description

This end panel conceals the structure when transitioning from a 30"-high frame to a 42"-high frame. It is available in high-pressure laminate or Corian®. Corian end panel is to be field cut to minimize gaps between bottom of panel and 30"-high work surface. Attachment hardware included.

Notes

Handedness is determined from interior/user side of the application.

Dimensions

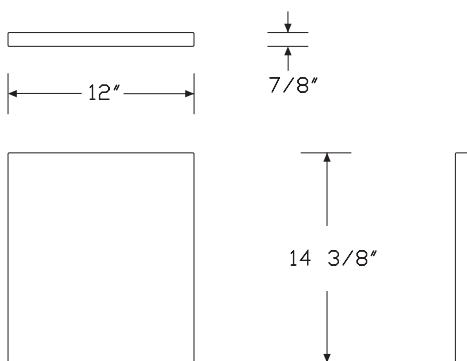

Specification Information

Step 1.

HQ505.

Step 2. Frame Height

42 42" high

Step 3. Handedness

L left change of height end panel
R right change of height end panel

Step 4. Surface Material

K corian
H high-pressure laminate/thermoplastic edge

Prices for Steps 1-4.

	K	H
HQ505. 42 L	\$1601	561
R	\$1601	561

Step 5. Grain Direction

For high-pressure laminate/thermoplastic edge (H)

HRG	horizontal grain	+\$0
VTG	vertical grain	+\$0

Step 6. Surface Finish

For corian (K)

1S	savannah	+\$130
1U	sahara	+\$28
4I	sandstone	+\$28
58	cameo white	+\$0
ANC	antarctica	+\$130
CQ	glacier white	+\$0
CRT	concrete	+\$232
DVC	dove	+\$232
IQ	aurora	+\$130
OQ	silt	+\$130
QB	bisque	+\$0
SVG	silver gray	+\$0

Commend™ Supports

Commend™ Change of Height End Panel *continued*

Commend™ Supports

For high-pressure laminate/thermoplastic edge (H)

125	natural maple (CP)	+\$0
126	natural cherry (CP)	+\$0
127	walnut (CP)	+\$0
139	light ash (CP)	+\$0
140	warm ash (CP)	+\$0
76	light brown walnut	+\$0
8Q	folkstone grey (CP)	+\$0
91	white (CP)	+\$0
98	studio white (CP)	+\$0
CL	cool grey neutral	+\$0
HF	inner tone light	+\$0
HP	light anigre	+\$0
LBA	clear on ash (CP)	+\$0
LBB	oak on ash (CP)	+\$0
LBC	walnut on ash (CP)	+\$0
LBF	neutral twill	+\$0
LBJ	graphite twill	+\$0
LBQ	white twill	+\$0
LBR	phantom ecru A	+\$0
LBS	phantom cocoa A	+\$0
LBU	medium matte walnut (CP) A	+\$0
LBV	warm grey teak A	+\$0
LT	light tone	+\$0
LU	soft white	+\$0
WL	warm stone (CP)	+\$0
WN	warm grey neutral	+\$0

Step 7. Edge Finish

For high-pressure laminate/thermoplastic edge (H)

125	natural maple (CP)	+\$0
126	natural cherry (CP)	+\$0
127	walnut (CP)	+\$0
139	light ash (CP)	+\$0
140	warm ash (CP)	+\$0
76	light brown walnut	+\$0
8Q	folkstone grey (CP)	+\$0
91	white (CP)	+\$0
98	studio white (CP)	+\$0
CL	cool grey neutral	+\$0
G1	graphite (CP)	+\$0
HF	inner tone light	+\$0
HP	light anigre	+\$0
LBA	clear on ash (CP)	+\$0
LBB	oak on ash (CP)	+\$0
LBC	walnut on ash (CP)	+\$0
LBF	neutral twill	+\$0
LBJ	graphite twill	+\$0
LBQ	white twill	+\$0
LBR	phantom ecru	+\$0
LBS	phantom cocoa	+\$0
LBU	medium matte walnut (CP)	+\$0
LBV	warm grey teak	+\$0
LU	soft white	+\$0
WL	warm stone (CP)	+\$0
WN	warm grey neutral	+\$0

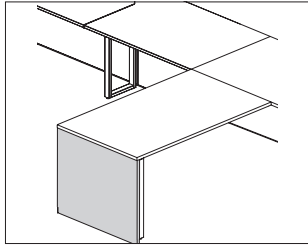

Product Information

Description

This panel attaches at the end of an approach peninsula or work peninsula surface to conceal the loop leg support. It is available in high-pressure laminate or Corian®. Corian end panels are to be field cut to site-specific floor conditions to minimize gaps between bottom of panel and floor. Laminate end panel condition from bottom of panel to floor to be adjusted with structural glides. End panel attachment hardware included.

Notes

Handedness is determined from interior/user side of the application.
 For appropriate installation of modesty panel (HQ630.), specify peninsula end panel for use with modesty panel (HQ530.AYM).
 Order the following products separately:
 • Commend loop leg (HQ540.)
 Order the following optional products separately:
 • Commend peninsula modesty panel (HQ630.)

Dimensions

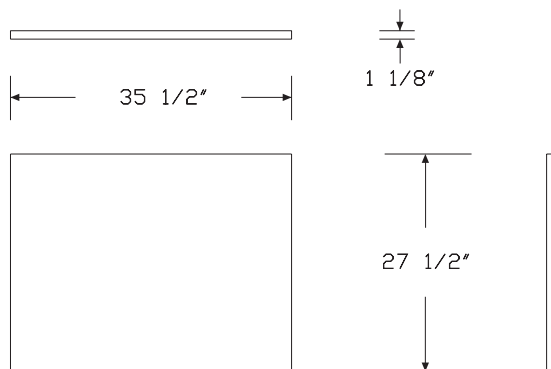

Specification Information

Step 1.

HQ530.

Step 2. Peninsula Type

A approach
W work

Step 3. Modesty

For approach (A)

NM no modesty
YM modesty

For work (W)

NM no modesty

Step 4. Handedness

For approach (A) with modesty (YM)

L end panel, left
R end panel, right

For approach (A) or work (W) with no modesty (NM)

N end panel, non - handed

Step 5. Surface Material

K corian
H high-pressure laminate/thermoplastic edge

Prices for Steps 1-5.

		LK	LH	NK	NH	RK	RH
HQ530. A	NM	—	—	\$3782	878	—	—
	YM	\$3847	929	—	—	3847	929
	W NM	—	—	\$3782	878	—	—

Step 6. Grain Direction

For high-pressure laminate/thermoplastic edge (H)

HRG horizontal grain +\$0
VTG vertical grain +\$0

Commend™ Peninsula End Panel

continued

Commend™ Supports

Step 7. Surface Finish

For corian (K)

1S	savannah	+\$421
1U	sahara	+\$90
4I	sandstone	+\$90
58	cameo white	+\$0
ANC	antarctica	+\$421
CQ	glacier white	+\$0
CRT	concrete	+\$751
DVC	dove	+\$751
IQ	aurora	+\$421
OQ	silt	+\$421
QB	bisque	+\$0
SVG	silver gray	+\$0

For high-pressure laminate/thermoplastic edge (H)

125	natural maple (CP)	+\$0
126	natural cherry (CP)	+\$0
127	walnut (CP)	+\$0
139	light ash (CP)	+\$0
140	warm ash (CP)	+\$0
76	light brown walnut	+\$0
8Q	folkstone grey (CP)	+\$0
91	white (CP)	+\$0
98	studio white (CP)	+\$0
CL	cool grey neutral	+\$0
HF	inner tone light	+\$0
HP	light anigre	+\$0
LBA	clear on ash (CP)	+\$0
LBB	oak on ash (CP)	+\$0
LBC	walnut on ash (CP)	+\$0
LBF	neutral twill	+\$0
LBJ	graphite twill	+\$0
LBQ	white twill	+\$0
LBR	phantom ecru A	+\$0
LBS	phantom cocoa A	+\$0
LBU	medium matte walnut (CP) A	+\$0
LBV	warm grey teak A	+\$0
LT	light tone	+\$0
LU	soft white	+\$0
WL	warm stone (CP)	+\$0
WN	warm grey neutral	+\$0

Step 8. Edge Finish

For high-pressure laminate/thermoplastic edge (H)

125	natural maple (CP)	+\$0
126	natural cherry (CP)	+\$0
127	walnut (CP)	+\$0
139	light ash (CP)	+\$0
140	warm ash (CP)	+\$0
76	light brown walnut	+\$0
8Q	folkstone grey (CP)	+\$0
91	white (CP)	+\$0
98	studio white (CP)	+\$0
CL	cool grey neutral	+\$0
G1	graphite (CP)	+\$0
HF	inner tone light	+\$0
HP	light anigre	+\$0
LBA	clear on ash (CP)	+\$0
LBB	oak on ash (CP)	+\$0
LBC	walnut on ash (CP)	+\$0
LBF	neutral twill	+\$0
LBJ	graphite twill	+\$0
LBQ	white twill	+\$0
LBR	phantom ecru	+\$0
LBS	phantom cocoa	+\$0
LBU	medium matte walnut (CP)	+\$0
LBV	warm grey teak	+\$0
LU	soft white	+\$0
WL	warm stone (CP)	+\$0
WN	warm grey neutral	+\$0

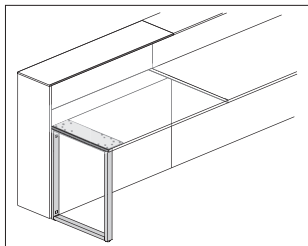

Product Information

Description

This individual leg supports a work surface or peninsula. 24"- and 36"-deep legs can be concealed with an end panel, ordered separately. Leg has leveling glides with 1½" of adjustment. Attachment hardware included.

Notes

For use with frame (HQ100.), specify 24"-deep (24) loop leg.
 For use with approach peninsula (HQ430.) or work peninsula (HQ435.), specify 36"-deep (36) loop leg.
 12"-deep loop leg (12) is to be used for mid-run support. See Commend™ planning guide for planning rules.
 Order the following optional products separately:
 • Commend end panel (HQ500.)

Dimensions

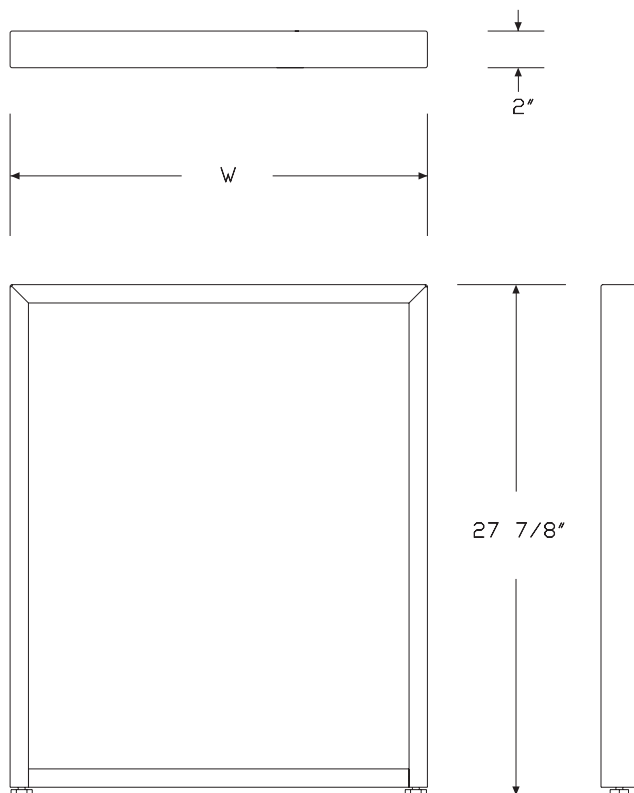

Specification Information

Step 1.

HQ540.

Step 2. Support Depth

12 12" deep, mid run support
24 24" deep, end of run support
36 36" deep, peninsula support

Step 3. End Panel Attachment

For 12" deep, mid run support (12)

N no panel attachment, open loop leg

For 24" deep, end of run support (24) or 36" deep, peninsula support (36)

N no panel attachment, open loop leg

P panel attachment, closed loop leg

Step 4. Surface Material

K for use with corian

H for use with high-pressure laminate/thermoplastic edge

Prices for Steps 1-4.

	K	H
HQ540. 12 N	\$641	641
24 N	\$737	737
P	\$737	737
36 N	\$802	802
P	\$802	802

Step 5. Finish

611	beige mist metallic (CP)	+\$0
613	silver (CP)	+\$0
8Q	folkstone grey (CP)	+\$0
91	white (CP)	+\$0
98	studio white (CP)	+\$0
G1	graphite (CP)	+\$0
SNA	satin aluminum	+\$30
SNB	satin bronze	+\$30
SNC	satin carbon	+\$30
WL	warm stone (CP)	+\$0

Commend™ Works Surface Wall Attachment Bracket

HQ590.

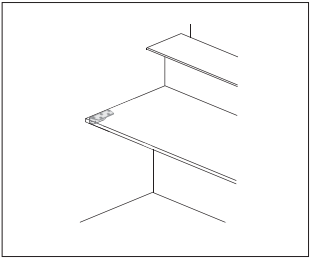

Product Information
Description
This bracket attaches 1 end of a Commend™ work surface to an architectural wall, eliminating the need for an end support. Finish is black. Attachment hardware included.
Notes
Bracket only available for use with work surface attached to end-of-run frame (HQ100.). To receive appropriate hardware for installation, specify work surface material (K) for use with Corian® or (H) for use with high-pressure laminate.
Dimensions

Specification Information
Step 1.
HQ590.
Step 2. Work Surface Material
H for use with high-pressure laminate/thermoplastic edge
K for use with corian
Prices for Steps 1-2.
HQ590. H
K

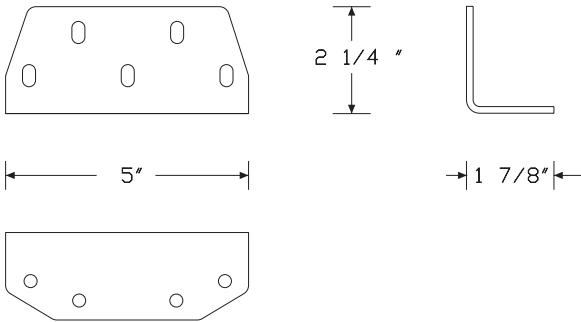

Surface Cantilever

FT290.

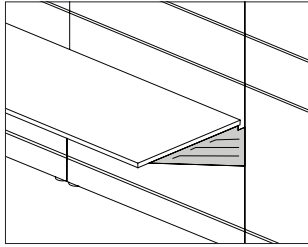

Product Information

Description

This bracket supports a surface on the left or right side and attaches the surface to a frame or wall strips. Attachment hardware and 1 surface cantilever are included.

Notes

Specify cantilever depth to match depth of surface being supported.
Cantilevered surfaces can be placed in 1" vertical increments along the frame or wall strips.

Dimensions

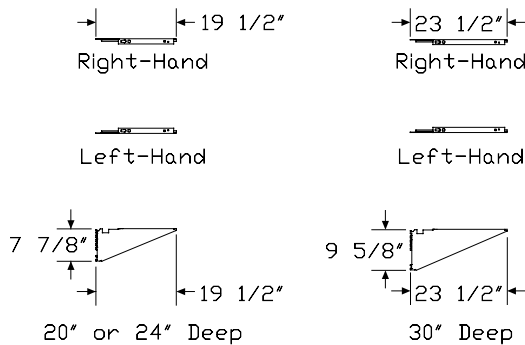

Specification Information

Step 1.

FT290.

Step 2. Surface Depth

24 for 20" or 24"-deep surfaces
30 for 30"-deep surface

Step 3. Position

L left-hand cantilever
R right-hand cantilever

Prices for Steps 1-3.

	L	R
FT290. 24	\$51	51
30	\$61	61

Step 4. Finish

Sand Texture Paint

8Q	folkstone grey (CP) <input type="checkbox"/>	+\$0
91	white (CP)	+\$0
98	studio white (CP) <input type="checkbox"/>	+\$0
BK	black	+\$0
CL	cool grey neutral	+\$0
G1	graphite (CP)	+\$0
UBK	ultra black (CP)	+\$0
WL	warm stone (CP) <input type="checkbox"/>	+\$0
WN	warm grey neutral	+\$0

Reclaimed Paint

RS	ironstone	-\$5
-----------	-----------	------

Metallic Paint

611	beige mist metallic (CP)	+\$0
613	silver (CP)	+\$0
EH	metallic bronze	+\$0
SNA	satin aluminum	+\$10
SNB	satin bronze	+\$10
SNC	satin carbon	+\$10

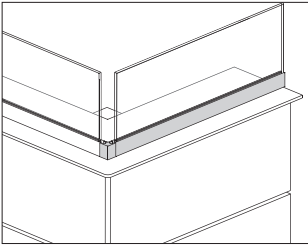

Product Information

Description

This mount attaches an upmount glass screen to a work surface or transaction surface. The mount consists of several components, each to be ordered separately: mount, corner connector, and end caps. Mount is to be field cut to desired length and includes all necessary gaskets and hardware. Corner connector is to be used with corner frame to create a 90° corner. End caps are required for each end of the glass mount.

Notes

Mount only accommodates glass 3/8" thick and not more than 12" high.
Order the following products separately:
• Commend glass screen mount, end cap (HQ600.EC)
Glass not included and is to be sourced locally.
See Commend™ planning guide for glass ordering details.

Dimensions

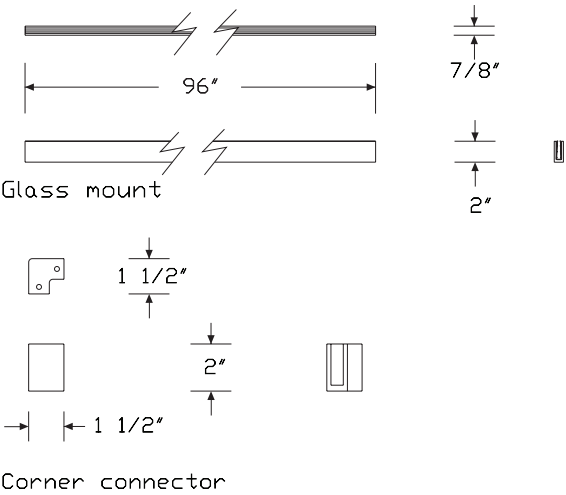

Specification Information

Step 1.

HQ600. A

Step 2. Configuration

GC corner connector A
GS straight 8' long mount A

Step 3. Glass

N3 no glass, for customer's own 3/8" thick glass A

Step 4. Surface Material

H for high-pressure laminate / thermoplastic edge surface attachment A
K for corian surface attachment A

Prices for Steps 1-4.

	H	K
HQ600. GC N3	\$883	883
GS N3	\$1773	1773

Step 5. Finish

For straight 8' long mount (GS)

AN anodized A +\$0

For corner connector (GC)

8Q folkstone grey (CP) A +\$0

Description

Notes

Dimensions

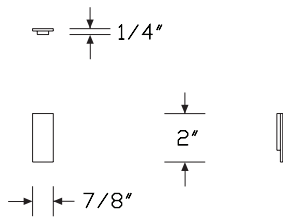

Step 1.

Step 2. Configuration

Step 3. Glass

Step 4. Surface Material

K for corian surface attachment A

Prices for Steps 1-4.

	H	K
HQ600. EC N3	\$507	507

Step 5. Finish

8Q	folkstone grey (CP)	A	+ \$0
----	---------------------	---	-------

Commend™ Surface To Ceiling Glass Mount

HQ605.

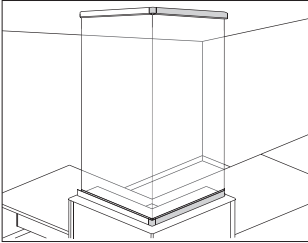

Product Information

Description

This surface-to-ceiling glass mount attaches glass to a transaction surface and an architectural element. It consists of multiple components, each to be ordered separately: top and bottom mount, corner connector, and end caps. Mount is to be field cut to desired length and includes all necessary gaskets and hardware. Corner connector is to be used with corner frame to create a 90° corner. End caps are required for each end of the glass mount.

Notes

Mount only accommodates glass 3/8" thick and tempered.

Corner connectors come as a pair of 2.

Order the following product separately:

- Commend surface to ceiling glass mount, end cap (HQ605.EC)

Glass not included and is to be sourced locally.

Glass installer necessary for installation.

See Commend™ planning guide for specific planning rules.

Dimensions

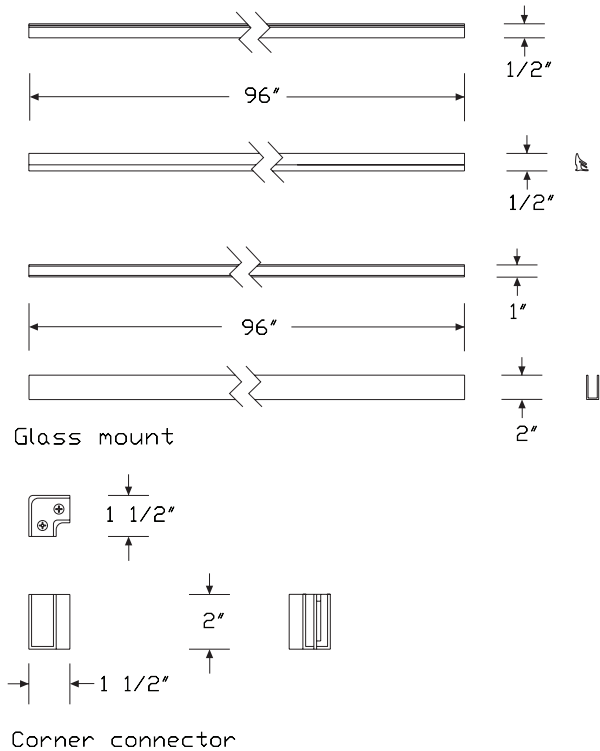

Specification Information

Step 1.

HQ605. A

Step 2. Configuration

GC corner connector (pair) A

GS straight 8' long top and bottom mount A

Step 3. Glass

N3 no glass, for customer's own 3/8" thick glass A

Prices for Steps 1-3.

	N3
HQ605. GC	\$1268
GS	\$2545

Step 4. Finish

For straight 8' long top and bottom mount (GS)

AN anodized A +\$0

For corner connector (pair) (GC)

8Q folkstone grey (CP) A +\$0

Commend™ Surface To Ceiling Glass Mount, End Cap

HQ605.

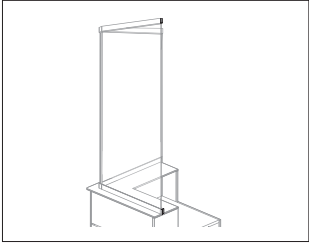

Product Information
Description
These end caps attach to each end of the Commend surface to ceiling glass mount. The surface to ceiling glass mount components attach glass to Commend and to the ceiling. 4 end caps are required for each application. Package contains 4 end caps.
Notes
Order Commend surface to ceiling glass mount (HQ605.) separately.
Dimensions

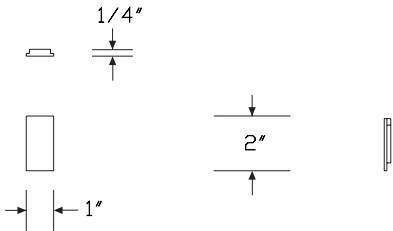

Specification Information
Step 1.
HQ605. <input type="checkbox"/> A
Step 2. Configuration
EC end cap kit (package of 4) <input type="checkbox"/> A
Step 3. Glass
N3 no glass, for customer's own 3/8" thick glass <input type="checkbox"/> A
Prices for Steps 1-3.
HQ605. EC
Step 4. Finish
8Q folkstone grey (CP) <input type="checkbox"/> A

Commend™ Screen

Commend™ Peninsula Modesty Panel HQ630.

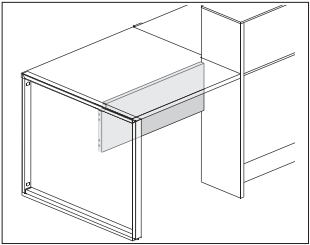

Product Information

Description

This modesty panel provides privacy under the work surface when used with Commend™ approach peninsula surface. Panel suspends from underside of peninsula surface and comes in low-pressure laminate. Attachment hardware included.

Notes

Specify modesty panel width to match width of approach peninsula surface (HQ430.).
Modesty panel cannot be used with Commend work peninsula surface (HQ435.).
For appropriate installation of modesty panel, order Commend peninsula end panel for use with modesty panel (HQ530.AYM) separately.
Handedness is determined from interior/user side of the application.

Dimensions

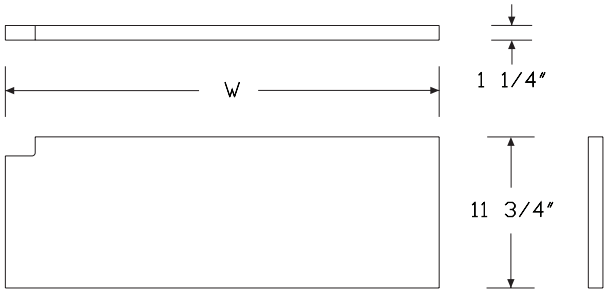

Specification Information

Step 1.

HQ630.

Step 2. Work Surface Width

- 03 3' wide
- 04 4' wide
- 05 5' wide

Step 3. Peninsula Location in Run

- EL end of run left
- ER end of run right

Step 4. Modesty Panel Type

- P partial height

Step 5. Surface Material

- L thermally-fused laminate/thermoplastic edge

Prices for Steps 1-5.

			PL
HQ630.	03	EL	\$384
		ER	\$384
	04	EL	\$448
		ER	\$448
	05	EL	\$510
		ER	\$510

Step 6. Grain Direction

- HRG horizontal grain +\$0
- VTG vertical grain +\$0

Commend™ Peninsula Modesty Panel

continued

Step 7. Surface Finish

125	natural maple (CP)	+\$0
126	natural cherry (CP)	+\$0
127	walnut (CP)	+\$0
139	light ash (CP)	+\$0
140	warm ash (CP)	+\$0
76	light brown walnut	+\$0
8Q	folkstone grey (CP)	+\$0
91	white (CP)	+\$0
98	studio white (CP)	+\$0
CL	cool grey neutral	+\$0
G1	graphite (CP)	+\$0
HP	light anigre	+\$0
LBA	clear on ash (CP)	+\$0
LBB	oak on ash (CP)	+\$0
LBC	walnut on ash (CP)	+\$0
LBF	neutral twill	+\$0
LBJ	graphite twill	+\$0
LBQ	white twill	+\$0
LBR	phantom ecru	+\$0
LBS	phantom cocoa	+\$0
LBU	medium matte walnut (CP)	+\$0
LBV	warm grey teak	+\$0
LU	soft white	+\$0
WL	warm stone (CP)	+\$0
WN	warm grey neutral	+\$0

Step 8. Edge Finish

125	natural maple (CP)	+\$0
126	natural cherry (CP)	+\$0
127	walnut (CP)	+\$0
139	light ash (CP)	+\$0
140	warm ash (CP)	+\$0
76	light brown walnut	+\$0
8Q	folkstone grey (CP)	+\$0
91	white (CP)	+\$0
98	studio white (CP)	+\$0
CL	cool grey neutral	+\$0
G1	graphite (CP)	+\$0
HF	inner tone light	+\$0
HP	light anigre	+\$0
LBA	clear on ash (CP)	+\$0
LBB	oak on ash (CP)	+\$0
LBC	walnut on ash (CP)	+\$0
LBF	neutral twill	+\$0
LBJ	graphite twill	+\$0
LBQ	white twill	+\$0
LBR	phantom ecru	+\$0
LBS	phantom cocoa	+\$0
LBU	medium matte walnut (CP)	+\$0
LBV	warm grey teak	+\$0
LU	soft white	+\$0
WL	warm stone (CP)	+\$0
WN	warm grey neutral	+\$0

Commend™ Screen

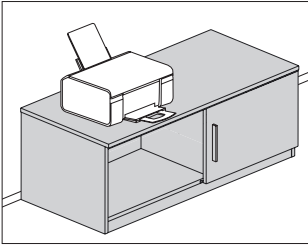

Product Information

Description

This freestanding laminate storage case provides a surface for a printer. Storage is available in high-pressure or low-pressure laminate with a 3/4" top.

Notes

200 pound load limit.
For keyed-alike locks, order lock plugs separately.

Dimensions

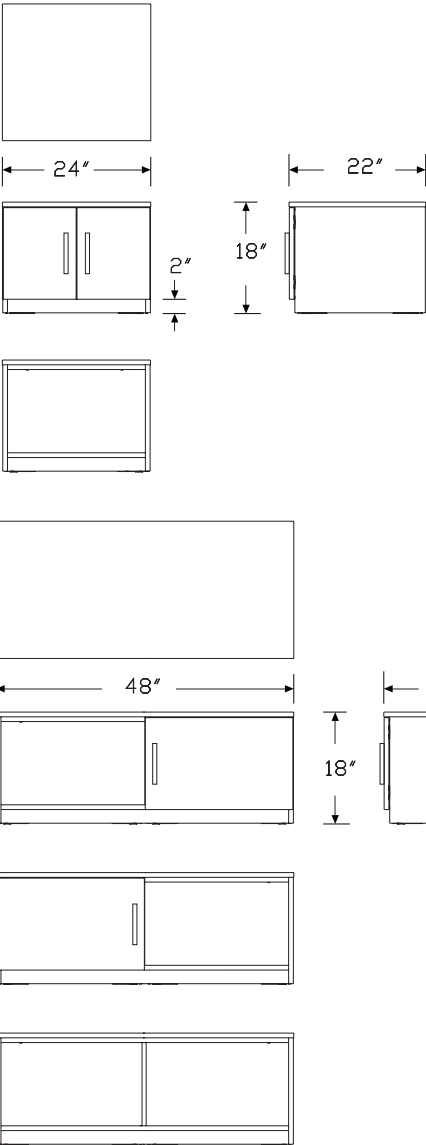

Printer Storage *continued*

Specification Information

Step 1.

CH730.

Step 2. Width

24 24" wide

48 48" wide

Step 3. Depth

22 22" deep

Step 4. Base Type

1 plinth base

Step 5. Storage Options

For 24" wide (24)

DD double doors

OP open storage

For 48" wide (48)

DL hinged door left, open right

DR hinged door right, open left

OP open storage with center support

Step 6. Lock Option

For double doors (DD), hinged door left, open right (DL), or hinged door right, open left (DR)

NL no lock

KA keyed lock, keyed alike

KC keyed lock, keyed differently, chrome

KD keyed lock, keyed differently, black

For open storage (OP) or open storage with center support (OP)

NL no lock

Step 7. Top/Case/Front/Side Material

H high-pressure laminate/thermoplastic edge

L thermally / fused laminate/thermoplastic edge

Prices for Steps 1-7.

	1DDNLH	1DDNLL	1DDKAH	1DDKAL	1DDKCH	1DDKCL
CH730. 24 22	\$1968	1641	2054	1728	2054	1728

	1DDKDH	1DDKDL	1DLNLH	1DLNLL	1DLKAH	1DLKAL
CH730. 24 22	\$2054	1728	—	—	—	—

48 22	—	—	\$2538	2210	2622	2300
--------------	---	---	--------	------	------	------

	1DLKCH	1DLKCL	1DLKDH	1DLKDL	1DRNLH	1DRNLL
CH730. 48 22	\$2622	2300	2622	2300	2538	2210

	1DRKAH	1DRKAL	1DRKCH	1DRKCL	1DRKDH	1DRKDL
CH730. 48 22	\$2622	2300	2622	2300	2622	2300

	10PNLH	10PNLL
CH730. 24 22	\$1470	1142
48 22	\$2252	1924

Step 8. Grain Direction

HRG horizontal grain +\$0

VTG vertical grain +\$0

Step 9. Top/Case/Front Finish

For high-pressure laminate/thermoplastic edge (H)

76 light brown walnut +\$0

8Q folkstone grey (CP) +\$0

91 white (CP) +\$0

98 studio white (CP) +\$0

CL cool grey neutral +\$0

HF inner tone light +\$0

HP light anigre +\$0

LBA clear on ash (CP) +\$0

LBB oak on ash (CP) +\$0

LBC walnut on ash (CP) +\$0

LBF neutral twill +\$0

LBJ graphite twill +\$0

LBQ white twill +\$0

LBR phantom ecru +\$0

LBS phantom cocoa +\$0

LBU medium matte walnut (CP) +\$0

LBV warm grey teak +\$0

LT light tone +\$0

LU soft white +\$0

WL warm stone (CP) +\$0

WN warm grey neutral +\$0

Commend™ Storage

For thermally / fused laminate/thermoplastic edge (L)

76	light brown walnut	+\$0
8Q	folkstone grey (CP)	+\$0
91	white (CP)	+\$0
98	studio white (CP)	+\$0
CL	cool grey neutral	+\$0
G1	graphite (CP)	+\$0
HP	light anigre	+\$0
LBA	clear on ash (CP)	+\$0
LBB	oak on ash (CP)	+\$0
LBC	walnut on ash (CP)	+\$0
LBF	neutral twill	+\$0
LBJ	graphite twill	+\$0
LBQ	white twill	+\$0
LBR	phantom ecru	+\$0
LBS	phantom cocoa	+\$0
LBU	medium matte walnut (CP)	+\$0
LBV	warm grey teak	+\$0
LU	soft white	+\$0
WL	warm stone (CP)	+\$0
WN	warm grey neutral	+\$0

Step 10. Edge Finish

For high-pressure laminate/thermoplastic edge (H)

76	light brown walnut	+\$0
8Q	folkstone grey (CP)	+\$0
91	white (CP)	+\$0
98	studio white (CP)	+\$0
CL	cool grey neutral	+\$0
G1	graphite (CP)	+\$0
HF	inner tone light	+\$0
HP	light anigre	+\$0
LBA	clear on ash (CP)	+\$0
LBB	oak on ash (CP)	+\$0
LBC	walnut on ash (CP)	+\$0
LBF	neutral twill	+\$0
LBJ	graphite twill	+\$0
LBQ	white twill	+\$0
LBR	phantom ecru	+\$0
LBS	phantom cocoa	+\$0
LBU	medium matte walnut (CP)	+\$0
LBV	warm grey teak	+\$0
LU	soft white	+\$0
WL	warm stone (CP)	+\$0
WN	warm grey neutral	+\$0

For thermally / fused laminate/thermoplastic edge (L)

76	light brown walnut	+\$0
8Q	folkstone grey (CP)	+\$0
91	white (CP)	+\$0
98	studio white (CP)	+\$0
CL	cool grey neutral	+\$0
G1	graphite (CP)	+\$0
HF	inner tone light	+\$0
HP	light anigre	+\$0
LBA	clear on ash (CP)	+\$0
LBB	oak on ash (CP)	+\$0
LBC	walnut on ash (CP)	+\$0
LBF	neutral twill	+\$0
LBJ	graphite twill	+\$0
LBQ	white twill	+\$0
LBR	phantom ecru	+\$0
LBS	phantom cocoa	+\$0
LBU	medium matte walnut (CP)	+\$0
LBV	warm grey teak	+\$0
LU	soft white	+\$0
WL	warm stone (CP)	+\$0
WN	warm grey neutral	+\$0

Step 11. Pull Type

For open storage (OP) or open storage with center support (OP)

N	no pull	+\$0
----------	---------	------

For double doors (DD), hinged door left, open right (DL), or hinged door right, open left (DR)

A	arc pull	+\$26
K	bar pull	+\$26
T	tab pull	+\$58
P	profile pull	+\$58
C	curved pull	+\$52

Step 12. Pull Finish

For no pull (N)

NN	none	+\$0
-----------	------	------

For tab pull (T), profile pull (P), or curved pull (C)

STD	standard finish	+\$0
------------	-----------------	------

For arc pull (A)

NH	brushed nickel	+\$0
NK	black nickel	+\$0

Printer Storage *continued*

For bar pull (K)

611	beige mist metallic (CP)	+\$0
613	silver (CP)	+\$0
8Q	folkstone grey (CP)	+\$0
91	white (CP)	+\$0
98	studio white (CP)	+\$0
G1	graphite (CP)	+\$0

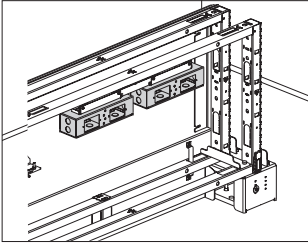

Product Information

Description

This junction box holds a hard-wired, flexible conduit electrical system. Each box includes a bracket. The junction box can hold 2 rectangular-faced receptacles and can be divided to allow for both standard power and emergency power or data in the same box.

Notes

Frame type and width determines the number of included junction boxes.
Frame Width—#of Junction Boxes

- CC—1
- CO—2
- 03—2
- 04—2
- 05—2
- 06—4
- 07—4
- 08—4

For corner close out frame (HQ120.), power can only route along frame width, not depth.
Receptacles, faceplates, and data ports are field supplied and installed.

Dimensions

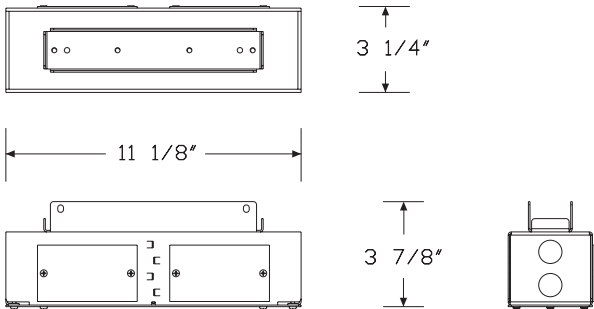

Specification Information

Step 1.

HQ790.

Step 2. Frame Width

- | | |
|----|------------------|
| CC | corner close out |
| CO | corner |
| 03 | 3' wide |
| 04 | 4' wide |
| 05 | 5' wide |
| 06 | 6' wide |
| 07 | 7' wide |
| 08 | 8' wide |

Prices for Steps 1-2.

HQ790. CC	\$445
CO	\$844
03	\$844
04	\$844
05	\$844
06	\$1629
07	\$1629
08	\$1629

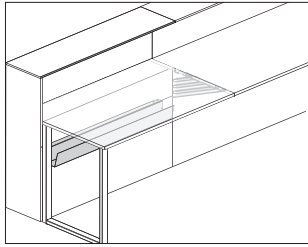

Product Information

Description

This cable trough is painted metal and attaches to the interior cladding under the work surface. It mounts below power knockouts to catch and conceal power cords and cables. Attachment hardware included.

Notes

Specify cable trough width to match width of frame.

For cable trough widths 5', 6', 7', and 8', trough will be in 2 pieces to cover the overall width.

For corner close out frame (HQ120.), power can only route along frame width, not depth.

Dimensions

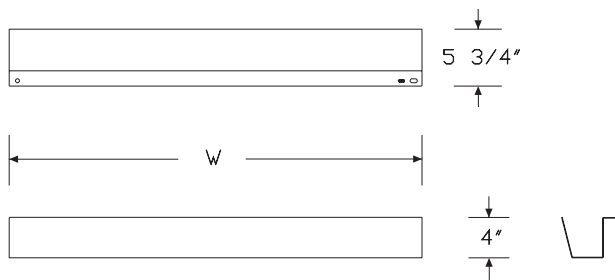

Specification Information

Step 1.

HQ791.

Step 2. Frame Width

03	3' wide
04	4' wide
05	5' wide
06	6' wide
07	7' wide
08	8' wide
CC	corner close out
CO	corner

Prices for Steps 1-2.

HQ791. 03	\$385
04	\$653
05	\$686
06	\$711
07	\$736
08	\$753
CC	\$385
CO	\$711

Step 3. Finish

611	beige mist metallic (CP)	+\$0
613	silver (CP)	+\$0
8Q	folkstone grey (CP)	+\$0
91	white (CP)	+\$0
98	studio white (CP)	+\$0
G1	graphite (CP)	+\$0
SNA	satin aluminum	+\$30
SNB	satin bronze	+\$30
SNC	satin carbon	+\$30
WL	warm stone (CP)	+\$0

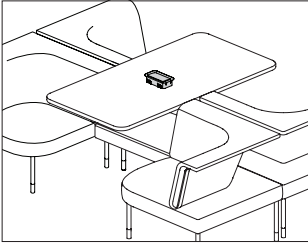

Product Information

Description
This Logic Power Access Solutions™ plastic grommet is available in mini rectangle or mini square configuration. The integrated flaps can hide the things below the surface while also retaining power and data cords.

Notes
This grommet is installed in some HermanMiller applications. Verify your application before ordering grommet separately.

Dimensions

Commend™ Energy Distribution

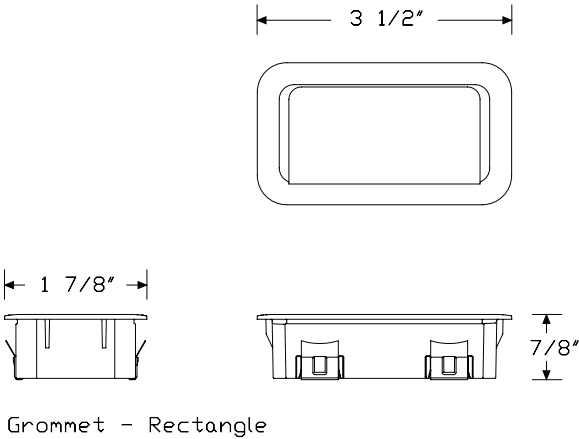

Grommet - Rectangle

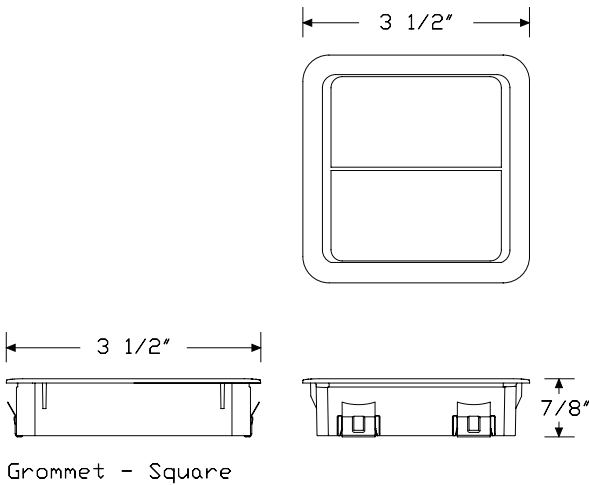

Grommet - Square

Specification Information

Step 1.
Y1412.

Step 2. Configuration
1 mini rectangle grommet
2 mini square grommet

Prices for Steps 1-2.	
Y1412. 1	\$42
2	\$47

Step 3. Finish		
91	white (CP)	+\$0
98	studio white (CP)	+\$0
BK	black	+\$0
G1	graphite (CP)	+\$0
UBK	ultra black (CP)	+\$0

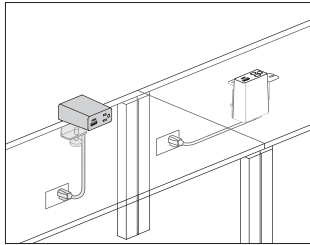

Product Information

Description

This electrical distributor plugs directly into floor, wall, or ceiling drop outlets. Each module configuration presents the same visual appearance. Grommet mount attachment does not come with the mini grommet (order separately as needed). Cable clips and attachment hardware included. Product is UL listed.

Notes

Grommet mount attachment (Y1414.xxxG) does not come with the mini grommet. Order Logic mini grommet (Y1412.) separately, as needed.

Cable clips for cord management are intended for a 1-time installation.

Clamp versions can be reoriented in the field by a technician.

USB ports provide a combined 20 watts of power to charge most devices and tablets at full speed. USB-C provides 15 watts of power and USB-A provides 10 watts of power individually. When using the USB-C and USB-A ports simultaneously, USB-C remains at 15 watts and USB-A reduces to 5 watts.

Cord color is predetermined. For white (91) finish cords will be white. For graphite (G1) finish cords will be black.

Grommet mount attachment (Y1414.xxxG) does not come with the mini grommet. Order Logic mini grommet (Y1412.) separately, as needed.

Dimensions

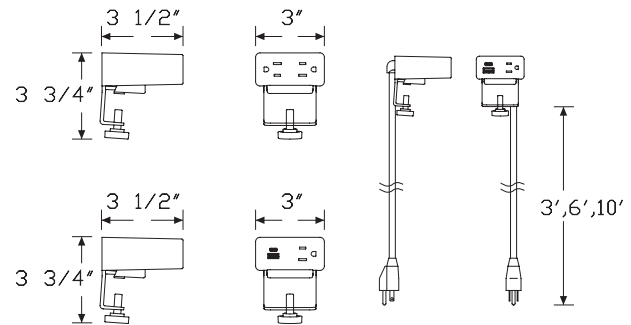

Surface Clamp

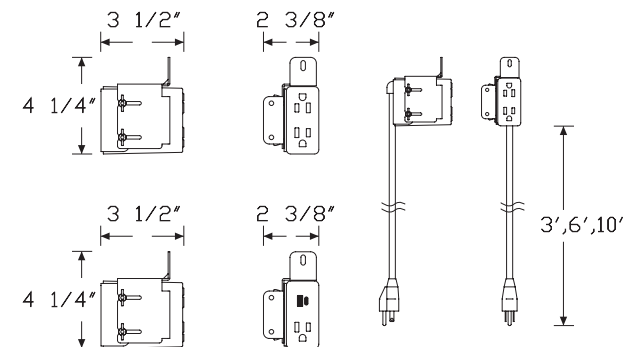

Grommet Mount

Specification Information

Step 1.

Y1414.

Step 2. Configuration

- L 1 simplex receptacles, 1 powered USB A/C Combo
- K 2 simplex receptacles

Step 3. Cord/Conduit Length

- 03 3' cord/conduit
- 06 6' cord/conduit
- 10 10' cord/conduit

Step 4. Attachment

- G grommet mount
- S surface clamp

Prices for Steps 1-4.

			G	S
Y1414.	L	03	\$471	471
		06	\$471	471
		10	\$483	483
	K	03	\$264	264
		06	\$264	264
		10	\$278	278

Step 5. Finish

- BK black ☐ +\$0
- UBK ultra black (CP) +\$0
- 91 white (CP) ☐ +\$0
- 98 studio white (CP) ☐ +\$0
- G1 graphite (CP) ☐ +\$0

Index by Product Name

Commend™ Nurses Station	
Commend™ Approach Peninsula Work Surface	page(s) 44
Commend™ Cable Trough	79
Commend™ Change of Height End Panel	61
Commend™ Corner Close Out Frame	8
Commend™ Corner Close Out Interior Cladding	27
Commend™ Corner Closeout Tackable Fabric Back Panel	33
Commend™ Corner Close Out Transaction Surface	52
Commend™ Corner Close Out Work Surface	41
Commend™ Corner Exterior Cladding	18
Commend™ Corner Frame	7
Commend™ Corner Interior Cladding	25
Commend™ Corner Tackable Fabric Back Panel	32
Commend™ Corner Toe Kick	29
Commend™ Corner Transaction Surface	51
Commend™ Corner Utility Shelf	56
Commend™ Corner Work Surface	38
Commend™ End Panel	58
Commend™ Exterior Cladding	13
Commend™ Floor Anchor Bracket	12
Commend™ Frame	5
Commend™ Frame Feet	9
Commend™ Glass Screen Mount	68
Commend™ Glass Screen Mount, End Cap	69
Commend™ Interior Cladding	23
Commend™ Junction Box	78
Commend™ Loop Leg	65
Commend™ Peninsula End Panel	63
Commend™ Peninsula Modesty Panel	72
Commend™ Seismic Anchor Bracket	11
Commend™ Surface To Ceiling Glass Mount	70
Commend™ Surface To Ceiling Glass Mount, End Cap	71
Commend™ Tackable Fabric Back Panel	30
Commend™ Toe Kick	28
Commend™ Transaction Surface	49
Commend™ Utility Shelf	54
Commend™ Work Peninsula Surface	47
Commend™ Works Surface Wall Attachment Bracket	66
Commend™ Work Surface	34
Logic Mini	81
Logic Mini Grommet	80
Printer Storage	74
Surface Cantilever	67



Index by Product Number

CH730. Printer Storage	page(s) 74
FT290. Surface Cantilever	67
HQ100. Commend™ Frame	5
HQ110. Commend™ Corner Frame	7
HQ120. Commend™ Corner Close Out Frame	8
HQ125. Commend™ Frame Feet	9
HQ140. Commend™ Seismic Anchor Bracket	11
HQ150. Commend™ Floor Anchor Bracket	12
HQ200. Commend™ Exterior Cladding	13
HQ205. Commend™ Toe Kick	28
HQ210. Commend™ Corner Exterior Cladding	18
HQ215. Commend™ Corner Toe Kick	29
HQ300. Commend™ Interior Cladding	23
HQ305. Commend™ Tackable Fabric Back Panel	30
HQ310. Commend™ Corner Interior Cladding	25
HQ315. Commend™ Corner Tackable Fabric Back Panel	32
HQ320. Commend™ Corner Close Out Interior Cladding	27
HQ325. Commend™ Corner Closeout Tackable Fabric Back Panel	33
HQ400. Commend™ Work Surface	34
HQ401. Commend™ Utility Shelf	54
HQ405. Commend™ Transaction Surface	49
HQ410. Commend™ Corner Work Surface	38
HQ411. Commend™ Corner Utility Shelf	56
HQ415. Commend™ Corner Transaction Surface	51
HQ420. Commend™ Corner Close Out Work Surface	41
HQ425. Commend™ Corner Close Out Transaction Surface	52
HQ430. Commend™ Approach Peninsula Work Surface	44
HQ435. Commend™ Work Peninsula Surface	47
HQ500. Commend™ End Panel	58
HQ505. Commend™ Change of Height End Panel	61
HQ530. Commend™ Peninsula End Panel	63
HQ540. Commend™ Loop Leg	65
HQ590. Commend™ Works Surface Wall Attachment Bracket	66
HQ600. Commend™ Glass Screen Mount	68
HQ600. Commend™ Glass Screen Mount, End Cap	69
HQ605. Commend™ Surface To Ceiling Glass Mount	70
HQ605. Commend™ Surface To Ceiling Glass Mount, End Cap	71
HQ630. Commend™ Peninsula Modesty Panel	72
HQ790. Commend™ Junction Box	78
HQ791. Commend™ Cable Trough	79
Y1412. Logic Mini Grommet	80
Y1414. Logic Mini	81





20-Day or Less/Assigned Lead-Time Order Information

GSA

20-Day or Less and Assigned Lead-Time Programs

20-day or less and assigned lead-time products are designed for established Herman Miller dealers with pre-approved credit.

Products are distributed from multiple manufacturing facilities across the United States. All products and options not designated by an Assigned Lead-Time icon  will ship in 20 business days or less after being acknowledged by Herman Miller. Products and options designated by an  are on the assigned lead-time program and will ship in 20 days, less than 20 days, or more than 20 days from order acknowledgement.

Ordering Procedure

Please place orders through Order Manager. If this is not available to you, place orders through mail or fax. Verbal purchase orders will not be accepted.

Order Entry fax number for Meridian® Filing and Storage:

(616) 846 9236.

Order Entry fax number for all other products:

(616) 654 3085.

For more information, contact your Customer Care representative at:

(866) 854 3048 ext 3400.

Shipments and Delivery

Per Herman Miller Terms and Conditions.

Changes and Cancellation

Per Herman Miller Terms and Conditions.



Textiles Application Chart —
Healthcare Workspaces

GSA

- Available

A Assigned lead-time textile.

See page 2 for exception notes.

	Commend™ Tackable Fabric Back Panels	Ethospace® B-Style Storage	Ethospace E-Style Storage	Ethospace Tiles/Connectors	Seating
Price Category 1					
COM Customer's Own Material A	1		1	1	1
2V__ Chain	•		•	•	
8T__ Crossing (85__)	•		•	•	18
3DE__ Dex	•		•	•	•
2I__ Grasscloth	•		•	•	
1MN__ Monologue	•		•	•	•
5T__ Resonance	•		•	•	
22F__ Slant	•			•	
235__ Tailored A	•		•	•	•
1WS__ Whisper	•		•	•	•
Price Category 2					
3AR__ Aristo	•		•	•	•
51__ Cord	•		•	•	
92__ Crepe	•		•	•	•
3EP__ Epic	•		•	•	•
4N__ Horizon	•		•	•	
1HA__ Medley	•		•	•	•
4ME__ Mellow	•		•	•	•
ZMA__ Metaphor - Maharam A	•	2	2	2	•
8I1__ Muse - Maharam A		2	2	•	•
3SL__ Sequel			2		•
4TE__ Terra	•		•	•	•
3TW__ Twine	•		•	21	
8R__ Twist (5S__)	•		•	•	18
Price Category 3					
47__ Ground Cloth®	•		•	•	
ZM2__ Meld - Maharam A	•	2	•	•	•
8W__ Strands	•		•	•	
Price Category 4					
No fabrics available at this time.					
Price Category 5					
14A__ Hopsak	•		•	•	•
40G__ Method - Maharam A	•	2	2	2	•
ZNC__ Nico - Maharam A	•	2	2	•	•
Price Category 6-9					
No fabrics available at this time.					
Price Category A					
No fabrics available at this time.					
Price Category B					
VM__ Medium - Maharam A	•	2			•
TI__ Messenger - Maharam * A	•	2	•	19	•

continued on next page

Textiles Application Chart — Healthcare Workspaces

continued

GSA

- Available

A Assigned lead-time textile.

See below for exception notes.

	Commend™ Tackable Fabric Back Panels	Ethospace® B-Style Storage	Ethospace E-Style Storage	Ethospace Tiles/Connectors	Seating
Price Category C					
Z27__ Manner - Maharam A	•	2	2	•	•
Z3__ Metric - Maharam A	•				•
Price Category D					
ZMD__ Mode - Maharam A					•
ZS3__ Spiral - Maharam A	•	•	•	•	
Price Category E					
TT__ Parallel - Maharam A	•	•		•	
Price Category F					
8EX__ Emit - Maharam A	•	2	2	•	
Price Category G-Z					
No fabrics available at this time.					

* Available in select colors on 20-day lead-time. Refer to “Textile Colors - Healthcare Workspaces” for 20-day colors.

- 1 Refer to price book appendices and Omni for COM information.
- 2 Available on all products except 54” and 60” wide.
- 18 Available on seating products in select colors.
- 19 Not available on Ethospace tackable tiles.
- 21 Not available on Ethospace connectors and cable management tiles.

Application Note: Herman Miller cannot guarantee material/pattern alignment in adjacent products. For example, a fabric’s pattern may not align from one screen to the next, or from one panel to the next.

Textile Colors — Healthcare Workspaces

GSA

Price Category 1

Customer's Own Material
See Order Information in
Appendices.
Assigned lead-time textile. [A](#)

Chain
66" wide
100% recycled polyester

2V01	Pearl
2V02	Oyster
2V03	Wheat
2V04	Linen
2V05	Wicker
2V06	Bamboo
2V07	Sage
2V08	Spring Wood
2V09	Iceberg

Crossing
54" wide
86% antimony-free polyester
14% polyester

8T03	Wicker
8T04	Porcelain
8T05	Warm Grey
8T10	Tomato
8T17	Cerulean
8T18	Indigo
8T19	Shale
8T22	Tin
8T23	Graphite
8T24	Black

Crossing
For workspaces products only.
54" wide
86% antimony-free polyester
14% polyester

8501	Ivory
8502	Oyster

Dex
54" wide
50% recycled polyester
50% polyester

3DE01	Frost
3DE02	Silver Pine
3DE03	Stone
3DE04	Shale
3DE05	Charcoal

Grasscloth
66" wide
100% recycled polyester

2I01	Silver Birch
2I02	Pampas
2I03	Sedge
2I07	Lea
2I08	Taro
2I09	Steam Grey
2I13	Gravel

Monologue
54" wide
56% recycled polyester
44% polyester

1MN01	Linen
1MN02	Alabaster
1MN04	Folkstone
1MN05	Silver Pine
1MN06	Slate
1MN07	Seed
1MN09	Persimmon
1MN11	Meadow
1MN12	Blue Sky
1MN13	Blue Spruce
1MN14	Deep Sea

Resonance
66" wide
100% polyester

5T04	Greige
5T05	Porcelain
5T06	Alabaster
5T15	Iris
5T28	Sugar
5T47	Tobacco
5T54	Saltbush
5T57	Seed
5T58	Sepia
5T60	Iceberg
5T65	Red
5T68	Pistachio
5T71	Jade
5T72	Blue Green
5T74	Twilight

Slant
66" wide
51% polyester
49% recycled polyester

22F04	Pesto
22F06	Neptune
22F07	Blueberry
22F10	Pumpkin
22F12	Silver Birch
22F13	Bluestone
22F15	Shale

Tailored
54" wide
56% polyester
44% recycled polyester

23501	Studio White
23502	Sugar
23503	Tomato
23506	Chive
23508	Cobalt
23509	Cadet
23510	Fog
23511	Graphite
23512	Black
23513	Coffee

Whisper
54" wide
73% recycled polyester
27% polyester
with 11.3% ocean bound plastic

1WS01	Sand Dollar
1WS02	Pebble
1WS03	Silver Birch
1WS04	Iceberg
1WS05	Silver Pine
1WS06	Carbon
1WS07	Cumin
1WS12	Willow
1WS13	Sea Grass
1WS14	Pool
1WS15	Blueberry
1WS16	Glacier
1WS17	Grey
1WS18	Canyon

Appendix: Textile Colors — Healthcare Workspaces

- Maharam textiles are on assigned lead times [A](#).
- Fabric numbers are listed as Herman Miller fabric number/Maharam fabric number.

Textile Colors — Healthcare Workspaces

continued

GSA

Price Category 2

Aristo	
54" wide	
88% recycled polyester	
12% polyester	
Acrylic backing	
3AR01	Forest Moss
3AR02	Light Brindle
3AR03	Mink
3AR04	Copper
3AR06	Cherry
3AR08	Green Apple
3AR10	Waterfall
3AR11	Cadet
3AR12	Tin
3AR13	Pewter
3AR14	Grey Brindle
3AR15	Grey Black

Cord	
66" wide	
51% antimony-free polyester	
49% polyester	
5101	Ivory
5102	White Ash
5103	Linen
5104	Bamboo
5105	Sepia
5107	Sesame
5109	Bayou
5111	Spring Wood
5112	Summer White

Crepe	
54" wide	
100% recycled polyester,	
with 43.6% ocean bound plastic	
9201	Licorice
9203	Smoke
9207	Cherry
9223	Cadet
9241	Beachglass
9249	Stone
9251	Fog
9252	Slate Grey
9261	Shale
9262	Graphite
9265	Mineral
9266	Persimmon
9267	Juniper
9268	Glacier
9269	Cascade
9270	Navy

Epic	
54" wide	
56% recycled polyester	
44% polyester	
Acrylic backing	
3EP01	Alabaster
3EP02	Smoke
3EP03	Falcon
3EP05	Copper
3EP06	Urban Orange
3EP07	Poppy
3EP10	Clover
3EP11	Loden
3EP14	Peacock
3EP15	Cadet
3EP16	Indigo
3EP17	Spring Wood
3EP18	Grey Brindle
3EP19	Seed
3EP20	Carbon Dark

Horizon	
54" wide	
65% antimony-free polyester	
35% polyester	
4N01	Rye Grass
4N02	Sugar Pine
4N03	Silver Pine
4N04	White Ash
4N05	Spring Wood
4N08	Haystack
4N09	Oat Grass
4N13	Pine Cone
4N15	Elderberry

Medley	
54" wide	
50% recycled polyester	
50% polyester	
1HA01	Stone
1HA02	Trail
1HA03	Charcoal
1HA04	Cinder
1HA06	Papaya
1HA07	Chutney
1HA09	Feather Grey
1HA11	Loden
1HA13	Bayou
1HA14	Blue Grotto
1HA15	Blueberry
1HA22	Khaki
1HA23	Pewter
1HA24	Yellow Oxide
1HA25	Vintage Rose
1HA26	Raspberry
1HA27	Acai Berry

Mellow	
54" wide	
100% recycled polyester,	
with 16% ocean bound plastic	
4ME01	Mineral
4ME04	Olive
4ME05	Glacier
4ME06	Oceanside
4ME07	Charcoal

Metaphor — Maharam	
54" wide	
100% polyester	
Acrylic backing	
ZMA01/466553-001	Afterfeather
ZMA02/466553-002	Moonflower
ZMA03/466553-003	Handcraft
ZMA04/466553-004	Crossroad
ZMA05/466553-005	Chondrite
ZMA06/466553-006	Detective
ZMA07/466553-007	Steamship
ZMA08/466553-008	Electricity
ZMA09/466553-009	Takeoff
ZMA10/466553-010	Parachute
ZMA11/466553-011	Blueshift
ZMA12/466553-012	Dockyard
ZMA13/466553-013	Bathe
ZMA14/466553-014	Icebound
ZMA15/466553-015	Thermosphere
ZMA16/466553-016	Aboard
ZMA17/466553-017	Agateway
ZMA18/466553-018	Homeland
ZMA19/466553-019	Rockfall
ZMA20/466553-020	Undergrowth
ZMA21/466553-021	Gremolata
ZMA22/466553-022	Patina
ZMA23/466553-023	Sylvan
ZMA24/466553-024	Outfield
ZMA25/466553-025	Windbreak
ZMA26/466553-026	Saguaro
ZMA27/466553-027	Barnwood
ZMA28/466553-028	Cookshop
ZMA29/466553-029	Amandine
ZMA30/466553-030	Bodhran
ZMA31/466553-031	Centerstage
ZMA32/466553-032	Focaccia
ZMA33/466553-033	Bumblebee
ZMA34/466553-034	Microbrew
ZMA35/466553-035	Sauna
ZMA36/466553-036	Gazebo
ZMA37/466553-037	Pirouette
ZMA38/466553-038	Heartbeat
ZMA39/466553-039	Shino
ZMA40/466553-040	Sunrise
ZMA41/466553-041	Florist

- Maharam textiles are on assigned lead times [A](#).
- Fabric numbers are listed as Herman Miller fabric number/Maharam fabric number.

Price Category 2 continued
on next page

Textile Colors — Healthcare Workspaces

continued

GSA

Price Category 2

continued

Metaphor continued

ZMA42/466553-042	Beadwork
ZMA43/466553-043	Framboise
ZMA44/466553-044	Wisteria
ZMA45/466553-045	Warrior

Muse – Maharam

54" wide	
100% post-consumer recycled polyester	
8I101/466487-001	Crescendo
8I102/466487-002	Resonate
8I103/466487-003	Runway
8I104/466487-004	Ascend
8I105/466487-005	Veil
8I106/466487-006	Refresh
8I107/466487-007	Clear
8I108/466487-008	Fantasy
8I109/466487-009	Miso
8I110/466487-010	Compass
8I111/466487-011	Bergamot
8I112/466487-012	Grasshopper
8I113/466487-013	Goal
8I114/466487-014	Mistletoe
8I115/466487-015	Seaglass
8I116/466487-016	Frigid
8I117/466487-017	Riverbend
8I118/466487-018	Noble
8I119/466487-019	Pulsar
8I120/466487-020	Velella
8I121/466487-021	Sailboat
8I122/466487-022	Sparse
8I123/466487-023	Vase
8I124/466487-024	Haven
8I125/466487-025	Mead
8I126/466487-026	Neat
8I127/466487-027	Jovial
8I128/466487-028	Theater
8I129/466487-029	Poinsettia
8I130/466487-030	Celebrate
8I131/466487-031	Spectacle

Sequel

54" wide	
100% vinyl	
100% polyester knit backing	
Resilience® finish	
3SL01	White
3SL02	Pebble
3SL03	Mushroom
3SL04	Stone
3SL05	Chestnut
3SL07	Black Cherry
3SL08	Tundra
3SL09	Seal
3SL10	Blue Fog
3SL11	Folkstone
3SL12	Shale
3SL13	Slate Grey
3SL14	Charcoal
3SL15	Carbon Dark

Terra

54" wide	
100% post-consumer recycled biodegradable polyester *	
4TE01	Spring Wood
4TE02	Zinc
4TE03	Pine Cone
4TE04	Charcoal

* 1% biodegradation in 1,278 days under ASTM D5511 conditions. No evidence of further degradation.

Twine

66" wide	
100% recycled polyester	
3TW01	Silver Birch
3TW02	Ivory
3TW03	Alabaster
3TW04	Bamboo
3TW05	Iceberg
3TW06	Charcoal
3TW07	Feather Grey
3TW08	Shale

Twist

54" wide	
80% antimony-free polyester	
13% recycled polyester	
7% polyester	
8R05	Wicker
8R10	Poppy
8R14	Tin
8R15	Shale
8R16	Graphite
8R17	Birch
8R18	Sepia
8R22	Blueberry
8R23	Green Apple
8R26	Gunmetal
8R27	Cinder
8R29	Pekoe
8R33	Forest
8R35	Waterfall
8R36	Midnight Blue
8R37	Carbon Dark

Twist

For workspaces products only.	
54" wide	
80% antimony-free polyester	
13% recycled polyester	
7% polyester	
5S03	Oyster

Price Category 3

Ground Cloth®

66" wide	
100% polyester	
4701	Vapor Grey
4721	Warm White
4722	Fog
4723	Straw
4724	Red Orange
4726	Green Apple
4727	Caribbean
4728	Midnight
4729	Cappuccino

Meld – Maharam

54" wide	
68% post-consumer recycled polyester	
32% polyester	
PFOA-Free stain resistant	
ZM201/466387-201	Vast
ZM202/466387-202	Panda *
ZM203/466387-203	Skyline *
ZM204/466387-204	Knight *
ZM205/466387-205	Quill **
ZM206/466387-206	Pipe
ZM207/466387-207	Grate *
ZM208/466387-208	Gloss
ZM209/466387-209	Bulb
ZM210/466387-210	Bride
ZM211/466387-211	Stark
ZM212/466387-212	Seashell
ZM213/466387-213	Antler
ZM214/466387-214	Crater *
ZM215/466387-215	Perennial
ZM216/466387-216	Mulberry
ZM217/466387-217	Fuchsia *
ZM218/466387-218	Amethyst *
ZM219/466387-219	Merlot
ZM220/466387-220	Magma *
ZM221/466387-221	Rooster
ZM222/466387-222	Heat *
ZM223/466387-223	Clementine
ZM224/466387-224	Fox
ZM225/466387-225	Kiss *
ZM226/466387-226	Bare

Price Category 3 continued on next page

- Maharam textiles are on assigned lead times [A](#).
- Fabric numbers are listed as Herman Miller fabric number/Maharam fabric number.

Textile Colors — Healthcare Workspaces

continued
GSA

Price Category 3

continued

Price Category 4

Price Category 5

Appendix: Textile Colors — Healthcare Workspaces

Meld continued	
ZM227/466387-227	Blonde
ZM228/466387-228	Mimosa
ZM229/466387-229	Comet *
ZM230/466387-230	Honeydew
ZM231/466387-231	Wild *
ZM232/466387-232	Vine
ZM233/466387-233	Seed
ZM234/466387-234	Kale *
ZM235/466387-235	Waterfall *
ZM236/466387-236	Nordic *
ZM237/466387-237	Reef *
ZM238/466387-238	Wave
ZM239/466387-239	Isle **
ZM240/466387-240	Creek
ZM241/466387-241	Mariner *
ZM242/466387-242	Globe
ZM243/466387-243	Spa

* Colors available on
20-day lead time.
** Colors available on
10-day lead time.

Strands	
66" wide	
100% recycled polyester	
8W01	Pebble
8W02	Porcelain
8W03	Taupe
8W04	Honey
8W05	Khaki
8W06	Rye
8W07	Wicker
8W08	Tin
8W09	Cool Grey

No fabrics available at this time.

Hopsak	
56" wide	
100% recycled polyester	
14A20	Black
14A22	Raw Umber Dark
14A26	Grey Blue Dark
14A30	Sepia Dark
14A38	Emerald Dark
14A39	Yellow Dark
14A40	Orange
14A41	Sienna
14A42	Olive Green Dark
14A43	Crimson
14A44	Crimson Dark Dark
14A45	Violet Dark
14A46	Pink Dark Dark
14A47	Ultramarine Dark
14A48	Cobalt Blue
14A49	Terra Cotta
14A50	Ochre Dark

Method – Maharam	
54" wide	
100% recycled polyester with 12% ocean-bound plastic	
40G01/466579-001	Inspire
40G02/466579-002	Rhea
40G03/466579-003	Noise
40G04/466579-004	Speedway
40G05/466579-005	Villanelle
40G06/466579-006	Maestro
40G07/466579-007	Destiny
40G08/466579-008	Possess
40G09/466579-009	Waterside
40G10/466579-010	Relax
40G11/466579-011	Delightful
40G12/466579-012	Parrotlet
40G13/466579-013	Verdurous
40G14/466579-014	Bosky
40G15/466579-015	Acreage
40G16/466579-016	Allude
40G17/466579-017	Tweed
40G18/466579-018	Korma
40G19/466579-019	Fossilize
40G20/466579-020	Cattail
40G21/466579-021	Shortcake

Method continued	
40G22/466579-022	Racecar
40G23/466579-023	Courtship
40G24/466579-024	Jam
40G25/466579-025	Sparrow

Nico - Maharam	
54" wide	
63% wool	
21% polyester	
16% solution-dyed nylon	
ZNC01/466564-001	Alcazar
ZNC02/466564-002	Ironclad
ZNC03/466564-003	Tune
ZNC04/466564-004	Bridegroom
ZNC05/466564-005	Diode
ZNC06/466564-006	Jest
ZNC07/466564-007	Sanctuary
ZNC08/466564-008	Aquarius
ZNC09/466564-009	Houseboat
ZNC10/466564-010	Olympian
ZNC11/466564-011	Tennis
ZNC12/466564-012	Dressage
ZNC13/466564-013	Zing
ZNC14/466564-014	Bitterroot
ZNC15/466564-015	Gemini
ZNC16/466564-016	Posh
ZNC17/466564-017	Sizzle
ZNC18/466564-018	Cheerful
ZNC19/466564-019	Watermelon
ZNC20/466564-020	Toucan
ZNC21/466564-021	Rosin
ZNC22/466564-022	Jousting
ZNC23/466564-023	Jojoba
ZNC24/466564-024	Dromedary
ZNC25/466564-025	Toasty
ZNC26/466564-026	Casaba
ZNC27/466564-027	Greenhouse
ZNC28/466564-028	Sibyl
ZNC29/466564-029	Spearmint
ZNC30/466564-030	Pothos
ZNC31/466564-031	Calathea
ZNC32/466564-032	Landscape
ZNC33/466564-033	Espalier
ZNC34/466564-034	Gecko
ZNC35/466564-035	Meditation

- Maharam textiles are on assigned lead times [A](#).
- Fabric numbers are listed as Herman Miller fabric number/Maharam fabric number.

Textile Colors — Healthcare Workspaces

continued

GSA

Price Category 6-9	Price Category A	Price Category B																																																																												
No fabrics available at this time.	No fabrics available at this time.	<table><tr><th>Medium – Maharam</th><th>Messenger continued</th></tr><tr><td>54” wide</td><td>TI46/458640-046 Ice *</td></tr><tr><td>100% polyester</td><td>TI48/458640-048 Neon</td></tr><tr><td>VM01/463490-001 Raven</td><td>TI50/458640-050 Hydrangea</td></tr><tr><td>VM02/463490-002 Smoke</td><td>TI53/458640-053 Tangelo</td></tr><tr><td>VM03/463490-003 Alloy</td><td>TI54/458640-054 Lumine *</td></tr><tr><td>VM04/463490-004 Flax</td><td>TI58/458640-058 Snow</td></tr><tr><td>VM07/463490-007 Espresso</td><td>TI60/458640-060 Peridot</td></tr><tr><td>VM14/463490-014 Laser</td><td>TI61/458640-061 Capri *</td></tr><tr><td>VM16/463490-016 Port</td><td>TI62/458640-062 Ultramarine</td></tr><tr><td>VM22/463490-022 Marina</td><td>TI63/458640-063 Squall</td></tr><tr><td>VM29/463490-029 Pistachio</td><td>TI66/458640-066 Cassis</td></tr><tr><td>VM32/463490-032 Prospect</td><td>TI67/458640-067 Aster</td></tr><tr><td>VM36/463490-036 Delight</td><td>TI69/458640-069 Cherry</td></tr><tr><td>VM39/463490-039 Nautical</td><td>TI70/458640-070 Vibrant</td></tr><tr><td>VM40/463490-040 Pool</td><td>TI71/458640-071 Satsuma *</td></tr><tr><td>VM44/463490-044 Washed</td><td>TI72/458640-072 Maize</td></tr><tr><td>VM45/463490-045 Sculpture</td><td>TI76/458640-076 Fossil</td></tr><tr><td>VM46/463490-046 Thatched</td><td>TI77/458640-077 Ash</td></tr><tr><td>VM47/463490-047 Hike</td><td>TI78/458640-078 Tusk</td></tr><tr><td>VM48/463490-048 Tangle</td><td>TI79/458640-079 Oyster</td></tr><tr><td>VM49/463490-049 Pacific</td><td>TI81/458640-081 Husk</td></tr><tr><td>VM50/463490-050 Cosmic</td><td>TI84/458640-084 Robust</td></tr><tr><td>VM53/463490-053 Nasturtium</td><td>TI85/458640-085 Beyond</td></tr><tr><th>Messenger – Maharam</th><td>TI86/458640-086 Voyage *</td></tr><tr><td>54” wide</td><td>TI87/458640-087 Everglade</td></tr><tr><td>78% recycled polyester</td><td>TI89/458640-089 Blanch</td></tr><tr><td>15% polyester, 7% nylon</td><td>TI90/458640-090 Longspur</td></tr><tr><td>TI07/458640-007 Shadow</td><td>TI91/458640-091 Vireo</td></tr><tr><td>TI08/458640-008 Bayou *</td><td>TI92/458640-092 Dipper</td></tr><tr><td>TI24/458640-024 Poppy</td><td>TI93/458640-093 Gale</td></tr><tr><td>TI25/458640-025 Mao</td><td>TI94/458640-094 Hunter</td></tr><tr><td>TI29/458640-029 Onyx *</td><td>TI95/458640-095 Lime</td></tr><tr><td>TI31/458640-031 Cloud *</td><td>TI96/458640-096 Apple</td></tr><tr><td>TI38/458640-038 Depth *</td><td>TI97/458640-097 Krill</td></tr><tr><td>TI40/458640-040 Nile *</td><td>TI98/458640-098 Catalyst</td></tr><tr><td>TI41/458640-041 Azure *</td><td>* Colors available on</td></tr><tr><td>TI45/458640-045 Cactus *</td><td>20-day lead time.</td></tr></table>	Medium – Maharam	Messenger continued	54” wide	TI46/458640-046 Ice *	100% polyester	TI48/458640-048 Neon	VM01/463490-001 Raven	TI50/458640-050 Hydrangea	VM02/463490-002 Smoke	TI53/458640-053 Tangelo	VM03/463490-003 Alloy	TI54/458640-054 Lumine *	VM04/463490-004 Flax	TI58/458640-058 Snow	VM07/463490-007 Espresso	TI60/458640-060 Peridot	VM14/463490-014 Laser	TI61/458640-061 Capri *	VM16/463490-016 Port	TI62/458640-062 Ultramarine	VM22/463490-022 Marina	TI63/458640-063 Squall	VM29/463490-029 Pistachio	TI66/458640-066 Cassis	VM32/463490-032 Prospect	TI67/458640-067 Aster	VM36/463490-036 Delight	TI69/458640-069 Cherry	VM39/463490-039 Nautical	TI70/458640-070 Vibrant	VM40/463490-040 Pool	TI71/458640-071 Satsuma *	VM44/463490-044 Washed	TI72/458640-072 Maize	VM45/463490-045 Sculpture	TI76/458640-076 Fossil	VM46/463490-046 Thatched	TI77/458640-077 Ash	VM47/463490-047 Hike	TI78/458640-078 Tusk	VM48/463490-048 Tangle	TI79/458640-079 Oyster	VM49/463490-049 Pacific	TI81/458640-081 Husk	VM50/463490-050 Cosmic	TI84/458640-084 Robust	VM53/463490-053 Nasturtium	TI85/458640-085 Beyond	Messenger – Maharam	TI86/458640-086 Voyage *	54” wide	TI87/458640-087 Everglade	78% recycled polyester	TI89/458640-089 Blanch	15% polyester, 7% nylon	TI90/458640-090 Longspur	TI07/458640-007 Shadow	TI91/458640-091 Vireo	TI08/458640-008 Bayou *	TI92/458640-092 Dipper	TI24/458640-024 Poppy	TI93/458640-093 Gale	TI25/458640-025 Mao	TI94/458640-094 Hunter	TI29/458640-029 Onyx *	TI95/458640-095 Lime	TI31/458640-031 Cloud *	TI96/458640-096 Apple	TI38/458640-038 Depth *	TI97/458640-097 Krill	TI40/458640-040 Nile *	TI98/458640-098 Catalyst	TI41/458640-041 Azure *	* Colors available on	TI45/458640-045 Cactus *	20-day lead time.
Medium – Maharam	Messenger continued																																																																													
54” wide	TI46/458640-046 Ice *																																																																													
100% polyester	TI48/458640-048 Neon																																																																													
VM01/463490-001 Raven	TI50/458640-050 Hydrangea																																																																													
VM02/463490-002 Smoke	TI53/458640-053 Tangelo																																																																													
VM03/463490-003 Alloy	TI54/458640-054 Lumine *																																																																													
VM04/463490-004 Flax	TI58/458640-058 Snow																																																																													
VM07/463490-007 Espresso	TI60/458640-060 Peridot																																																																													
VM14/463490-014 Laser	TI61/458640-061 Capri *																																																																													
VM16/463490-016 Port	TI62/458640-062 Ultramarine																																																																													
VM22/463490-022 Marina	TI63/458640-063 Squall																																																																													
VM29/463490-029 Pistachio	TI66/458640-066 Cassis																																																																													
VM32/463490-032 Prospect	TI67/458640-067 Aster																																																																													
VM36/463490-036 Delight	TI69/458640-069 Cherry																																																																													
VM39/463490-039 Nautical	TI70/458640-070 Vibrant																																																																													
VM40/463490-040 Pool	TI71/458640-071 Satsuma *																																																																													
VM44/463490-044 Washed	TI72/458640-072 Maize																																																																													
VM45/463490-045 Sculpture	TI76/458640-076 Fossil																																																																													
VM46/463490-046 Thatched	TI77/458640-077 Ash																																																																													
VM47/463490-047 Hike	TI78/458640-078 Tusk																																																																													
VM48/463490-048 Tangle	TI79/458640-079 Oyster																																																																													
VM49/463490-049 Pacific	TI81/458640-081 Husk																																																																													
VM50/463490-050 Cosmic	TI84/458640-084 Robust																																																																													
VM53/463490-053 Nasturtium	TI85/458640-085 Beyond																																																																													
Messenger – Maharam	TI86/458640-086 Voyage *																																																																													
54” wide	TI87/458640-087 Everglade																																																																													
78% recycled polyester	TI89/458640-089 Blanch																																																																													
15% polyester, 7% nylon	TI90/458640-090 Longspur																																																																													
TI07/458640-007 Shadow	TI91/458640-091 Vireo																																																																													
TI08/458640-008 Bayou *	TI92/458640-092 Dipper																																																																													
TI24/458640-024 Poppy	TI93/458640-093 Gale																																																																													
TI25/458640-025 Mao	TI94/458640-094 Hunter																																																																													
TI29/458640-029 Onyx *	TI95/458640-095 Lime																																																																													
TI31/458640-031 Cloud *	TI96/458640-096 Apple																																																																													
TI38/458640-038 Depth *	TI97/458640-097 Krill																																																																													
TI40/458640-040 Nile *	TI98/458640-098 Catalyst																																																																													
TI41/458640-041 Azure *	* Colors available on																																																																													
TI45/458640-045 Cactus *	20-day lead time.																																																																													

* Colors available on
20-day lead time.

- Maharam textiles are on assigned lead times [\[A\]](#).
- Fabric numbers are listed as Herman Miller fabric number/Maharam fabric number.

Textile Colors — Healthcare Workspaces

continued
GSA

Price Category C

Manner - Maharam
54" wide
100% recycled polyester
Z2701/466177-001 Magic
Z2702/466177-002 Carob
Z2703/466177-003 Porpoise
Z2704/466177-004 Flint
Z2705/466177-005 Hush
Z2706/466177-006 Nuance
Z2711/466177-011 Ember
Z2712/466177-012 Wagon
Z2713/466177-013 Ablaze
Z2714/466177-014 Peel
Z2716/466177-016 Butterscotch
Z2717/466177-017 Harvest
Z2720/466177-020 Parakeet
Z2722/466177-022 Aquatic
Z2723/466177-023 Cottage
Z2724/466177-024 Dahlia
Z2725/466177-025 Vivid
Z2726/466177-026 Basin
Z2727/466177-027 Schooner
Z2729/466177-029 Silverpoint
Z2730/466177-030 Lattice
Z2731/466177-031 Smoky
Z2732/466177-032 Magnetic
Z2733/466177-033 Woad
Z2734/466177-034 Resolute
Z2735/466177-035 Cruise
Z2736/466177-036 Atmospheric
Z2737/466177-037 Cloudburst
Z2738/466177-038 Tidewater
Z2739/466177-039 Firth
Z2740/466177-040 Oceanside
Z2741/466177-041 Grandeur
Z2742/466177-042 Comfort
Z2743/466177-043 Dill
Z2744/466177-044 Poplar
Z2745/466177-045 Citronella
Z2746/466177-046 Passerine
Z2747/466177-047 Southwest
Z2748/466177-048 Roseate

Manner continued
Z2749/466177-049 Charisma
Z2750/466177-050 Siltstone
Z2751/466177-051 Kimono
Z2752/466177-052 Valiant
Z2753/466177-053 Baroness
Metric – Maharam
54" wide
51% recycled polyester
49% polyester
Z302/466014-002 Fog
Z303/466014-003 Fleece
Z312/466014-012 Cardinal
Z313/466014-013 Lava
Z318/466014-018 Pollen
Z320/466014-020 Alligator
Z323/466014-023 Tar
Z324/466014-024 Anchor
Z326/466014-026 Admiral
Z327/466014-027 Seaport
Z328/466014-028 Scuba
Z329/466014-029 Skate
Z330/466014-030 Hopscotch
Z331/466014-031 Film
Z332/466014-032 Whale
Z333/466014-033 Downpour
Z334/466014-034 Midday
Z335/466014-035 Talisman
Z336/466014-036 Hedgerow
Z337/466014-037 Snorkel
Z338/466014-038 Highway
Z339/466014-039 Canary
Z340/466014-040 Sunny
Z341/466014-041 Aztec
Z342/466014-042 Fruit
Z343/466014-043 Galah
Z344/466014-044 Kiln
Z345/466014-045 Moth

Price Category D

Mode – Maharam
54" wide
80% post-consumer recycled polyester
20% polyester
PFOA-Free stain resistant finish
ZMD01/466337-001 Stroll
ZMD02/466337-002 Intaglio
ZMD03/466337-003 Ominous
ZMD04/466337-004 Machine
ZMD05/466337-005 Talus
ZMD06/466337-006 Marsh
ZMD07/466337-007 Hollow
ZMD08/466337-008 Sycamore
ZMD09/466337-009 Clavicle
ZMD10/466337-010 Billygoat
ZMD11/466337-011 Spindle
ZMD12/466337-012 Lemon
ZMD13/466337-013 Oxeye
ZMD14/466337-014 Henge
ZMD15/466337-015 Goldenrod
ZMD16/466337-016 Cottontail
ZMD17/466337-017 Lioness
ZMD18/466337-018 Oriole
ZMD19/466337-019 Rust
ZMD20/466337-020 Carotene
ZMD21/466337-021 Blush
ZMD22/466337-022 Vermilion
ZMD23/466337-023 Alder
ZMD24/466337-024 Kermes
ZMD25/466337-025 Barberry
ZMD26/466337-026 Petal
ZMD27/466337-027 Valley

Mode continued
ZMD28/466337-028 Odyssey
ZMD29/466337-029 Ballpoint
ZMD30/466337-030 Toile
ZMD31/466337-031 Paradise
ZMD32/466337-032 Angelfish
ZMD33/466337-033 Denim
ZMD34/466337-034 Crush
ZMD35/466337-035 Jetty
ZMD36/466337-036 Saltwater
ZMD37/466337-037 Mallard
ZMD38/466337-038 Celtic
ZMD39/466337-039 Eucalyptus
ZMD40/466337-040 Bonsai
ZMD41/466337-041 Sassafras
ZMD42/466337-042 Yucca
ZMD43/466337-043 Lichen

Spiral - Maharam
66" wide
100% polyester
ZS301/901882-001 Chalk
ZS302/901882-002 Birch
ZS303/901882-003 Wheat
ZS304/901882-004 Mica
ZS305/901882-005 Pavement
ZS306/901882-006 Graphite

- Maharam textiles are on assigned lead times [\[A\]](#).
- Fabric numbers are listed as Herman Miller fabric number/Maharam fabric number.

Textile Colors — Healthcare Workspaces

continued

GSA

Price Category E	Price Category F	Price Category G-Z
Parallel — Maharam 66" wide 100% recycled polyester TT01/901180-001 Chalk TT03/901180-003 Fog TT22/901180-022 Sterling TT23/901180-023 Linen TT24/901180-024 Pea TT27/901180-027 Boulder TT28/901180-028 Stream TT29/901180-029 Shiitake TT30/901180-030 Wafer TT31/901180-031 Plank TT32/901180-032 Brandy TT33/901180-033 Crater TT36/901180-036 Quail	Emit — Maharam 54" wide 55% post-industrial recycled polyester 45% post-consumer recycled polyester PFOA-free stain resistant 8EX01/466378-001 Wed 8EX02/466378-002 Zebra 8EX03/466378-003 Chiffon 8EX05/466378-005 Nectar 8EX06/466378-006 Elk 8EX08/466378-008 Goldenrod 8EX09/466378-009 Beached 8EX10/466378-010 Samba 8EX11/466378-011 Nest 8EX14/466378-014 Groove 8EX17/466378-017 Haiku 8EX18/466378-018 Bluefin 8EX19/466378-019 Flow 8EX20/466378-020 Xenon 8EX21/466378-021 Artem 8EX25/466378-025 Limeade	No fabrics available at this time.

- Maharam textiles are on assigned lead times [A](#).
- Fabric numbers are listed as Herman Miller fabric number/Maharam fabric number.

For more information about our products and services or to see a list of dealers, please visit us at HermanMiller.com or call (800) 851 1196.

© 2025 Herman Miller, Inc., Zeeland, Michigan

Distribution Rights

Working together since 1956, Herman Miller and Vitra are the authentic sources of designs by Charles and Ray Eames, Alexander Girard, and George Nelson. All the designs shown in this book are protected by law. Herman Miller has obtained all rights to make and sell these designs. Also, Herman Miller holds exclusive worldwide manufacturing and distribution rights for these products with the following exceptions:

Charles and Ray Eames, George Nelson, and Alexander Girard—Worldwide distribution rights for furniture in all areas except Europe and the Middle East. For those areas, please contact Vitra.

Isamu Noguchi—Worldwide distribution rights for the Noguchi Rudder Table. Distribution rights for the Noguchi Table in North America and Central America only. For all other areas, please contact Vitra.

Magis—Exclusive distribution rights in the US and Canada. For all other areas, please contact Magis.

® HermanMiller, ●, Action Office, Aeron, Aside, Canvas Office Landscape, Caper, Cosm, Co/Struc, Eames, Embody, Ethospace, Exclave, Fine-Tune, FlexFront, Formcoat, Ground Cloth, Intent, Layout Studio, Lino, Maharam, Meridian, Mirra, Motia, Nelson, Pellicle, Perspectives, Plex, PostureFit, PostureFit SL, Sayl, Setu, Tu, Verus, Y-Tower and Zeph are among the registered trademarks of Herman Miller, Inc., and its owned subsidiaries.

™ AireWeave, Bubbletack, Canvas Vista, Cellular Suspension, Commend, Compass, Connect, DOT, Durawrap, Everywhere, Flex-Edge, Headway, Hopsak 2, Iota, Keyless Entry, Latitude, Lyris 2, Mora, Multiscrim, Nevi, OE1, OE1 Workspace Collection, Overlay, Renew, Stackable, Swoop, Thrive, TriFlex, Twist and Valor are among the trademarks of Herman Miller, Inc., and its owned subsidiaries.

Chemsurf® is a registered trademark of Wilsonart International.

Corian® is a registered trademark of E.I. du Pont de Nemours and Company Corporation.

FLEXNET™ is a trademark of Milliken & Company.

Floor Saver Glide® is a registered trademark of Carpin Manufacturing, Inc.

Forest Stewardship Council® is a registered trademark of the Forest Stewardship Council A.C. (FSC). We are FSC® certified (FSC® C102895).

FSC® is a registered trademark of the Forest Stewardship Council A.C. (FSC).

MicrobeCare™ is a trademark of Parasol Medical LLC.

Microsoft® and Natural® Keyboard are registered trademarks of Microsoft Corporation.

Place Textiles® is a registered trademark of Place Textiles.