



Prices effective February 3, 2025

Published February 2025

Nemschoff® Pamona™ Seating

Introduction	page 2
Nemschoff® Pamona™ Seating	3
Chair, 31.25" Wide	5
Settee, 54" Wide	7
Sofa, 72" Wide	9
Flop® Sofa, 80.25" Wide	11
Indices	13
By Name	13
By Number	15
Appendices	
20-Day or Less/Assigned Lead-Time Order Information	
Multiple Fabrics Guide	

Introduction

A Note on the Organization of This Book

There are a few signals that will help you understand the organization of this book. Once you know them, you should be able to find your way around easily.

Like a newspaper, this book is formatted with columns of text and illustrations that run vertically.

Information wraps from one column to the next and continues for as many pages as it needs to.

Black bars are clues.

A black bar at the top of a page signals the start of information about a product.

This information is divided into two sections, each signaled by a black bar. Product Information includes a description, additional notes, and dimensional drawings. Specification Information, which always begins at the top of a column, includes a series of steps. Each step represents a decision you need to make in order to complete your product number. Steps must be followed sequentially. The number of pages needed to complete information on a product varies; some will be complete in one page; others may fill three or four pages. Just continue going through the steps until you run into the next product, signaled by the black bar at the top of the page.

Black tabs running along the outside edge of the page help you locate what section you are in or what section you want to go to. You can thumb forwards or backwards to find a section; tabs and text appear on both sides of the page.

The additional pages in the back of the book include the appendices and indices. They are signaled by a long black bar running along the outside edge of the page.

The index is presented two ways.

The first index is in alphabetical order by product name. It can be helpful if you are new to the products and numbering scheme or if you are looking for a type of product, such as work chair or round table.

The second index is by product number. It lists, in alphanumeric order, the base product number, typically a five-digit number.

General Information

This book is effective February 3, 2025, subject to change without notice. Products may be purchased from authorized Herman Miller dealers who will quote prices upon request. For more information about our products and services or to see a list of dealers, visit www.HermanMiller.com.

All prices are list prices. Additional services, such as planning services, design, storage, and installation, are not included and must be added to these prices when the additional services are requested.

Illustrations, specifications, and prices are based on the latest information at the time of publication. The right is reserved to make changes at any time without notice in prices, fabrics, finishes, materials, specifications, and models, and also to discontinue models and finishes.

Dimensions shown in the drawings are engineering drawing dimensions rounded up to the nearest 1/8". Product is shipped set up or knocked down. Products that include "Shipped knocked down" in the description require some assembly. If this statement does not appear in the description, the product is shipped assembled.

Service problems are normally handled by a Herman Miller authorized dealer. Where this cannot be accomplished on a local level, service problems should be referred to the Customer Care Representative for your region, Herman Miller, Inc., Zeeland, Michigan 49464.

20-Day or Less/Assigned Lead-Time Shipments

All products and options in this price book not designated by an Assigned Program icon  will ship in **20 business days or less** after being acknowledged by Herman Miller.

Products and options designated by an  are on the assigned lead-time program and may ship in 20 days, less than 20 days, or more than 20 days from order acknowledgement.

Pamona™ Lounge Seating

SleepOver® Seating—Pamona™ Flop® Sofa



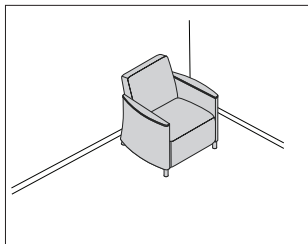

Product Information

Description

Features:

- Mortise and tenon joinery
- Spring seat construction
- Clean-out design
- Replaceable components
- Upholstered arms
- Powder-coated metal legs
- Wallsaver legs
- Non-marring 1" glides
- Indoor Advantage™ Gold Certified

Notes

Weight—51 lbs

COM yardage:

Single Fabric—5

Multiple Fabrics:

Seat—1¾

Back—2

Arms—3

Dimensions

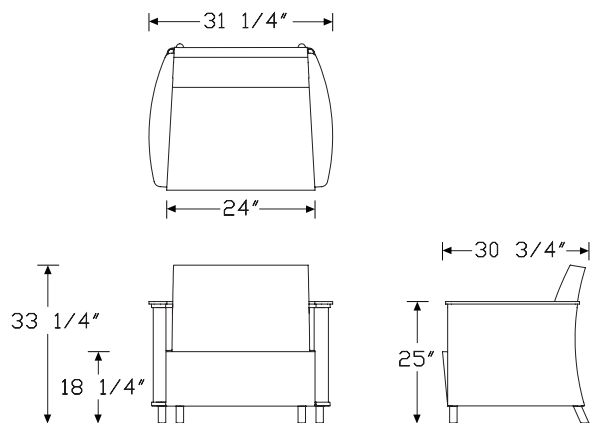

Specification Information

Step 1.

797 ☐

Step 2. Size

-1 31.25" wide ☐ +\$3030

Step 3. Covers

S standard covers ☐ +\$0

P removable covers ☐ +\$336

Step 4. Fire Retardancy

NR not fire retardant (non CTB-133) ☐ +\$0

Step 5. Fabric Configuration

1F one fabric ☐ +\$0

MF multiple fabrics ☐ +\$127

Step 6. Arm Cap Detail

K solid surface ☐ +\$0

U upholstered ☐ +\$0

R urethane ☐ +\$0

W wood ☐ +\$124

Step 7. Arm Cap Finish

For upholstered (U)

SU same as chair arm upholstery ☐ +\$0

For urethane (R)

BK black ☐ +\$124

For wood (W)

0Z medium cherry ☐ +\$0

2U light brown walnut ☐ +\$0

40 dark brown walnut ☐ +\$0

5K honey maple ☐ +\$0

ED aged cherry ☐ +\$0

IZ aged teak ☐ +\$0

UL natural maple ☐ +\$0

For solid surface (K)

58 cameo white ☐ +\$500

ANC antarctica ☐ +\$500

CQ glacier white ☐ +\$500

QB bisque ☐ +\$500

SVG silver gray ☐ +\$500

Pamona™ Chair, 31.25" Wide *continued*

Step 8. Powdercoat Base Finish		
BK	black <input type="checkbox"/>	+\$0
G1	graphite textured <input type="checkbox"/>	+\$0
MSS	metallic silver smooth <input type="checkbox"/>	+\$0
MST	metallic silver textured <input type="checkbox"/>	+\$0
XTS	titanium smooth <input type="checkbox"/>	+\$0
XTT	titanium textured <input type="checkbox"/>	+\$0

Step 9. Moisture Barrier Option		
MBN	no moisture barrier <input type="checkbox"/>	+\$0
MBB	moisture barrier back only <input type="checkbox"/>	+\$175
MBS	moisture barrier seat only <input type="checkbox"/>	+\$175
MBX	moisture barrier seat and back <input type="checkbox"/>	+\$350

Step 10. MicrobeCare Selection		
MCN	no MicrobeCare protection <input type="checkbox"/>	+\$0

Step 11.

Fabric

For not fire retardant (non CTB-133) (NR) with one fabric (1F)

Price Category (Nemschoff) Series 3	+\$0
Price Category (Nemschoff) Series 4	+\$291
Price Category (Nemschoff) Series 5	+\$595
Price Category (Nemschoff) Series 6	+\$954
Price Category (Nemschoff) Series 7	+\$1318
Price Category (Nemschoff) Series 8	+\$1774

Seat Fabric

For not fire retardant (non CTB-133) (NR) with multiple fabrics (MF)

Price Category (Nemschoff) Series 3	+\$0
Price Category (Nemschoff) Series 4	+\$105
Price Category (Nemschoff) Series 5	+\$200
Price Category (Nemschoff) Series 6	+\$312
Price Category (Nemschoff) Series 7	+\$428
Price Category (Nemschoff) Series 8	+\$572

Step 12. Back Fabric

For not fire retardant (non CTB-133) (NR) with multiple fabrics (MF)

Price Category (Nemschoff) Series 3	+\$0
Price Category (Nemschoff) Series 4	+\$130
Price Category (Nemschoff) Series 5	+\$248
Price Category (Nemschoff) Series 6	+\$389
Price Category (Nemschoff) Series 7	+\$531
Price Category (Nemschoff) Series 8	+\$707

Step 13. Arm Fabric

For not fire retardant (non CTB-133) (NR) with multiple fabrics (MF)

Price Category (Nemschoff) Series 3	+\$0
Price Category (Nemschoff) Series 4	+\$187
Price Category (Nemschoff) Series 5	+\$356
Price Category (Nemschoff) Series 6	+\$558
Price Category (Nemschoff) Series 7	+\$762
Price Category (Nemschoff) Series 8	+\$1016

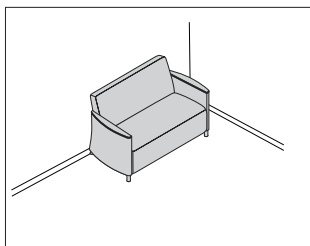

Product Information

Description

Features:

- Mortise and tenon joinery
- Spring seat construction
- Clean-out design
- Replaceable components
- Upholstered arms
- Powder-coated metal legs
- Wallsaver legs
- Non-marring 1" glides
- Indoor Advantage™ Gold Certified

Notes

Weight—62 lbs

COM yardage:

Single Fabric—6½

Multiple Fabrics:

Seat—2¼

Back—2¼

Arms—3

Dimensions

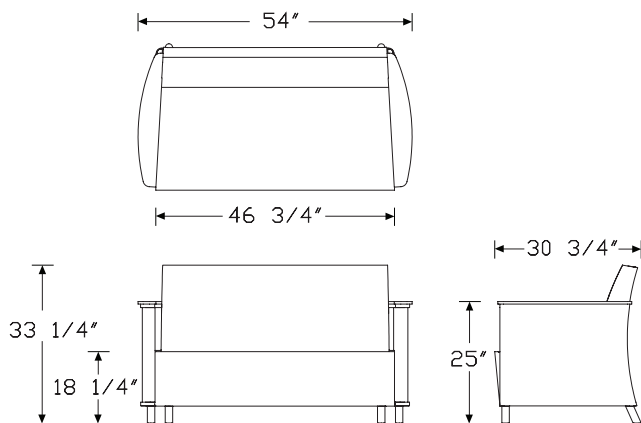

Specification Information

Step 1.

797 ☐ A

Step 2. Size

-2 54" wide ☐ A +\$4374

Step 3. Covers

S standard covers ☐ A +\$0

P removable covers ☐ A +\$483

Step 4. Fire Retardancy

NR not fire retardant (non CTB-133) ☐ A +\$0

Step 5. Fabric Configuration

1F one fabric ☐ A +\$0

MF multiple fabrics ☐ A +\$127

Step 6. Arm Cap Detail

K solid surface ☐ A +\$0

U upholstered ☐ A +\$0

R urethane ☐ A +\$0

W wood ☐ A +\$124

Step 7. Arm Cap Finish

For upholstered (U)

SU same as chair arm upholstery ☐ A +\$0

For urethane (R)

BK black ☐ A +\$124

For wood (W)

0Z medium cherry ☐ A +\$0

2U light brown walnut ☐ A +\$0

40 dark brown walnut ☐ A +\$0

5K honey maple ☐ A +\$0

ED aged cherry ☐ A +\$0

IZ aged teak ☐ A +\$0

UL natural maple ☐ A +\$0

For solid surface (K)

58 cameo white ☐ A +\$500

ANC antarctica ☐ A +\$500

CQ glacier white ☐ A +\$500

QB bisque ☐ A +\$500

SVG silver gray ☐ A +\$500

Pamona™ Settee, 54" Wide *continued*

Step 8. Powdercoat Base Finish		
BK	black <input type="checkbox"/>	+\$0
G1	graphite textured <input type="checkbox"/>	+\$0
MSS	metallic silver smooth <input type="checkbox"/>	+\$0
MST	metallic silver textured <input type="checkbox"/>	+\$0
XTS	titanium smooth <input type="checkbox"/>	+\$0
XTT	titanium textured <input type="checkbox"/>	+\$0

Step 9. Moisture Barrier Option		
MBN	no moisture barrier <input type="checkbox"/>	+\$0
MBB	moisture barrier back only <input type="checkbox"/>	+\$250
MBS	moisture barrier seat only <input type="checkbox"/>	+\$250
MBX	moisture barrier seat and back <input type="checkbox"/>	+\$400

Step 10. MicrobeCare Selection		
MCN	no MicrobeCare protection <input type="checkbox"/>	+\$0

Step 11.

Fabric

For not fire retardant (non CTB-133) (NR) with one fabric (1F)

Price Category (Nemschoff) Series 3	+\$0
Price Category (Nemschoff) Series 4	+\$377
Price Category (Nemschoff) Series 5	+\$771
Price Category (Nemschoff) Series 6	+\$1242
Price Category (Nemschoff) Series 7	+\$1714
Price Category (Nemschoff) Series 8	+\$2305

Seat Fabric

For not fire retardant (non CTB-133) (NR) with multiple fabrics (MF)

Price Category (Nemschoff) Series 3	+\$0
Price Category (Nemschoff) Series 4	+\$151
Price Category (Nemschoff) Series 5	+\$286
Price Category (Nemschoff) Series 6	+\$449
Price Category (Nemschoff) Series 7	+\$610
Price Category (Nemschoff) Series 8	+\$817

Step 12. Back Fabric

For not fire retardant (non CTB-133) (NR) with multiple fabrics (MF)

Price Category (Nemschoff) Series 3	+\$0
Price Category (Nemschoff) Series 4	+\$205
Price Category (Nemschoff) Series 5	+\$389
Price Category (Nemschoff) Series 6	+\$608
Price Category (Nemschoff) Series 7	+\$831
Price Category (Nemschoff) Series 8	+\$1110

Step 13. Arm Fabric

For not fire retardant (non CTB-133) (NR) with multiple fabrics (MF)

Price Category (Nemschoff) Series 3	+\$0
Price Category (Nemschoff) Series 4	+\$203
Price Category (Nemschoff) Series 5	+\$385
Price Category (Nemschoff) Series 6	+\$602
Price Category (Nemschoff) Series 7	+\$823
Price Category (Nemschoff) Series 8	+\$1093

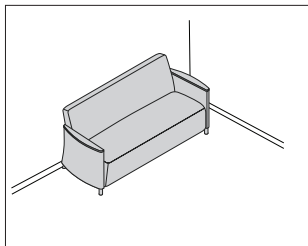

Product Information

Description

Features:

- Mortise and tenon joinery
- Spring seat construction
- Clean-out design
- Replaceable components
- Upholstered arms
- Powder-coated metal legs
- Wallsaver legs
- Non-marring 1" glides
- Indoor Advantage™ Gold Certified

Notes

Weight—73 lbs

COM yardage:

Single Fabric—8

Multiple Fabrics:

Seat—3¼

Back—3¾

Arms—3

Dimensions

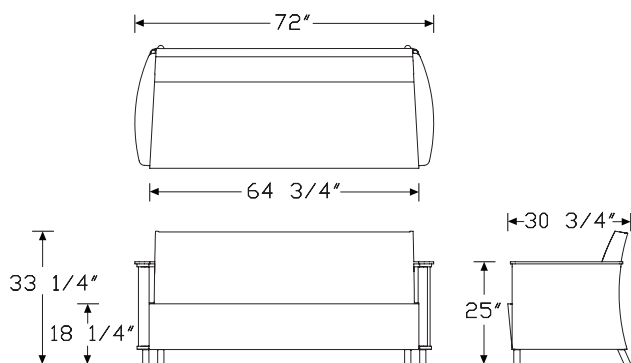

Specification Information

Step 1.

797 ☐ A

Step 2. Size

-3 72" wide ☐ A +\$5644

Step 3. Covers

S standard covers ☐ A +\$0

P removable covers ☐ A +\$623

Step 4. Fire Retardancy

NR not fire retardant (non CTB-133) ☐ A +\$0

Step 5. Fabric Configuration

1F one fabric ☐ A +\$0

MF multiple fabrics ☐ A +\$127

Step 6. Arm Cap Detail

K solid surface ☐ A +\$0

U upholstered ☐ A +\$0

R urethane ☐ A +\$0

W wood ☐ A +\$124

Step 7. Arm Cap Finish

For upholstered (U)

SU same as chair arm upholstery ☐ A +\$0

For urethane (R)

BK black ☐ A +\$124

For wood (W)

0Z medium cherry ☐ A +\$0

2U light brown walnut ☐ A +\$0

40 dark brown walnut ☐ A +\$0

5K honey maple ☐ A +\$0

ED aged cherry ☐ A +\$0

IZ aged teak ☐ A +\$0

UL natural maple ☐ A +\$0

For solid surface (K)

58 cameo white ☐ A +\$500

ANC antarctica ☐ A +\$500

CQ glacier white ☐ A +\$500

QB bisque ☐ A +\$500

SVG silver gray ☐ A +\$500

Step 8. Powdercoat Base Finish		
BK	black <input type="checkbox"/>	+\$0
G1	graphite textured <input type="checkbox"/>	+\$0
MSS	metallic silver smooth <input type="checkbox"/>	+\$0
MST	metallic silver textured <input type="checkbox"/>	+\$0
XTS	titanium smooth <input type="checkbox"/>	+\$0
XTT	titanium textured <input type="checkbox"/>	+\$0

Step 9. Moisture Barrier Option		
MBN	no moisture barrier <input type="checkbox"/>	+\$0
MBB	moisture barrier back only <input type="checkbox"/>	+\$325
MBS	moisture barrier seat only <input type="checkbox"/>	+\$325
MBX	moisture barrier seat and back <input type="checkbox"/>	+\$550

Step 10. MicrobeCare Selection		
MCN	no MicrobeCare protection <input type="checkbox"/>	+\$0

Step 11.

Fabric

For not fire retardant (non CTB-133) (NR) with one fabric (1F)

Price Category (Nemschoff) Series 3	+\$0
Price Category (Nemschoff) Series 4	+\$464
Price Category (Nemschoff) Series 5	+\$951
Price Category (Nemschoff) Series 6	+\$1526
Price Category (Nemschoff) Series 7	+\$2108
Price Category (Nemschoff) Series 8	+\$2838

Seat Fabric

For not fire retardant (non CTB-133) (NR) with multiple fabrics (MF)

Price Category (Nemschoff) Series 3	+\$0
Price Category (Nemschoff) Series 4	+\$231
Price Category (Nemschoff) Series 5	+\$435
Price Category (Nemschoff) Series 6	+\$678
Price Category (Nemschoff) Series 7	+\$922
Price Category (Nemschoff) Series 8	+\$1229

Step 12. Back Fabric

For not fire retardant (non CTB-133) (NR) with multiple fabrics (MF)

Price Category (Nemschoff) Series 3	+\$0
Price Category (Nemschoff) Series 4	+\$271
Price Category (Nemschoff) Series 5	+\$511
Price Category (Nemschoff) Series 6	+\$797
Price Category (Nemschoff) Series 7	+\$1085
Price Category (Nemschoff) Series 8	+\$1449

Step 13. Arm Fabric	
<i>For not fire retardant (non CTB-133) (NR) with multiple fabrics (MF)</i>	
Price Category (Nemschoff) Series 3	+\$0
Price Category (Nemschoff) Series 4	+\$209
Price Category (Nemschoff) Series 5	+\$397
Price Category (Nemschoff) Series 6	+\$617
Price Category (Nemschoff) Series 7	+\$840
Price Category (Nemschoff) Series 8	+\$1118

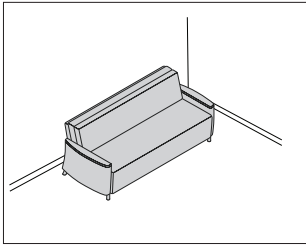

Product Information

Description

Features:

- Mortise and tenon joinery
- Spring seat construction
- Replaceable components
- Removable covers
- Upholstered arms
- Powder-coated metal legs
- Wallsaver legs
- 1" plastic glides
- Back cushion flops down to convert to sleep surface (no mechanism)
- Sleep surface dimensions 30" x 80¼"
- Antimicrobial, moisture-proof and cleanable sleep surface
- Indoor Advantage™ Gold Certified

Notes

Weight—141 lbs

COM yardage:

Single Fabric—12

Multiple Fabrics:

Seat—3¾

Back—2¾

Arms—2½

Flop Cushion—3¾

Dimensions

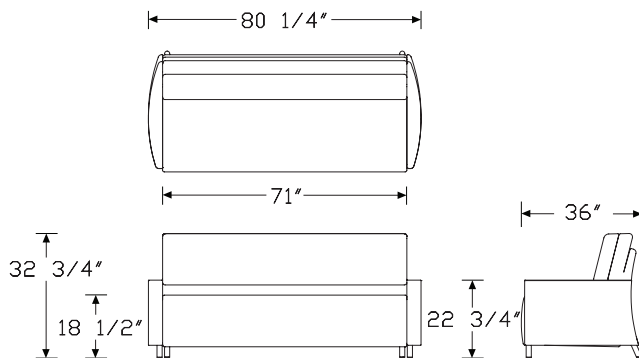

Specification Information

Step 1.

797 A

Step 2. Size

-37 80.25" wide A +\$6338

Step 3. Fire Retardancy

NR not fire retardant (non CTB-133) A +\$0

Step 4. Fabric Configuration

1F one fabric A +\$0

MF multiple fabrics A +\$127

Step 5. Arm Cap Detail

K solid surface A +\$0

U upholstered arm caps A +\$0

W wood arm caps A +\$124

R urethane arm caps A +\$0

Step 6. Arm Cap Finish

For upholstered arm caps (U)

SU same as chair arm upholstery A +\$0

For urethane arm caps (R)

BK black A +\$124

For wood arm caps (W)

0Z medium cherry A +\$0

2U light brown walnut A +\$0

40 dark brown walnut A +\$0

5K honey maple A +\$0

ED aged cherry A +\$0

IZ aged teak A +\$0

UL natural maple A +\$0

For solid surface (K)

58 cameo white A +\$500

ANC antarctica A +\$500

CQ glacier white A +\$500

QB bisque A +\$500

SVG silver gray A +\$500

Pamona™ Flop® Sofa, 80.25" Wide

continued

Nemschoff® Pamona™ Flop® Sofa

Step 7. Casters

NNN	no casters <input type="checkbox"/>	+\$0
SBS	front legs, 3" twin wheel swivel casters with breaks in rear only <input type="checkbox"/>	+\$275
CST	four 3" twin wheel swivel casters with brakes <input type="checkbox"/>	+\$325

Step 8. Powdercoat Finish

For no casters (NNN) or front legs, 3" twin wheel swivel casters with breaks in rear only (SBS)

BK	black <input type="checkbox"/>	+\$0
G1	graphite textured <input type="checkbox"/>	+\$0
MSS	metallic silver smooth <input type="checkbox"/>	+\$0
MST	metallic silver textured <input type="checkbox"/>	+\$0
XTS	titanium smooth <input type="checkbox"/>	+\$0
XTT	titanium textured <input type="checkbox"/>	+\$0

Step 9. Moisture Barrier Option

MBN	no moisture barrier <input type="checkbox"/>	+\$0
MBB	moisture barrier back only <input type="checkbox"/>	+\$325
MBS	moisture barrier seat only <input type="checkbox"/>	+\$325
MBX	moisture barrier seat and back <input type="checkbox"/>	+\$550

Step 10. MicrobeCare Selection

MCN	no MicrobeCare protection <input type="checkbox"/>	+\$0
------------	--	------

Step 11.

Fabric

For not fire retardant (non CTB-133) (NR) with one fabric (1F)

Price Category (Nemschoff) Series 3	+\$0
Price Category (Nemschoff) Series 4	+\$697
Price Category (Nemschoff) Series 5	+\$1424
Price Category (Nemschoff) Series 6	+\$2289
Price Category (Nemschoff) Series 7	+\$3163
Price Category (Nemschoff) Series 8	+\$4256

Seat Fabric

For not fire retardant (non CTB-133) (NR) with multiple fabrics (MF)

Price Category (Nemschoff) Series 3	+\$0
Price Category (Nemschoff) Series 4	+\$276
Price Category (Nemschoff) Series 5	+\$540
Price Category (Nemschoff) Series 6	+\$852
Price Category (Nemschoff) Series 7	+\$1165
Price Category (Nemschoff) Series 8	+\$1560

Step 12. Back Fabric

For not fire retardant (non CTB-133) (NR) with multiple fabrics (MF)

Price Category (Nemschoff) Series 3	+\$0
Price Category (Nemschoff) Series 4	+\$200
Price Category (Nemschoff) Series 5	+\$389
Price Category (Nemschoff) Series 6	+\$613
Price Category (Nemschoff) Series 7	+\$840
Price Category (Nemschoff) Series 8	+\$1126

Step 13. Cushion Fabric

For not fire retardant (non CTB-133) (NR) with multiple fabrics (MF)

Price Category (Nemschoff) Series 3	+\$0
Price Category (Nemschoff) Series 4	+\$276
Price Category (Nemschoff) Series 5	+\$540
Price Category (Nemschoff) Series 6	+\$852
Price Category (Nemschoff) Series 7	+\$1165
Price Category (Nemschoff) Series 8	+\$1560

Step 14. Arm Fabric

For not fire retardant (non CTB-133) (NR) with multiple fabrics (MF)

Price Category (Nemschoff) Series 3	+\$0
Price Category (Nemschoff) Series 4	+\$192
Price Category (Nemschoff) Series 5	+\$374
Price Category (Nemschoff) Series 6	+\$591
Price Category (Nemschoff) Series 7	+\$808
Price Category (Nemschoff) Series 8	+\$1082

Nemschoff® Pamona™ Seating	
Pamona™ Chair, 31.25" Wide	page(s) 5
Pamona™ Flop® Sofa, 80.25" Wide	11
Pamona™ Settee, 54" Wide	7
Pamona™ Sofa, 72" Wide	9



Index by Product Number



797-1	Pamona™ Chair, 31.25" Wide	page(s) 5
797-2	Pamona™ Settee, 54" Wide	7
797-3	Pamona™ Flop® Sofa, 80.25" Wide	11
797-3	Pamona™ Sofa, 72" Wide	9



20-Day or Less/Assigned Lead-Time Order Information

20-Day or Less and Assigned Lead-Time Programs

20-day or less and assigned lead-time products are designed for established Herman Miller dealers with pre-approved credit.

Products are distributed from multiple manufacturing facilities across the United States. All products and options not designated by an Assigned Lead-Time icon  will ship in 20 business days or less after being acknowledged by Herman Miller. Products and options designated by an  are on the assigned lead-time program and will ship in 20 days, less than 20 days, or more than 20 days from order acknowledgement.

Ordering Procedure

Please place orders through Order Manager. If this is not available to you, place orders through mail or fax. Verbal purchase orders will not be accepted.

Order Entry fax number for Meridian®

Filing and Storage: (616) 846 9236.

Order Entry fax number for all other products:

(616) 654 3085.

For more information, contact your Customer Care representative at: (866) 854 3048 ext 3400.

Shipments and Delivery

Per Herman Miller Terms and Conditions.

Changes and Cancellation

Per Herman Miller Terms and Conditions.



Nemschoff® Pamona™ Seating Multiple Fabrics Guide

Multiple fabrics can be selected for application on a single product. Choosing multiple fabrics allows for high-performance fabrics to be used in the specific areas where they're most needed. For example, easy-to-clean, abrasion-resistant polyurethane can be used on the seat and headrest, combined with a softer woven fabric for the back where wear is less of an issue.

Choosing multiple fabrics also offers aesthetic flexibility. For example, you can create design continuity among multiple pieces by combining colors and patterns to help coordinate them.

All surfaces included in an area must be the same fabric.

Illustrations intended for single seat, multiple seat, and different back height units.

All arms, including intervening when applicable, must be in the same fabric.

All footrests include the mid-ottoman and footrest flap in the same fabric.

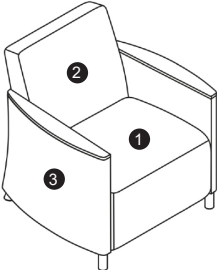
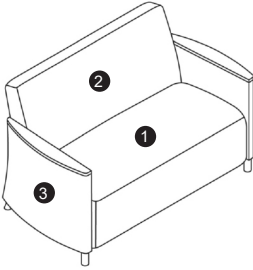
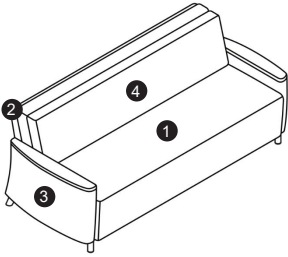
KEY	Pamona Armchair	Pamona Settee & Sofa	Pamona Flop Sofa
1. Seat			

For more information about our products and services or to see a list of dealers, please visit us at HermanMiller.com or call (800) 851 1196.

© 2025 Herman Miller, Inc., Zeeland, Michigan

Distribution Rights

Working together since 1956, Herman Miller and Vitra are the authentic sources of designs by Charles and Ray Eames, Alexander Girard, and George Nelson. All the designs shown in this book are protected by law. Herman Miller has obtained all rights to make and sell these designs. Also, Herman Miller holds exclusive worldwide manufacturing and distribution rights for these products with the following exceptions:

Charles and Ray Eames, George Nelson, and Alexander Girard—Worldwide distribution rights for furniture in all areas except Europe and the Middle East. For those areas, please contact Vitra.

Isamu Noguchi—Worldwide distribution rights for the Noguchi Rudder Table. Distribution rights for the Noguchi Table in North America and Central America only. For all other areas, please contact Vitra.

Magis—Exclusive distribution rights in the US and Canada. For all other areas, please contact Magis.

© HermanMiller, 3D Intelligent, 8Z Pellicle, AO, Action Office, Aeron, Aside, Bubble Lamps, Canvas Office Landscape, Caper, Celle, Cosm, Co/Struc, Daisyone, Distil, Eames, Eco-Dematerialized, Embody, Envelop, Ethospace, Exclave, Fine-Tune, FlexFront, Flo, Formcoat, Formwork, Ground Cloth, Intent, Kinemat, Layout Studio, Lino, Live Unframed, Living Office, Maharam, Meridian, Mirra, Motia, Nelson, Pari, Pellicle, Perspectives, Plex, PostureFit, PostureFit SL, Public Office Landscape, Sayl, Setu, Striad, Tu, Ubi, Verus, Wishbone, Y-Tower and Zeph are among the registered trademarks of Herman Miller, Inc., and its owned subsidiaries.

™ About Face, AireWeave, Airia, Ambit, Asari Chair by HermanMiller, Backfit, Bubbletack, Burdick Group, Butterfly Back, Canvas Vista, Cellular Suspension, Commend, Compass, Connect, DOT, Duracare, Durawrap, EnhancedAccess, Everywhere, Flex-Edge, Flute, Harmonic, Headway, Herman Miller Select, Hopsak 2, Iota, Keyless Entry, Latitude, Logic Mini, Logic Power Access Solutions, Lyris, Lyris 2, Made-to-Measure Storage, Mora, Multiscrim, Nevi, OE1, OE1 Workspace Collection, Overlay, Pixelated Support, Pronta, Renew, Sense, Soft Pad, Stackable, Stackable Storage, Swoop, Thrive, Tone, TriFlex, Twist and Wireframe are among the trademarks of Herman Miller, Inc., and its owned subsidiaries.

SM Herman Miller Options is among the service marks of Herman Miller, Inc.

AAP™ is a trademark of Extron Electronics.

Alexander Girard® is a registered trademark of The Alexander Girard Estate.

Chemsurf® is a registered trademark of Wilsonart International.

Corian® is a registered trademark of E. I. du Pont de Nemours and Company Corporation.

Crypton® is a registered trademark of Crypton, Inc.

DACRON® is a registered trademark of INVISTA S.a r.l.

Danzer® is a registered trademark of Danzer Holding AG.

Decora® is a registered trademark of Leviton Manufacturing Co., Inc.

Edelman® Leather is a registered trademark of Edelman Leather, Inc.

Extron® is a registered trademark of RGB Systems, Inc.

FENIX NTM® is a registered trademark of Arpa Industriale S.p.A.

FLEXNET™ is a trademark of Milliken & Company.

Floor Saver Glide® is a registered trademark of Carpin Manufacturing, Inc.

Forest Stewardship Council® is a registered trademark of the Forest Stewardship Council A.C. (FSC). We are FSC® certified (FSC® C102895).

FSC® is a registered trademark of the Forest Stewardship Council A.C. (FSC).

Geiger® is a registered trademark, and Bumper™, Saiba™, and Ward Bennett™ are trademarks, of Geiger International.

Hang-It-All® is a registered trademark of Lucia Eames Demetrios, d.b.a. Eames Office.

Holophane® is a registered trademark of Holophane.

Ingeo™ is a trademark of Cargill Dow LLC.

iPad® and Mac mini® are registered trademarks of Apple Inc.

Leviton® is a registered trademark of Leviton Manufacturing Co., Inc.

LifeSize® is a registered trademark of LifeSize Communications, Inc.

Lisocore® is a registered trademark of Pyrus Panels GmbH.

Logitech G® is a registered trademark of Logitech International S.A.

Magis®, Bombo®, and Me Too® are registered trademarks of Magis S.p.A.

MicrobeCare™ is a trademark of Parasol Medical LLC.

Microsoft® and Natural® Keyboard are registered trademarks of Microsoft Corporation.

Noguchi® and the Noguchi table configuration (trade dress) are registered trademarks, and Rudder Table™ is a trademark, of The Isamu Noguchi Foundation and Garden Museum.

Place Textiles® is a registered trademark of Place Textiles.

Sunbrella® is a registered trademark of Glen Raven, Inc.

SuperSeat™ is a trademark of Dahti Seating, a division of ITW.

Valor™ is among the trademarks owned by Nemschoff, Inc.