

CertainTeed supports SmartFlash ONE use with a library of flashing and repair construction details including: CTL-SF-14 Chimney Flashing

For light gage existing metal flashings, such as those found in chimney flashing, the surface must be cleaned with non-greasy solvent such as acetone or Methyl Ethyl Ketone (MEK). Metals surfaces must be smooth, clean and uncontaminated (free of oxidized bitumen). A small scale adhesion test is recommended. A minimum 2 lbs. per lineal foot of force shall be required to peel SmartFlash® ONE/polyester reinforcement from the metal surface. For guidance, please contact CertainTeed Technical Services Department. A light abrasion with 80 grit sandpaper can also be done to increase the adhesion quality.

**Tape (Recommended)**

Tape off desired edges for clean detail aesthetic.

**Polyester Reinforcement Preparation (Recommended)**

Prepare and cut SMARTFAB 500 Polyester Reinforcement prior to applying any resin.

**First Waterproofing Coat**

Using a paint brush, roller or trowel for SmartFlash ONE Resin, apply approximately 30 mils of wet resin to properly

prepared metal/chimney surfacing as needed to extend a minimum 3" (76 mm) beyond any deficiencies in all directions. Immediately lightly press SMARTFAB 500 Reinforcement into wet resin ensuring that the polyester is free of all air pockets and wrinkles; Reinforcement shall be a width sufficient to extend a minimum 2" (50 mm) beyond deficiencies in all directions - vertical reinforcement shall extend a minimum 4" from the base of the detail; saturate and coat Reinforcement with resin such that no Reinforcement is visible.

If leak is known or there is a visible breach of the flashing, extend resin and reinforcement onto horizontal plane a minimum 4" for resin and 3" for reinforcement.

**Second Waterproofing Coat**

Apply approximately 30 mils of wet resin to entire surface covered by first coating.

**Granules (Optional)**

If desired, broadcast granules into the second waterproofing coat before it forms a skin.



For Use with Asphaltic Membranes or Shingles

# SmartFlash® ONE

Your Go-To Solution for Liquid-Applied Flashing and/or Permanent Repairs

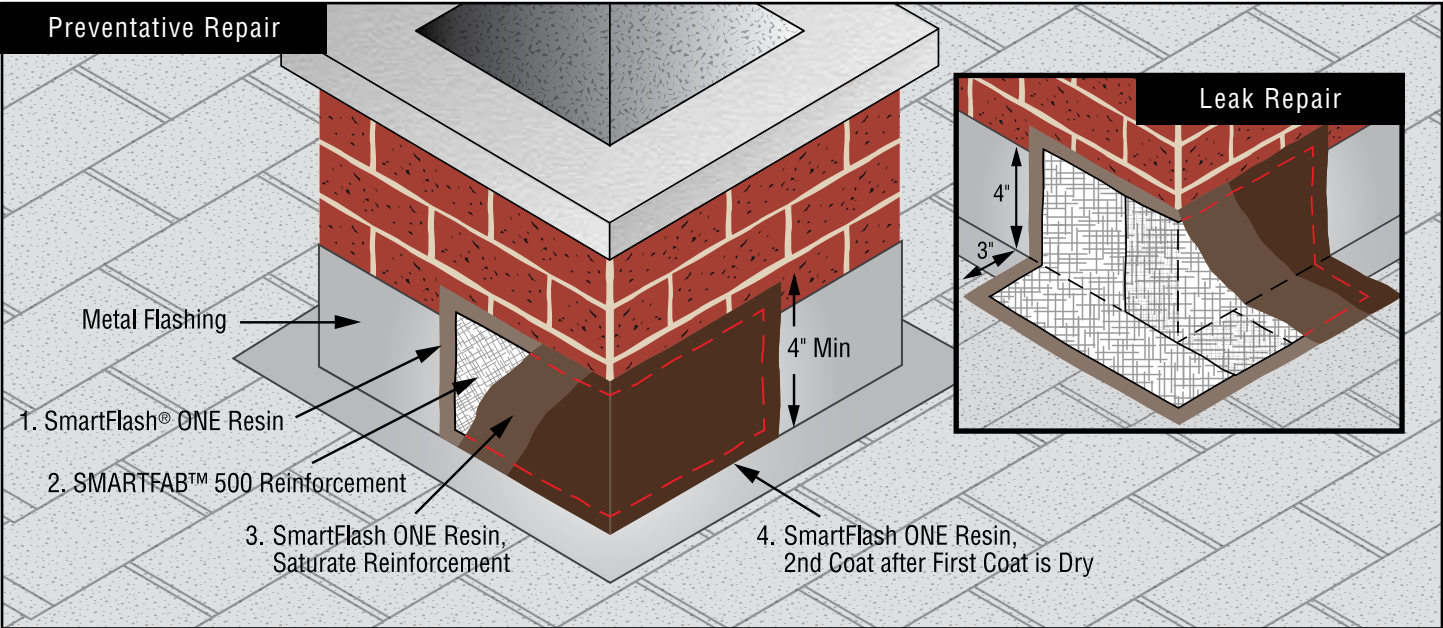

NOT DRAWN TO SCALE



**CertainTeed**

CEILINGS • DECKING • FENCE • GYPSUM • INSULATION • RAILING • ROOFING • SIDING • TRIM  
20 Moores Road, Malvern, PA 19355 Professional: 800-233-8990 Consumer: 800-782-8777 [certainteed.com](http://certainteed.com)

©Rev. 01/23 CertainTeed, Printed in the USA, Code No. 01-00-262-US-EN



## New Flashing Details — Problem

Traditional penetration flashings fail without routine inspection and maintenance.  
Why?

- Improper installation or incompatible sealants
- High levels of roof vibration or structural movement
- Failure to inspect and refill sealant
- Failure to inspect and correct corroded metal

*Penetration pockets are no longer a recommended flashing method by the National Roofing Contractors Association.*



## SmartFlash® ONE:

Maintenance-free waterproofing, up to 20 years.

- **Self-Terminating:** No lead, no additional components
- **Versatile:** Conformation to almost any penetration shape
- **Efficient:** One-part resin, no primer, no roof-top measuring or mixing, no limitation to working time, no waste – unused resin can be stored and used on a future project
- **Warranted:** CertainTeed Integrity Roof System (NDL) Limited Warranties apply to SmartFlash ONE roof system flashings, up to 20 years



## Repairs — Problem

Mastic-based repairs on steep or low-slope roofs are a temporary patch.

More durable repair options are often inefficient, requiring multiple trips to the job site and procurement of custom materials - squeezing contractor margins.



## SmartFlash ONE:

UV stable, quick, permanent repairs.

- **Versatile:** Repair cracks in asphalt membrane/shingle or damaged/corroded flashings
- **Visually Appealing:** Broadcast granules into wet resin to match existing roof surfacing only *if desired*
- **Efficient:** Easily resealed and stored on repair trucks for use when needed
- **Warranted:** Backed by 10-year waterproof repair warranty



Packaging That Makes Cents

SmartFlash® ONE is available in a Flash Pack, 1G or 5G pails. A Flash Pack includes all materials and tools required to flash 17 square feet.



Option 1. Flash Pack, All-In-One

Repairs can be a highly profitable business. But if you’re not charging for the tools and accessories you’re using, you are leaving money on the table. The Flash Pack includes everything you need to flash or repair 17 square feet and can be invoiced on a single line item. All this with the added benefit of always having what you need to finish the job.

SmartFlash ONE Flash Pack includes 1G resin, 6" x 36' polyester, 4" roller, two extra naps, 2" brush, scissors, two pairs of latex gloves, and 2" x 180" masking tape.

Option 2. A la Carte

High volume usage? No problem. SmartFlash ONE is also available in 1G pails, sold two per carton, and 5G pails. SMARTFAB stitchbond polyester reinforcement is available in 4", 6", 12" and 20" widths, each 150' long. The scissors and tape are on you (wink).



Packaging	Units/Pallet	Yield/Unit (sq. ft.)
Flash Pack	36	17
1G (sold 2 per carton)	120 (60 cartons)	34 (assumes 2, 1G pails)
5G	36	85
SMARTFAB 500 Reinforcement 4", 6", 12", 20" widths x 300' length (sold 5 per carton)	Size Dependent, see Technical Data Sheet or Price Sheet	

CertainTeed supports SmartFlash ONE use with a library of flashing and repair construction details including: CTL-SF-06 Pipe Flashing, Liquid

NOTE: This detail is not intended for use on hot pipes, see CTL-SF-09 HOT PIPE FLASHING.

Anchor, Base Ply and Cap Sheet

Mechanically attach or fully adhere (self-adhered, torch, cold process or hot asphalt) to base of penetration. Proper attachment is defined by specific system, product selection and deck type.

Pipe

If pipe is manufactured with PVC, abrade the surface with sand paper prior to resin application. This is also recommended for surfaces with rust or paint. All other surface should be clean and free of moisture, oil or debris.

Tape (Recommended)

Tape off desired edges for clean detail aesthetic.

Polyester Reinforcement Preparation (Recommended)

Prepare SmartFlash ONE Reinforcements prior to applying any resin.

FINGER FLASHING: For pipe or round penetrations, it is necessary to cut "fingers" into one side of the polyester to allow the material to radiate onto the field of the roof without creases.

FLASHING STRIPS: Additionally, prepare two 6" strips cut to 10" in length with half-circles removed to allow for the strips to overlap when placed on opposite sides of the pipe.

First Waterproofing Coat

Using a paint brush, roller or trowel for resin application, apply approximately 30 mils of wet resin to the Cap Sheet approximately 4" (100 mm) horizontally surrounding the penetration and 4" vertically up the penetration.

Immediately lightly press "finger" Reinforcement into wet resin onto field and wrapping pipe; saturate and coat field and vertical Reinforcement with resin such that no reinforcement is visible. Extend resin out to pre-defined detail edges (tape), approximately 10" x 10", at approximately 30 wet mils.

Immediately lightly press field Reinforcement strips into wet resin. Reinforcement strips must overlap each other by a minimum of 2" (50 mm); saturate and coat Reinforcement strips, including overlapped surfaces, with resin such that no Reinforcement is visible. Allow to dry 2-3 hours (assumes 70°F or 20°C).

Second Waterproofing Coat

Apply approximately 30 mils of wet resin to entire surface covered by first coat.

Granules (Optional)

If desired, broadcast granules into the second waterproofing coat before it forms a skin.

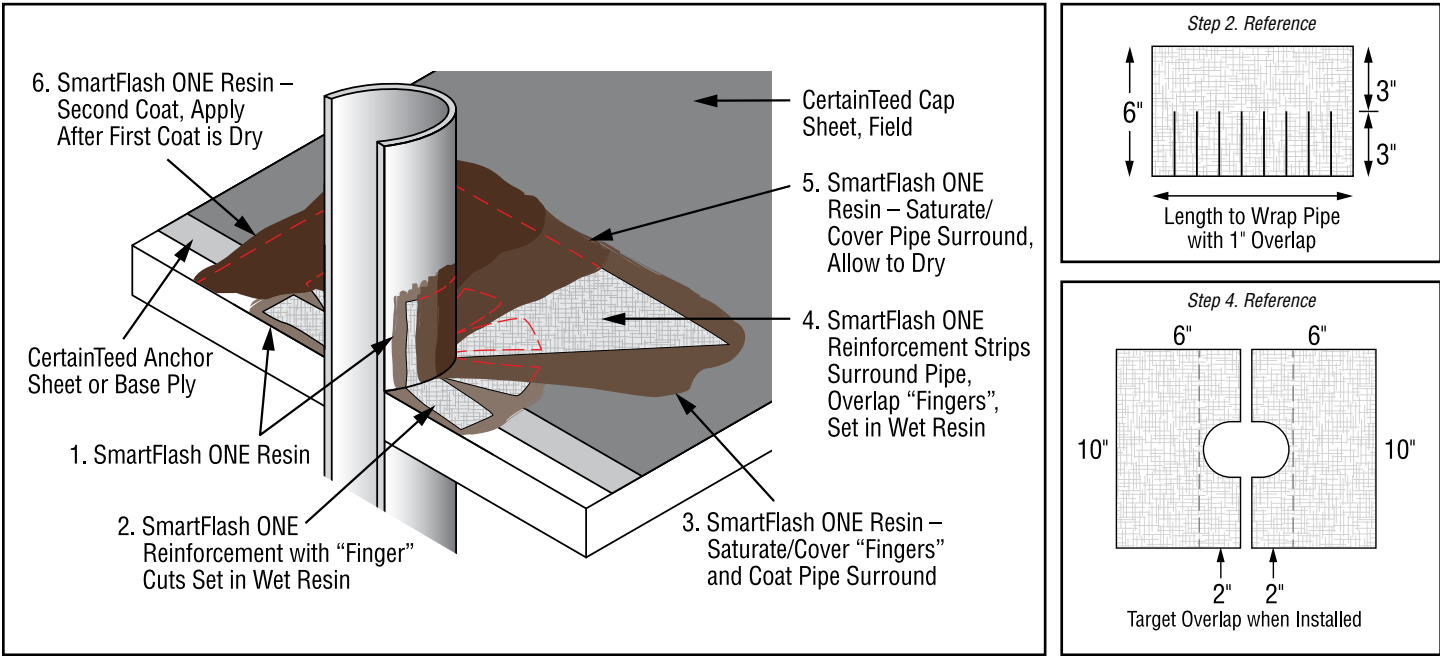

NOT DRAWN TO SCALE



Scan for access to Joe Knows How to Flash a Pipe

For complete SmartFlash ONE details, please visit [certainteed.com](https://certainteed.com) or review the Commercial Roof Systems Specifications manual.

Note: The shades of color representing the Resin is to illustrate difference in coats only. The actual Resin is one color.

CertainTeed supports SmartFlash ONE use with a library of flashing and repair construction details including: CTL-SF-03 Base Flashing, Liquid

Anchor, Base Ply and Cap Sheet

Mechanically attach or fully adhere (self-adhered, torch, cold process or hot asphalt) to intersection of horizontal roof plane and divider. Proper attachment is defined by specific system, product selection and deck type.

Tape (Recommended)

Tape off desired edges for clean detail aesthetic.

Polyester Reinforcement Preparation (Recommended)

Prepare SmartFlash ONE Reinforcements prior to applying any resin. Cut 6" width SmartFlash ONE Reinforcement to appropriate lengths. Reinforcement shall be applied wherever a change in angle occurs and across any seams in the substrate. Reinforcement shall overlap 2" anywhere an overlap occurs. NOTE: To accommodate inside or outside corners, make a 3" long cut halfway through the width of the strip end.

OUTSIDE CORNERS: The cut allows the strip to round the corner and extend onto the field; a second strip cut the same way shall overlap the first strip.

INSIDE CORNERS: The cut allows the strip to round the corner and overlap itself on the vertical surface; a second strip cut the same way shall overlap the first strip.

First Waterproofing Coat

Using a paint brush, roller or trowel for resin application, apply approximately 30 mils of wet resin to the Cap Sheet approximately 4" (100 mm) horizontally onto the field, vertically up the face of the wall, over the top surface of the wall and down the opposing vertical face approximately 2" (50 mm). Immediately lightly press SmartFlash ONE Reinforcement into wet resin where field of roof meets base of vertical surface, along top edges of the wall and across any seams/breaks in material in the wall; saturate and coat Reinforcement with resin such that no Reinforcement is visible. Allow to dry 2-3 hours (assumes 70°F or 20°C).

Second Waterproofing Coat

Apply approximately 30 mils of wet resin to entire surface covered by first coat.

Granules (Optional)

If desired, broadcast granules into the second waterproofing coat before it forms a skin.

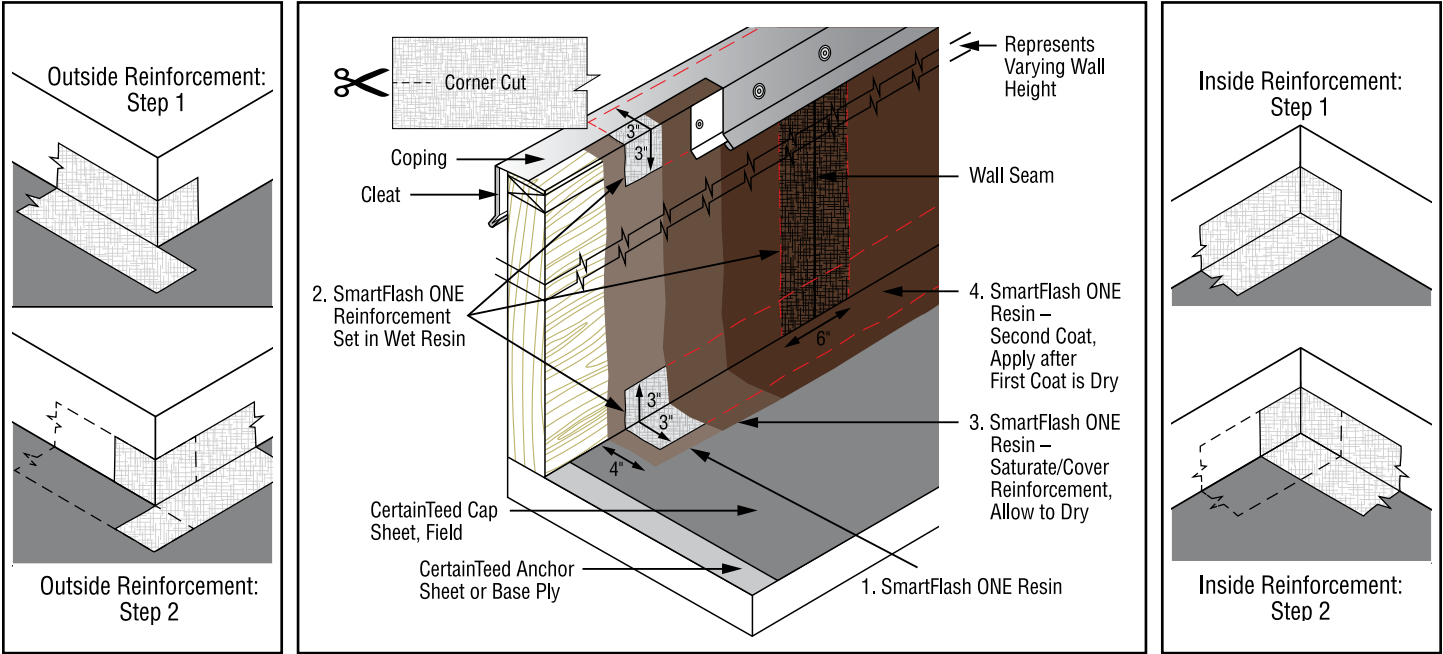

NOT DRAWN TO SCALE

CertainTeed supports SmartFlash ONE use with a library of flashing and repair construction details including: CTL-SF-05 Drain Flashing, Liquid

Anchor, Base Ply and Cap Sheet

Mechanically attach or fully adhere (self-adhered, torch, cold process or hot asphalt) to edge of drain bowl. Proper attachment is defined by specific system, product selection and deck type.

Tape (Recommended)

Tape off desired edges for clean detail aesthetic.

Polyester Reinforcement Preparation (Recommended)

Prepare SmartFlash ONE Reinforcements prior to applying any resin.

FINGER FLASHING: For drains, it is necessary to cut "fingers" into the sides of the polyester to allow the material to radiate onto the field of the roof and into the drain bowl without creases.

FLASHING STRIPS: Prepare four 6" strips cut to approximately 12" in length with oval centers removed to overlap the "finger" flashing and surround the drain.

First Waterproofing Coat

Using a paint brush, roller or trowel for resin application, apply approximately 30 mils of wet resin to the Cap Sheet approximately 4" (100 mm) horizontally surrounding the drain and 4" into the bowl.

Immediately lightly press "finger" Reinforcement into wet resin; saturate and coat reinforcement with resin such that no Reinforcement is visible. Extend approximately 30 wet mils of resin out to pre-defined detail edges (tape), approximately 12" x 12".

Immediately lightly press Reinforcement strips into wet resin. Reinforcement strips shall completely cover finger flashing and overlap each other by a minimum of 2" (50 mm); saturate and coat Reinforcement strips, including overlapped surfaces, with resin such that no Reinforcement is visible. Allow to dry 2-3 hours (assumes 70°F or 20°C).

Second Waterproofing Coat

Apply approximately 30 mils of wet resin to entire surface covered by first coat.

Granules (Optional)

If desired, broadcast granules into the second waterproofing coat before it forms a skin.

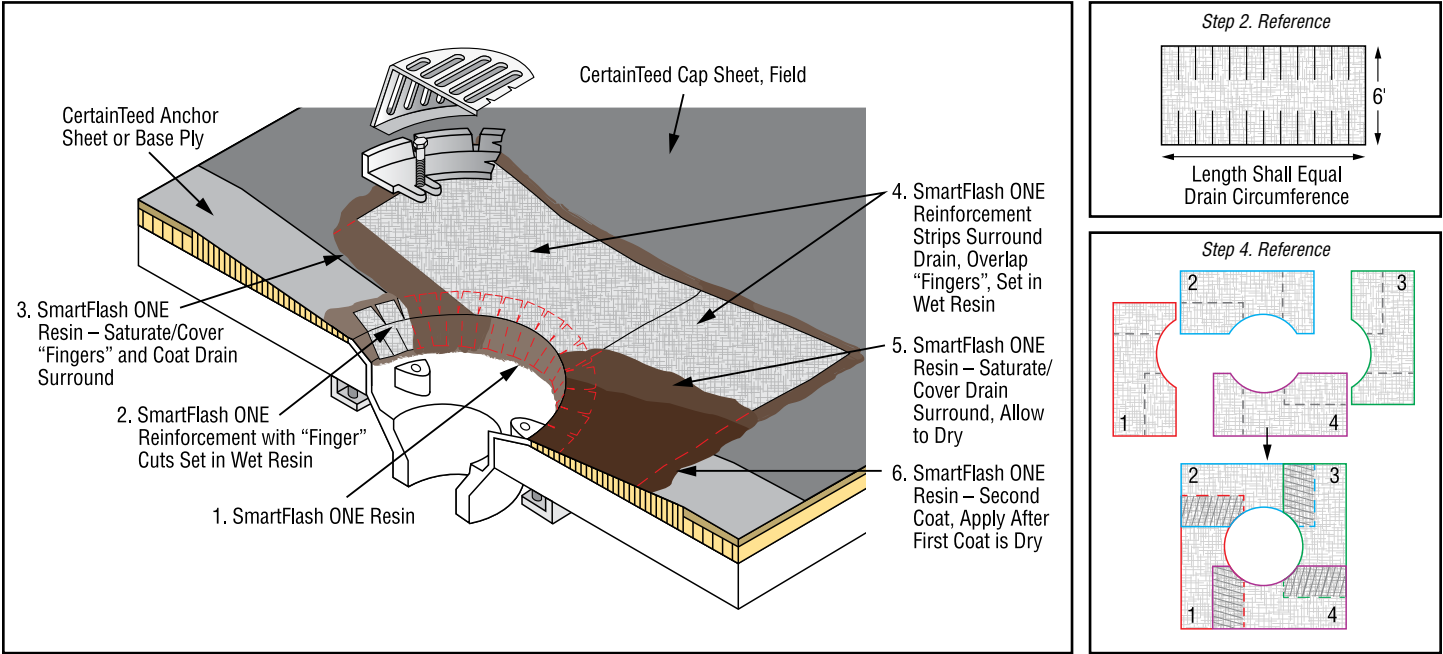

NOT DRAWN TO SCALE



Scan for access to Joe Knows How to Flash a Drain

For complete SmartFlash ONE details, please visit [certainteed.com](https://www.certainteed.com) or review the Commercial Roof Systems Specifications manual.

Note: The shades of color representing the Resin is to illustrate difference in coats only. The actual Resin is one color.