

KEILHAUER

AWLA Assembly Guide



keilhauer.com

1450 Birchmount Road
Toronto, Ontario, Canada
M1P 2E3

T 416 759 5665
F 416 759 5723
1 800 724 5665

Tool Required

Hex Allen Key

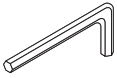

Power Drill



Hex Socket Driver



Hardware Included

1/4-20 x 5/8" flat head socket head cap screw (x6)



1/4-20 x 3/4" Hex socket button head cap screw (x8)



1/4" Post & Cap (x2 each)

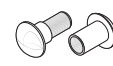

Robertson flat head wood screw #8 X 1" (x4)



AWLA Counter & Bar Height Powered Assembly Instructions

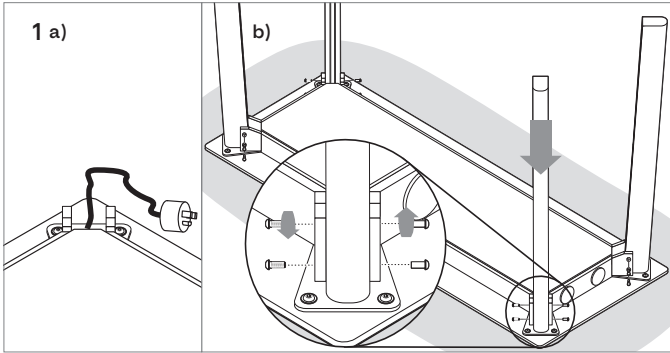

DO NOT COMPLETELY UNWRAP TABLE TOP UNTIL STEP 6. Place table top upside down on a clean surface. One leg has a hollow leg for cable management. Ensure this leg is fastened to the corner with the protruding power cable (See Figure a). Proceed to loosely fasten 1/4" Post & Cap (x2 each per leg) (See Figure b). **DO NOT COMPLETELY TIGHTEN THESE SCREWS UNTIL AFTER STEP 5.**

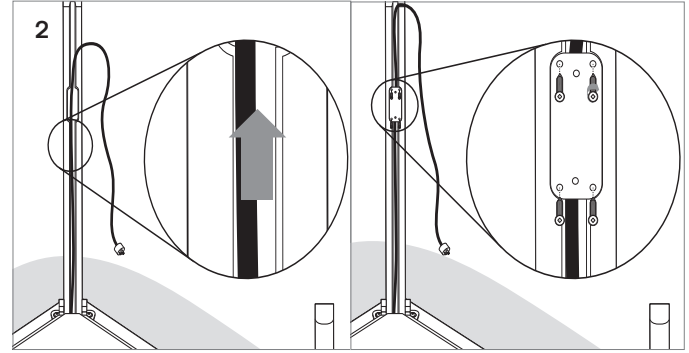

Feed the power cable up and into the channel leg, then install plate to secure (illustrated above) with wood screw #8 X 1" (x4).

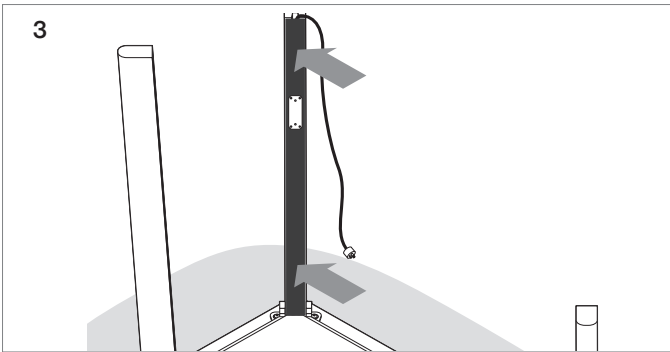

Prior to installing the foot rail, ensure the black cable channel cover is placed over the cable channel leg. Fasten with 1/4-20 x 5/8" flat head socket head cap screw (x6).

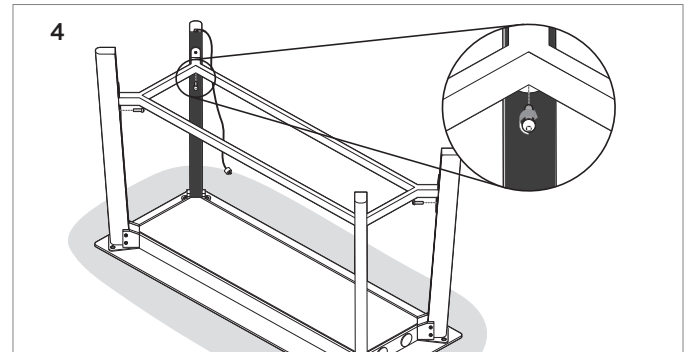

With two assemblers holding up the foot rail so it lines up horizontally to the pilot holes located below the foot rail, proceed to fasten the 1/4-20 x 3/4" Hex socket button head cap screws (x4) using the drill, Hex driver or Hex key.

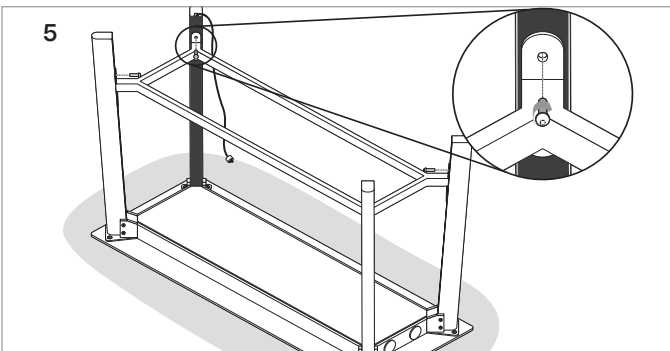

Proceed to fasten the remaining screws to the pilot holes located above the foot rail, using the 1/4-20 x 3/4" Hex socket button head cap screws (x4) using the drill, Hex driver or Hex key. Proceed to fully tighten the the screws fastened to the legs in Step 1.

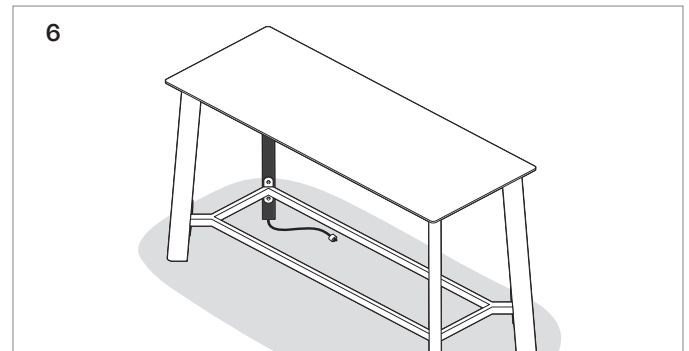

With a minimum of two assemblers, proceed to flip the table and place in its final position. **The table top can now be completely unwrapped.**

AWLA Counter & Bar Height Non- Powered Assembly Instructions

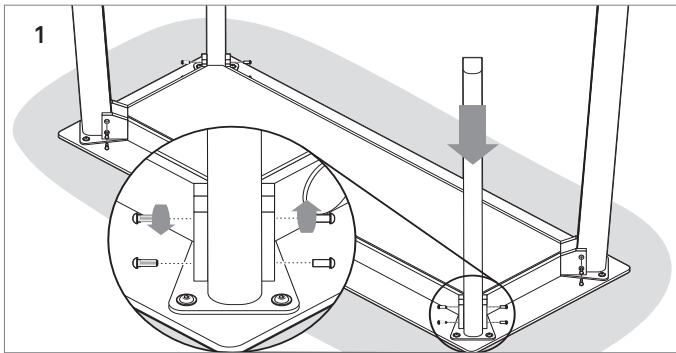

DO NOT COMPLETELY UNWRAP TABLE TOP UNTIL STEP 6. Place table top upside down on a clean surface. Proceed to loosely fasten 1/4" Post & Cap (x2 each per leg) (See Figure b). **DO NOT COMPLETELY TIGHTEN THESE SCREWS UNTIL AFTER STEP 5.**

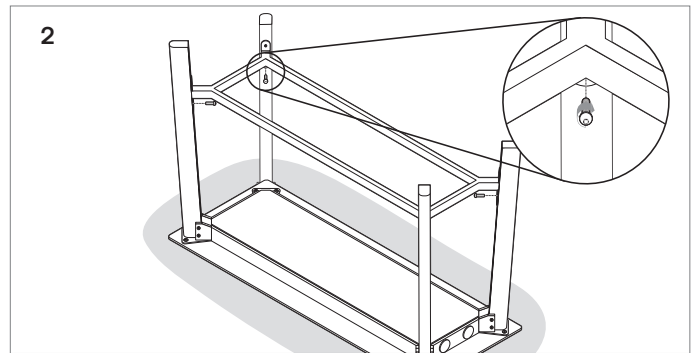

With two assemblers holding up the foot rail so it lines up horizontally to the pilot holes located below the foot rail, proceed to fasten the 1/4-20 x 3/4" Hex socket button head cap screws (x4) using the drill, Hex driver or Hex key.

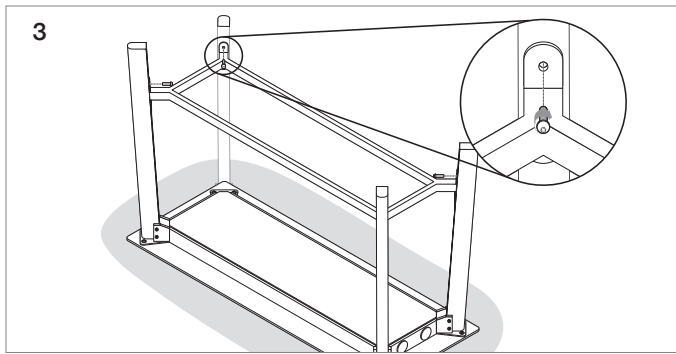

Proceed to fasten the remaining screws to the pilot holes located above the foot rail, using the 1/4-20 x 3/4" Hex socket button head cap screws (x4) using the drill, Hex driver or Hex key. Proceed to fully tighten the the screws fastened to the legs in Step 1.

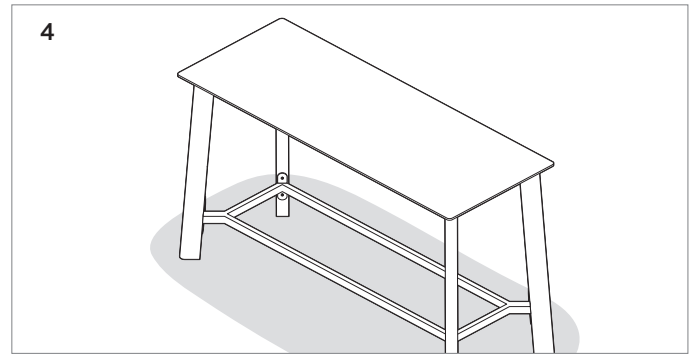

With a minimum of two assemblers, proceed to flip the table and place in its final position. **The table top can now be completely unwrapped.**

AWLA Conference Height Powered Assembly Instructions

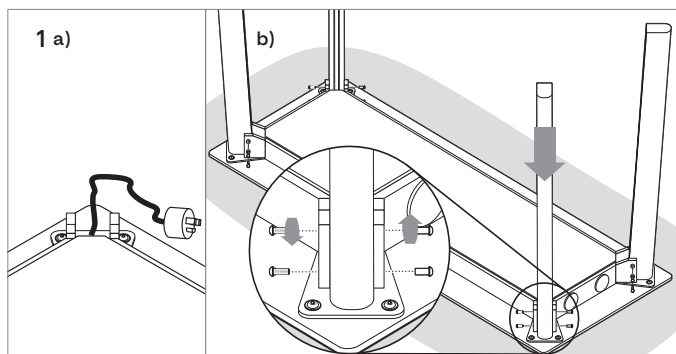

Place table top upside down on a clean surface. One leg has a hollow leg for cable management. Ensure this leg is fastened to the corner with the protruding power cable (See Figure a). Proceed to fasten 1/4" Post & Cap (x2 each per leg) (See Figure b). **DO NOT COMPLETELY UNWRAP TABLE TOP UNTIL STEP 6.**

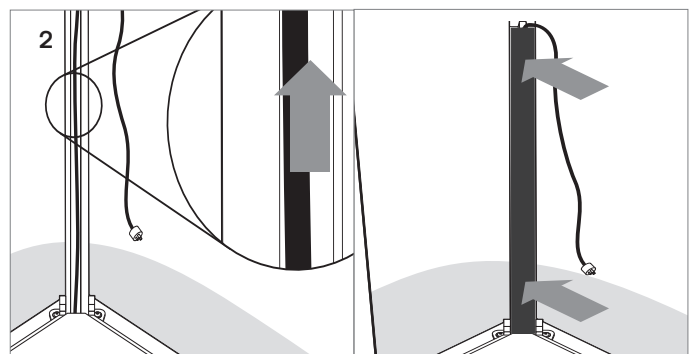

Feed the power cable up and into the channel leg, then fasten the black cable channel cover with 1/4-20 x 5/8" flat head socket head cap screw (x6).

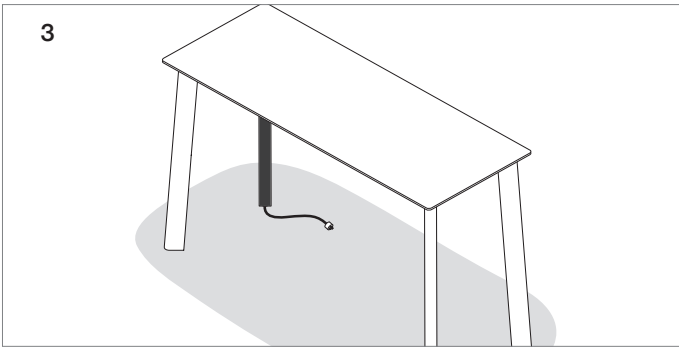

With a minimum of two assemblers, proceed to flip the table and place in its final position.
The table top can now be completely unwrapped.

AWLA Conference Height Non- Powered Assembly Instructions

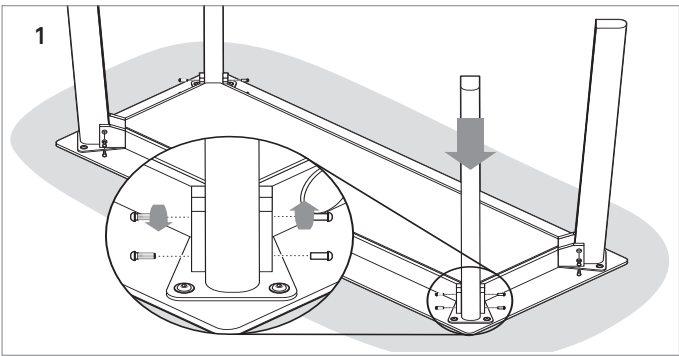

Place table top upside down on a clean surface. Proceed to fasten 1/4" Post & Cap (x2 each per leg) (See Figure b). **DO NOT COMPLETELY UNWRAP TABLE TOP UNTIL STEP 6.**

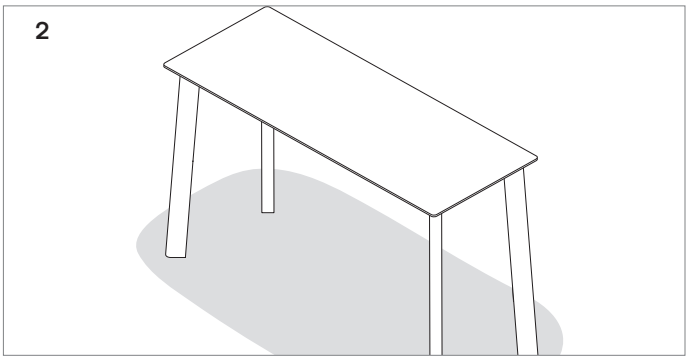

With a minimum of two assemblers, proceed to flip the table and place in its final position.
The table top can now be completely unwrapped.