

KEILHAUER

Epix Shelf

Assembly Instructions, Models 76101, 76102 & 76103

Tool Required

Phillips head screw driver



Hardware Included

1/4-20 x 3/4"
Flat head cap screw
(x36)

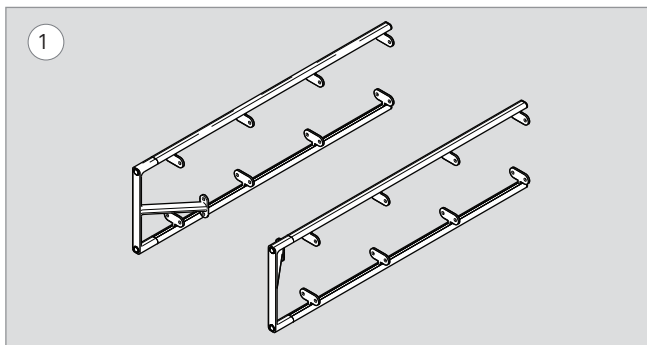

Place each column sub assembly (x2) on its side on a blanket approximately 28 inches apart.

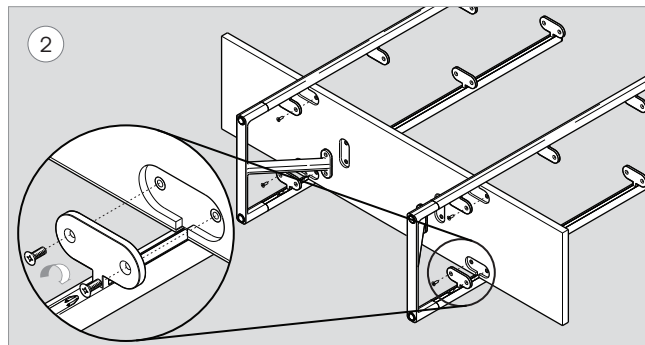

Using the Phillips head screw driver, fasten the column sub assembly (x2) to the bottom shelf platform with 1/4-20 x 3/4" flat head cap screw (x8).

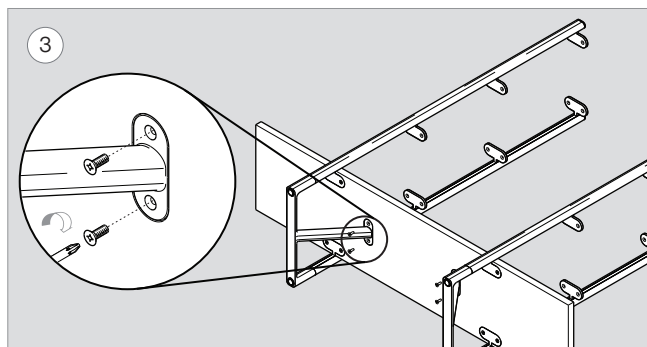

Using the Phillips head screw driver, fasten the two bottom supports using 1/4-20 x 3/4" flat head cap screw (x4).

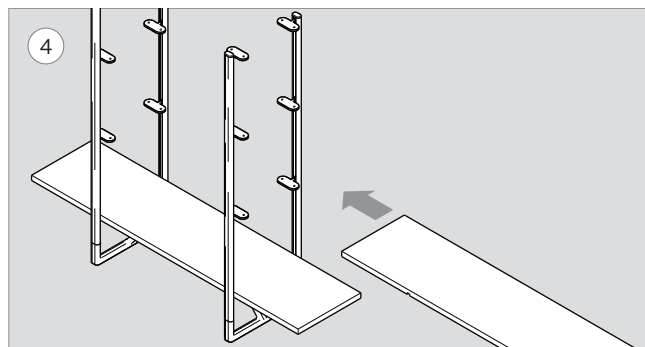

Turn the shelf into the upright position. Slide the remaining shelf platforms through the uprights in to position.

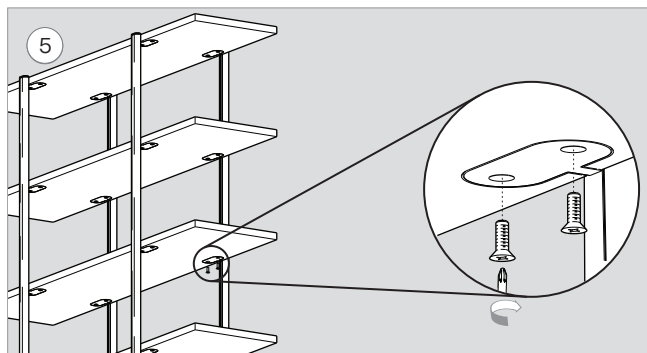

Using the Phillips head screw driver, fasten the remaining shelf platforms with 1/4-20 x 3/4" flat head cap screw (x24).

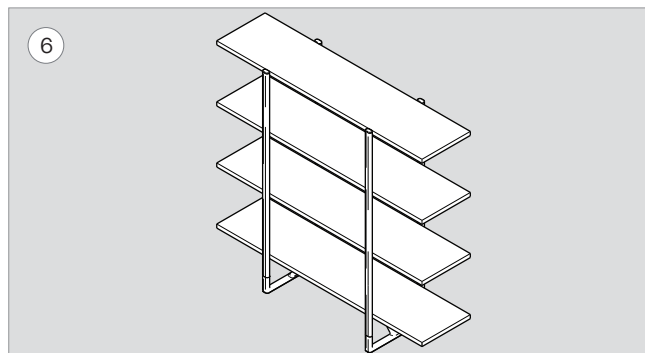

Place assembled shelf in its final position.