

Parts Diagram

Apply™ Armless 4-Leg Stack Chair

December 2022

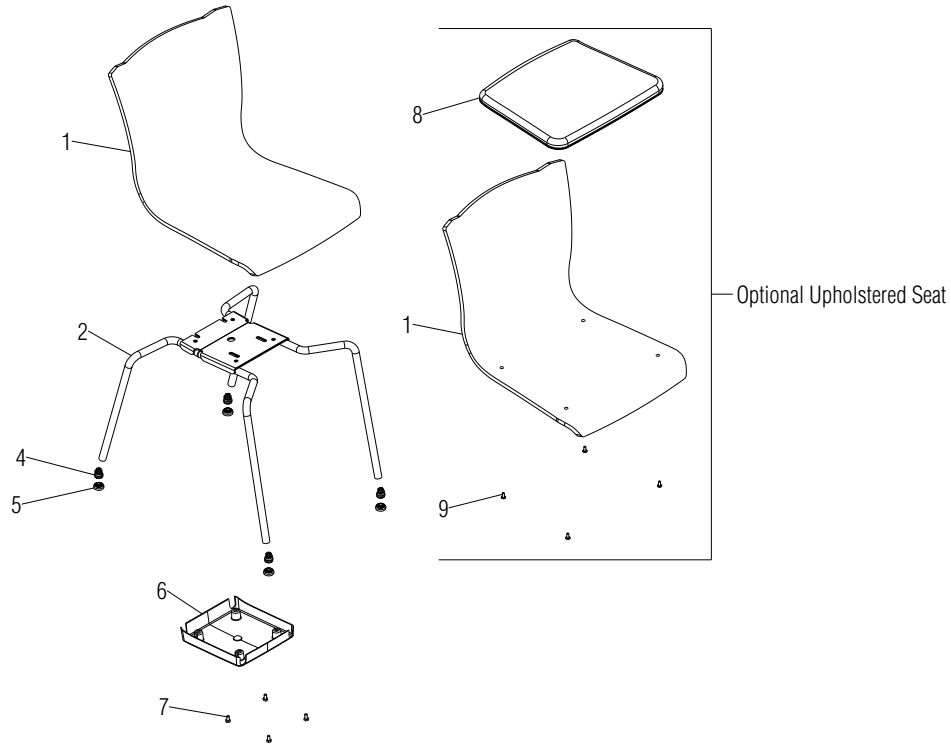

.LXX = Select Laminate

ARSC includes 12.1160.X.

APRF includes choice of glides.

Item 3 glides 10.0039 & 10.0039.N.X are no longer used on chairs shipped after 1/22/21.

Item 4 glides, use caps that are replaced when worn. Use Item 5, caps to replace.

Item 10 glide cap removal tool (not shown) is used to remove old glide caps for replacement on felt glides.

See KI-RR-000030 for instructions.

Item	Part Number	Item Description	Req Qty
1	APRLS	Assembly, Molded Plywood Seat	1
	APRLS	Assembly, Molded Plywood Seat w/ Upholstery	1
2	APRF	Weldment, 4-Leg Armless Stack Chair Frame	1
3	10.0039.X	Glide, 3/4" Steel Bottom Swivel (not shown) (see note)	4
	10.0039.N.X	Glide, 3/4" Nylon Bottom Swivel (not shown) (see note)	4
4	10.0224.X	Glide, Steel (see note)	4
	10.0225.X	Glide, Nylon (see note)	4
	10.0226.X	Glide, Felt (see note)	4
5	10.0227.X	Cap, Steel Glide (see note)	4
	10.0221.X	Cap, Nylon Glide (see note)	4
	10.0223.X	Cap, Felt Glide (see note)	4
6	46.5407.BL.X	Shroud, Stacking	1
7	12.0565.X	Screw, 1/4-20 x 1/2" Hex Head w/ Nylok	4
8	ARSC	Assembly, Replacement Seat Cushion	1
9	12.1160.X	Screw, #12-16 x 1/2" #10 Truss Head	4
10	10.0138.X	Removal Tool, Glide Cap (not shown) (see note)	1

