

# Parts Diagram

LimeLite™ Seating

4-Leg Armless Stack Chair (Models LL11, LL12, LL21 & LL22)

October 2024

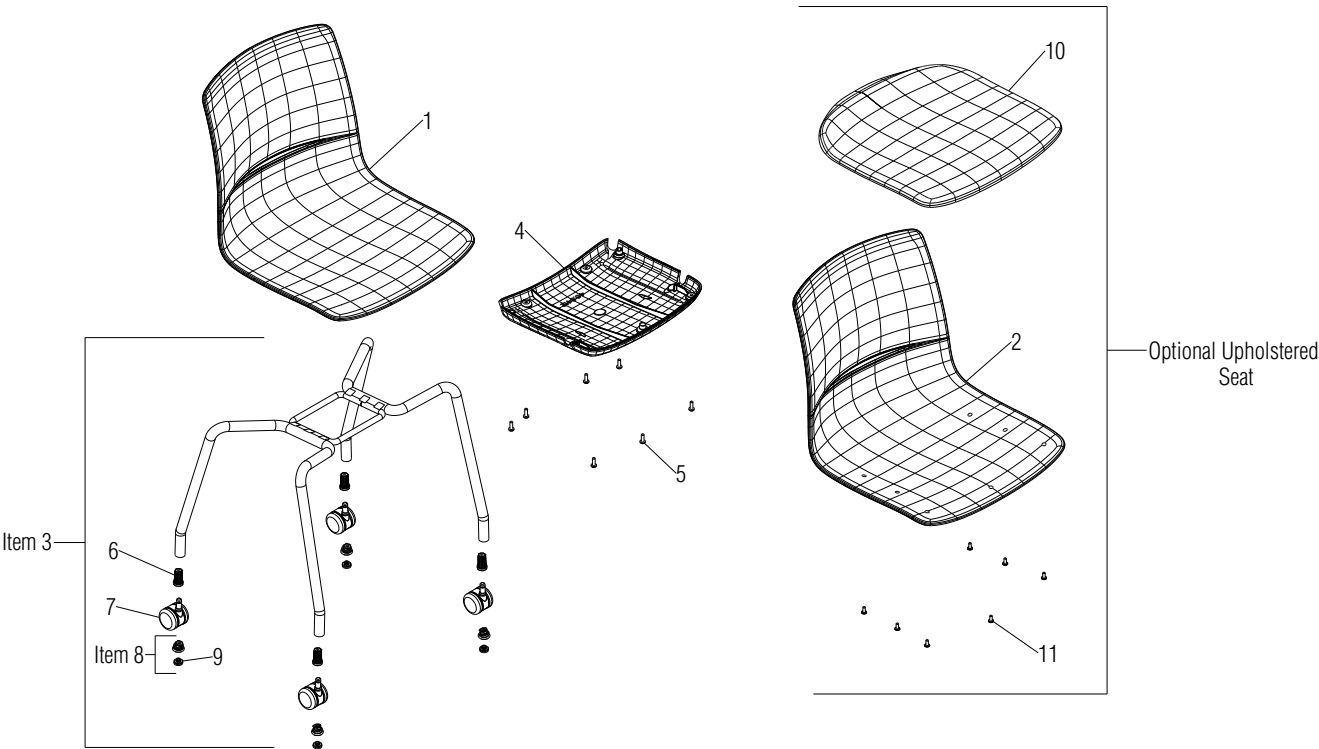

.XX = Select Color

Item 3 includes either Items 6 & 7 or Item 8 which includes Item 9.

See KI-RR-000036 for glide and glide cap replacement.

Item	Part Number	Item Description	Req Qty
1	46.6401.XX.X	Shell, Poly Seat and Back One Piece	1
2	46.6401.XX.U.X	Shell, Uph. Seat and Poly Back One Piece	1
3	LLRF	Weldment, 4-Leg Caster Armless Chair Frame (see note)	1
	LLRF	Weldment, 4-Leg Glide Armless Chair Frame (see note)	1
4	46.6412.XX.X	Shroud, Stacking Chairs Under Seat	1
5	12.0011.X	Screw, M6 x 18mm Phillips Pan Head BosScrew	7
6	46.5397.XX.X	Bushing, Caster	4
7	46.4113.XX.A.X	Caster, Dual Surface	4
8	10.0244.X	Glide, 7/8" Felt Swivel (includes item 9)	4
	10.0242.X	Glide, 7/8" Steel Swivel (includes item 9)	4
	10.0243.X	Glide, 7/8" Nylon Swivel (includes item 9)	4
9	10.0250.X	Cap, Snap-Fit Felt Swivel Glide	4
	10.0248.X	Cap, Snap-Fit Steel Swivel Glide	4
	10.0249.X	Cap, Snap-Fit Nylon Swivel Glide	4
10	LLRSC	Seat, Upholstered	1
11	12.0511.X	Screw, #10-16 x 5/8" Phillips Truss Head	5

