

# Parts Diagram

LimeLite™ Seating

High-Density Armless Chair (Models LL71 & LL72)

December 2024

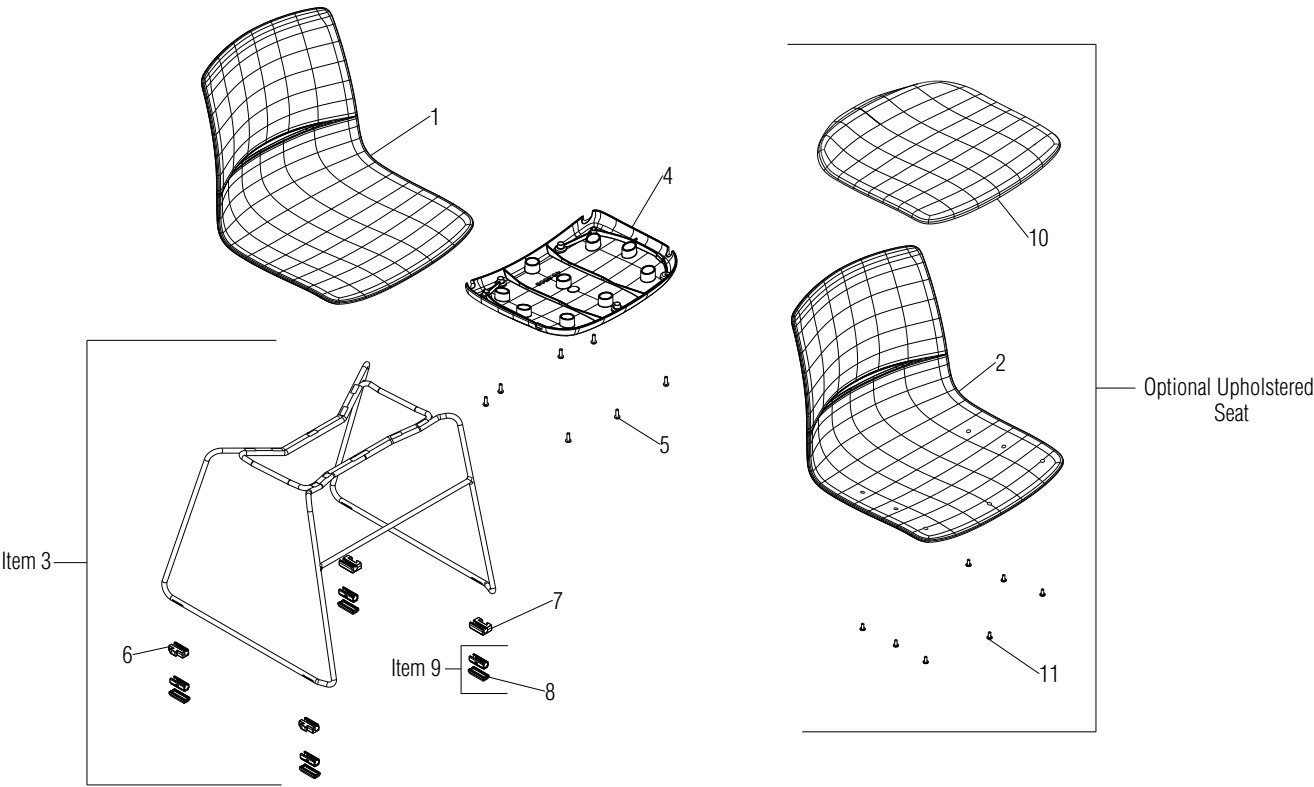

.XX = Select Color

Item 3 includes either Items 6 & 7, or item 9.

Item 9 includes Item 8.

Item 12 glide cap removal tool (not shown) is used to remove old glide caps for replacement. See KI-RR-000037 for Item 9 glide or glide cap replacement.

Item	Part Number	Item Description	Req Qty	Item	Part Number	Item Description	Req Qty
1	46.6401.XX.X	Shell, Poly Seat and Back One Piece	1	8	46.4331.X	Glide Cap, Sled Base Snap-Fit Felt	4
2	46.6401.XX.U.X	Shell, Uph. Seat and Poly Back One Piece	1		46.4338.X	Glide Cap, Sled Base Snap-Fit Steel	4
3	LLRF	Weldment, Wire Frame Chair (see note)	1		46.4337.X	Glide Cap, Sled Base Snap-Fit Poly	4
4	46.6509.XX.X	Shroud, Stacking Chairs Under Seat	1		46.4339.X	Glide Cap, Sled Base Snap-Fit Non-Skid	4
5	12.0011.X	Screw, M6 x 18mm Phillips Pan Head BosScrew	7	9	46.4330.X	Assembly, Snap-Fit Felt Glide (see note)	4
6	06.0490.M.X	Glide, Polycarbonate, Male Ganging	2		46.4342.X	Assembly, Snap-Fit Steel Glide (see note)	4
	06.0495.M.X	Glide, Stainless Steel, Male Ganging	2		46.4344.X	Assembly, Snap-Fit Poly Glide (see note)	4
7	06.0490.F.X	Glide, Polycarbonate, Female Ganging	2		46.4343.X	Assembly, Snap-Fit Non-Skid Glide (see note)	4
	06.0495.F.X	Glide, Stainless Steel, Female Ganging	2	10	LLRSC	Seat, Upholstered	1
				11	12.0511.X	Screw, #10-16 x 5/8" Phillips Truss Head	5
				12	10.0138.X	Removal Tool, Glide Cap (not shown) (see note)	1

