

Parts Diagram

Apply™ Armless Task Chair

February 2024

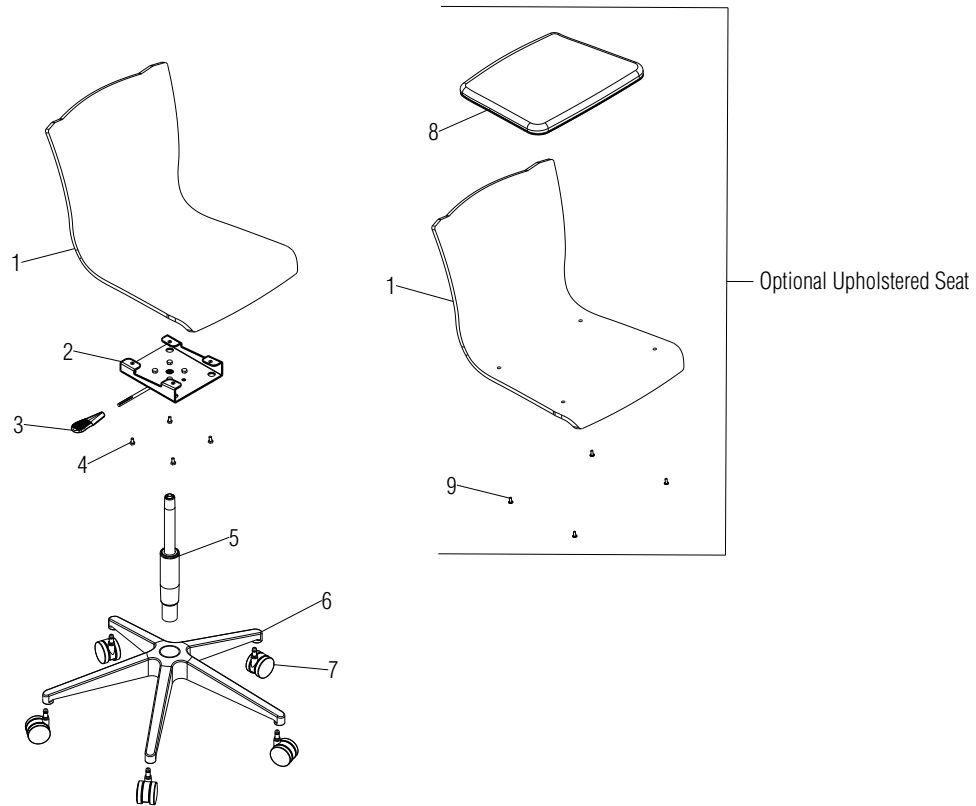

.LXX = Select Laminate
ARSC includes 12.1160.X
15.1084.D uses 46.2995.XX.X.
15.1078.X uses SIFT.015.X.

Item	Part Number	Item Description	Req Qty
1	APRLS	Assembly, Molded Plywood Seat	1
	APRLS	Assembly, Molded Plywood Seat w/ Upholstery	1
2	87.0458.BL.X	Assembly, Apply Pedestal Spider & Mechanism	4
3	PT.06.6040.BL.X	Handle, Pedestal	1
4	12.0565.X	Screw, 1/4-20 x 1/2" Hex Head with Nylok	1
5	15.1084.D	Cylinder, Pneumatic Height Adjustment, Type D (used with plastic base)	1
	15.1078.X	Cylinder, Gas Seat Height Adjustment (used with aluminum base)	1
6	46.2995.XX.X	Base, 5 Blade Pedestal Stool	1
	SIFT.015.X	Aluminum Base, Apply Task Chair	1
7	09.0440.BL.X	Caster, 60mm Diameter Carpet (black only)	5
	09.0441.BL.X	Caster, 60mm Diameter Hard Floor (black only)	5
8	ARSC	Assembly, Replacement Seat Cushion	1
9	12.1160.X	Screw, #12-16 x 1/2" #10 Truss Head	4

