

# Parts Diagram ■

Torsion® on the Go!®

Poly Back Nesting Arm Chair

February 2024

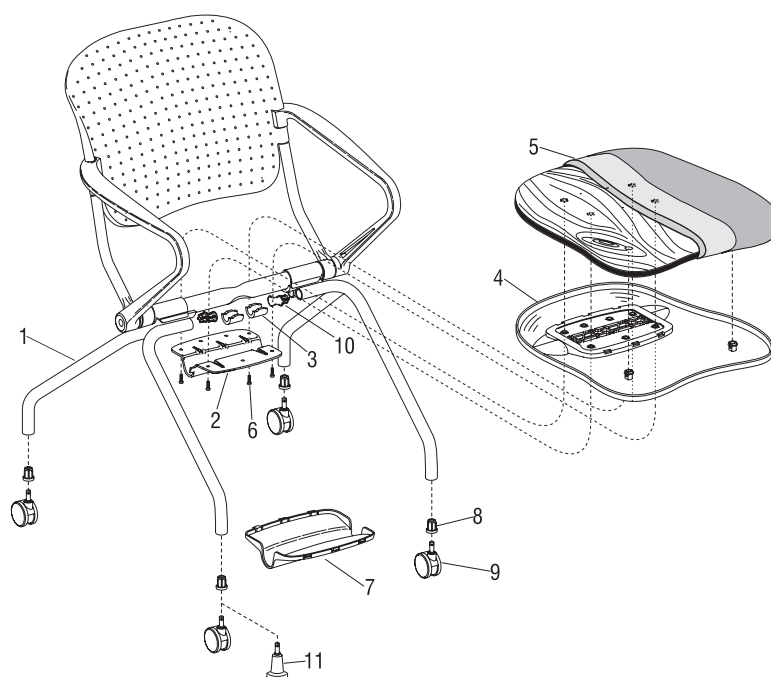

.XX = Select Color

PMR = Product Modification Request

Item	Part Number	Description
1	PMR	Replacement Chair (except seat)
2	PT.44.7005.ZN.X	Plate, Seat Support
3	PT.06.7007.X	Bushing, Seat Pivot
4	PT.06.7005.XX.X	Shroud, Seat
5	TGRC	Cushion and Board, Seat
6	12.0332.X	Screw, Seat Board, $\frac{5}{16}$ -18 x 1 $\frac{1}{4}$ "
7	PT.06.7006.XX.X	Shroud, Seat Support
8	46.5417.BL.X	Bushing, Caster
9	09.0440.BL.X	Caster, 60mm Diameter Carpet (black only)
	09.0441.BL.X	Caster, 60mm Diameter Hard Floor (black only)
10	46.0385.BL.X	Cap, Leg Tube
11	10.0150.X	Bell Glide