

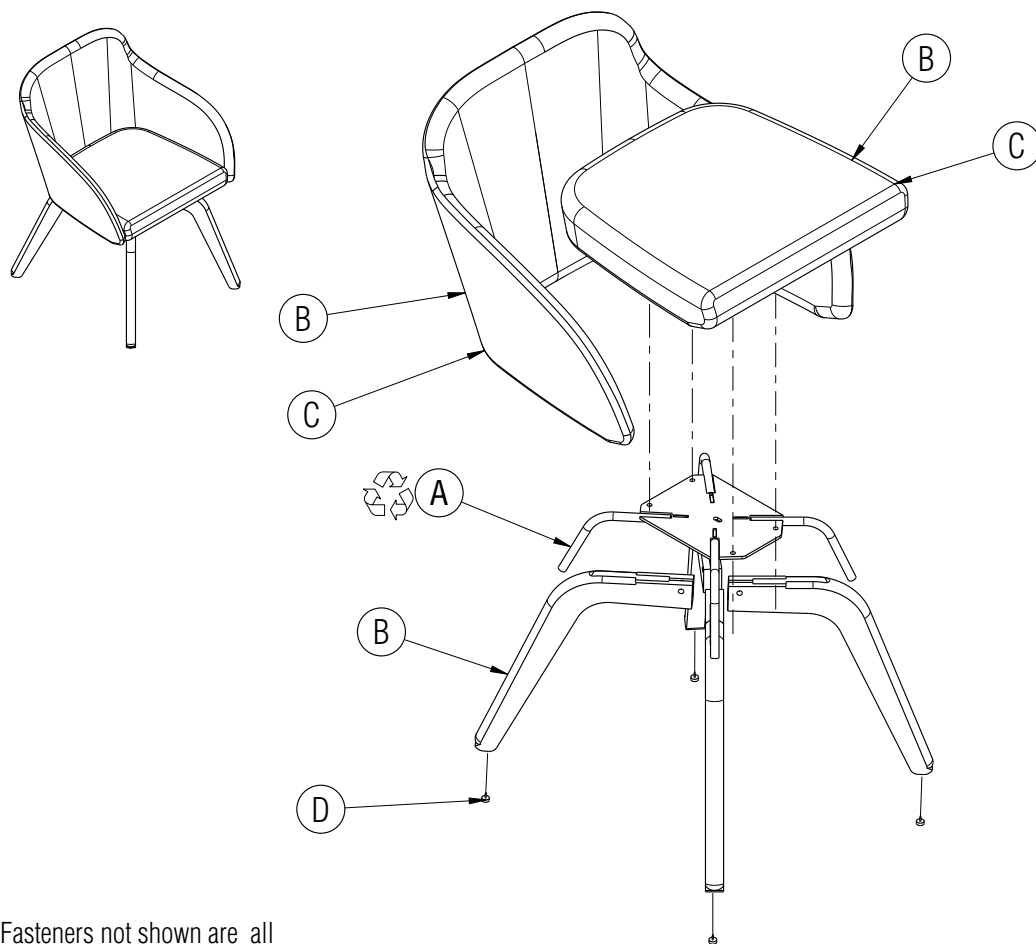

Disassembly Instructions

Calida Wood Leg Chair

Material Type: A . Steel B. Wood C. Foam/Fabric D. Plastic/Steel



 Fasteners not shown are all Material Type A: Steel.

Procedure:

1. Remove the seat bottom bolts from the leg assembly using the hex driver.
2. Remove the seat cushion from the seat assembly using the hex driver.
3. Cut away the fabric and scrape the foam from the wood seat and back shells.
4. Pry the glides from the base.
5. Cut the wood legs off of the base to expose the steel frame.

General Notes:

1. Disassembly time: 15-20 minutes
2. This procedure assumes basic familiarity with hand tools and furniture terminology: no specialized training is required
3. All materials removed and disassembled shall be sorted and segregated with like materials and disposed of or recycled according to recycling availability or waste acceptance
4.  For items to be recycled, refer to KI's End of Life Recycling Matrix and KI's End of Life Recovery Options Matrix, available at www.ki.com

Required Tools



Gloves



Safety Glasses

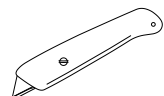

Utility Knife

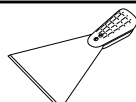

Putty Knife

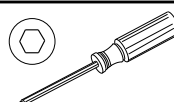

Metric Hex Driver

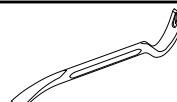

Pry Bar

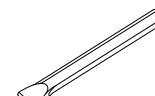

Cold Chisel



Claw Hammer