

Disassembly Instructions



Jubilee Lounge Seating

Material Type: A .Steel B. Wood C. Foam D. Fabric E. Plastic F. Other

Procedure:

1. Remove screws and washers attaching legs and seat(s) to frame and remove legs and seat(s). Remove screws attaching electrical accessories (if present) and remove accessories.
2. Cut fabric from seats and frame and remove. Scrape off foam from seats and frame.
3. Remove any metal springs, clips and fasteners from seats and frame.
4. Remove all webbing and plastic from frame.
5. Remove glides from metal legs. Plastic feet may be separated from the steel stem.
6. Electrical accessories may be broken down into metal housing, wire and internal components

General Notes:

1. Disassembly time: 45-60 minutes.
2. This procedure assumes basic familiarity with hand tools and furniture terminology: no specialized training is required.
3. All materials removed and disassembled shall be sorted and segregated with like materials and disposed of or recycled according to recycling availability or waste acceptance.
4. For items to be recycled, refer to KI's End of Life Recycling Matrix and KI's End of Life Recovery Options Matrix, available at www.ki.com

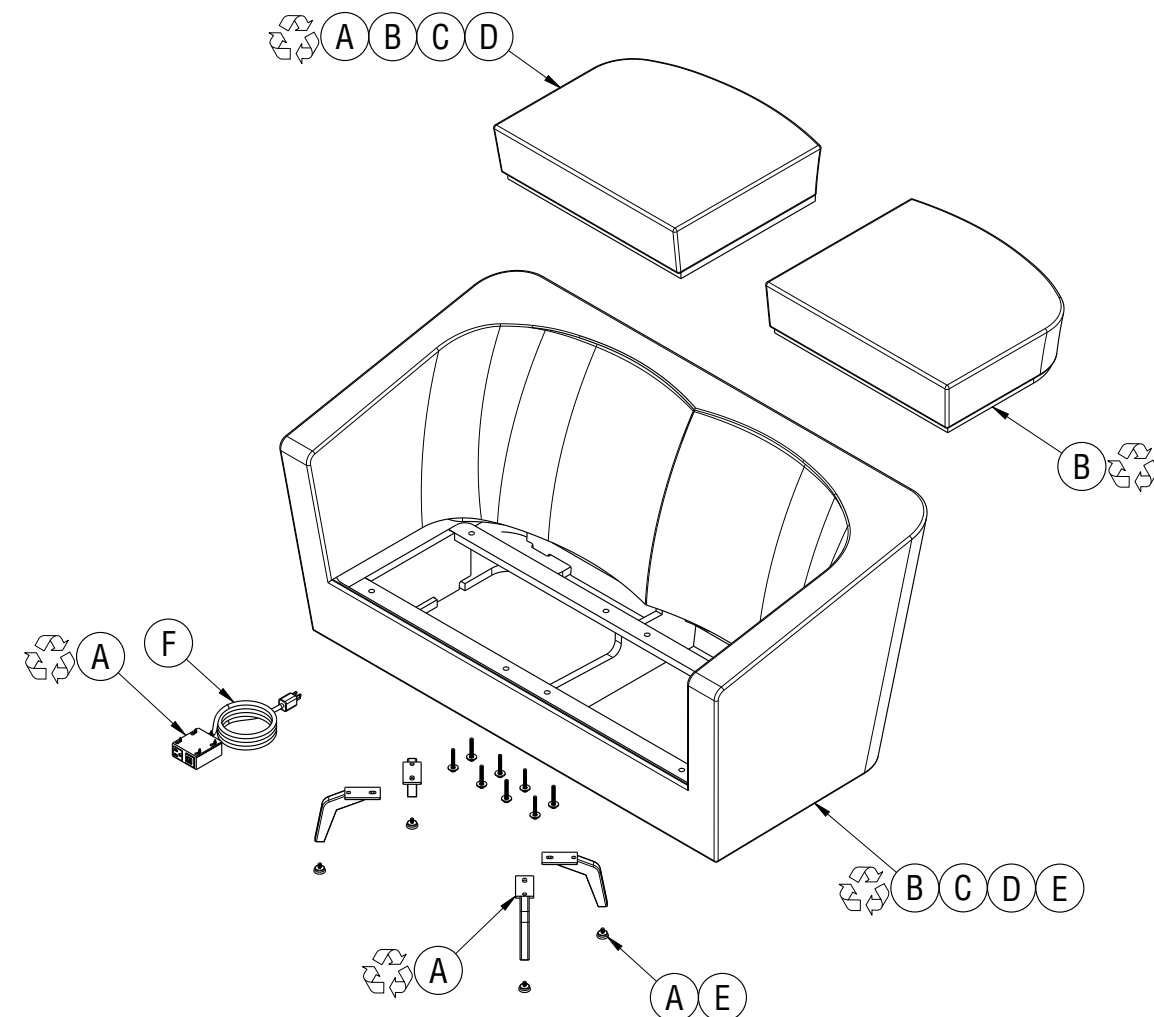

All fasteners not explicitly tagged are Material Type A: Steel



Required Tools

