

Disassembly Instructions

Sleeper / Sofa: Affina, LaResta

Material Type: A. Steel B. Wood C. Foam D. Plastic E. Fabric F. Aluminum/Alloy

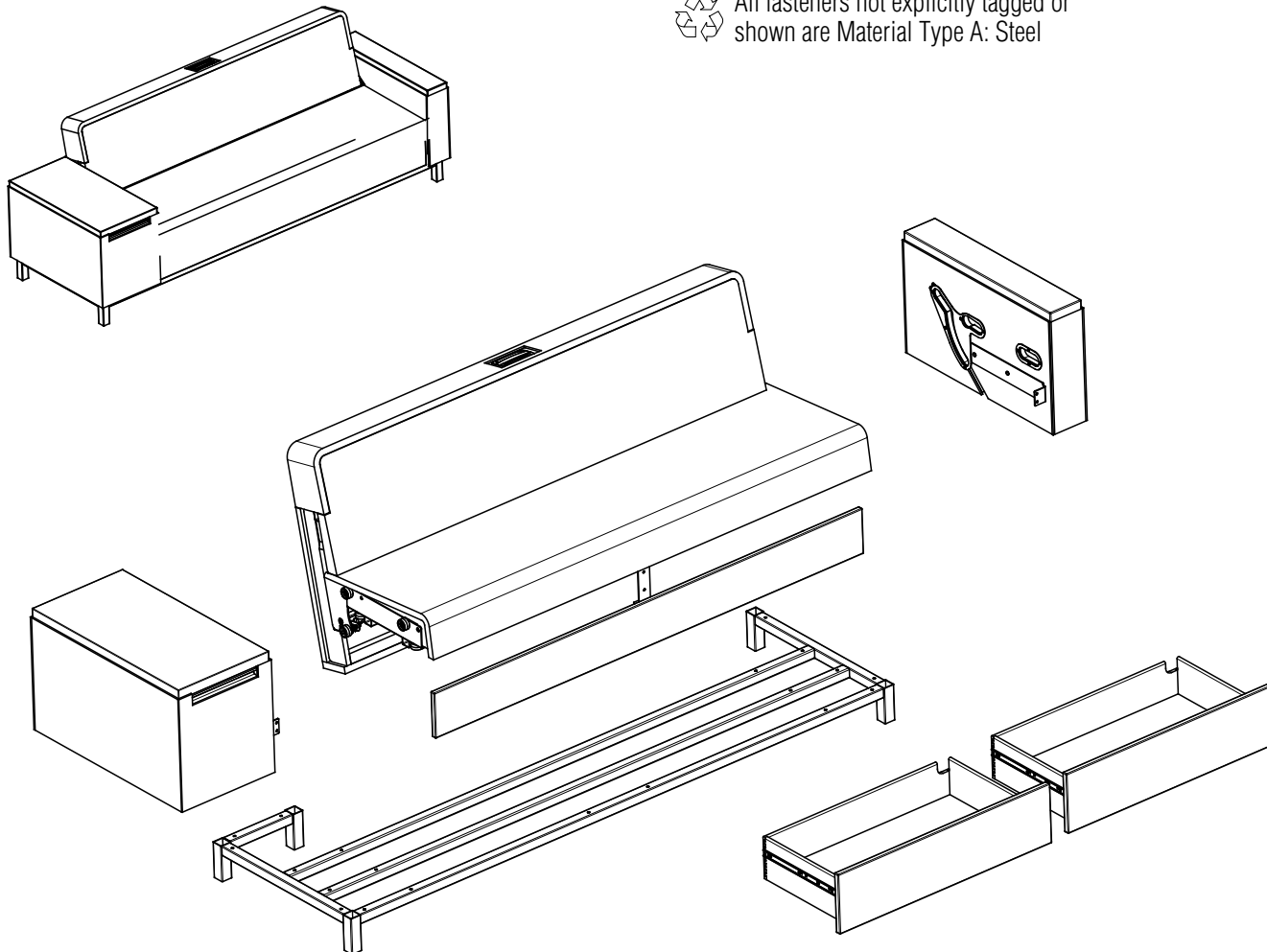

All fasteners not explicitly tagged or shown are Material Type A: Steel

Procedure:

1. Pull out any drawers if present and remove all steel slides, brackets and hardware from the drawers.
2. Remove all screws holding bed frame, arms, or storage arms and set these larger assemblies aside.
3. Separate bed back and seat from frame and arms or side supports
4. Dismantle storage arms. Remove door, alloy hinges, aluminum door pulls, veneer or laminated top caps, internal plastic liner panels and all steel brackets.
5. Dismantle back and seat, separating wood from metal components.
WARNING: DAMPING CYLINDER IS UNDER PRESSURE! HANDLE WITH CAUTION.
6. Cut and remove any fabric from the seat and back.
7. Cut away or scrape any foam from seat and back to expose any steel hardware or brackets. Any actuator cables may be cut for removal. Recycle aluminum and alloy actuator handle components.
8. Remove plastic rollers from bed frame and plastic leg glides from legs.
9. Separate all remaining steel from wood components and recycle or discard as required.

General Notes:

1. Disassembly time: 50-60 minutes
2. This procedure assumes basic familiarity with hand tools and furniture terminology: no specialized training is required
3. All materials removed and disassembled shall be sorted and segregated with like materials and disposed of or recycled according to recycling availability or waste acceptance
4. For items to be recycled, refer to KI's End of Life Recycling Matrix and KI's End of Life Recovery Options Matrix, available at www.ki.com



Required Tools



Gloves



Safety Glasses

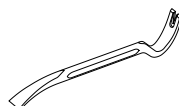

Pry Bar

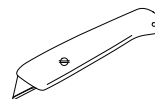

Utility Knife

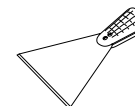

Putty Knife

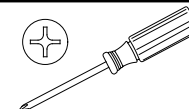

Phillips Screwdriver

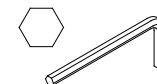

Allen Wrench

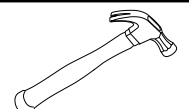

Claw Hammer

Disassembly Instructions



Sleeper / Sofa: Affina, LaResta

Material Type: A. Steel B. Foam C. Wood D. Plastic E. Fabric F. Aluminum/Alloy

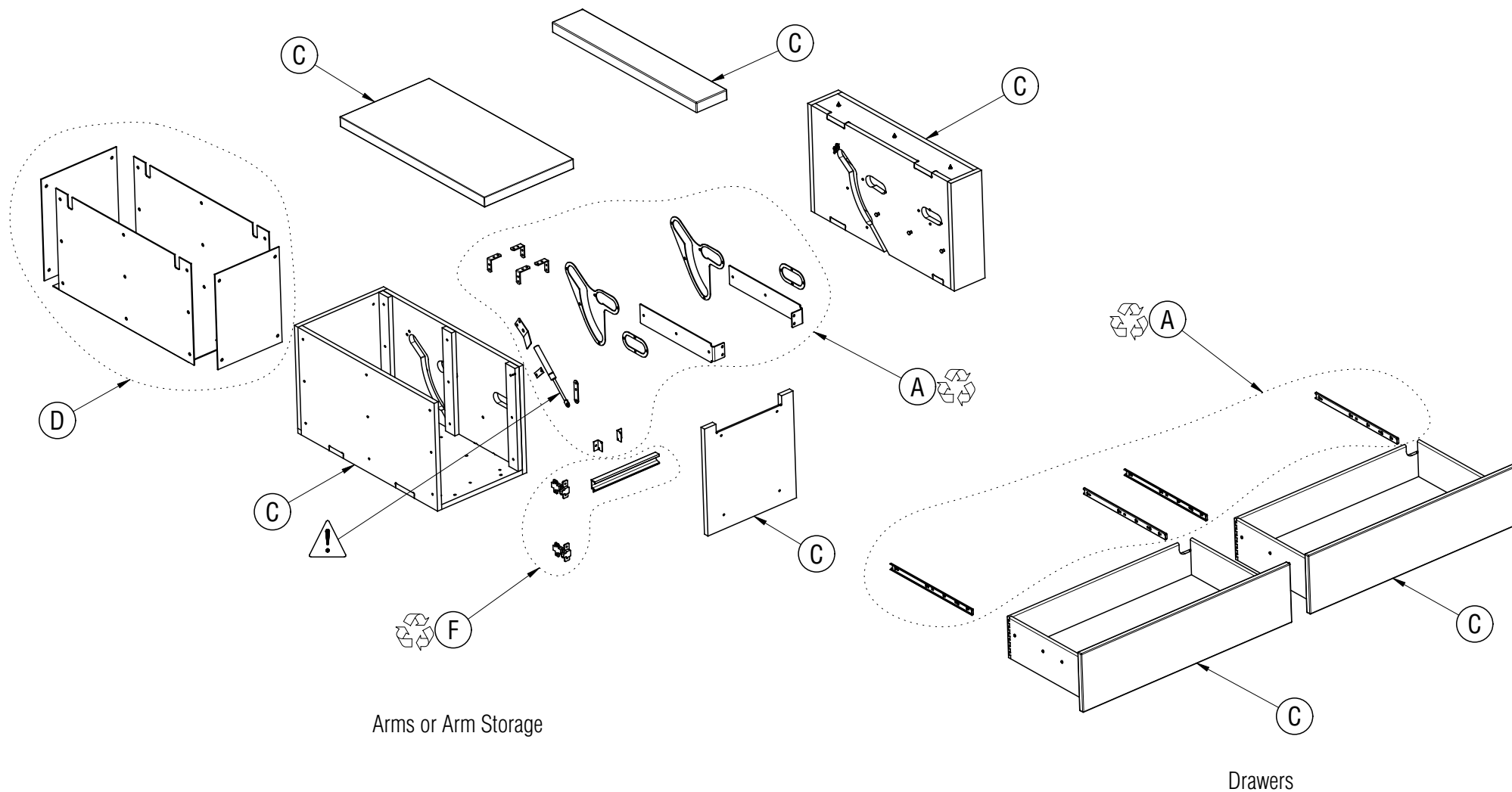

Required Tools

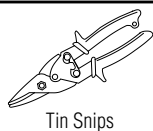

Robertson Screwdriver

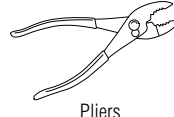

Disassembly Instructions



Sleeper / Sofa: Affina, LaResta

Material Type:	A. Steel	B. Foam	C. Wood	D. Plastic	E. Fabric	F. Aluminum/Alloy
----------------	----------	---------	---------	------------	-----------	-------------------

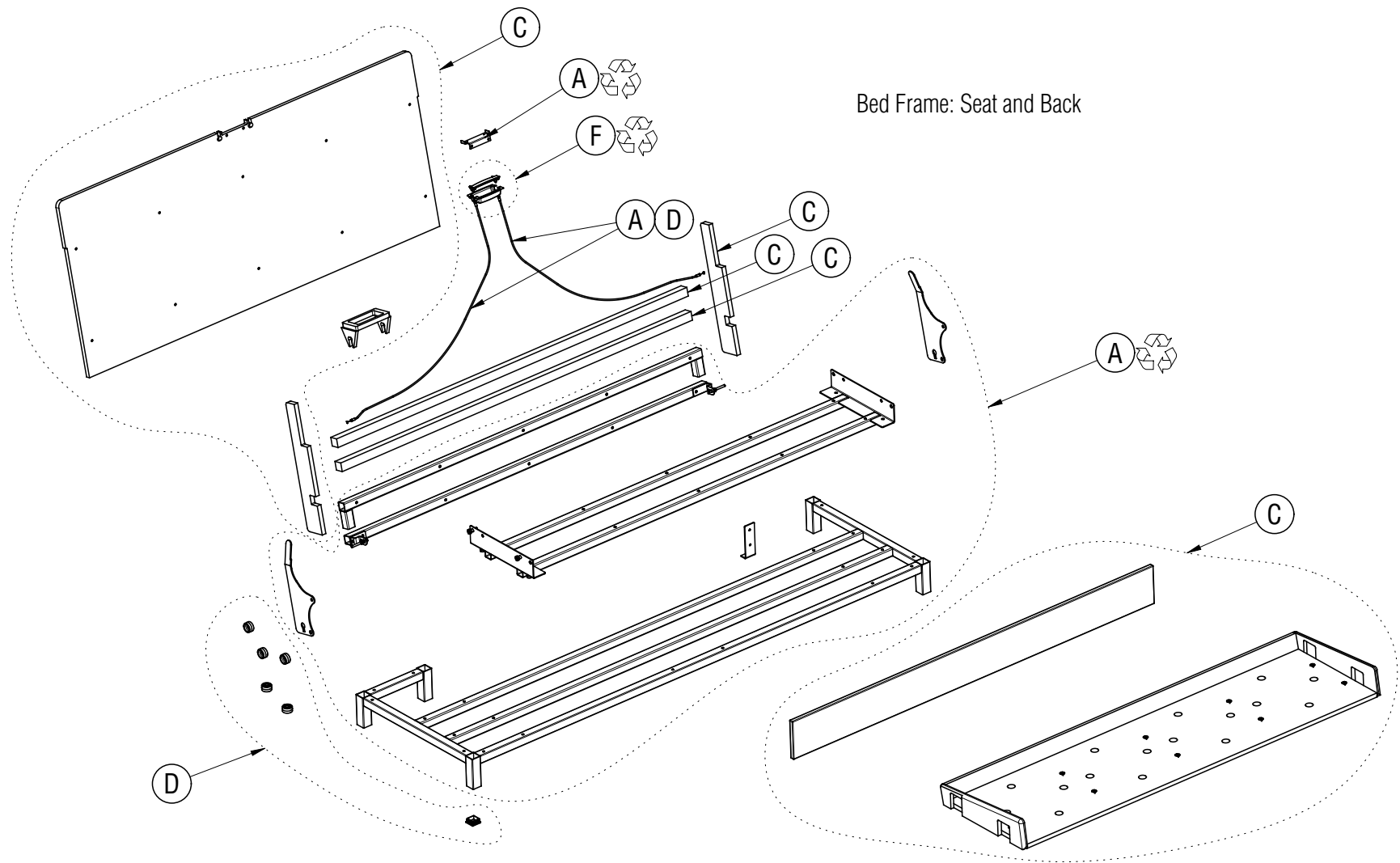

Required Tools