

Operating Instructions ■

Affina® & Soltice® Recliners

Heat & Massage with USB Charger Option

February 2020

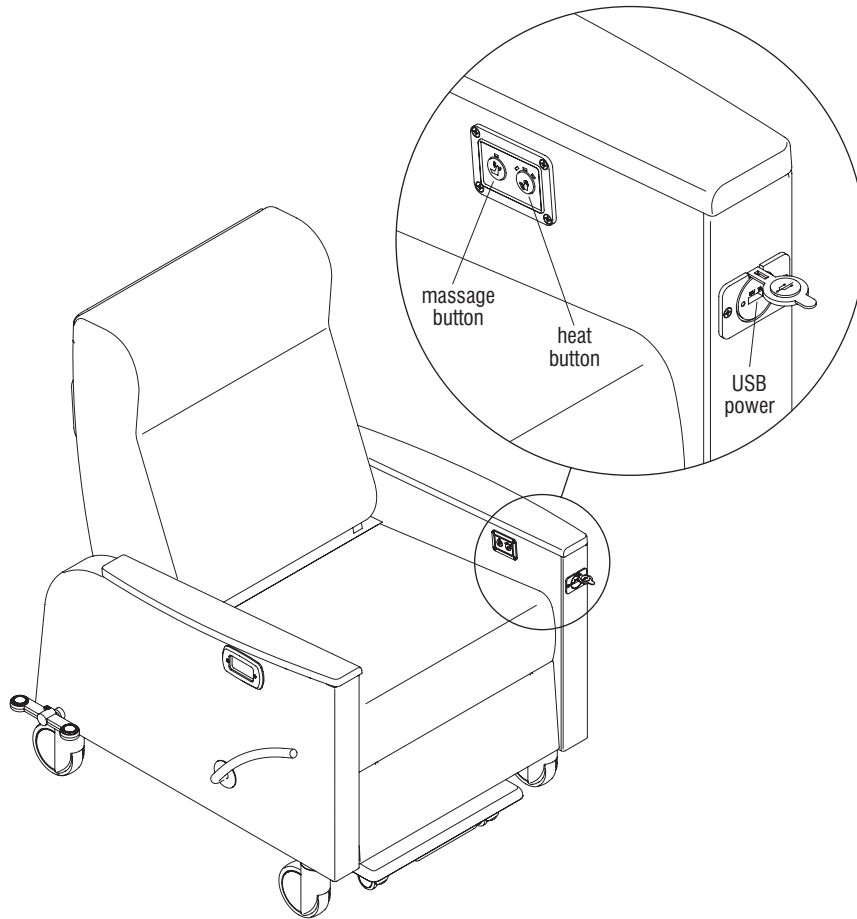

Note: The use of this product is not intended to offer any medical benefits, but rather supports relaxation, comfort and convenience (USB) to users.

Note: To operate, the power cord must be plugged into a grounded 15-AMP power outlet.

Massage Operation

1. Press the massage button once to activate the "First Push" vibrating massage option, the indicator light above the button will illuminate.

- First Push - Low intensity vibrating massage at low backrest position.
- Second Push - High intensity vibrating massage at low backrest position.
- Third Push - Low intensity vibrating massage at high backrest position.
- Fourth Push - High intensity vibrating massage at high backrest position.
- Fifth Push - Turns the vibrating massage option off.

The vibrating massage operates for fifteen minutes after initial massage button push, then it turns off automatically.

Heat Operation

1. Press the heat button one-to-three times, and the indicator lights above the button will indicate the level of heat.

- First Push - High heat level (39°C / 102°F).
- Second Push - Medium heat level (38°C / 101°F).
- Third Push - Low heat level (37°C / 99°F).
- Fourth Push - Turns heat off.

The heat operates for four hours after last button push.

USB Power Charger

1. Flip-up the USB cover to expose the USB Power Charger. A blue power light will illuminate to indicate that the USB port is operational.