

Parts Diagram

LimeLite™ Seating
4-leg Cafe Stool (Models LL41 & LL42)

March 2025

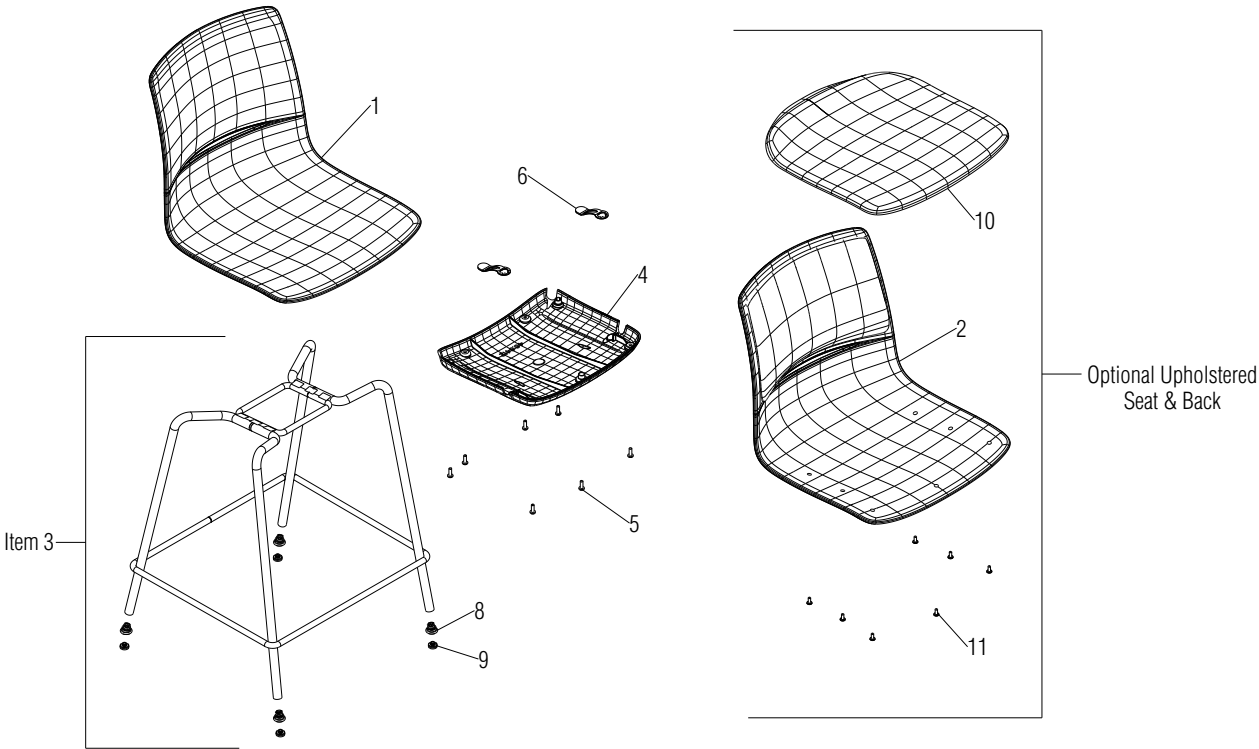

.XX = Select Color
Item 2 LLRBC will include shell with back upholstery and Items 10 & 11 installed.
Item 3 includes Items 8 & 9.
See KI-RR-000036 for glide and glide cap replacement.

| Item | Part Number | Item Description | Req Qty |
|------|----------------|---|---------|
| 1 | 46.6401.XX.X | Shell, Poly Seat and Back One Piece | 1 |
| 2 | 46.6401.XX.U.X | Shell, Uph. Seat and Poly Back One Piece (items 10 & 11 not included) | 1 |
| | LLRBC | Assembly, Uph. Seat and Uph. Back Shell (see note) | 1 |
| 3 | LLRF | Weldment, 4-Leg Glide 24" Cafe Frame (see note) | 1 |
| | LLRF | Weldment, 4-Leg Glide 30" Cafe Frame (see note) | 1 |
| 4 | 46.6412.XX | Shroud, Stacking Chairs Under Seat | 1 |
| 5 | 12.0011.X | Screw, M6 x 18mm Phillips Pan Head BosScrew | 7 |
| 6 | 46.6508 | Shim, Front Leg Shroud | 2 |
| 8 | 10.0247.X | Glide, 3/4" Felt Swivel (includes item 9) | 4 |
| | 10.0245.X | Glide, 3/4" Steel Swivel (includes item 9) | 4 |
| | 10.0246.X | Glide, 3/4" Nylon Swivel (includes item 9) | 4 |
| 9 | 10.0250.X | Cap, Snap-Fit Felt Swivel Glide | 4 |
| | 10.0248.X | Cap, Snap-Fit Steel Swivel Glide | 4 |
| | 10.0249.X | Cap, Snap-Fit Nylon Swivel Glide | 4 |
| 10 | LLRSC | Seat, Upholstered | 1 |
| 11 | 12.0511.X | Screw, #10-16 x 5/8" Phillips Truss Head | 5 |

