

Assembly Instructions ■

Medical & Laboratory Stool

Model KICLI 5

January 2011

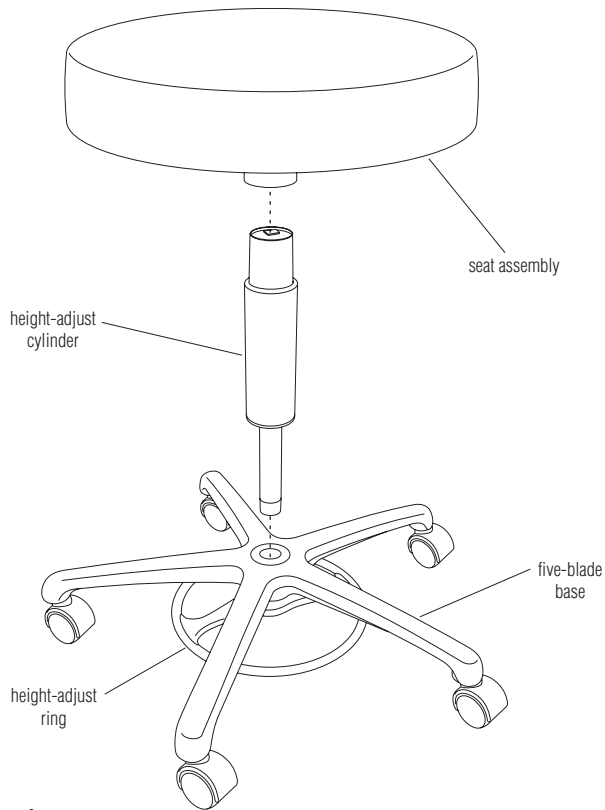

Figure 1

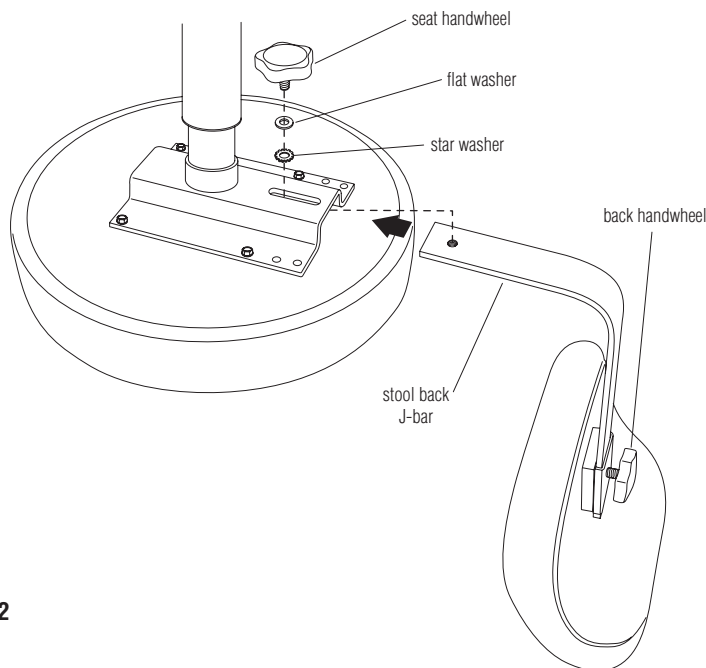

Figure 2

1. Carefully unpack all contents and place five-blade base onto floor. Press the smaller end of the height-adjust cylinder into the center hole of the five-blade base (Figure 1).
2. Align the hole in the bottom of the seat with the top of the height-adjust cylinder and press the seat assembly down firmly. Sit on the seat to completely drive the components together. Failure to do so could result in personal injury (Figure 1).
3. To install stool back, carefully turn seat/base assembly upside down on a clean elevated surface, such as a table top. Slide the J-bar of the stool back into the base of the stool (Figure 2).
4. Insert flat washer and star washer onto seat handwheel and insert threads of handwheel through slot in seat base, then thread into J-bar. Adjust to desired location and tighten seat handwheel (Figure 2).

Stool Operation

To adjust vertical height of seat, while sitting on stool use foot to press on height-adjust ring (Figure 1), then release weight or increase weight on seat to adjust height. To adjust vertical position of stool-back, loosen back handwheel, slide stool back to desired location and re-tighten back handwheel (Figure 2). To adjust stool back horizontal location, loosen seat handwheel at stool back, adjust location and re-tighten (Figure 2).