

Assembly Instructions ■

Uniframe® Convertible Bench

September 2023



Tools Required: 4mm Hex wrench, $\frac{3}{8}$ " ratchet wrench, $\frac{7}{16}$ " & $\frac{9}{16}$ " sockets, adjustable wrench.

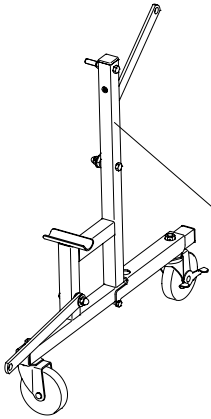

Support Leg Assembly
Right-hand
Qty. 1

Label on leg
L=Left- & R=Right-hand
Leg Assemblies

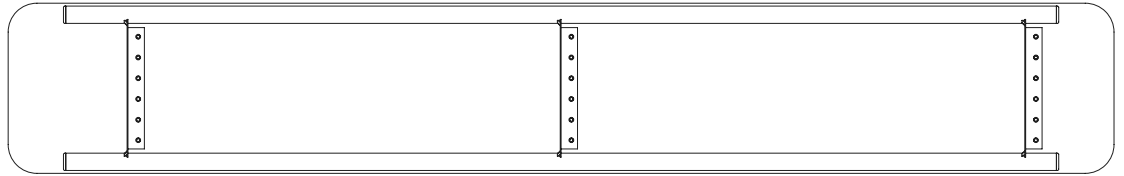

Top Assembly
Qty. 1

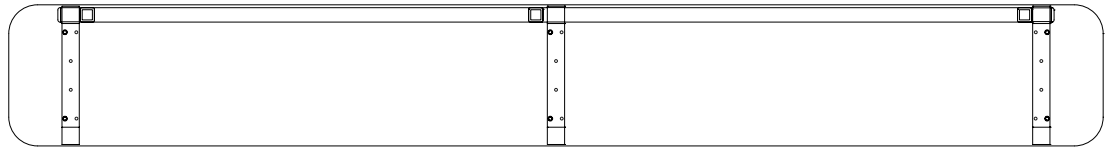

Bench Assembly
Qty. 1

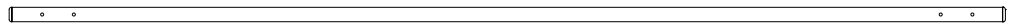

Main Horizontal Tube
Qty. 1

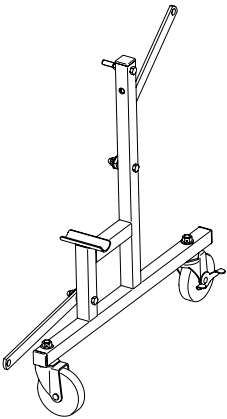

Support Leg Assembly
Left-hand
Qty. 1

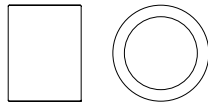

Item #1
Steel Spacer, .50" OD x .38" ID
Qty. 6

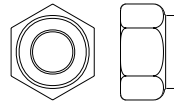

Item #2
Nut, $\frac{1}{4}$ -20 Nylon Lock
Qty. 4

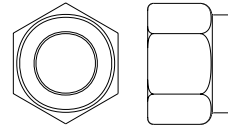

Item #3
Nut, $\frac{3}{8}$ -16 Nylon Lock
Qty. 4

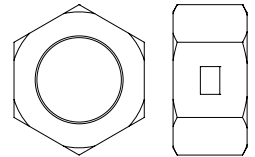

Item #4
Nut, $\frac{7}{16}$ -14 Center Lock
Qty. 4

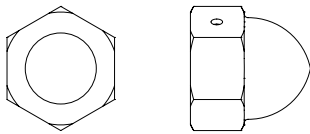

Item #5
Nut, $\frac{3}{8}$ -16 UNC Acorn
Qty. 2

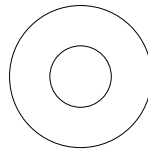

Item #6
Flat Washer, $\frac{1}{4}$ " SAE
Qty. 4

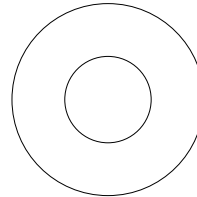

Item #7
Flat Washer, $\frac{3}{8}$ " SAE
Qty. 12

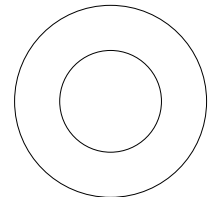

Item #8
Flat Washer, $\frac{1}{2}$ " Nylon
Qty. 4

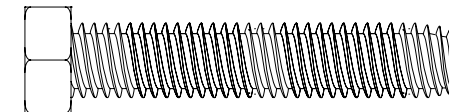
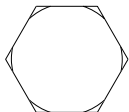

Item #9
Hex Bolt, $\frac{3}{8}$ -16 x 2 $\frac{1}{8}$ " HHCS
Qty. 2

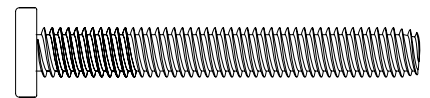

Item #10
Socket Cap Screw, $\frac{1}{4}$ -20 x 2" Button Head
Qty. 4

■ Uniframe® Convertible Bench Assembly Instructions

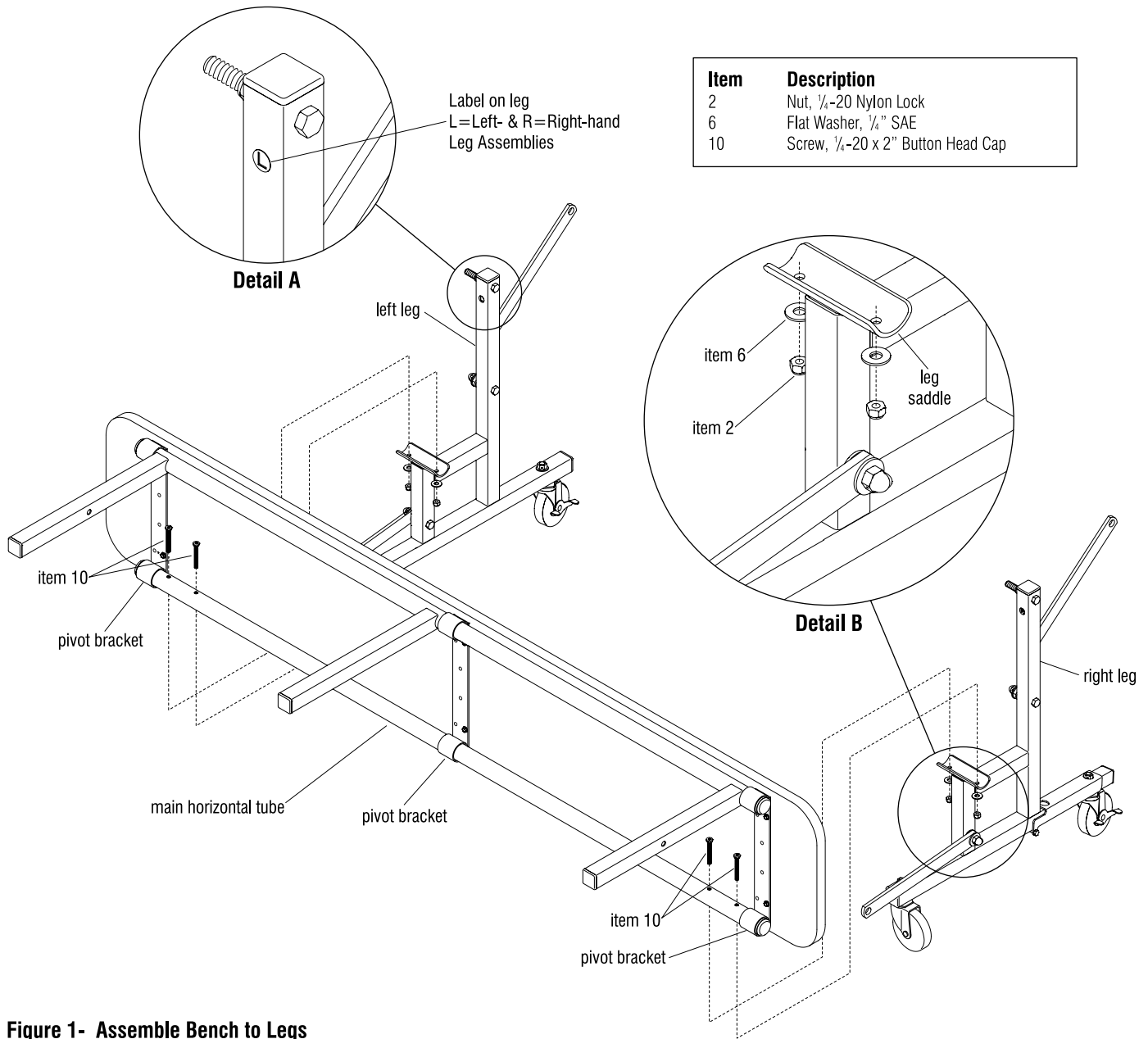

Figure 1- Assemble Bench to Legs

1. Identify right- & left-hand support leg assemblies by labels on upper support member (Figure 1 & Detail A).
2. Insert main horizontal tube through the pivot brackets in each bench assembly (Figure 1).
3. Insert four 1/4-20 x 2" screws (item 10) into main horizontal tube (Figure 1).
4. Place bench assembly with main tube onto leg saddles.
5. Align item 9 screws with holes and attach bench assembly with 1/4" flat washers (item 6) and 1/4-20 nylon lock nuts (item 2) (Figure 2 & Detail B).

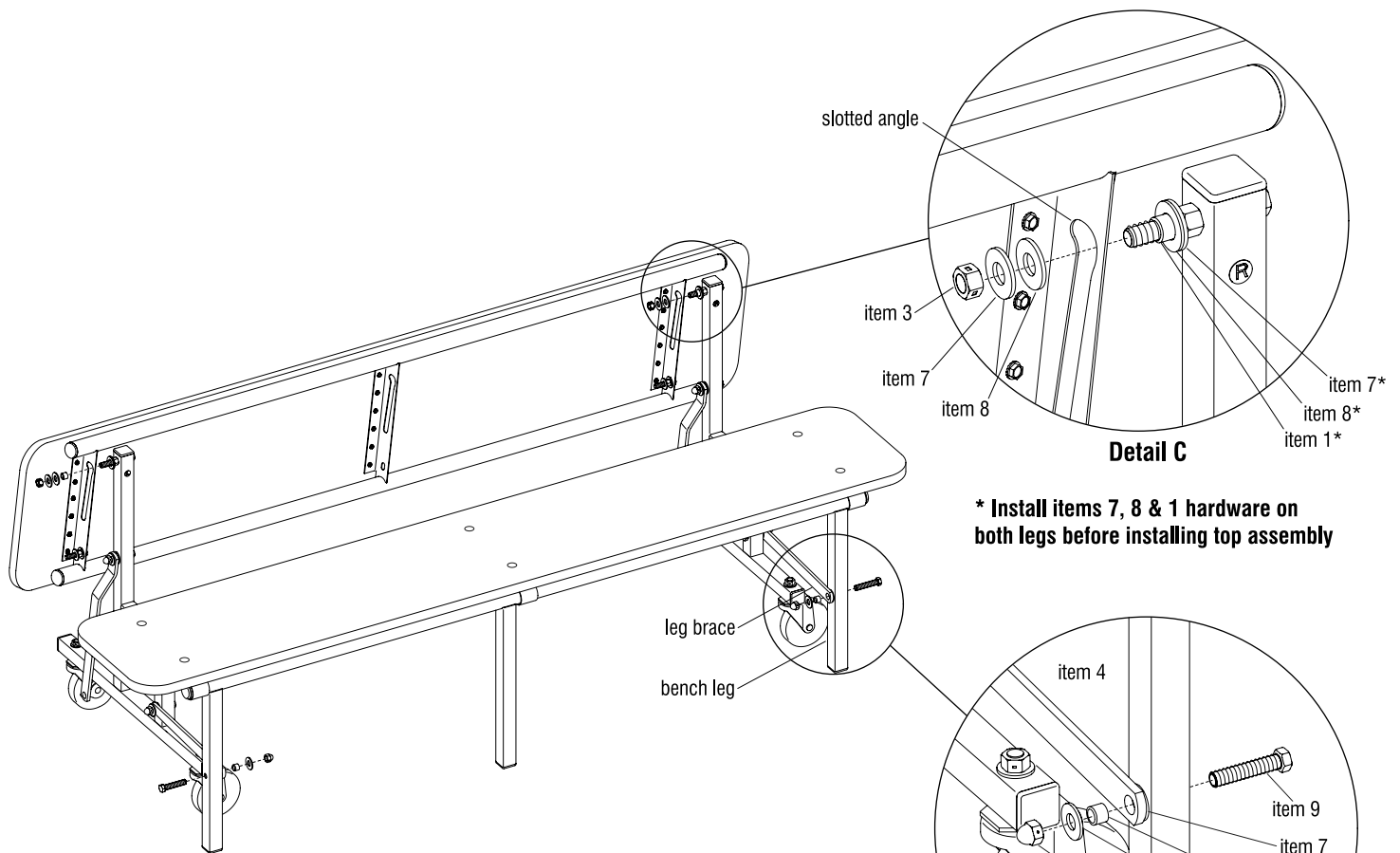

Figure 2 - Braces to Top, Legs & Bench Assembly

Item	Description
1	Steel Spacer, .50" OD x .38" ID
3	Nut, 3/8"-16 Nylon Lock
4	Nut, 7/16"-14 Center Lock
5	Nut, 3/8"-16 UNC Acorn
7	Flat Washer, 3/8" SAE
8	Flat Washer, 1/2" Nylon
9	Hex Bolt, 3/8"-16 x 2 1/8" HHCS

Detail B

Bench Legs to Bench Brace
*Steel spacers allow the fasteners to tighten without restricting movement at pivot points

1. Install leg braces to bench legs using hardware installed in sequence shown (Figure 2 & Detail B).
2. At top of leg uprights, install 3/8" flat washer (item 7), 1/2" nylon washer (item 8) and 3/8" steel spacer (item 1) onto leg bolts in sequence shown (Detail C).
3. Install top assembly through both slotted angles, over the spacers on bolts as illustrated (Detail C).
4. Install 1/2" nylon washer (item 8), 3/8" flat washer (item 7) and 3/8"-16 nylon lock nut (item 3) onto bolts, and steel spacer (item 1), then tighten (Detail C).

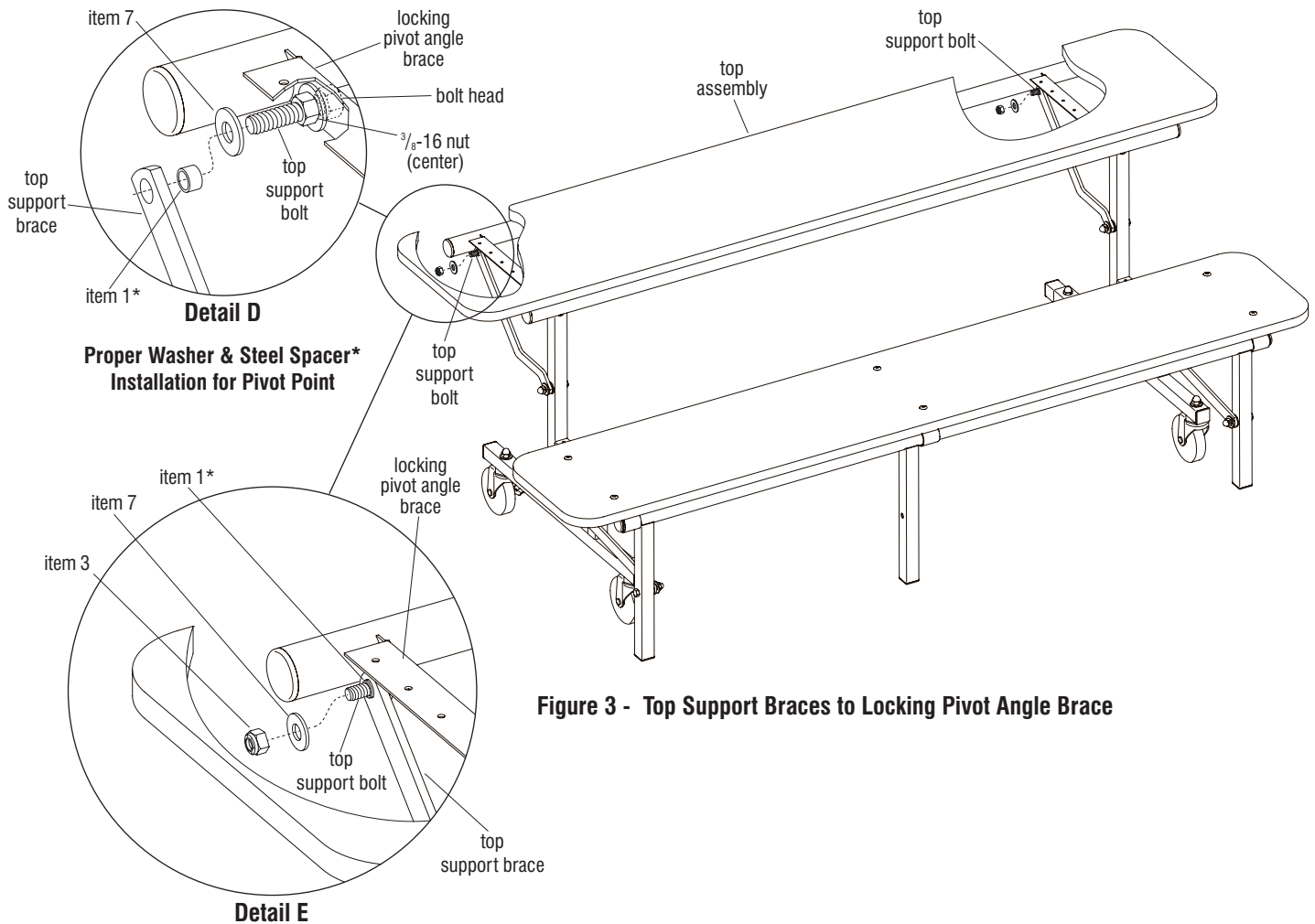

Figure 3 - Top Support Braces to Locking Pivot Angle Brace

Top Support Braces to Locking Pivot Angle Brace
***Steel spacers allow the fasteners to tighten without restricting movement of pivot points**

Item	Description
1	Steel Spacer, 1/2" OD x 3/8" ID
3	Nut, 3/8-16 Nylon Lock
7	Flat Washer, 3/8" SAE

1. Place a flat washer (item 7) and steel spacer (item 1) onto the top support bolt at each end, under the top assembly as illustrated (Figure 3 & Detail D).
2. Rotate top assembly up (Figure 3). Then rotate both top support braces up and locate each mounting hole onto the apron bolts. Spacers* go into each brace hole (Figure 3 & Detail D).
3. At each top support bolt with brace and spacer, install a flat washer (item 7) onto the bolt, then twist on and tighten a nut (item 3) (Figure 3 & Detail E).

Note: Steel spacers act as bearings and allow the fasteners to tighten without restricting movement of brace pivot points.

Note: If the top surface is not level once the top support brace is attached to the top support bolt, adjustments can be made at both ends under the top surface. The "top support" bolt is secured at the factory into a slotted hole in the "locking pivot angle brace" and this slot allows up to 5/8" of adjustment.

4. To adjust the top support bolt on the locking pivot angle brace, first loosen the outermost nut (Detail E) on the top support bolt (installed in step 3). Next use two 9/16" wrenches, one to hold the bolt head (Detail D) and another to loosen the center nut (Detail D). Adjust the table to level, then re-tighten the center nut and bolt head which pinch the pivot angle brace first. Next, tighten the outermost nut on the top support bolt (Detail E). Repeat this procedure at the other end of the top assembly as necessary (Figure 3, Details D & E).

KI
1330 Bellevue Street
Green Bay, Wisconsin 54302
1-800-424-2432
www.ki.com

KI is a registered trademark
of Krueger International, Inc.

© 2023 Krueger International, Inc.
All Rights Reserved
Code KI-61586R15/KI/PDF/0923

Part # 13.7709

