

Disassembly Instructions

Trellis System

Material Type: A. Steel B. Plastic C. Laminate

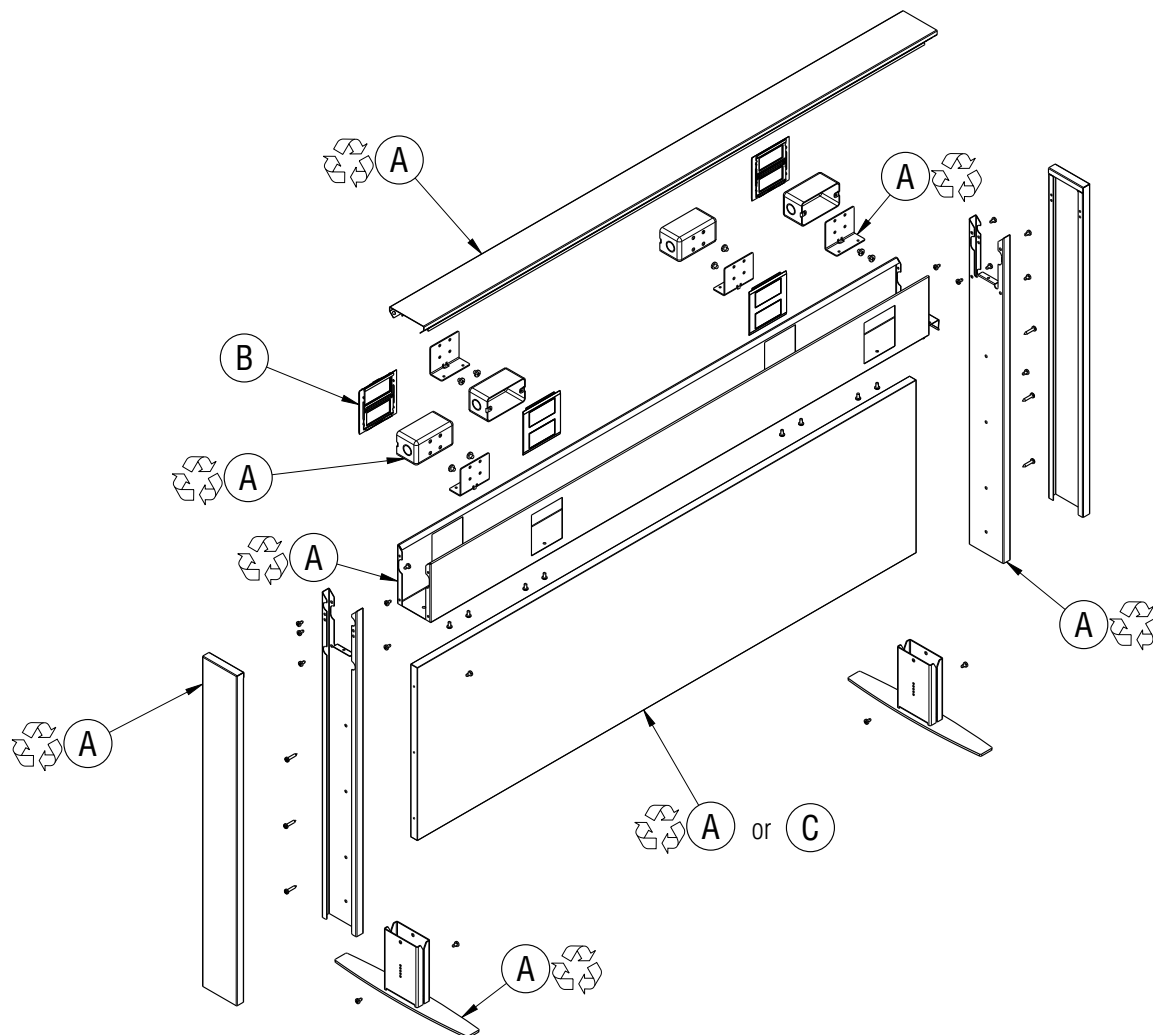

All fasteners not explicitly tagged are Material Type A: Steel

Procedure:

1. Lift off the top cover. Pull on each side of cover to get off trough.
2. Pull off the end covers. Remove screws holding side covers to channel.
3. Remove screws on sides of foot. Pull foot off of channel.
4. Remove screws on bottom of electrical box and trough. Pull out bezels, bracket and electrical box from trough.
5. Remove screws from both channels and trough.
6. Remove screws from insert.

General Notes:

1. Disassembly time: 15-20 minutes
2. This procedure assumes basic familiarity with hand tools and furniture terminology: no specialized training is required
3. All materials removed and disassembled shall be sorted and segregated with like materials and disposed of or recycled according to recycling availability or waste acceptance
4. For items to be recycled, refer to KI's End of Life Recycling Matrix and KI's End of Life Recovery Options Matrix, available at www.ki.com

Required Tools

