

Assembly Instructions ■

700 Series® Desking

D-Shape Desk

February 2020

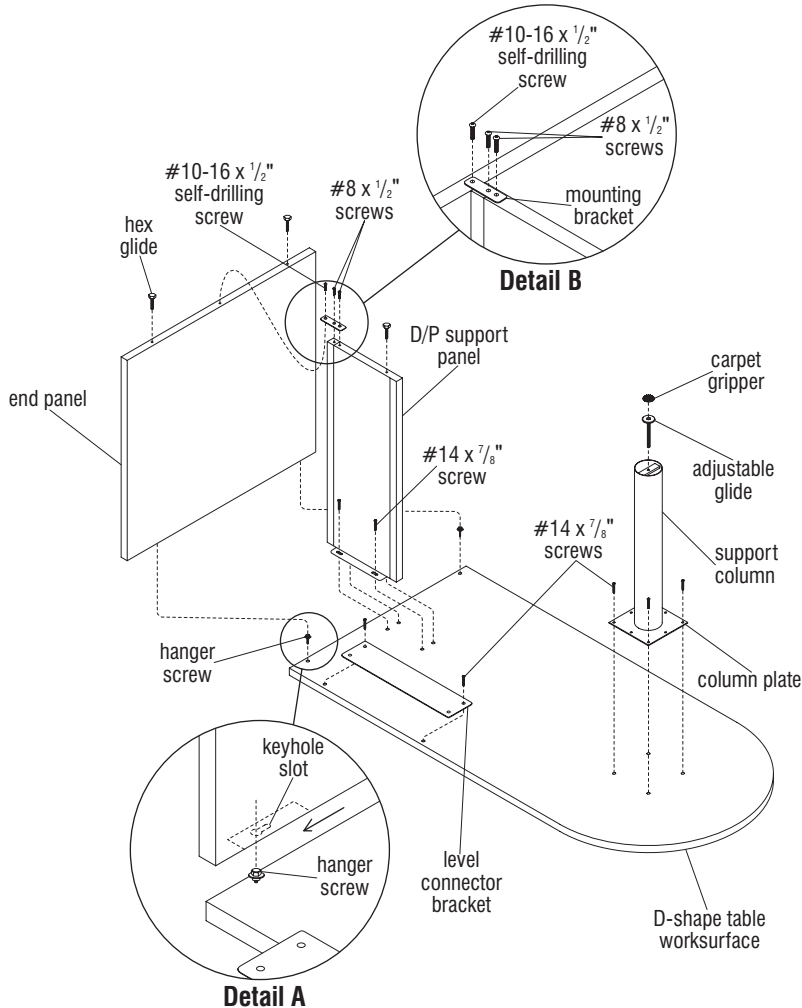

Figure 1



Assemble units as described herein only. To do otherwise may result in instability. All screws, nuts and bolts must be tightened securely and must be checked periodically after assembly. Failure to assemble properly, or to secure parts may result in assembly failure and personal injury.

The D-shape desk tables come in different depths and widths but the assembly of the components are the same.

Important: Assembled D-Shape Desks must be ganged to adjoining desking. Product not intended to be used as a stand alone desk.

1. Place the table worksurface down on a soft surface to avoid scratching.
 2. As illustrated, install two hanger screws into the pre-drilled holes on the underside of the table (Detail A).
 3. Carefully position keyhole slots of the end panel onto the hanger screws and slide it into position.
 4. Place the D/P support panel with the flange bracket side down over the pre-drilled holes and secure using four #14 x 7/8" screws.
 5. Position the small three-hole mounting bracket on the D/P support panel and secure using two #8 x 1/2" screws (Detail B). Then secure the small three-hole mounting bracket to the end panel using one #10-16 x 1/2" self-drilling screw.
 6. Position the support column with the column plate over the pre-drilled holes and secure using four #14 x 7/8" screws. Then twist the adjustable glide into the bottom of the support column.
- Note:** Height adjustment of the adjustable glide on the support column may be necessary for the surface of the D-shape table to mate properly with the main table.
7. If required, install a carpet gripper into the bottom of the adjustable glide.
 8. Twist two hex glides into the two glide nuts located on the bottom of the end panel. Then twist one hex glide into the glide nut located on the bottom of the D/P support panel.
 9. If not already installed, position the level connector bracket over the pre-drilled holes on the underside of the table and secure using two #14 x 7/8" screws.
 10. Carefully turn the D-shape table assembly right side up for the final assembly.

