

Kaleid building blocks





Table of contents

Overview	3
Open/board storage	4
Open shelving/closed shelving	5
Planters/liner	6-7
Media unit	8
Workstations	9-12
Ezel	13



Overview

- Widths: 38.5"w, 55.5"w, 76.5"w
- Height: 76"h
- Depth: 22"d
- Heavy duty locking casters
- Optional ganging kit, connects top of units
- For units with back panels: 38.5" and 55.5"w will be single panel width, 76.5"w will be double panel width
- Posts: Stain on solid ash, painted on solid beech
- Shelves/planter boxes: TFL, HPL or veneer
- Aluminum shelf frames: standard or studio powder coat
- Kaleid can be used with Ezel markerboards, see Ezel reference page

Elevation



38.5"w
single back panel



55.5"w
Single back panel

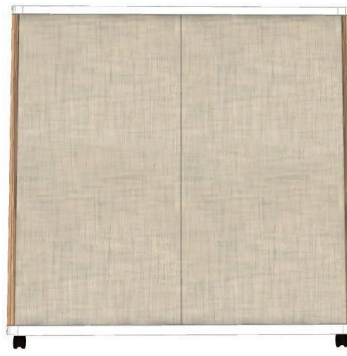

76.5"w
Double back panel

Ganging

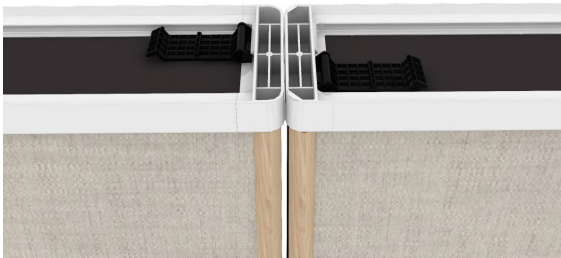

Not ganged



Ganged

Open/board storage

- Back panel material options:
 - **Note:** Face is on exterior of unit, back is on interior
 - Finished face and back (TFL, HPL or veneer)
 - Upholstered face/finished back (TFL, HPL or veneer)
 - Upholstered face and back
- **Note:** Finished face and back, and upholstered face and back options cannot be contrasting materials
- 38"w and 55"w will have a total of two panels, one per side
- 76"w will have a total of four panels, two per side. Side by side panels to be specified in same finish.
- Optional interior storage insert, for use with Ezel markerboards
 - 38"w holds two markerboards vertically
 - 55"w holds two markerboards vertically
 - 76"w holds six markerboards horizontally, four in bottom section and two in upper section



13-38WP



13-55WP



13-76WP



13-38WP
-with optional board storage
-boards specified separately



13-55WP
-with optional board storage
-boards specified separately



13-76WP
-with optional board storage
-boards specified separately

Open shelving

- Shelving specified as one finish, cannot be contrasting materials
- Shelving accessible from both sides



13-38SS



13-55SS



13-76SS

Closed shelving

- Back panel material options:
 - **Note:** Face is on exterior of unit, back is on interior
 - Finished face and back (TFL, HPL or veneer)
 - Upholstered face/finished back (TFL, HPL or veneer)
 - Upholstered face and back
 - Cork face/black back
- **Note:** Finished face and back, and upholstered face and back options cannot be contrasting materials
- Shelving specified as one finish, cannot be contrasting materials
- Shelving accessible from approach side only



13-38SSW



13-55SSW



13-76SSW



Back reference
13-55SSW shown

Single planter

- Optional planter liner
 - 13-38PB - 3 liners
 - 13-55PB - 4 liners
 - 13-76PB - 5 liners
- Top of planter box standard as BL3 black laminate



13-38PB



13-55PB



13-76PB

Double planter

- Optional planter liner
 - 13-38DPB - 6 liners
 - 13-55DPB - 8 liners
 - 13-76DPB - 10 liners
- Top of planter box standard as BL3 black laminate



13-38DPB



13-55DPB



13-76DPB

Planter + shelving

- Optional planter liner
 - 13-38PBS - 3 liners
 - 13-55PBS - 4 liners
 - 13-76PBS - 5 liners
- Top of planter box standard as BL3 black laminate
- Shelving and planter box can be contrasting materials



13-38PBS



13-55PBS



13-76PBS

Planter liner

- Planter liners are optional, and are specified as an option within the model
- Planter liners have a self irrigation system
- Separate water reservoir that is filled every 12 weeks slowly disperses water to the plant
- Water is filled to the max line indicator
- Every third watering, water the plant from above to hydrate the substrate
- Instruction booklet comes with all liners



Planter liner

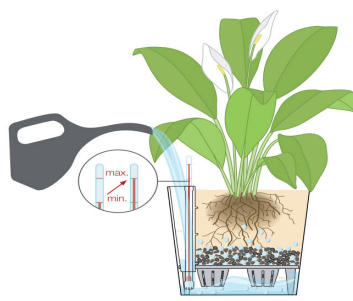

Watering detail



Watering detail

Media unit

- Widths: 38"w, 55"w, 76"w
- TV mounting structure included, tv mount not included.
Recommended max tv sizes per width:
 - 32" flat screen on 38"w unit
 - 50" flat screen on 55"w unit
 - 55" flat screen on 76"w unit
- **Note:** When adding a video conferencing system, smaller tv will be needed. 32.6"h overall mounting space available per unit, see mounting space elevation
- Molded plywood wire manager, standard in HPL or veneer
- Wire manager power supply: Two outlets, USB A and C, open data port. Available in white, fog or black
- Four convenience power outlets behind wire manager
- Storage bays: Four on 38"w and 55"w unit, six on 76"w unit
- Hinged door grommet on back for power/data access
- Optional 6' data cable
- Optional swivel tablet, 76"w model only. Post available in luster grey, bone white, or onyx
- Back panel material options:
 - **Note:** Face is on exterior of unit, back is on interior
 - Finished face and back (TFL, HPL, markerboard or veneer)
 - Upholstered face/finished back (TFL, HPL, markerboard or veneer)
 - Upholstered face and back
 - Cork face/black back
- **Note:** Finished face and back, and upholstered face and back options cannot be contrasting materials



13-38MP



13-55MP



13-76MP

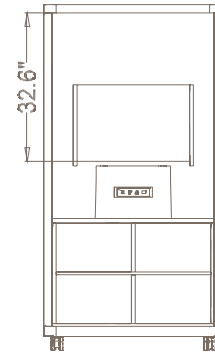

Mounting space elevation



13-76MP optional tablet detail
76"w only



Hinged door grommet on back
13-55MP shown

Workstation Single sided

- 24" d worksurface available with square or rounded corners, see worksurface options section
- Optional grommets and power inserts, see workstation power section section
- Worksurface hook and wire management available, see workstation accessories section
- **Note:** Finished face and back, and upholstered face and back options cannot be contrasting materials on each side
- Back panel material options:
 - **Note:** Face is on exterior of unit, back is on interior
 - Finished face and back (TFL, HPL, markerboard or veneer)
 - Upholstered face/finished back (TFL, HPL, markerboard or veneer)
 - Upholstered face and back
 - Cork face/black back



Desk height (38" w shown)
13-__WSW-D



Counter height (55" w shown)
13-__WSW-C



Bar height (76" w shown)
13-__WSW-B

Workstation Double sided

- 32" d worksurface is accessible from both sides
- Worksurface available with square or rounded corners
- Optional grommets and power inserts, see workstation power section
- Worksurface hook and wire management available, see workstation accessories section



Desk height (38" w shown)
13-__WS-D



Counter height (55" w shown)
13-__WS-C



Bar height (76" w shown)
13-__WS-B

Workstation Options

- Worksurfaces are available with square or rounded corners
- When rounded corners are selected on a single sided workstation, rounded corners will be on user only side only
- Double sided workstations will have square or rounded corners on all four corners



Square corners



Rounded corners

Workstation Accessories

Worksurface hook

- Mounts to underside of worksurface in any location. Predrilled holes included for suggested locations
- Max weight limit of 15 lbs
- Powder coated steel hook

Worksurface hook



13-AH

Workstation Grommets and power

- Single sided workstation grommet and power location located along the back of the worksurface
- Double sided workstation grommet and power locations located along the center of the worksurface
- Grommet locations: Left, right, center, or left and right

Grommets



Single sided workstation
left and right option shown



Double sided workstation
left and right option shown

Grommet/power locations



Left location



Right location



Left and right location



Center location

Workstation Grommets and power, continued

PS-100

- Set on surface power, 3.6" w x 3.9" d x 2.1" h
- One outlet, one usb-a charging port, one usb-c charging port
- 9' braided power cord
- Finishes:
 - Walnut shell with clear finish and black face, and black with white pinstripe braided power cord
 - Beech shell with clear finish and white face, and dusk braided power cord
 - Walnut shell with black finish and black face, and black with white pinstripe braided power cord
- **Note:** When PS-100 is specified, a grommet will be added to the worksurface

PS-92

- In surface power, 4" diameter x 3.25" h (recesses below worksurface)
- One outlet, one USB-A charging port, one USB-C charging port
- 10' power cord
- Available as black or white

PS-100



PS-100BE



PS-100WL



PS-100BK

PS-92



Single sided workstation



Double sided workstation

Ezel

- Markerboard: 33"w x 64"h x 2"d
 - white dry erase laminate
 - molded polyurethane knobs
- Caddy: 26.5"w x 19"h x 18.75"d
 - Total height of caddy and markerboard: 71.5"h
 - standard or studio powder coat
 - locking casters in black or white
- Wall rail: 42"w x 2"h x .5"d
 - Rail mounts approximately 68" AFF
 - Starter or add on option. Starter unit includes end caps
 - Aluminum rail in standard or studio powder coat
- Can be used with all Kaleid storage units, hangs from top shelf frame



Markerboard
16-MB



Caddy
16-MBC

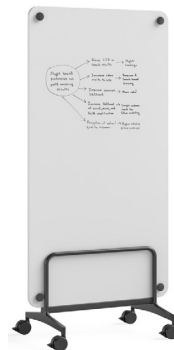

Caddy shown with
markerboard



Rail, shown with markerboard
16-MBRS - starter rail
16-MBRA - add on rail



Markerboard shown on
Kaleid unit