

The Maren wall mount bracket is designed for use with a toggle bolt anchor. If using a different type of wall anchor for securing the Maren wall mount bracket, please refer to the anchor manufacturer's installation.

IMPORTANT NOTICE:

Installers are responsible for selecting and supplying appropriate fasteners and must verify the adequacy of the mounting hardware. Improper installation may cause damage or serious injury. Carolina cannot be held liable for damage or injury caused by incorrect mounting, assembly or use. These instructions are only a suggested installation method and the installers are responsible for following all local codes and regulations.

Tools required:

Power drill
1/2" Drill bit
Phillips head screwdriver
Tape measurer
Level

Hardware required:

Maren wall mount bracket
Toggler [1/4"-20 snaptoggle toggle bolt anchor with bolts (2)
Screw cap covers (2)

1.) Mark the holes

Place the wall mount bracket at desired height (i.e. to position the chair 4" off the ground, place the bottom of the wall mount bracket 24" from the floor.) With a pencil, mark the position of the bracket screw holes; use a level for accuracy. Drill 1/2" diameter holes at each marking.

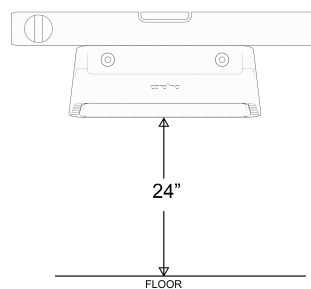

2.) Install toggler snap toggles

2.1.) Fold the metal channel so that it lies flat alongside the plastic straps, then slide the channel through the hole (note: a minimum clearance of 1-7/8" is required behind the wall.)

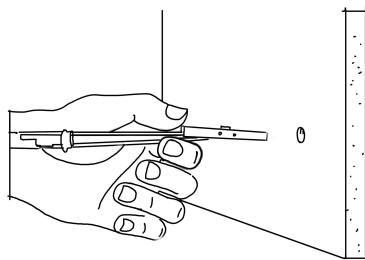

2.2) Hold ends of strap between thumb and forefinger and pull toward you until channel rests flush behind wall. While holding the strap/channel in place, slide the plastic cap along the straps until the flange of the cap is flush with the wall.

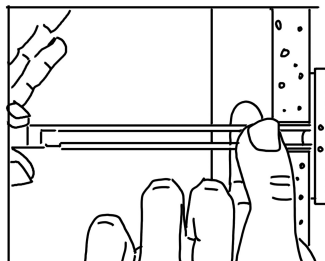

2.3) Snap the plastic straps off by pushing from side to side. Ensure the straps are level with the cap.

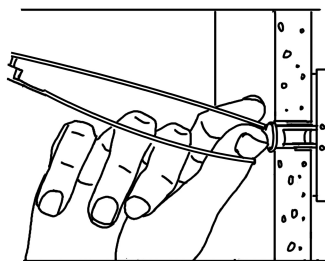

3.) Secure the wall mount bracket

Align the screw holes of the wall mount bracket with the plastic caps in the wall. Fasten the bolt into the wall with a screwdriver, check that the bottom of the bracket is parallel to the floor. Repeat the process for the 2nd bolt.

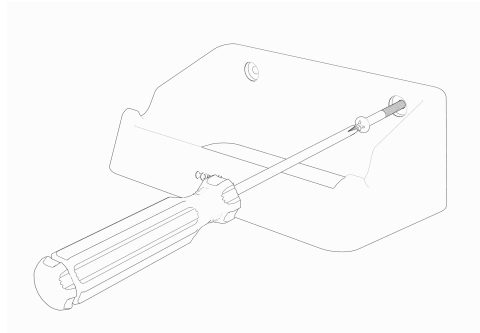

4.) Install screw caps

Press in the screw caps to conceal the bolt heads.

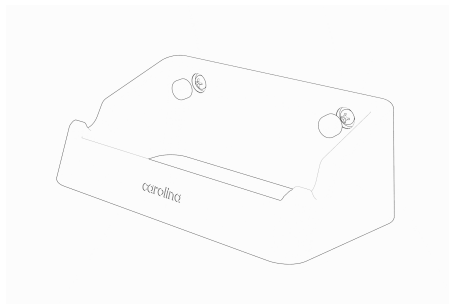

5.) Hang Maren folding chair

Fold chair and locate chair crossbar with the "Hang here" label. Set the crossbar into the grooves of the bracket, ensure that it is centered on the bracket.