

Walden Casegoods Product Information:

Exterior Wood Materials: Exterior surfaces are made from the finest selected veneers to achieve clarity and consistency in the Walden product line. To attain a pleasing, symmetrical pattern, all veneers in Walden are book-matched. All exterior solid lumber is matched to coordinate with the veneer.

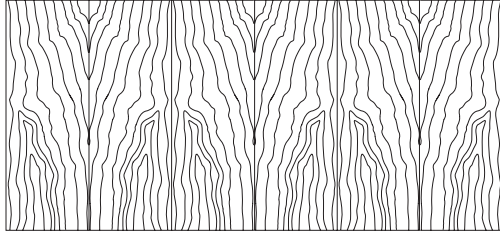

Alternating pieces of veneer are flipped over so they face each other like the pages within a book.

Walden is available in flat cut cherry and walnut veneer. A wide range of wood stains have been formulated to enhance the beauty of the veneer.

Work Surface Construction: Tops are 3-ply balanced construction, 1 3/8" thick with solid matching hardwood edges.

Coordinating high pressure laminate in a veneer grain pattern can be applied to the top surface and is available at no additional charge.

Case Construction: All construction is a combination of mortise and tenon with bore and dowel.

All panels are 3/4" thick with 3-ply construction and rimmed with veneer bands.

Arm slides are 3-ply construction, banded on all four sides with veneer. Pedestals are enclosed at the bottom with a 1/8" thick panel securely fastened to the bottom of the pedestal.

Each corner of the pedestal has a metal reinforcement bracket with a 2 1/2" adjustable glides. All glides can be adjusted from inside the pedestal by removing the bottom drawer.

Drawer Construction: The standard drawer is constructed with 1/2" thick high quality plywood with a durable finish. This five sided drawer box features fully glued dovetail construction ensuring a solid, warp resistant drawer box.

Veneered bottoms are framed into grooves on four sides. Bottoms are then glued, stapled, and reinforced with a continuous band of glue.

The optional V-fold drawer interior is a 1/2" durable, miter-fold drawer system. The V-fold vinyl wrapped drawer sides form a mitered box. The box is glued and doweled, the drawer fronts attached to the box.

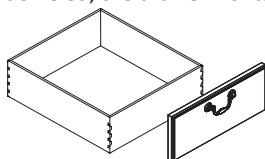

Drawer Suspension: The high quality black drawer suspensions carry a lifetime warranty. Slides feature steel ball bearings for longer life with cushioned in/out stops. All drawers, including file and box drawers, fully extend past the pedestal chassis allowing full access to the drawer box.

Filing Hardware: All file drawers are constructed with a custom designed filing system in place to allow for hanging folders.

Locking: All desk, credenzas and freestanding pedestals with drawers are face locked. Locks are located in the upper right corner of top drawer. Door locks are available as an option.

Units are shipped randomly keyed as standard. Key alike units are available upon request for no additional charges. Removable cores for in-field re-keying are standard.

Finish - Stain/Colors: We offer a variety of wood stains on Walden. Please see the chart below. Samples are available upon request.

ESS Essentials Veneer Collection

BRK	Brickdust	OBK	Outback
CSK	Cask	SIE	Sienna
CLY	Clay	TRF	Truffle
MES	Mesa	UMB	Umber
MCH	Mocha		

Protective Top Coat: DuraTex™ offers exceptional hardness along with abrasion and impact resistance, it has been formulated to eliminate hazardous and harmful gases that are normally associated with wood finish.

DuraTex™ Features

Safety - Significantly reduces hazardous formaldehyde emissions, which help improve the quality of the indoor air we breathe.

Quality - Developed to be tough and durable with special attention to appearance. The DuraTex™ finish preserves the natural beauty of wood.

Durability - Designed to meet a wide range of demanding performance and environmental standards to withstand even the highest wear and tear.

Conference Base Construction: Panels are joined together by mortise and tenon construction. In addition to mortise and tenon joint construction. Leveling glides are set into solid hardwood with t-nut inserts, which helps to prevent the leveling glide from tear out. Tops are secured to the bases with top fastening cleats screwed to the inside of the panels.



CORPORATE OFFICE
225 CLAY STREET
JASPER, INDIANA 47546



800.457.4511 **TOLL FREE**
812.482.3204 **OFFICE**
812.482.1548 **FAX**



JSIFURNITURE.COM



CONTACT JSI

Walden Casegoods Product Information:

Product Modification

Laminate Tops: Work surface only, no additional upcharge if Walden’s coordinating wood grain laminate is specified. Contact Customer Service for any other laminate request. Listed below are finishes that have coordinating wood grain HPL laminates.

ESS Essentials Veneer

BRK Brickdust	MCH Mocha
CSK Cask	OBK Outback
CLY Clay	UMB Umber
MES Mesa	

Custom/Special Finishes: JSI, upon request, will accommodate special finishes. A written request is required to proceed with custom finish orders. A sample reference is required for first-time matches and must be included with the written request.

There is a one-time upcharge per order for any non-standard wood finish.

Orders will be entered noting the special finish. A sample match will be provided to the customer. Written approval is needed before the finish process can be started. Delays in approval may have an impact on lead times.

Every effort will be made to create the requested match; however, an acceptable match may not be possible because of natural variations of wood. These natural variations can also cause minor differences in the final finish product.

Use standard pricing and option pricing for each line item with a special finish, unless additional modifications have been specified. For items available in both Essential and Artisan veneers, apply the Essentials pricing.

Finish Sheen: All veneer finishes, for Walden, are standard in 35-sheen. All other finishes can have their sheen modified with a 15% upcharge added to the list price of each item.

Special Veneer: Upon request standard veneer can be changed to a special veneer contact Customer Service for availability and pricing.

Pedestal Configuration Change: Pencil-box-file configuration is standard on all desks pedestals. Standard configurations for all other units are listed in the pricing section for that model.

Drawer configurations can be switched from a pencil-box-file or box-box-file to a file-file configuration on units 28 ¾” high, but must be specified at the time of order with an additional upcharge per pedestal.

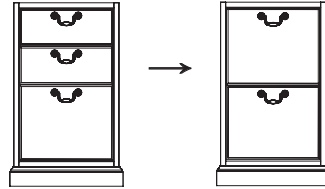

Changing from pencil-box-file to file-file pedestal will eliminate the writing shelf (arm slide).

Drawer Options: Walden drawers are standard in plywood and available in an optional V-fold style.

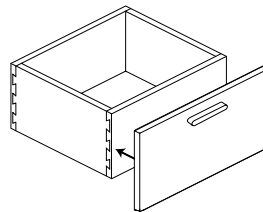

Wood Drawer DRW
Standard

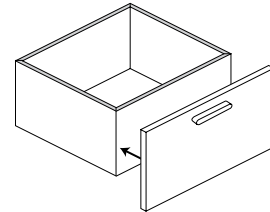

V-Fold Drawer DRV
Optional

Walden Casegoods Product Information:

Edge and Hardware: Walden offers the traditional federal edge profile and the Walden drawer pull in antique brass or pewter finish

Edge Profile

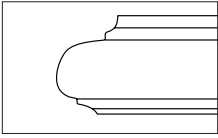

Federal Edge Profile
Accepts Laminate Top

Drawer Hardware

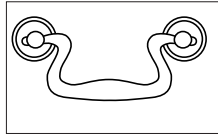

Walden Hardware
Antique Brass ANB
Pewter PTR

Picture Frame Molding: Many Walden units, including desks, credenzas, and overhead storage, can be specified with picture frame molding. Desks feature this molding on the modesty panel, the back and side of the pedestal, and the outside of the end panel. Molding on the returns are located on the side and back of the pedestal. Credenzas have molding on the side of the pedestal and end panel only. Overhead storage features molding on wood doors only.

Walden Molding WDM

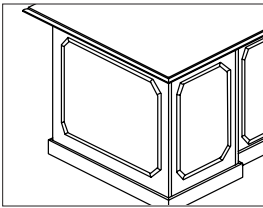

Desk (approach shown)
Pedestal Side and Back, Modesty,
End Panel (Single Pedestal Desk only)

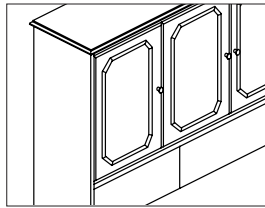

Overhead (front shown)
Wood Doors only

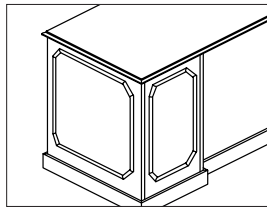

Return (approach shown)
Pedestal Side and Back

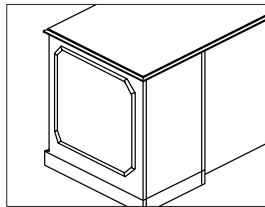

Credenza (back shown)
Pedestal End Panel

Base Molding Only WOM

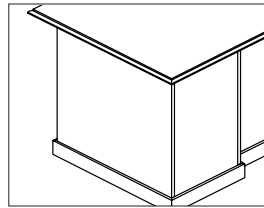

Desk (approach shown)

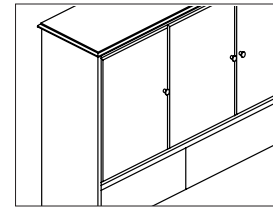

Overhead (front shown)

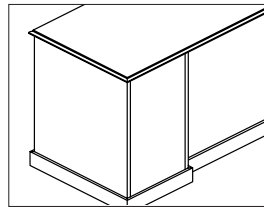

Return (approach shown)

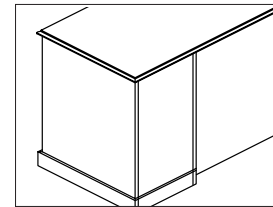

Credenza (back shown)

Walden Conference Base Molding

Walden trim molding (WDM) or without molding (WOM) can be specified at the time of order placement. Use the appropriate pricing column.

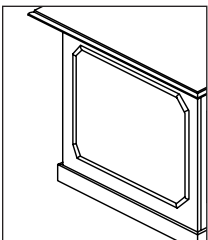

Walden Molding WDM

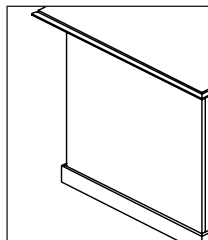

Base Molding Only WOM

Walden Casegoods Product Information:

Storage Overhead Cabinet: Overhead storage sizes range from 30" wide to 90" wide. Multiple variations, including wall mount overheads and open storage, are available.

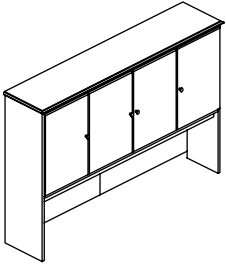

Storage Overhead Cabinet with Doors

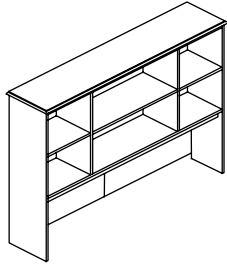

Open Storage Overhead Cabinet

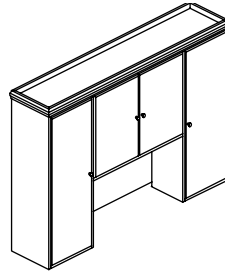

Open Storage Overhead Cabinet with Tower

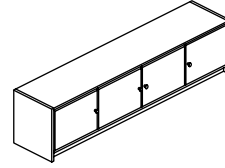

Wall Mount Overhead

Storage Overhead Cabinet Doors: Door options for storage overhead cabinets and storage towers include wood doors (DWW) with or without picture frame molding, grill doors (DWM), and clear glass doors (not low iron) (DWC). Knobs may be either antique brass or pewter. Grill matches hardware finish selected.

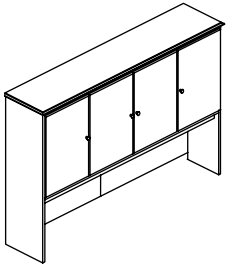

Wood Doors DWW Standard

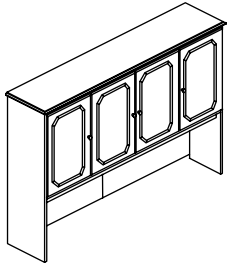

Wood Doors DWW with Optional Molding

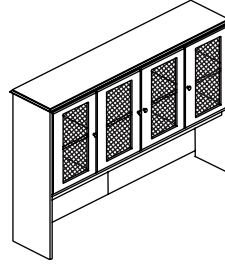

Grill Doors DWM

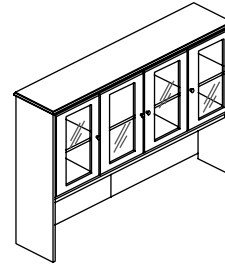

Clear Glass Doors DWC (not low iron)

Flat Cut Options: Units can fit tightly together with flat cut rims that replace the top edge profile and base molding. Specify the flat cut options. (see example)

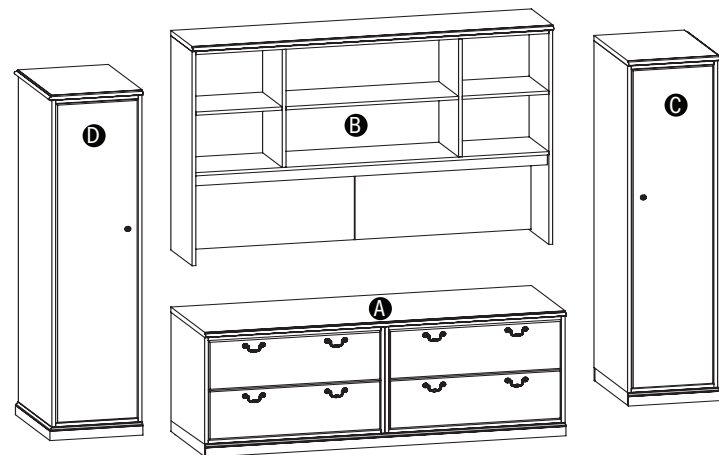

Example

- A** credenza flat cut on both sides (option code FB)
- B** overhead flat cut on both sides (option code FB)
- C** wardrobe flat cut on the left side (option code FL)
- D** wardrobe flat cut on the right side (option code FR)

Must be specified at the time of order placement.



Walden Casegoods Product Information:

Worksurface Grommets

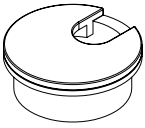

G3A - 3" Antique Brass
G3B - 3" Matte Black

Work Surface Grommet Locations

The optional grommet locations on the desk, run-off desk, bridges, credenzas and returns are predetermined on the Walden product. Grommet locations are indicated below with an (A) for left, (B) for center, (C) for right, and (D) for center end.

Add upcharge to the list price for each additional grommet.

Pedestal Desk

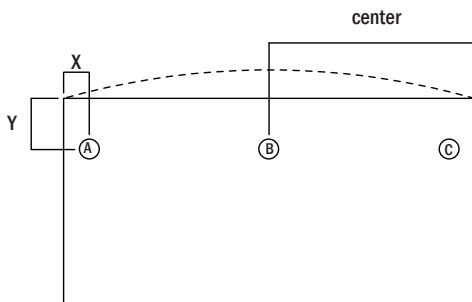

X = 4 1/2"
 Y = 8 1/4"

Support End and Run-Off Desk

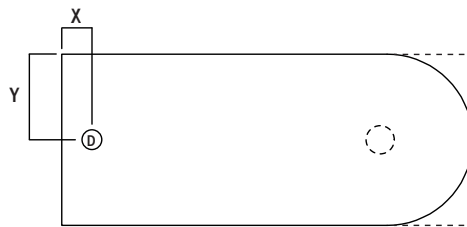

X = 4 1/2" from connect end
 Y = center

Bridges, Returns and Credenzas

Center grommet is not available on open corner lateral credenzas and lateral returns due to the location of the pedestal.

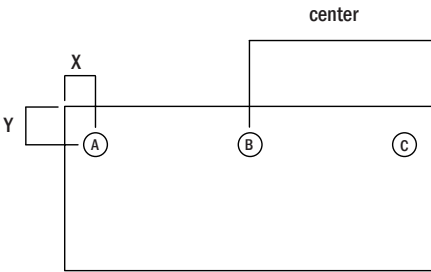

X = 4 1/2"
 Y = 5"

Note: Grommet not recommended over pedestal, contact Customer Service for other locations.

Walden Product Information:

Select Code

Essentials Veneer Collection

Brickdust	BRK
Cask	CSK
Clay	CLY
Mesa	MES
Mocha	MCH
Outback	OBK
Sienna	SIE
Truffle	TRF
Umber	UMB

Essentials Veneer with Laminate Top

Brickdust	BRK
Cask	CSK
Clay	CLY
Mesa	MES
Mocha	MCH
Outback	OBK
Umber	UMB

Select Code

Top Edge Profile

Federal

Hardware Finish

Antique Brass	ANB
Pewter	PTR

Drawer Box

Wood	DRW
V-Fold	DRV

Door Style

Wood Door	DWW
Wire Mesh/Wood Door	DWM
Clear Glass/Wood Door	DWC

Top Grommet Finish

3" dia. Antique Brass	G3A
3" dia. Black	G3B

Top Grommet Locations

Left	A
Center	B
Right	C
Center End	D

Door Locks

Locks	LCY
Without Locks	LCN

Flat Cut

Left Flat	FEL
Right Flat	FER
Left and Right Flat	FEB
No Flat Cut	NFE

