

American Standard

Installation Instructions

2064.461

ONE SINGLE CONTROL WALL MOUNT FAUCET IN-WALL LAVATORY FITTING with EverClean™ Finish

Congratulations on purchasing your American Standard faucet with EverClean finish found only on American Standard faucets.

EverClean Finish

- One wipe effortlessly removes spots
- Eliminates the need for cleaners and scrubbing
- Permanent surface protectant remains beautiful for the life of the faucet
- EverClean™ available on: Polished Chrome, Satin Nickel, Stainless Steel, Polished Brass (or any combination of these finishes)

To ensure that your installation proceeds smoothly-please read these instructions carefully before you begin.

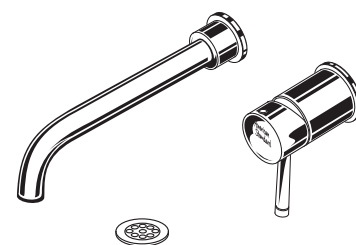

Certified to comply with ASME A112.18.1M
U.S. Patent No. 5,819,789

M968918

ROUGHING-IN DIMENSIONS

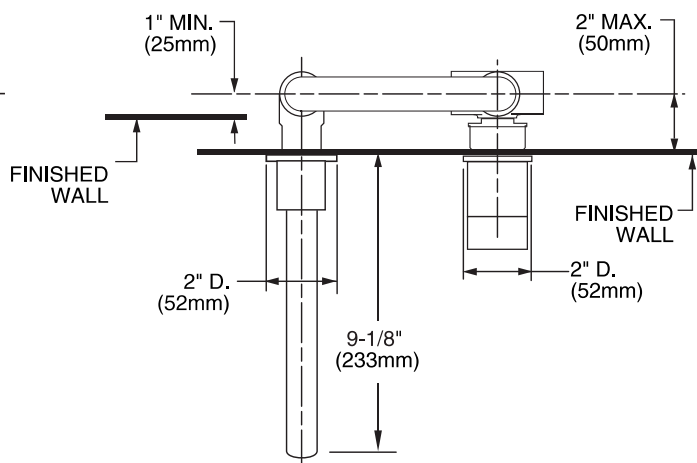
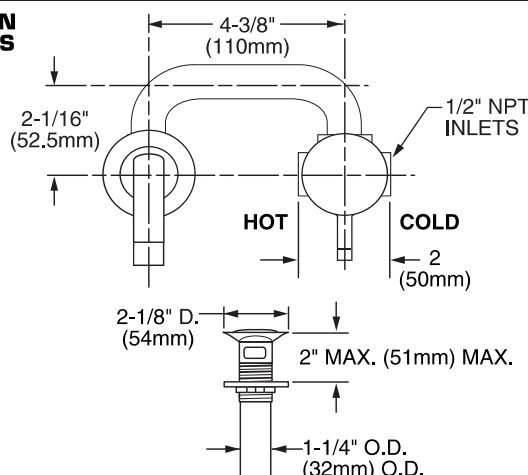

Required Tools

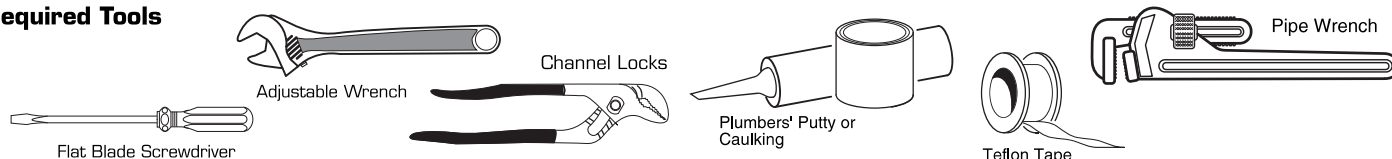

1

INSTALL VALVE BODY

CAUTION

Turn off hot and cold water supplies before beginning.

- Determine where the finished wall location will be. ***This measurement is very important!*** Note: The rough-in measurement from the finished wall is; 1" minimum and 2" maximum. This is a 1" tolerance. See rough-in illustration above.
- Secure FAUCET BODY (1) to cross brace of wall structure at required height using two wood screws and and pipe brace.
- Connect HOT water supply to left VALVE inlet and COLD water supply to right VALVE inlet. Use pipe sealant or Teflon tape for all threaded connections. For sweat connections, do not make sweat connections directly to valve body. Damage to seals and and valve cartridge may occur. Remove all valve parts before making sweat connections to valve body.
- Turn valve to off position. Turn hot and cold supplies on and check fitting connections for leaks .
- Complete wall construction.

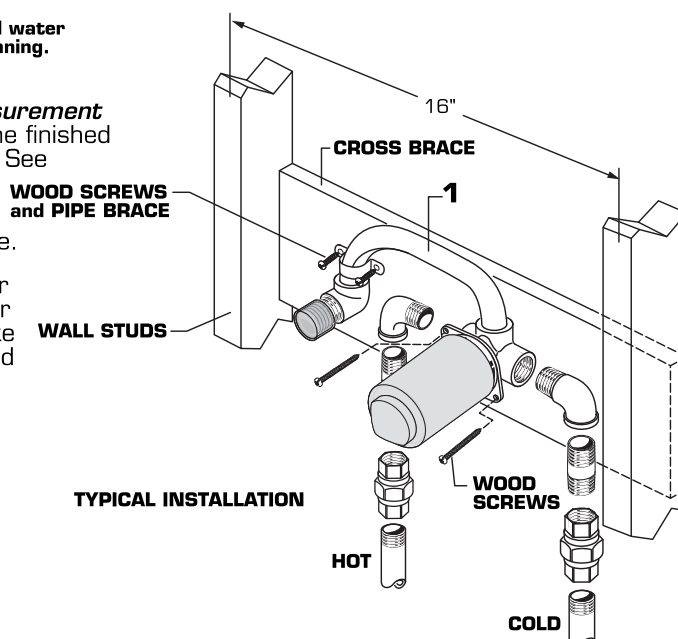

2 INSTALL WALL SPOUT

- Remove PLASTER GUARDS **(1, 1a)** from VALVE BODY and SPOUT NIPPLE **(2)**.
- Apply thread sealant to SPOUT NIPPLE **(2)**.
- Thread SPOUT MOUNT **(3)** onto SPOUT NIPPLE **(2)** using a 10mm Hex Wrench. Tighten completely.

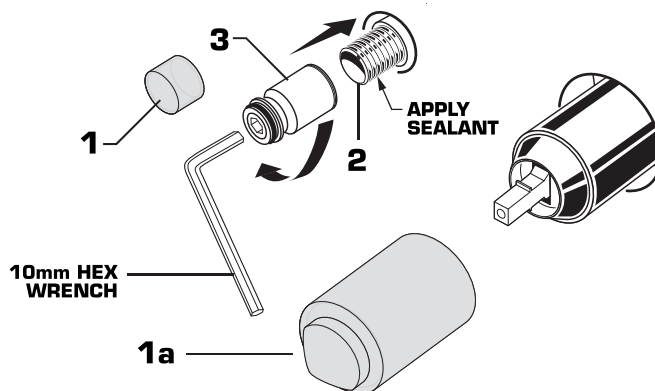

2a INSTALL WALL SPOUT

- Install SEAL **(4)** into SPOUT ESCUTCHEON **(5)**. Place SPOUT ESCUTCHEON **(5)** with SEAL **(4)** onto SPOUT **(6)**. **Fig. A**
- Push SPOUT **(6)** onto SPOUT MOUNT **(3)**. Align SPOUT **(6)** and tighten SPOUT SET SCREW **(7)** with 2mm HEX WRENCH **(8)** supplied. Push SPOUT ESCUTCHEON **(5)** against finished wall.
- Install SEAL **(9)** into VALVE ESCUTCHEON **(10)**. Place VALVE ESCUTCHEON **(10)** with SEAL **(9)** onto VALVE **(11)**. Push VALVE ESCUTCHEON **(10)** against finished wall. **Fig. B**

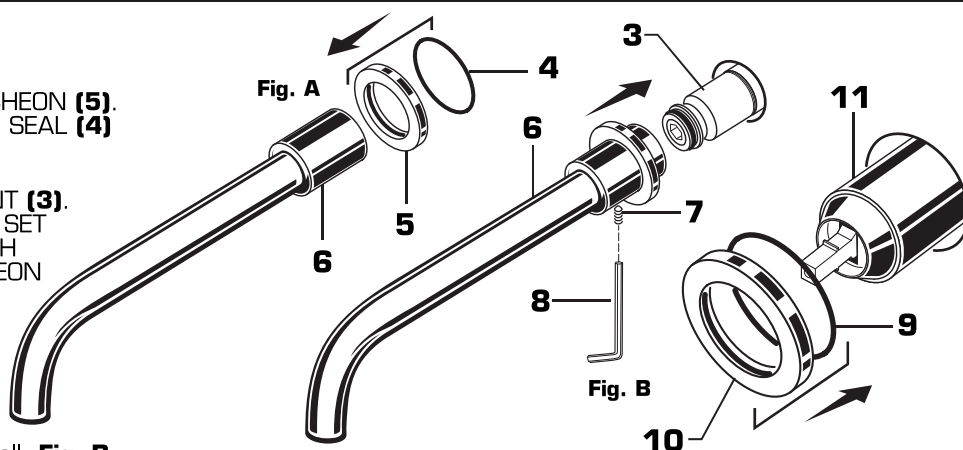

3 INSTALL HANDLE

- Push VALVE STEM **(1)** down to off position.
- Attach HANDLE ADAPTER **(2)** to VALVE STEM **(1)** with ADAPTER SCREW **(3)**. Tighten fully.
- Install HANDLE **(4)** onto VALVE STEM **(1)** and tighten SET SCREW **(5)** with 2.5mm HEX WRENCH **(6)** supplied.
- Install PLUG BUTTON **(7)** into HANDLE **(4)**.

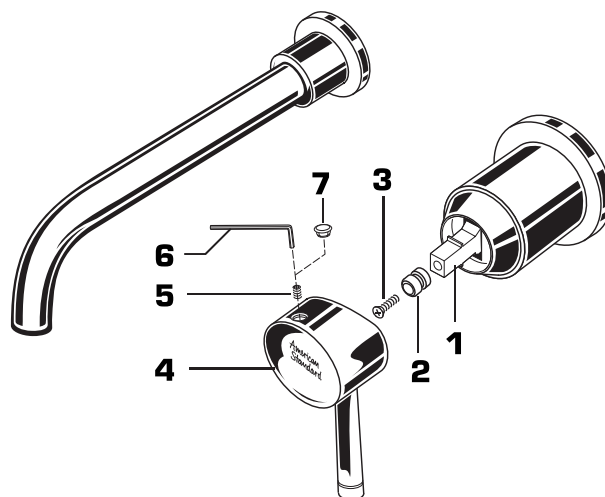

4 DRAIN INSTALLATION

- Apply a bead of PUTTY to underside of FLANGE on DRAIN BODY **(1)**.
- Feed DRAIN BODY **(1)** down through lavatory.
- Assembly GASKET **(2)** WASHER **(3)** and LOCKNUT **(4)** onto DRAIN BODY **(1)**. Tighten LOCKNUT **(4)** firmly.
- Assembly TAILPIECE **(5)** to DRAIN BODY **(1)**.

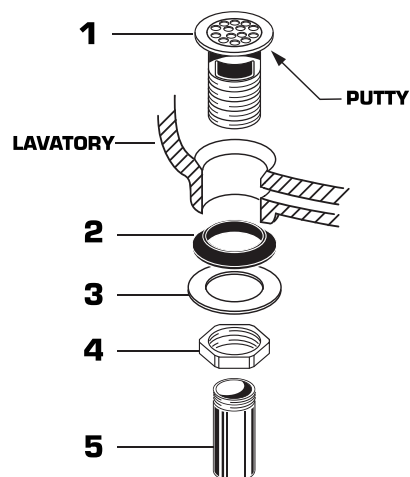

6

TEST INSTALLED FAUCET

- Turn **HANDLE** to "off" position.
- Remove **AERATOR (1)** using **TOOL (2)** supplied.
- Turn hot and cold water supplies on. Operate **HANDLE** to flush water lines thoroughly. Check spout connections for leaks. ➡
- Check all drain connections for leaks. ➡
- Turn handle to OFF position. Replace **AERATOR (1)**.

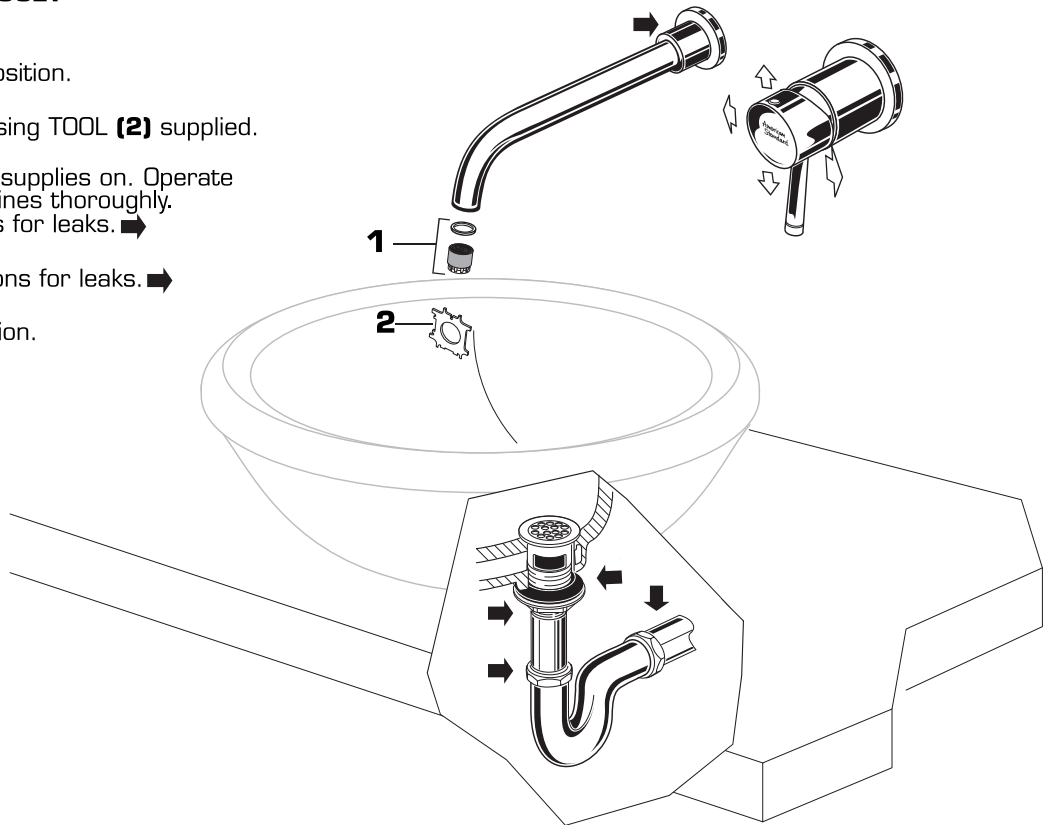

7

ADJUST HOT LIMIT SAFETY STOP

HOT LIMIT SAFETY STOP ADJUSTMENT

By restricting handle rotation and limiting the amount of hot water allowed to mix with the cold, the **HOT LIMIT SAFETY STOP** reduces risk of accidental scalding. To set the maximum hot water temperature of your faucets, all you need to do is adjust the setting on the **HOT LIMIT SAFETY STOP**.

- Remove **HANDLE (1)**, **ESCUTCHEON (2)** and **LOCK NUT (3)** from cartridge.
- Pull off **HOT LIMIT SAFETY STOP (4)**. Use a flat blade screwdriver if needed.
- Rotate **HOT LIMIT SAFETY STOP (4)** counter-clockwise to increase max. temperature and clockwise to decrease the max temperature.

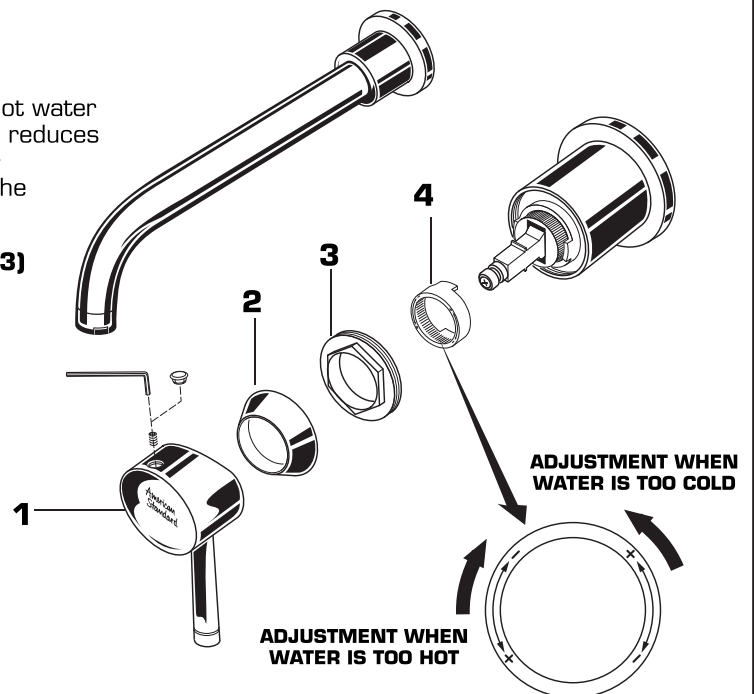

8

EverClean™ Finish Care Instructions

American Standard's EverClean finish will wipe clean with a soft, dry cloth. A soft cloth with clean water may also be used, if desired. No additional cleaning products are required.

DO NOT USE: Soaps, acid, polish, abrasives, harsh cleaners, or a cloth with a coarse surface.