

**SAVONA  
WHIRLPOOL  
MODEL NUMBER**

**2901.028 SERIES  
2901.028H SERIES**

*American Standard*

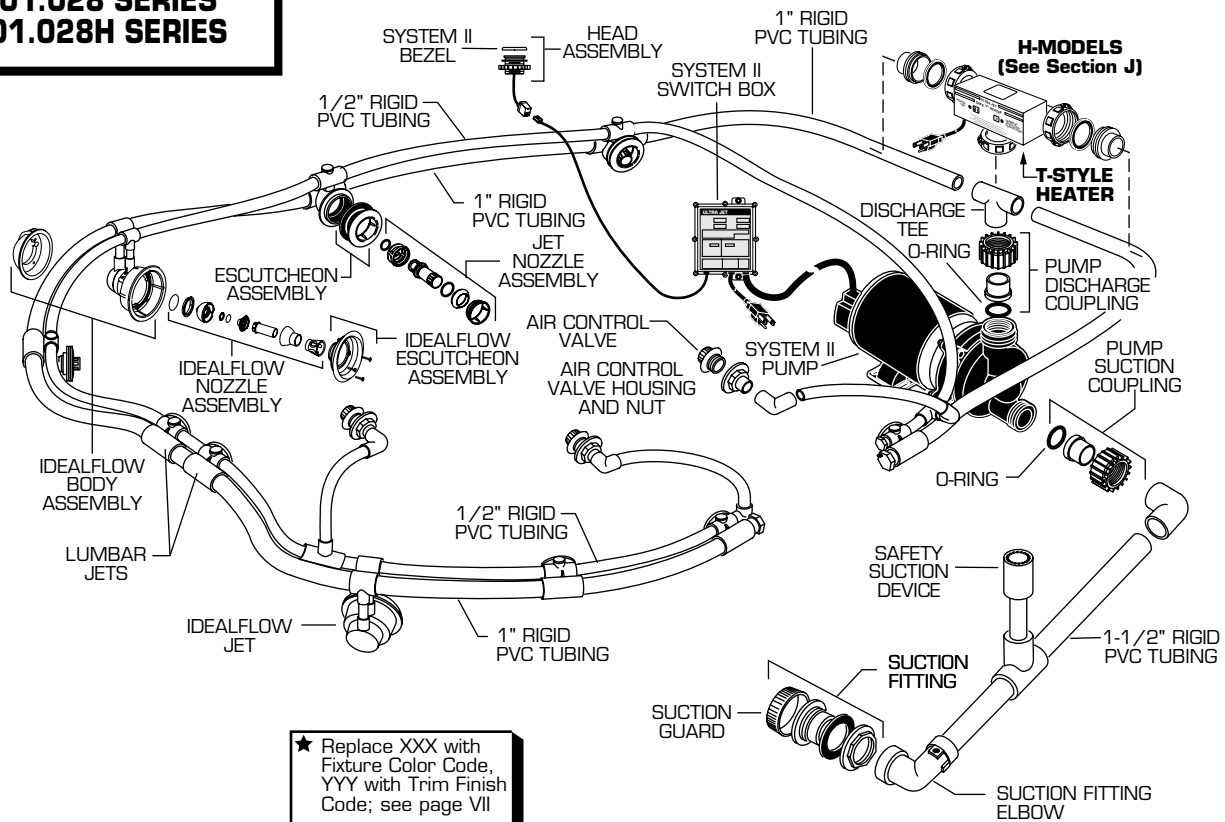

★ Replace XXX with Fixture Color Code, YYY with Trim Finish Code; see page VII

USABLE ON	DESCRIPTION	PART NUMBER	PKG QTY
ALL MODELS	Pump Suction Coupling	047186-0070A	1
	O-Ring	047187-0070A	1
	Pump Discharge Coupling	047186-0070A	1
	★ Air Control Valve	751677-XXX0A	1
	★ Air Control Valve Housing/Nut	068917-XXX0A	1
	★ Jet Nozzle Assembly △	047587-XXX0A	1
	★ Escutcheon Assembly □	047588-XXX0A	1
	Jet Body Assembly	047589-0070A	1
	★ Idealflow Nozzle Assembly	752407-XXX0A	1
	★ Idealflow Escutcheon Assembly	752408-XXX0A	1
	Idealflow Body Assembly	752409-0070A	1
	★ Suction Guard	750537-XXX0A	1
	★ Suction Fitting	752396-XXX0A	1
	Suction Fitting Elbow	751186-0070A	1
	Discharge Tee	047438-0070A	1
	★ Head Assembly ○	752118-YYY0A	1
	★ System II Bezel ○	752115-YYY0A	1
	System II Switch Box	752119-0070A	1
	Safety Suction Device (8")	752361-0070A	1
	SYSTEM II .028 .028H	Pump (2 Speed 2 HP)	752466-0070A
Head Assembly		752118-YYY0A	1
★ System II Bezel ○		752115-YYY0A	1
★ System II Switch Box ○		752468-0070A	1
Heater (.028H only) See Section J		752356-0070A	1

△ Removal/installation requires tool part no. 047530-0070A.  
 □ Removal/installation requires tool part no. 047605-0070A.

○ Available in Chrome, Polished Brass, and Gold.  
 See Section "J" for Additional Parts and Accessories.