

### HERITAGE SERIES SPREAD LAVATORY FAUCETS

### Installation Instructions

**4800 SERIES**  
**4801 SERIES**  
**4802 SERIES**  
**7830 SERIES**  
**7831 SERIES**  
**7890 SERIES**

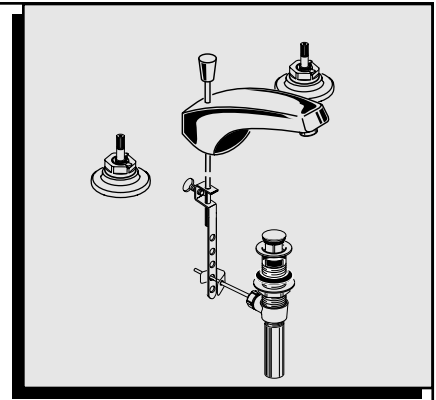

Certified to comply with ANSI A112.18.1M  
U.S. Patent No. 5,819,789

Thank you for selecting American-Standard...the benchmark of fine quality for over 100 years.

To ensure that your installation proceeds smoothly—please read these instructions carefully before you begin.

34312M-D

#### 4800 SERIES CONVENTIONAL SPOUT LESS POP-UP

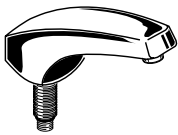

#### 7831 SERIES GOOSENECK SPOUT WITH POP-UP

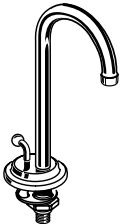

#### 7890 SERIES GOOSENECK SPOUT BAR SINK

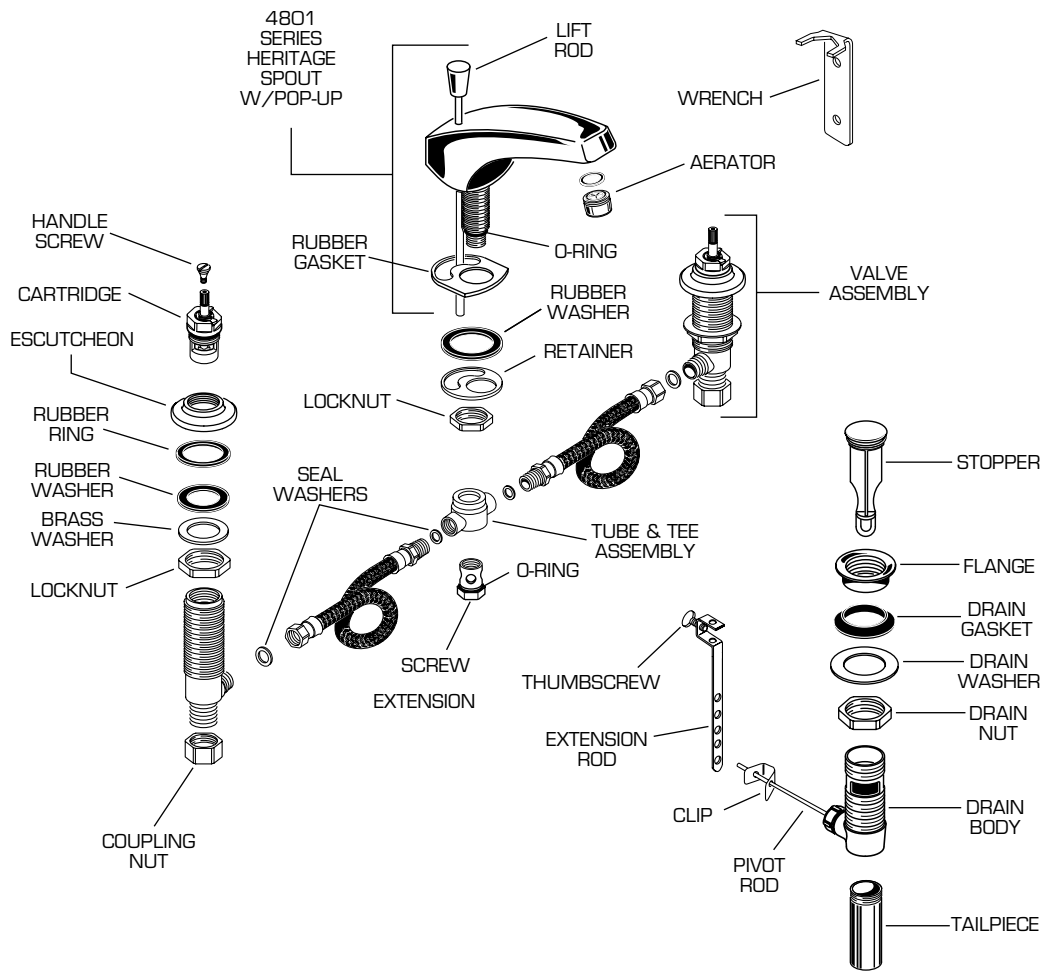
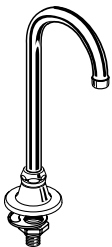

**1**

#### CAUTION

Turn off hot and cold water supplies before beginning.

#### SPOUT ASSEMBLY (Model 7890 only)

- Apply the grease (provided) liberally to the SPOUT O-RINGS and SNAP RING areas.
- Assemble the SPOUT and tighten SPOUT NUT until snug on VALVE BODY.
- Tighten BRASS LOCKNUT on center body.

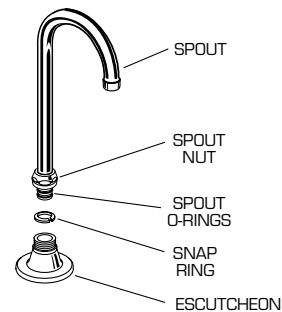

# 1

## SPOUT OR BASE ASSEMBLY (continued)

- Insert BASE or SPOUT shank through center hole of SINK, making sure RUBBER GASKET is properly positioned.
- Assemble RUBBER WASHER, RETAINER, and LOCKNUT onto threads of SPOUT from underside of SINK.
- Insert LIFT ROD through SPOUT (or BASE) and slot of RETAINER.
- Align SPOUT and tighten LOCKNUT. Be sure slot in BRASS WASHER is positioned to the rear as shown.

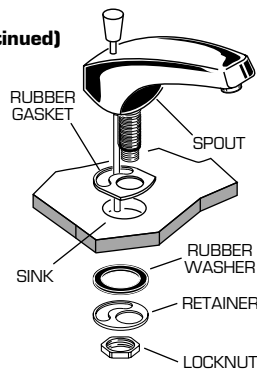

- Push SCREW into TEE and tighten SCREW onto SHANK to secure SPOUT connection.
- Place WASHERS inside COUPLING NUTS and connect HOSE to each valve outlet. Tighten COUPLING NUTS.
- Connect HOT water supply to the left VALVE and the COLD water to the right VALVE using sealant and appropriate connectors and coupling nuts.
- Refer to separate "Instruction Sheet" for assembly of handles.

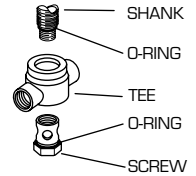

# 2

## VALVE INSTALLATION

- Insert VALVE BODY through hole from underside of SINK. Thread of VALVE BODY should extend at least 5/16" above SINK top. If necessary, adjust LOCKNUT.
- Place RUBBER RING into ESCUTCHEON and screw ESCUTCHEON onto VALVE BODY until snug against internal stop.
- Set VALVE BODIES so that their outlets are facing toward center of SINK. Tighten LOCKNUT using wrench supplied with faucet.
- Before connecting TEE make certain that O-RINGS are properly seated on stepped SHANK and SCREW.

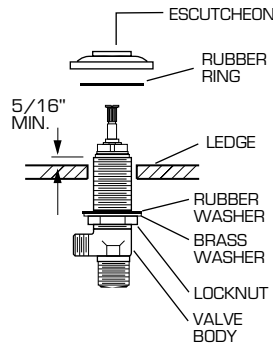

# 3

## DRAIN ASSEMBLY (Model 4802 only)

- Apply a bead of PUTTY around underside of DRAIN PLUG flange. Insert DRAIN PLUG into SINK drain hole.
- Hold DRAIN PLUG to prevent turning and assemble GASKET, WASHER, and LOCKNUT, from underneath sink.
- Insert threaded end of TAILPIECE into lower end of DRAIN PLUG. Connect other end to trap.

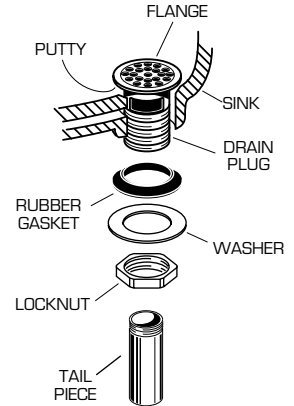

# 4

## INSTALL POP-UP DRAIN

- Push TAILPIECE down into TRAP (threaded end up).
- Thread LOCKNUT, WASHER and GASKET onto DRAIN BODY.
- Apply a bead of PUTTY to underside of FLANGE.
- Feed DRAIN BODY up through SINK and thread FLANGE fully onto BODY.
- Tighten LOCKNUT firmly, keeping the PIVOT ROD pointed towards the back of the SINK.
- Drop STOPPER into DRAIN BODY.
- Pull TAILPIECE up and thread tightly into DRAIN BODY.

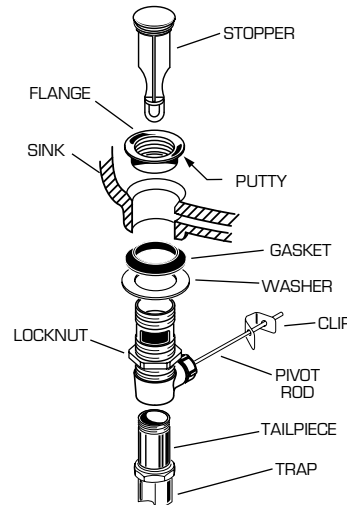

- Position EXTENSION ROD onto POP-UP ROD and tighten THUMBSCREW.
- Remove one end of CLIP from PIVOT ROD by squeezing ends together while sliding.
- Insert PIVOT ROD into second or third hole in EXTENSION and reassemble CLIP. (EXTENSION may need to be bent.)
- Adjust STOPPER height by repositioning EXTENSION and tightening THUMBSCREW.

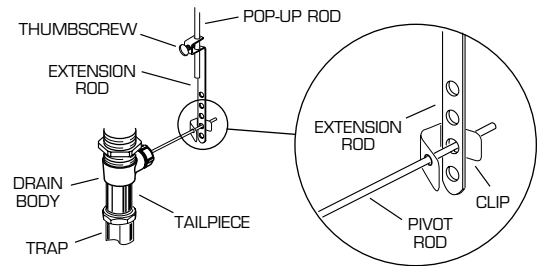

# 5

## TEST INSTALLED FAUCET

- Remove AERATOR.
- With handle in OFF position, turn on water supplies and check all connections for leaks.

- Operate both handles to flush water lines thoroughly. Check spout mounting and hose connections for leaks.
- Operate LIFT ROD and check DRAIN for leaks.
- Turn handles into OFF position and replace AERATOR.

# 6

## SERVICE

- To change direction of handle rotation, proceed as follows:
  - Turn valve to OFF position.
  - Remove INSERT and HANDLE SCREW.
  - Slip HANDLE with ADAPTER off.
  - Remove SPRING CLIP.
  - Lift STOP WASHER, turn 90° and replace.
  - Replace SPRING CLIP.
  - Replace ADAPTER, HANDLE, SCREW, and INSERT.
- AERATOR may accumulate dirt causing distorted and reduced water flow. Remove AERATOR and rinse clean.

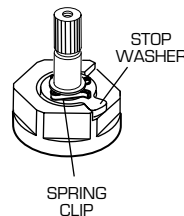

- If spout drips, operate handles several times from OFF to ON position. Do not force - handles turn only 90°.
- Plastic SCREEN in CARTRIDGE may accumulate dirt causing reduced water flow. To clean, first turn off hot and cold water supplies, then:
  - Remove INSERT and HANDLE SCREW.
  - Slip HANDLE with ADAPTER off.
  - Unscrew CARTRIDGE with wrench.
  - Thoroughly rinse plastic SCREEN at base of CARTRIDGE.
  - Replace CARTRIDGE until flange is tight against valve body.
  - Turn valves OFF.
  - Replace ADAPTER, HANDLE, SCREW, and INSERT.

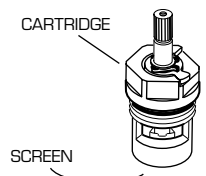

### HOTLINE FOR HELP

For toll-free information and answers to your questions, call:

1 (800) 223-0068

Weekdays 8:00 a.m. to 7:00 p.m. Eastern Time

Saturdays 8:00 a.m. to 4:00 p.m. Eastern Time

Product names listed herein are trademarks of American Standard Inc.  
© American Standard Inc. 1999

34312M-D