

### Features

- Acrylic
- Drop-in
- 6 individually adjustable ProFlex® hydro-massage jets
- 1.25 hp pump with air switch and grounding-type plug-in cord
- Optional K-9696 whirlpool trim kit in various finishes
- Optional K-1717 20-minute ProFlex® timer kit
- 66" (167.6 cm) x 42" (106.7 cm) x 22-5/8" (57.5 cm)

### Codes/Standards Applicable

Specified model meets or exceeds the following:

- ASME A112.19.7M
- ANSI Z124.1.2
- IAPMO/UPC
- Underwriters Laboratories (UL)

### ACRYLIC CUSTOM BATH WHIRLPOOL K-1263-CG/-CN

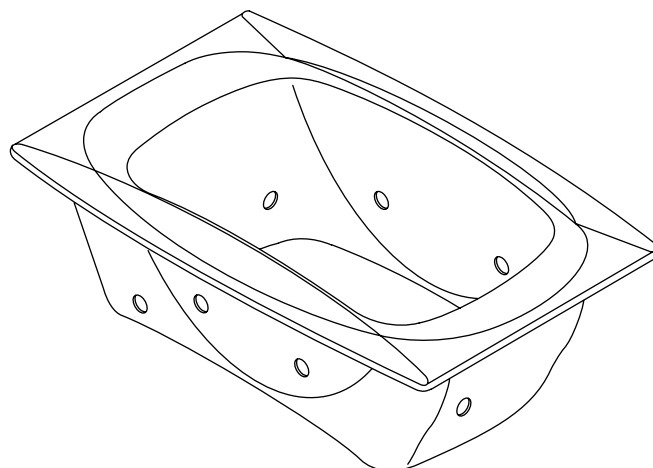

### Colors/Finishes

- 0: White
- Other: Refer to Price Book for additional colors/finishes

### Accessories:

- CP: Polished Chrome
- PB: Polished Brass
- NA: None applicable
- Other: Refer to Price Book for additional colors/finishes

### Specified Model

Model	Description	Colors/Finishes			
K-1263-CG	Bath whirlpool, drop-in, custom pump (shown)	<input type="checkbox"/> 0	<input type="checkbox"/> Other_____		
K-1263-CN	Bath whirlpool, drop-in, custom pump (top view shown)	<input type="checkbox"/> 0	<input type="checkbox"/> Other_____		
<b>Recommended Accessories</b>					
K-7161-AF	Drain	<input type="checkbox"/> CP	<input type="checkbox"/> PB	<input type="checkbox"/> Other_____	
<b>Optional Accessories</b>					
K-1717	20-minute ProFlex® timer kit				<input type="checkbox"/> NA
K-9696	Jet trim kit (metal finishes)	<input type="checkbox"/> CP	<input type="checkbox"/> PB	<input type="checkbox"/> Other_____	

### Product Specification

The acrylic drop-in bath whirlpool shall be 66" (167.6 cm) in length, 42" (106.7 cm) in width, and 22-5/8" (57.5 cm) in height. The bath whirlpool shall have 6 individually adjustable ProFlex® hydro-massage jets, a 1.25 hp pump with air switch and grounding-type plug-in cord. The bath whirlpool shall have an optional K-9696 jet trim kit, and an optional K-1717 20-minute ProFlex® timer kit. The bath whirlpool shall be Kohler Model K-1263-\_\_\_\_\_-\_\_\_\_\_.

## Technical Information

Fixture*:	
Basin area:	
Bathing well	49" (124.5 cm) x 30" (76.2 cm)
Top area	62" (157.5 cm) x 33" (83.8 cm)
To overflow:	
Water depth	17" (43.2 cm)
Capacity	110 gal (416.4 L)
Weight	135 lbs (61.2 kg)
* Approximate measurements for comparison only.	

Pump:	Hp	V	Hz	A
1-speed	1.25	120	60	7.5

## Required Electrical Service

Dedicated circuit required, protected with Class A Ground-Fault Circuit-Interrupter (GFCI):

Pump/control 120 V, 15 A, 60 Hz

Locate the outlet behind the whirlpool and within 24" (61 cm) of the pump.

## Installation Notes

Install this product according to the installation guide.

Floor support under whirlpool must provide for a minimum of 56 lbs/square foot (274 kg/square meter) loading.

If installing a rim-mount faucet, make sure there is no interference with drain overflow and circulating system before drilling any holes. Consult local and national codes for minimum air gap requirements if installing a spout on the faucet deck.

Pump must be relocated to custom position at the time of installation. Provide adequate clearance.

No change in measurements if connected with drain illustrated. (K-7161-AF or K-7161M-AF)

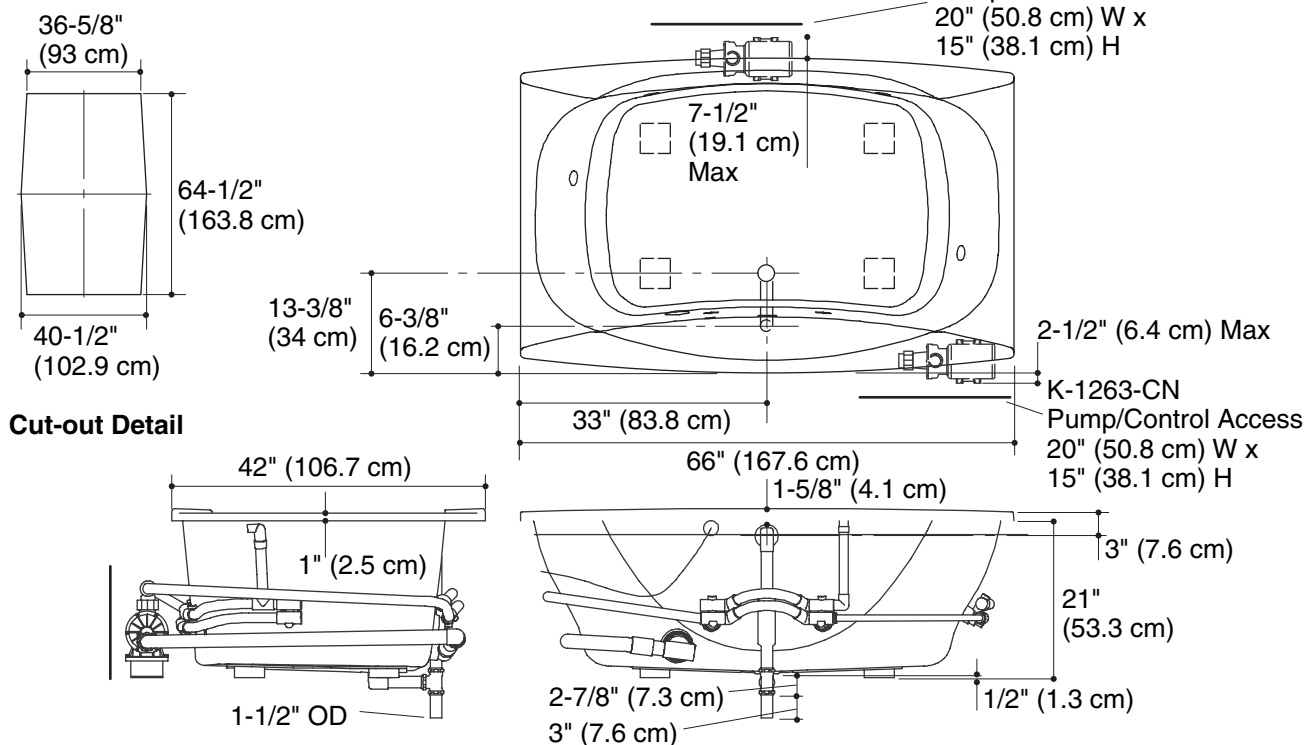

## Product Diagram