

### Product Information

Drop-in with Softgrip grip handles	K-1197	shown
Left drain, integral flange	K-1197-L	not shown
Right drain, integral flange	K-1197-R	not shown
Drop-in less Softgrip grip handles	K-1193	not shown
Left drain, integral flange	K-1193-L	not shown
Right drain, integral flange	K-1193-R	not shown

Fixture*:	basin area	top area	weight
Bathing well	42" (106.7cm) x 25" (63.5cm)	52" (132.1cm) x 34" (86.4cm)	75 lbs. (34.0kg)
	water depth	capacity	
To overflow	14" (35.6cm)	63 gal. (238.5L)	

\* Approximate measurements for comparison only.

### Installation Notes

Install this product according to the installation guide.

Floor support under bath must provide for a minimum of 80 lbs./square foot (390 Kg./square meter) loading.

If installing a rim-mount faucet, make sure there is no interference with drain overflow before drilling any holes. Consult local and national codes for minimum air gap requirements if installing a spout on the faucet deck.

The apron must be installed before the finish floor and wall materials are installed.

Fixture conforms to ANSI Standard Z124.1. All dimensions are nominal.

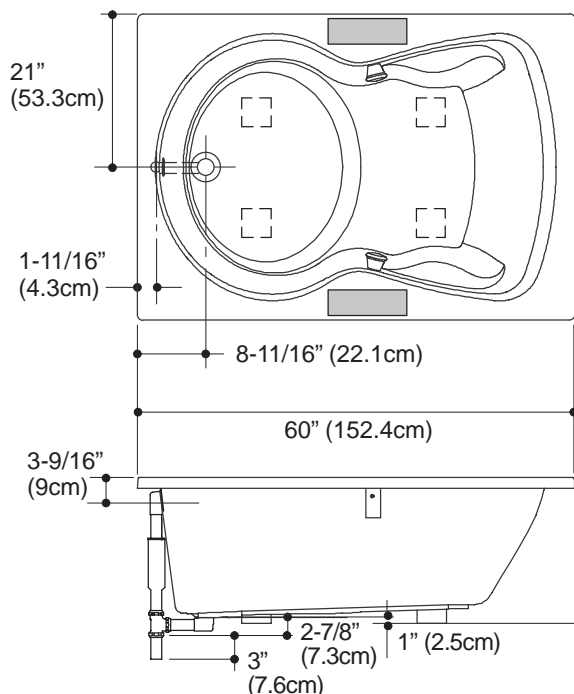

No change in measurements if connected with drain illustrated. (K-7161-AF or K-7161M-AF)

Drop-in cut-out	58" (147.3cm) x 40" (101.6cm)
Faucet area	recommended

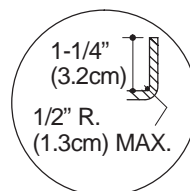

**INTEGRAL  
FLANGE DETAIL**

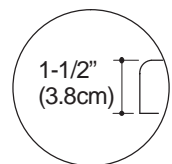

**DROP-IN RIM  
DETAIL**