

## Features

- Brass construction
- Front seal plate assembly
- Handle assembly

## TRANSFER VALVE TRIM K-T10340

**ADA**

## Codes/Standards Applicable

Specified model meets or exceeds the following:

- ASME A112.18.1/CSA B125.1
- IAPMO/UPC
- ADA

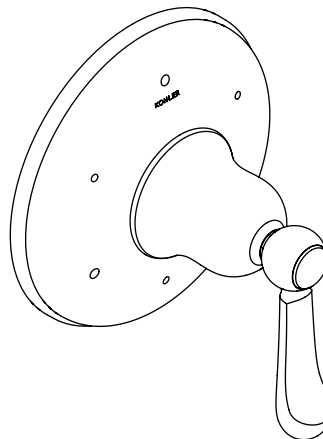

## Colors/Finishes

- CP: Polished Chrome
- Other: Refer to Price Book for additional colors/finishes

## Accessories:

- NA: None applicable

## Specified Model

For complete faucet, both faucet trim and valving must be specified.			
Model	Description	Colors/Finishes	
K-T10340-4	Transfer valve trim	<input type="checkbox"/> CP	<input type="checkbox"/> Other _____
Required Accessories			
K-672-K	3/4" Transfer valve	<input type="checkbox"/> NA	

## Product Specification:

Transfer valve trim shall be of brass construction. Trim shall include front seal plate assembly and handle assembly. Transfer valve trim shall be Kohler Model K-T10340-4-\_\_\_\_\_, the transfer valve shall be Kohler Model K-672-K-\_\_\_\_\_.

# LYNTIER™

## Installation Notes

Install this product according to the installation guide.

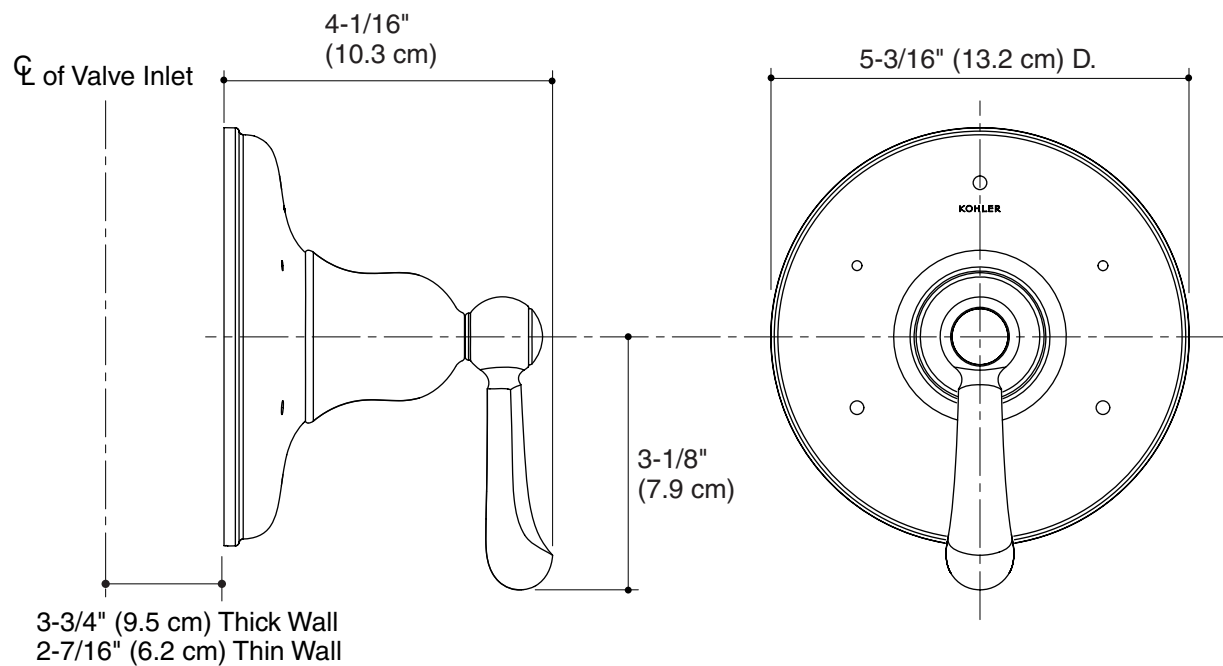

## Product Diagram