



INSTALLATION INSTRUCTIONS

K-705250 ARICA™ ROUND SHOWER ENCLOSURE

1. BEFORE YOU BEGIN

HOW TO USE THESE INSTRUCTIONS

Please read these instructions carefully to familiarize yourself with the required tools, materials, and installation sequences. Follow the sections that pertain to your particular installation. This will help you avoid costly mistakes. In addition to proper installation, read all operating and safety instructions.

All information in these instructions is based on the latest product information available at the time of publication. Kohler Co. reserves the right to make changes in product characteristics, packaging, or availability at any time without notice.

These instructions contain important care, cleaning, and warranty information – please leave instructions for the consumer.

SPECIFICATIONS

- K-705250 Shower Enclosure:
36" x 36" x 72" H

TOOLS AND MATERIALS REQUIRED

- Conventional woodworking tools
- Measuring tape
- Pencil
- Safety glasses
- Screwdriver - Flat
- Caulking gun
- Masking tape
- Silicone Sealant (RTV)
- Center punch
- Hammer
- Screwdriver - Phillips
- Electric drill
- Drill bit - 5/16"
- Masonry bit for ceramic tile - 5/16"

PREPARATION

- Before starting the installation, lay out and identify all the parts. Use the exploded view parts list and illustrations on pages 8 through 10 for reference.
- Install shower receptor in accordance with instructions supplied with receptor.



CAUTION: Tempered glass cannot be cut.

NOTE: For ease of installation, it is recommended that two people install shower enclosure.

2. INSTALLATION

A. INSTALL FIXED PANELS

NOTE: Assemble door enclosure on a clean and non-abrasive surface (such as a drop cloth) to prevent damage.

Position the right-hand fixed panel onto the top and bottom track and align the holes in the glass with the installed female patch.

Align the hole in the fixed panel male patch with the screw hole in the female patch and fasten with four M6 x 10 Flat Sockethead screws. Use the hex wrench provided to fasten the screws but do not tighten the screws at this time.

Repeat the above procedures to install the left-hand fixed panel.

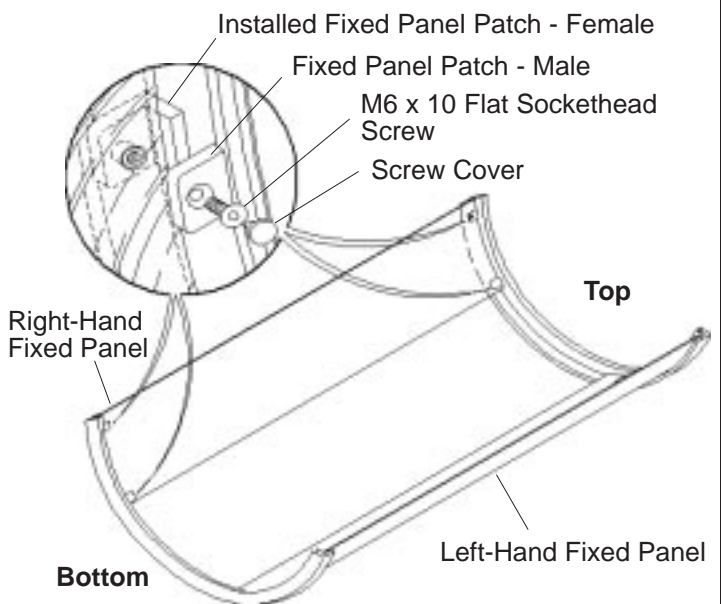

B. INSTALL MOVING PANELS

Apply supplied silicone lubricant to the bottom track groove, making sure to apply to the entire length of the groove.

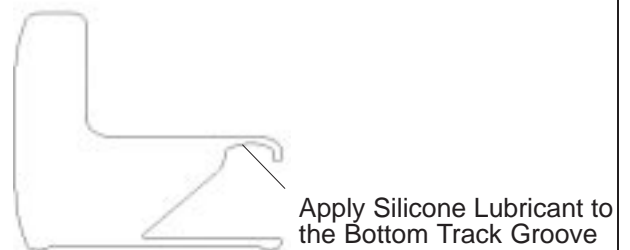

Right-Hand Panels

At the bottom end of the right-hand moving panel, disengage, if necessary, the two catches with the turngrip levers.

Position the moving right-hand panel with the rollers up and the magnet side towards the right-hand fixed panel.

Fit the first roller (nearest magnet side of moving panel) into the top track roller groove of the fixed panel.

Fit the second roller (near outside edge of moving panel) into the groove and slide the right-hand moving panel into the top track of the right-hand fixed panel.

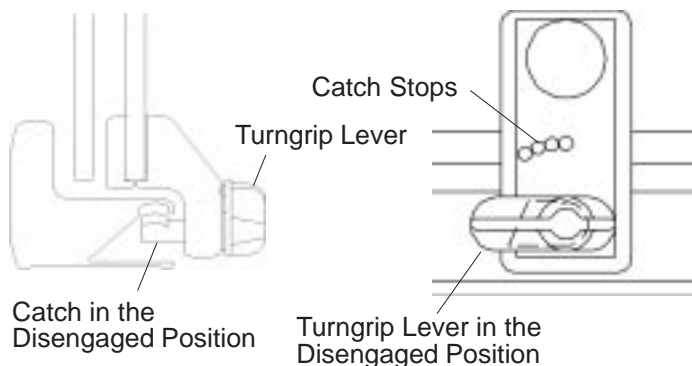

Left-Hand Panels

At the bottom end of the left-hand moving panel, disengage, if necessary, the two catches with the turngrip levers.

Position the moving left-hand panel with the rollers up and the magnet side towards the left-hand fixed panel.

Fit the first roller (nearest magnet side of moving panel) into the top track roller groove of the fixed panel.

Fit the second roller (near outside edge of moving panel) into the groove and slide the left-hand moving panel into the top track of the left-hand fixed panel.

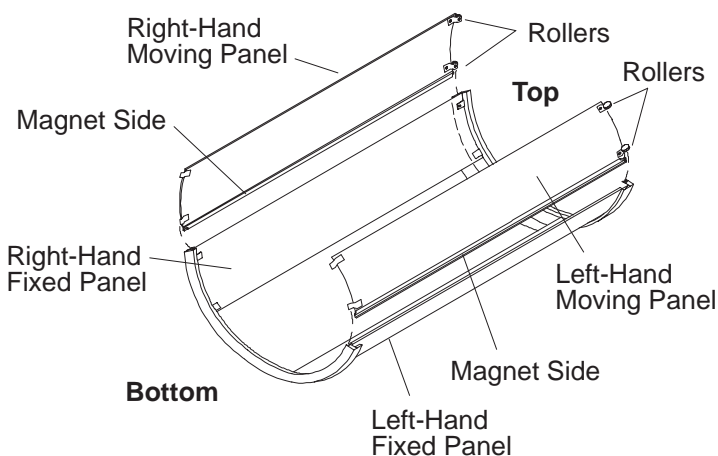

C. INSTALL WALL JAMB / EXPANDER JAMB ASSEMBLY

Position each wall jamb/expander jamb assembly onto the top and bottom tracks.

Align each end of the assemblies with the top and bottom track screwports and fasten with twelve #6-20 x 1" panhead screws but do not tighten.

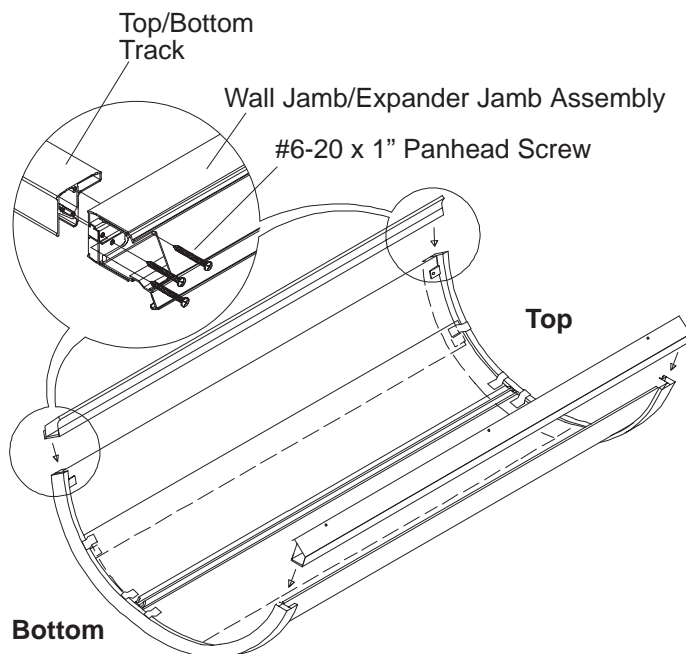

D. ADJUST DOOR ASSEMBLY AND TIGHTEN SCREWS

Measure diagonally across each side of the door assembly and adjust, if necessary, for equal measurements on each side.

Refer to **Install Fixed Panels** on page 2 for location of patch screws.

Tighten the fixed panel patch screws with the hex wrench provided and insert the screw covers over the screw heads. Lift bottom of moving panel and tilt up and away from fixed panel to gain access to lower inside patch screws.

Now tighten the twelve #6-20 x 1" panhead screws that attach the top and bottom tracks to the wall jamb/expander jamb assembly. Refer to Step C.

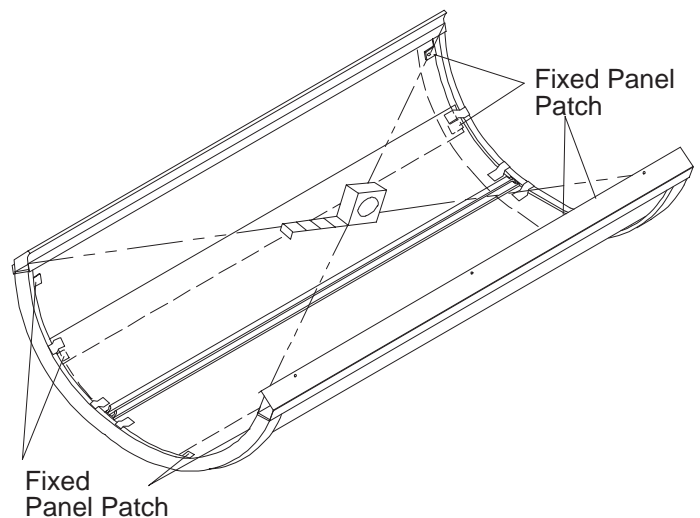

E. ENGAGE CATCHES

Place the catch into the bottom track recess with the catch and turngrip lever disengaged.

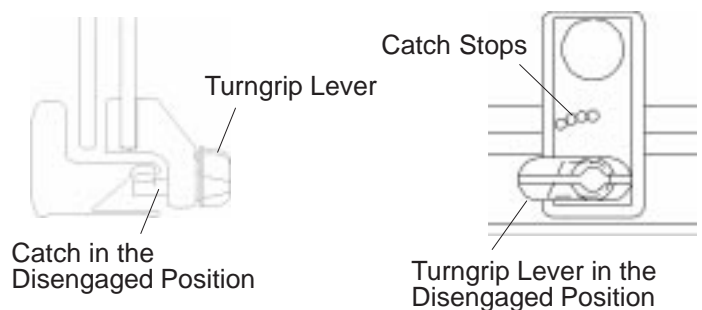

Move the turngrip lever to the position shown at right until the catch stops.



Move the lever back one step as shown to allow for sufficient operating clearance.

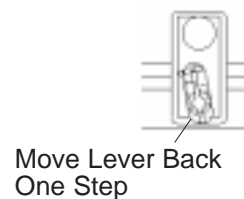

Repeat for the remaining three catches.

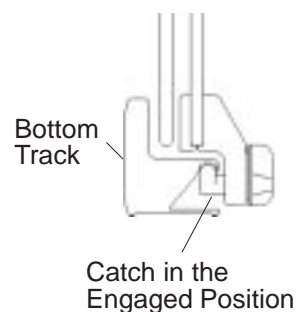

Stand door assembly upright.

F. INSTALL DOOR ENCLOSURE

NOTE: Wear Safety Glasses.

The following steps explain installing wall jambs using hollow wall anchors.

Align door assembly to receptor and place onto the shower floor ledge with the bottom track 3/16" from the edge of the shower floor ledge.

Adjust the expander jambs by turning the two adjustment screws on each side. Turning the screws counterclockwise will increase the width of the assembly; turning the screws clockwise decreases the width of the assembly.

Adjust each expander jamb until both wall jambs touch the wall at the bottom. Adjust top until jambs touch the wall.

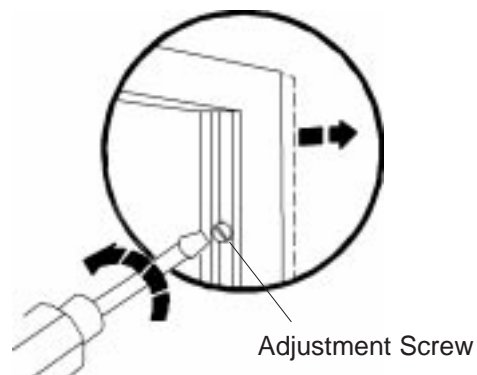

After adjusting, mark the three hole locations through the locator holes in each wall jamb and expander jamb.

Move the door assembly to one side and lightly center punch the three hole locations on the wall. On ceramic tile, use a center punch to nick the surface glaze. Tap the punch lightly with a hammer so as not to crack the tile.

Drill three holes into each wall with a 5/16" drill bit. Use a 5/16" masonry bit for ceramic tile.

After drilling all six holes, thoroughly clean the shower floor ledge and wall. Insert the hollow wall anchors into all six 5/16" drilled holes.

Install the door assembly into opening and align the locator holes with the holes in the wall. Make minor adjustments using the adjustment screws, as necessary.

Secure sides of enclosure at bottom by installing two #8-18 x 1-1/4" panhead screws through each expander jamb and wall jamb into the installed anchors in wall. Repeat, securing the top of the enclosure and lastly the middle.

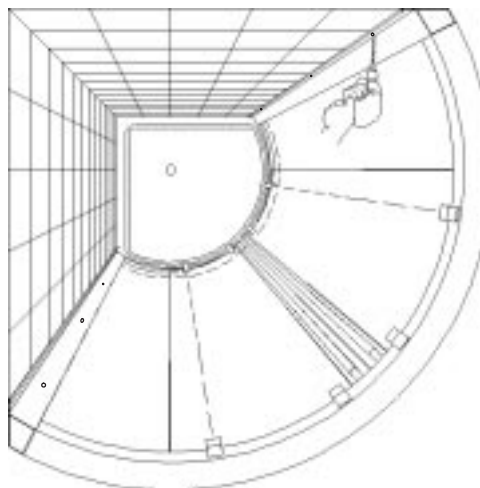

G. FINAL ADJUSTMENT / ATTACH ROLLER PATCH COVERS

If necessary, adjust the moving panels using the top rollers. Disengage catches at the bottom track, refer to **Install Moving Panels** on page 2.

Loosen roller screws and adjust panels by shifting panels and re-positioning until level.

After adjusting panels, tighten roller screws.

Insert the four roller patch covers.

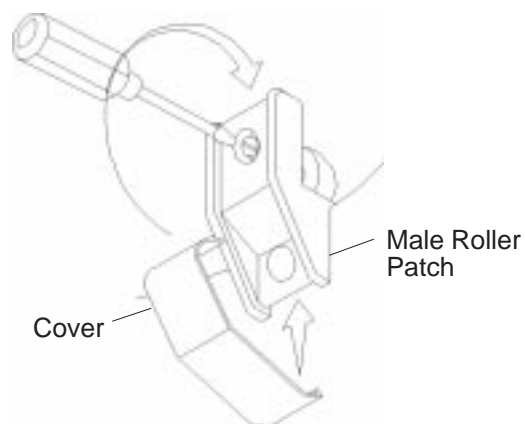

H. INSTALL INTERLOCK BASE AND SEAL

Slide both interlock seals into the interlock bases.

Push an interlock base onto the trailing edge of each moving panel.

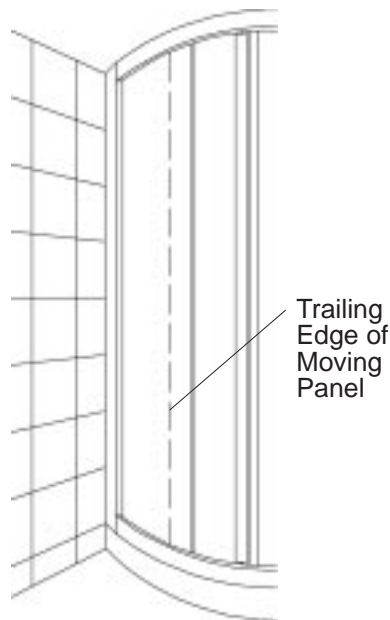

If interference when closing the door is excessive, the interlock seal can be changed to the depth shown.

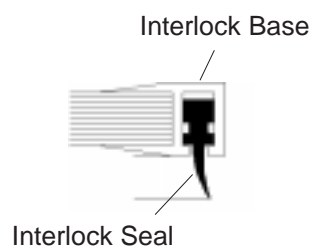

Excessive Interference

If there is not enough interference when closing the door, the interlock seal can be changed to the depth shown.

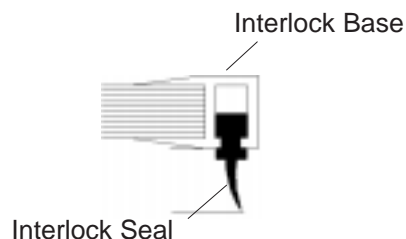

Insufficient Interference

I. INSTALL COVERS AND GASKETS

IMPORTANT: All adjustments should be made to the door before installing the wall jamb cover and the expander jamb cover.

Follow the sequence below to install covers and glazing gasket:

From **inside** the shower, install the wall jamb cover into the wall jamb.

From **outside** the shower, position the glazing gasket where the fixed glass panel is inserted into the expander jamb. Push the gasket into place down the length of the glass panel.

Inside the shower, install the expander jamb cover into the expander jamb with the leg of the cover towards the fixed glass panel.

Repeat the above procedures for the opposite expander jamb.

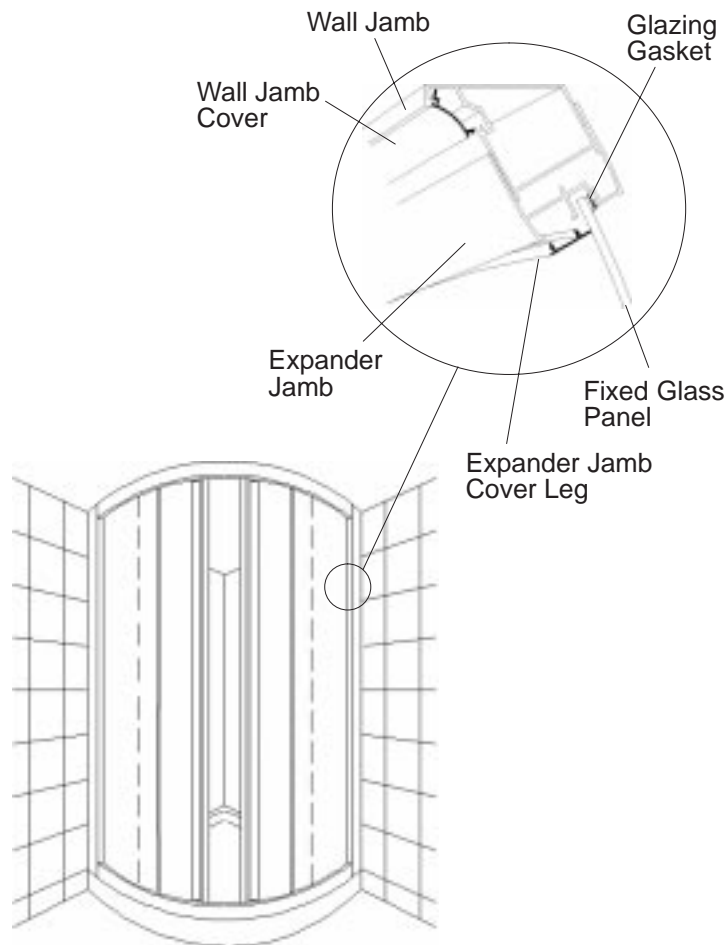

J. SEALING

Thoroughly clean all dust, dirt and grease from the bottom frame and shower ledge surfaces to be sealed. Make sure surfaces are dry.

CAUTION: Apply silicone sealant around the *outside* of the door *only*. Sealant applied to the inside of the door will cause leakage and damage.

Carefully apply a bead of silicone sealant around the outside (dry side) of door where:

- 1) Bottom frame meets the shower ledge.
- 2) Wall jambs meet the shower walls.

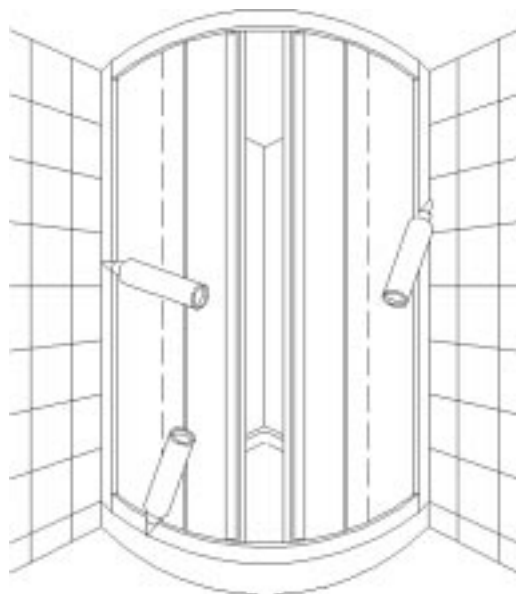

3. EXPLODED PARTS LIST

ITEM	DESCRIPTION	QTY.
1	Top/Bottom Track	2
2	Interlock Seal	2
3	Interlock Base	2
4	Left-Hand Moving Glass Panel	1
5	Right-Hand Moving Glass Panel	1
6	Moving Panel Wheel Patch – Female	8
7	Roller	4
8	Moving Panel Wheel Patch – Male	4
9	#8 Lockwasher	4
10	M4 x 0.7 Machine Screw	4
11	Roller Patch Cover	4
12	M6 x 10 Flat Sockethead Screw	16
13	Frame End Cap	4
14	Handle End Cap	8
15	Handle	4
16	Magnet	2
17	Moving Panel Cam Patch Screw Cover	4
18	Turngrip Lever	4
19	Patch Fitting Body	4
20	Catch	4
21	Expander Jamb Cover	2
22	Fixed Panel Glass Panel	2
23	Glazing Gasket	2
24	Fixed Panel Patch Screw Cover	8
25	Fixed Panel Patch – Male	8
26	Fixed Panel Patch – Female	8
27	#6-20 x 3/8" Philips Flathead Screw	8
28	Expander Jamb Large Spacer Block	4
29	Expander Jamb Small Spacer Block	4
30	#6-20 x 1" Philips Panhead Screw	12
31	Wall Jamb Cover	2
32	Adjustment Screw Retainer	4
33	Adjustment Screw	4
34	Expander Jamb	2
35	Wall Jamb	2
36	#8-18 x 1-1/4" Philips Panhead Screw	6
37	Hollow Wall Anchor	6
	Hex Wrench (not shown)	1
	Silicone Lubricant (not shown)	1

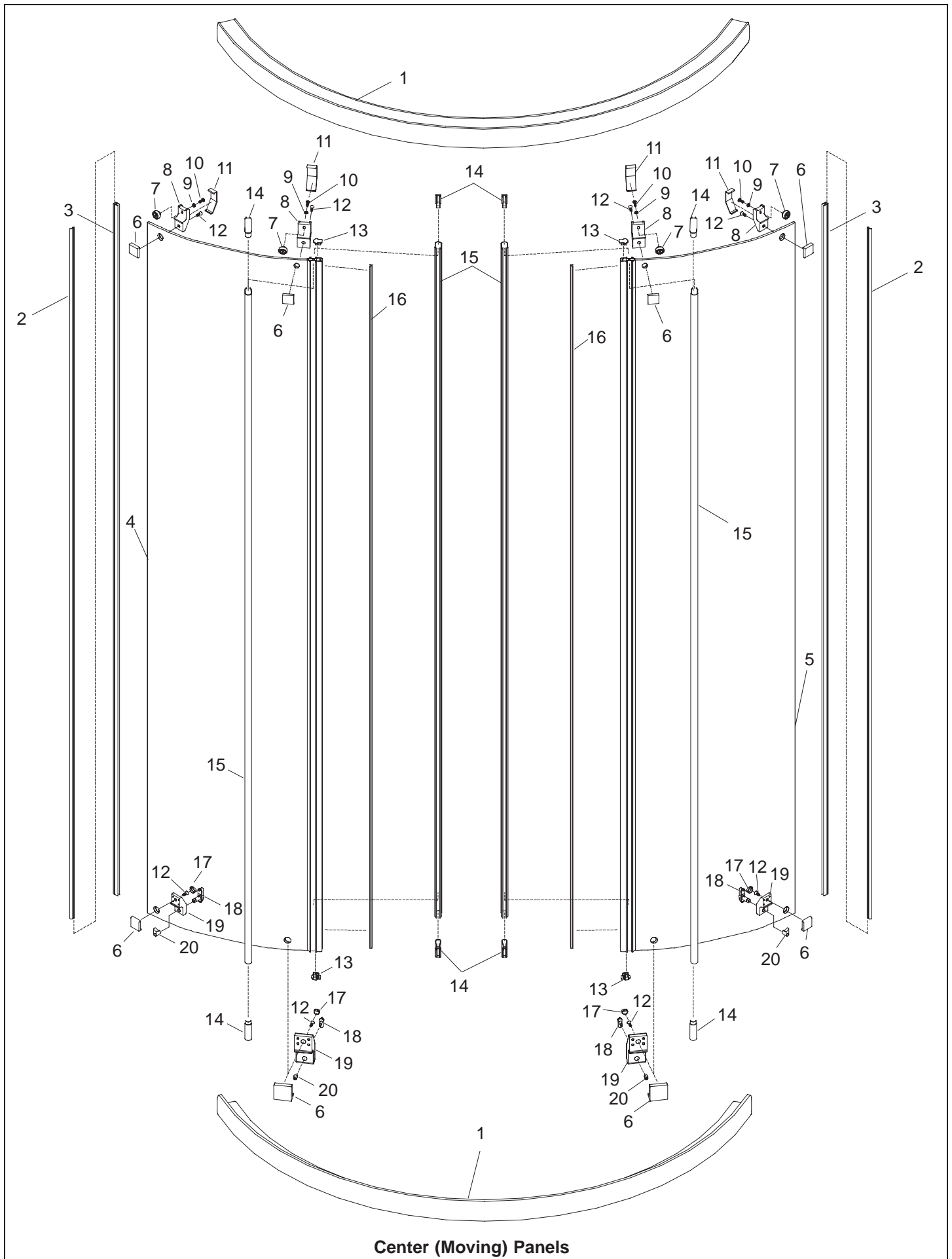

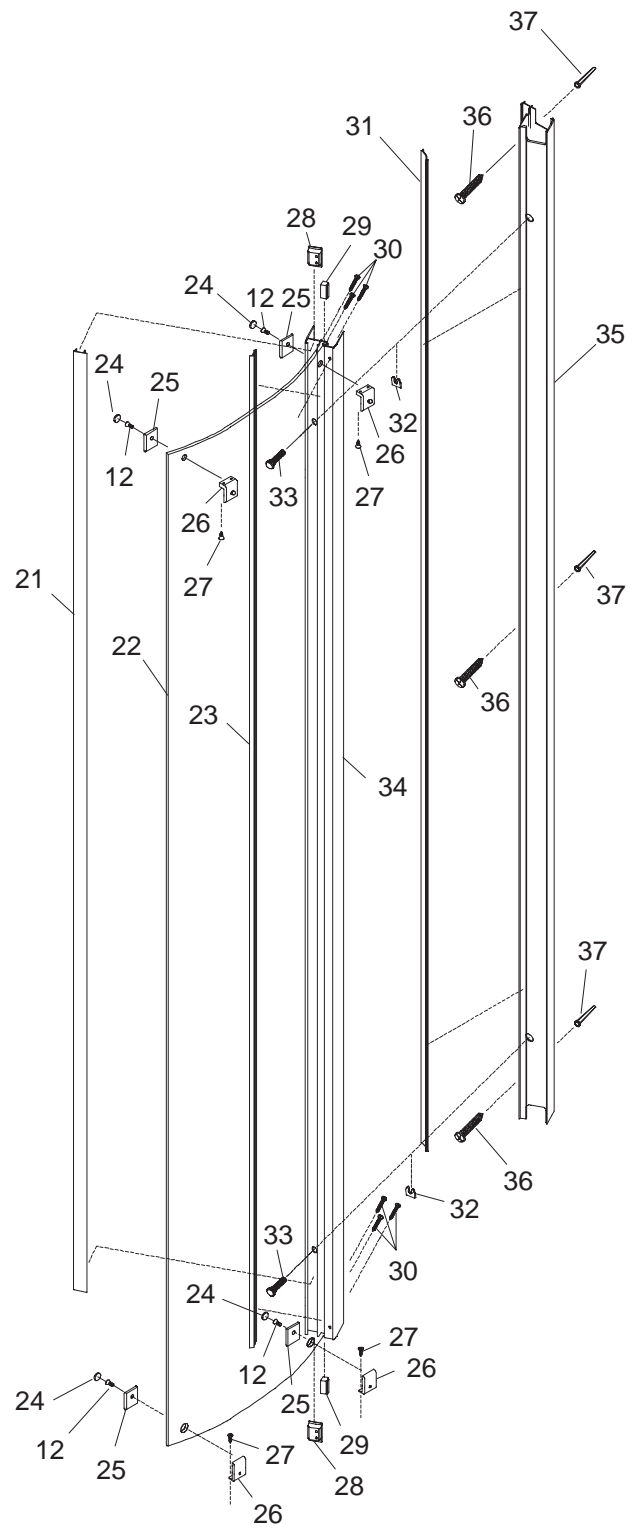
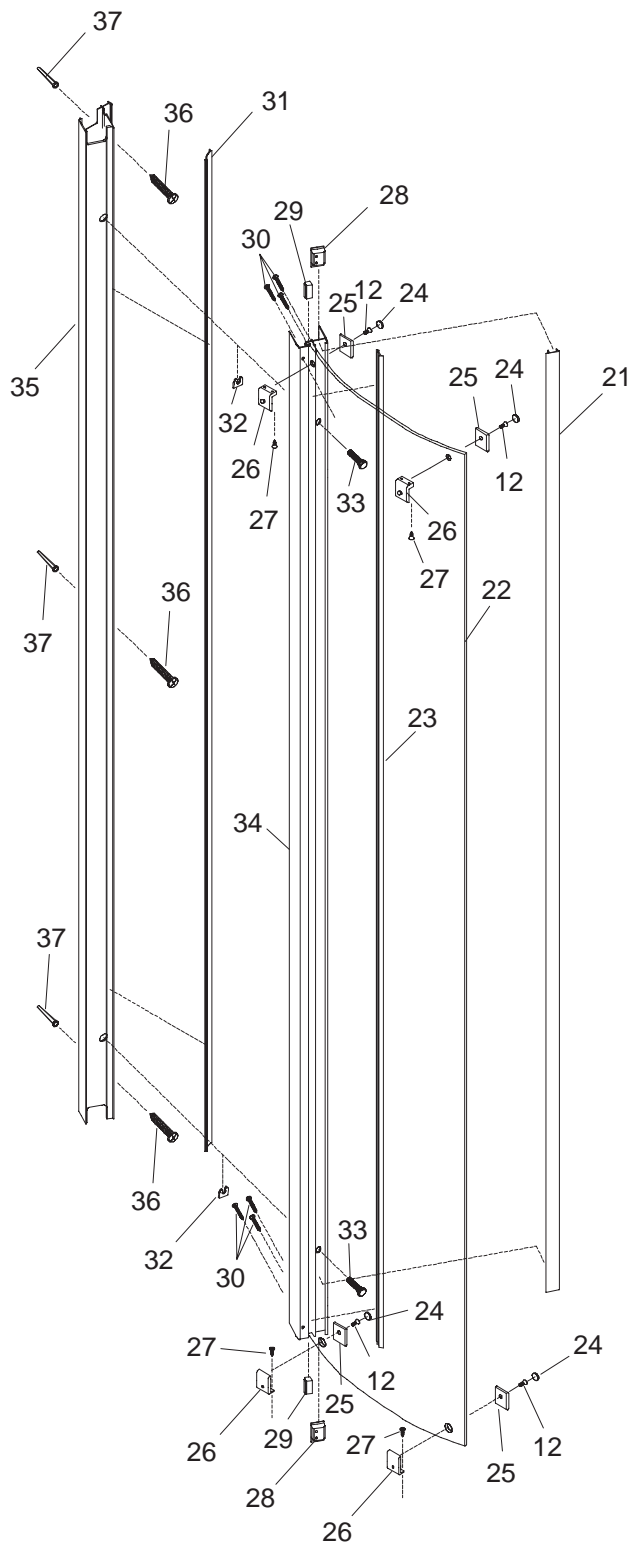

Fixed Panels

4. IMPORTANT CONSUMER INFORMATION

CONSUMER RESPONSIBILITIES

Your Kohler Shower Enclosure will remain beautiful if you take care of it. It is recommended that you replace seals, when they show signs of wear, yellowing, or are not watertight. Refer to the exploded parts page and list for Kohler Service Parts.

Water conditions in various parts of the country will determine any extra cleaning attention you may have to give your new shower enclosure. A simple routine of daily care will keep your shower enclosure looking like new.

Kohler Co. does not recommend the use of harsh abrasive cleansers on any of its products. Harsh cleansers will damage the metal or glass finish on your shower enclosure.

REQUESTING SERVICE

Please take a moment to familiarize yourself with the Kohler Warranty, its benefits, and limitations. Kohler Co. and its distributors support you with one of the largest Service Networks of its type. Here's what you need to do if you require service:

FIRST: Contact the dealer or contractor who sold and installed the product. They should be able to solve any problems you may have.

SECOND: If your dealer or contractor cannot solve the problem, they will contact or supply you with the name of the local Kohler Distributor and the:



KOHLER TECHNICAL SPECIALIST

THIRD: If you are unable to obtain warranty service through either your contractor or Kohler Co. distributor, please write us directly at Kohler Co., Attn.: Customer Service Department, Kohler, WI 53044 U.S.A.

FOURTH: Include all pertinent information regarding your claim, including a complete description of the product, model numbers, colors, finishes, and the date the product was installed. Include a description of the problem, and a photocopy of your invoice for the products involved. Also give us the name of the contractor and distributor.

LIMITED ONE-YEAR WARRANTY

Kohler plumbing fixtures and fittings are warranted free of manufacturing defects.

Kohler Co. will, at its election, repair, replace, or make appropriate adjustment where Kohler Co. inspection discloses any such defects occurring in normal usage within one year after installation. **Kohler Co. is not responsible for installation or removal costs.**

To obtain warranty service, contact Kohler Co. either through your Dealer or Plumbing Contractor, or by writing Kohler Co., Attn: Customer Service Department, 444 Highland Drive, Kohler, WI 53044 USA, or by calling **1-800-4-KOHLER** from within the USA.

Implied warranties, including that of merchantability or fitness for a particular purpose, are expressly limited in duration to the duration of this warranty. Kohler Co. disclaims any liability for special, incidental, or consequential damages.

Some states do not allow limitations on how long an implied warranty lasts or the exclusion or limitation of special, incidental, or consequential damages, so these limitations and exclusions may not apply to you. This warranty gives you specific legal rights. You may also have other rights which vary from state to state.

This limited warranty provides specific legal rights as they apply within the USA, and other rights may be available, but may vary from country to country.

This is our exclusive written warranty.

KOHLER CO., KOHLER, WISCONSIN 53044

