

KOHLER SHOWER ENCLOSURES—QUALITY BY DESIGN™

INSTALLATION MANUAL

K-711200

FOCAL™

***custom
pivot
shower
enclosures***

Min. Width-23"

Max. Width-36"

Min. Height-50"

Max. Height-72"

THE BOLD LOOK
OF **KOHLER®**

INTRODUCTION

Please read these instructions carefully to familiarize yourself with the required tools, materials, and installation sequences. The Exploded Diagram of the Door on page 3 will also provide a helpful reference when relating the location of the various parts.

All information in these instructions is based on the latest product information available at the time of publication. Kohler Co. reserves the right to make changes in product characteristics, packaging, or availability at any time without notice.

IMPORTANT CONSUMER INFORMATION

LIMITED ONE-YEAR WARRANTY

Kohler plumbing fixtures and fittings are warranted free of manufacturing defects.

Kohler Co. will, at its election, repair, replace, or make appropriate adjustment where Kohler Co. inspection discloses any such defects occurring in normal usage within one year after installation. **Kohler Co. is not responsible for installation costs.**

To obtain warranty service, contact Kohler Co. either through your Dealer or Plumbing Contractor or by writing Kohler Co., Att: Consumer Affairs Department, Kohler, WI 53044 U.S.A.

IMPLIED WARRANTIES INCLUDING THAT OF MERCHANTABILITY, ARE EXPRESSLY LIMITED IN DURATION TO THE DURATION OF THIS WARRANTY. KOHLER CO. DISCLAIMS ANY RESPONSIBILITY FOR CONSEQUENTIAL DAMAGES.

Some states do not allow limitations on how long an implied warranty lasts, or the exclusion or limitation of incidental or consequential damages, so this limitation and exclusion may not apply to you. This warranty gives you specific legal rights. You may also have rights which vary from state to state.

This is our exclusive written warranty.

KOHLER CO., KOHLER, WISCONSIN 53044

BASIC TOOLS AND MATERIALS NEEDED

TOOLS

6 foot folding rule or measuring tape
Hacksaw with 32 teeth per inch blade
Miter box or square
Hammer
Electric drill
Drill bit- $\frac{5}{16}$ "
Masonry bit for ceramic tile- $\frac{5}{16}$ "
Fine file
Screwdriver-Phillips
Level
Pencil
Safety glasses
Caulking gun
Knife

MATERIALS

Masking Tape
Silicone Sealant (RTV)

HOW TO CARE FOR YOUR DOOR

NEVER USE SCOURING POWDER, PADS OR SHARP INSTRUMENTS ON METAL WORK OR GLASS PANELS.

The use of a squeegee following each shower is recommended to eliminate water spots on the inside of the glass panels.

An occasional wiping down with a mild detergent diluted in water is all that is needed to keep the panels and anodized aluminum parts looking new.

CAUTION: TEMPERED GLASS CANNOT BE CUT.

PART NAMES FOR INSTALLATION

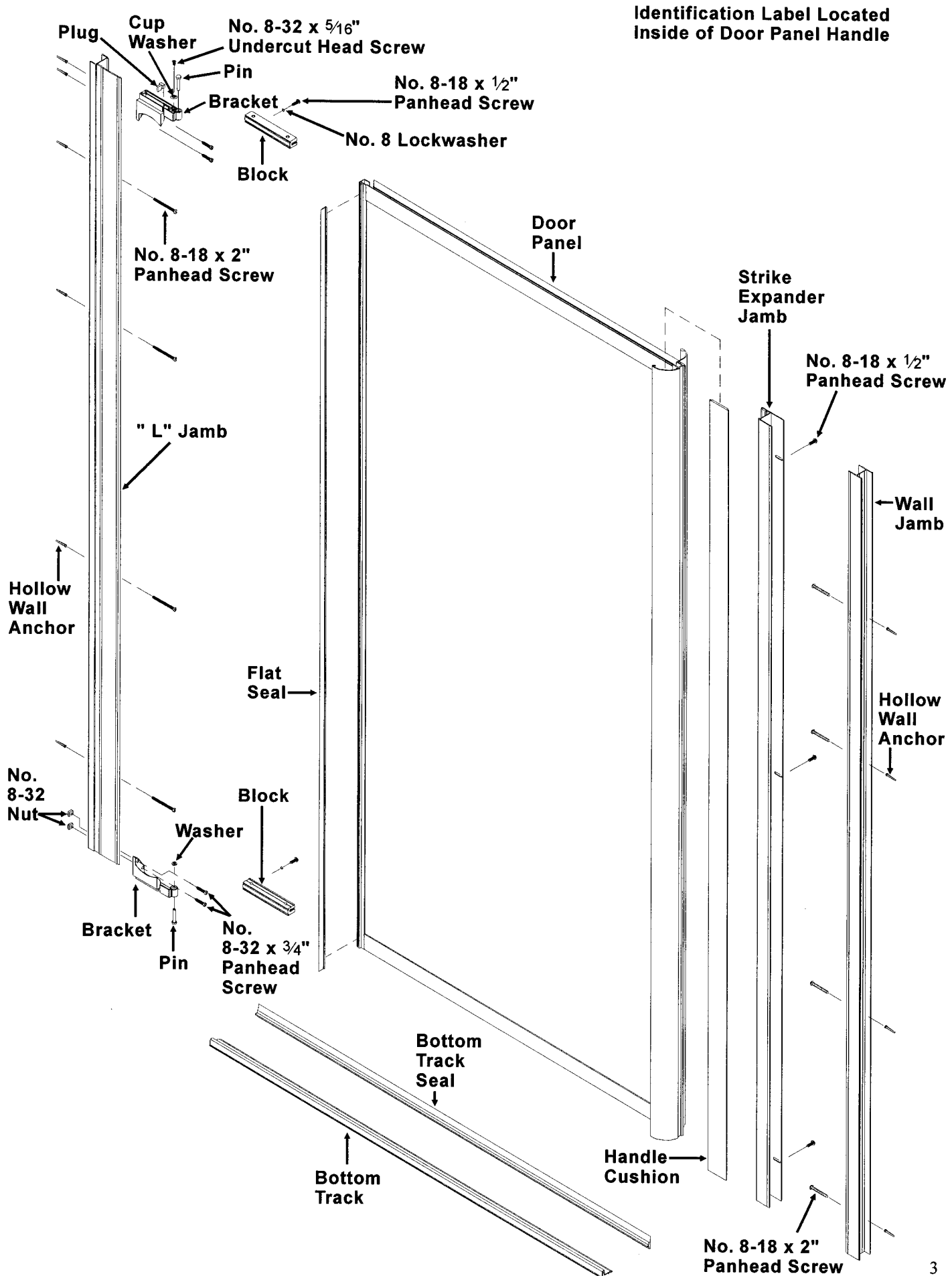

1 MEASURING AND CUTTING BOTTOM TRACK

NOTE: WEAR SAFETY GLASSES.

- A. **Note: If your stall has a curve in the corners at the side walls, be sure to measure distance D above the curves and cut bottom track $2\frac{1}{8}$ " shorter than distance D.**
- B. Measure distance D from wall to wall as shown and cut the bottom track $2\frac{1}{8}$ " shorter than distance D. For best results use a 32-tooth per inch hacksaw blade and miter box. File rough edges.

CAUTION: If a steel tape is used, be sure to add the width of the case to the measurement.

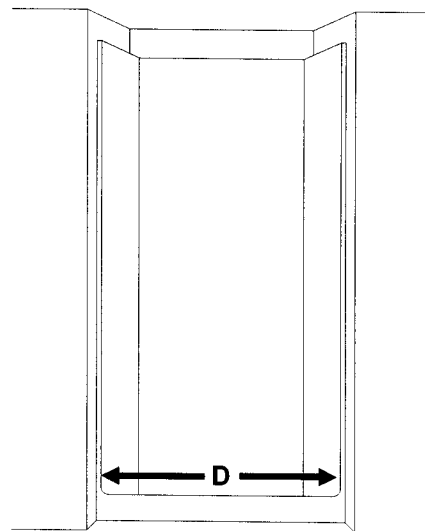

2 DETERMINING DIRECTION OF SWING

- A. Determine whether the door will swing toward the right or left. Check that there are no obstacles in the door path as it swings open.
- B. It is recommended that the swing side of the door be installed on the opposite side from the showerhead. Be sure there are no obstructions.

All of the following illustrations are for door that swings open toward the left. Door that swings open toward right would be opposite.

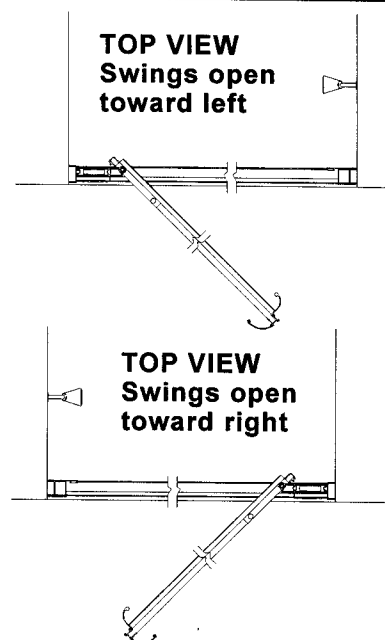

3 PLACING BOTTOM TRACK ON SHOWER LEDGE

NOTE: Locate bottom track on flattest part of ledge.

- A. Place the bottom track on the ledge with one end of bottom track $\frac{9}{16}$ " from the wall that is opposite the showerhead. Make sure the distance from the outer edge of the shower ledge to front edge of the bottom track is the same measurement on both ends.
- B. Temporarily secure the bottom track with masking tape and mark the shower ledge with a soft pencil.

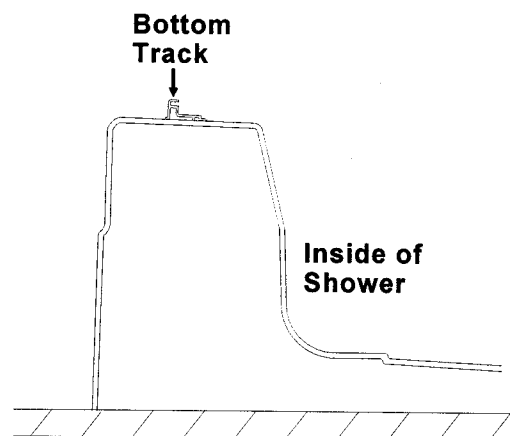

4 LOCATING "L" JAMB AGAINST WALL, MARKING HOLE LOCATION AND DRILLING HOLES

- A. Place the "L" Jamb down over the bottom track and against the wall opposite the showerhead. Be sure the end of bottom track is against the "L" Jamb.

NOTE: The "L" Jamb must sit flat against the wall with the legs of "L" Jamb fully engaged with bottom track. If the jamb is not fully engaged with the bottom track, use a file to shape the bottom end of jamb to fit the curve at side wall of shower.

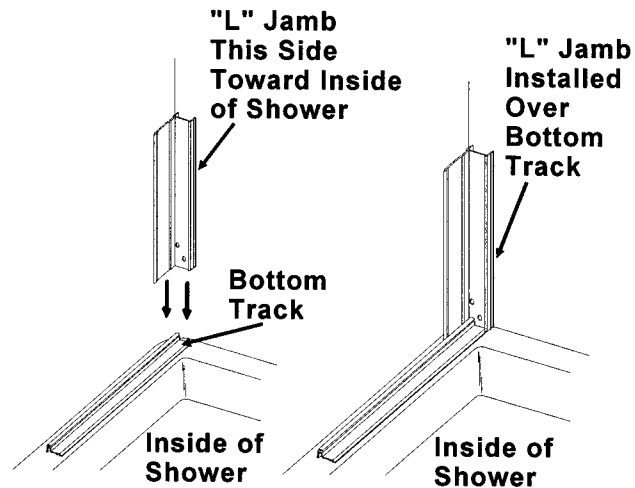

- B. Use a level to plumb the "L" Jamb as shown and mark the 6 hole locations. *Do not mark the 2 bottom holes. These holes are used to install bottom bracket in step 6.*
- C. Remove the "L" Jamb and bottom track.
- D. Lightly center punch the 6 hole locations. On ceramic tile, use the center punch to nick the surface glaze. Tap the punch lightly with your hammer so you don't crack the tile.
- E. Drill all 6 holes with a $\frac{5}{16}$ " drill bit. (Use a masonry bit for ceramic tile).
- F. After drilling, thoroughly clean shower ledge.

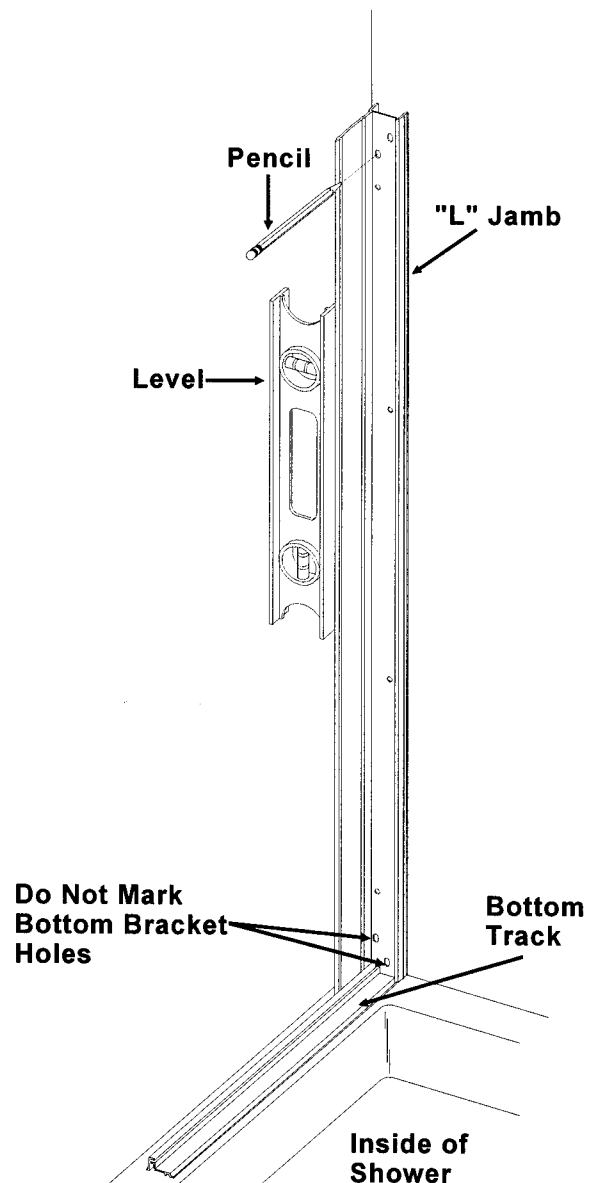

5 SEALING AND INSTALLING BOTTOM TRACK

- A. Apply a bead of sealant on the underside of bottom track as shown.
- B. Install the bottom track at location marked on the shower ledge and use masking tape to hold the bottom track in place.

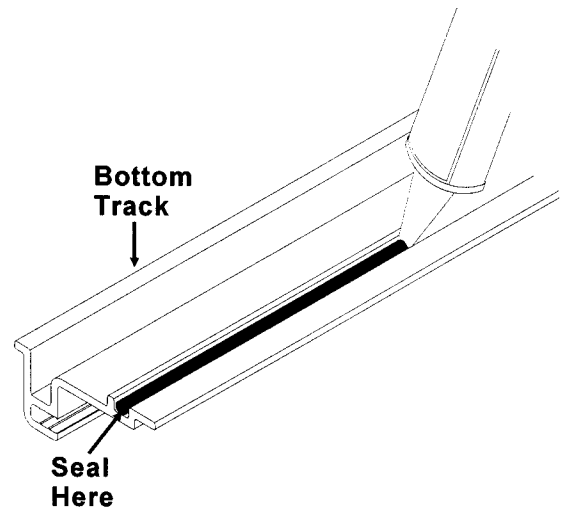

6 INSTALLING BOTTOM BRACKET

- A. At the bottom end of the "L" Jamb, position a bracket against the Jamb and align the holes in bracket with the holes in "L" Jamb.
- B. Secure with 2 No. 8-32 x $\frac{3}{4}$ " panhead screws and No. 8-32 square nuts. Use pliers to hold square nuts as screws are tightened.

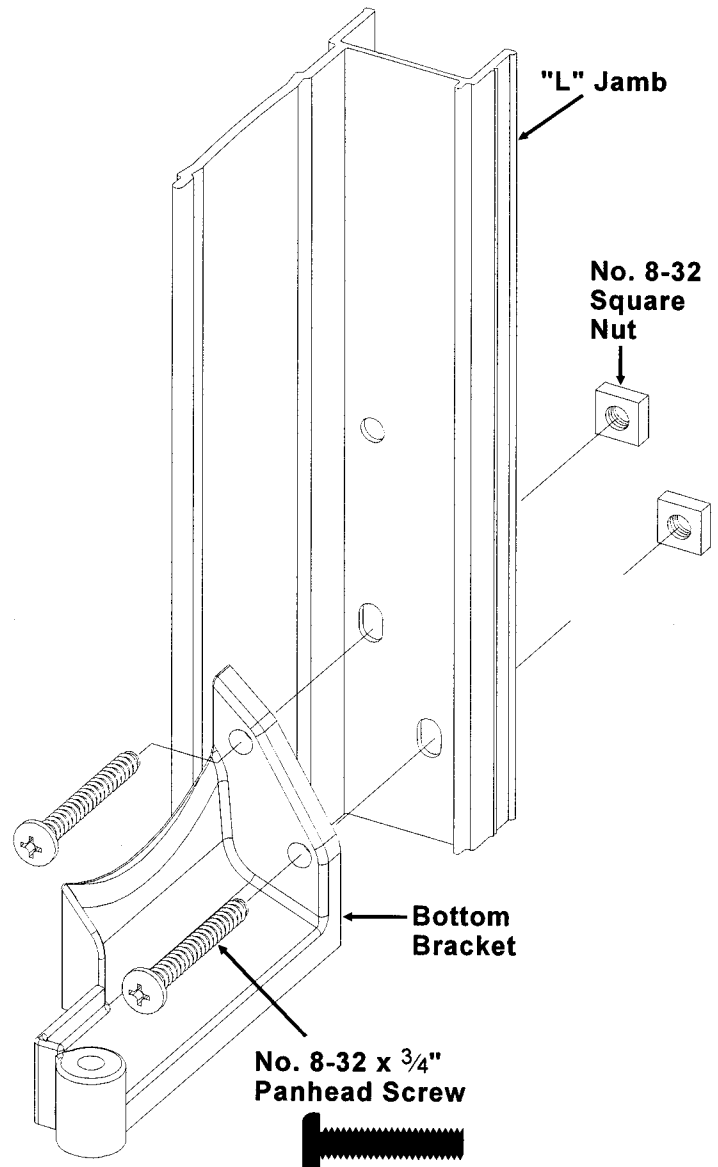

7 INSTALLING "L" JAMB

Use the following steps to install "L" Jamb using **TOGGLER® BRAND** hollow wall anchors.



**No. 8-18 x 2"
Panhead Screw**

- A. Insert the **TOGGLER® BRAND** hollow wall anchors into all six $\frac{5}{16}$ " holes drilled in step 3.
- B. Insert a pivot pin through the hole in bottom bracket with the head of pin toward the bottom track. Place the bushing down over the pin as shown.
- C. Holding the pin in place, install the "L" Jamb down over the bottom track and align the holes in the "L" Jamb with the holes in wall.
- D. Through the 4 holes below the top bracket holes, secure the "L" Jamb to wall with 4 No. 8-18 x 2" panhead screws.
- E. Place a bracket at top of "L" Jamb and align the holes in bracket with the holes in "L" Jamb. Secure with 2 No. 8-18 x 2" panhead screws.
- F. Add sealant to the top bracket plug and insert the plug into the top bracket as shown.

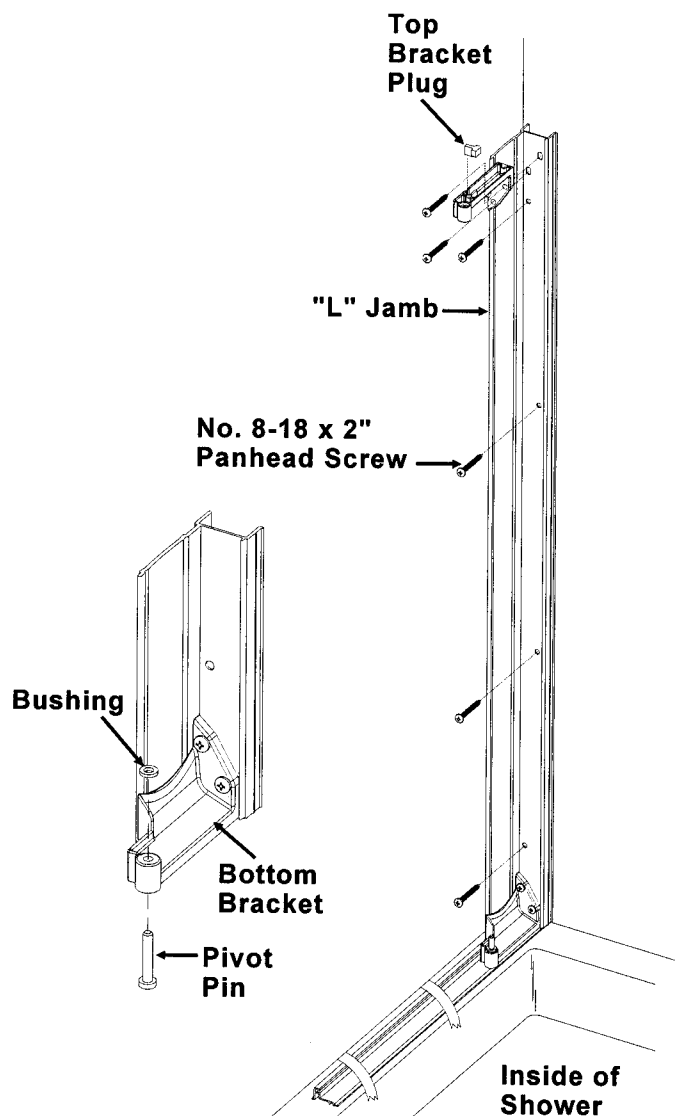

How to use **TOGGLER® BRAND** Hollow Wall Anchors

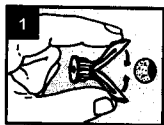

1. Drill $\frac{5}{16}$ " (8mm \varnothing) hole.

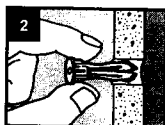

2. Fold anchor, insert in hole, and tap flush with wall.

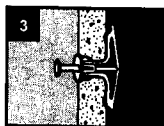

3. Insert key to pop anchor open behind wall (except in thick or solid walls). Do not hammer key. Remove key.

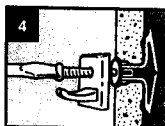

4. Place item over anchor. Insert screw and tighten.

Patented under one or more of the following US Patent Nos.: 4,075,924; 4,174,910; 4,181,061; 4,221,154; 4,294,156; 4,650,386; 4,673,150; 4,752,170; 4,878,790; 4,993,901; 5,028,186; and foreign counterparts thereof. Other patents pending. TOGGLER and typeface Alligator, TA, TB, TC, TH, anchor shape and symbol are registered trademarks of MPC. © 1991 MPC.

8 INSTALLING STRIKE SIDE WALL JAMB

Note: Shorter legs of wall jamb against wall with flange holes toward the inside of shower.

- A. Place the strike side wall jamb against opposite wall *directly across* from the "L" Jamb with the bottom of jamb resting on the shower ledge.
- NOTE:** The Wall Jamb must sit flat against the wall with the bottom end of Wall Jamb sitting flat on the shower ledge. If the jamb is not sitting flat on the shower ledge, use a file to shape the bottom end of jamb to fit the curve.
- B. Use a level to plumb the wall jamb as shown and mark the 4 hole locations.
 - C. Remove the wall jamb.
 - D. Lightly center punch the 4 hole locations. On ceramic tile, use the center punch to nick the surface glaze. Tap the punch lightly with your hammer so you don't crack the tile.

Use the following steps to install Strike Side Wall Jamb using **TOGGLER® BRAND** hollow wall anchors.

- E. Drill all 4 holes with a $\frac{5}{16}$ " drill bit. (Use a masonry bit for ceramic tile).
- F. After drilling, thoroughly clean shower ledge.
- G. Insert the **TOGGLER® BRAND** hollow wall anchors into all four $\frac{5}{16}$ " drilled holes.
- H. Place the strike side wall jamb against wall and align the holes in jamb with the holes drilled in wall.
- I. Secure the wall jamb with 4 No. 8-18 x 2" panhead screws and remove masking tape from bottom track.

How to use TOGGLER® BRAND Hollow Wall Anchors

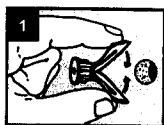

1. Drill $\frac{5}{16}$ " (8mm \varnothing) hole.

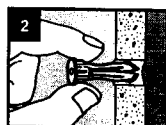

2. Fold anchor, insert in hole, and tap flush with wall.

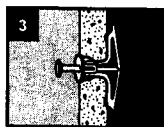

3. Insert key to pop anchor open behind wall (except in thick or solid walls). Do not hammer key. Remove key.

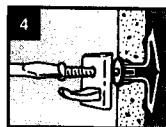

4. Place item over anchor. Insert screw and tighten.

Patented under one or more of the following US Patent Nos.: 4,075,924; 4,174,910; 4,181,061; 4,221,154; 4,294,156; 4,650,386; 4,673,150; 4,752,170; 4,878,790; 4,993,901; 5,028,186; and foreign counterparts thereof. Other patents pending. TOGGLER and typeface Alligator, TA, TB, TC, TH, anchor shape and symbol are registered trademarks of MPC. © 1991 MPC.

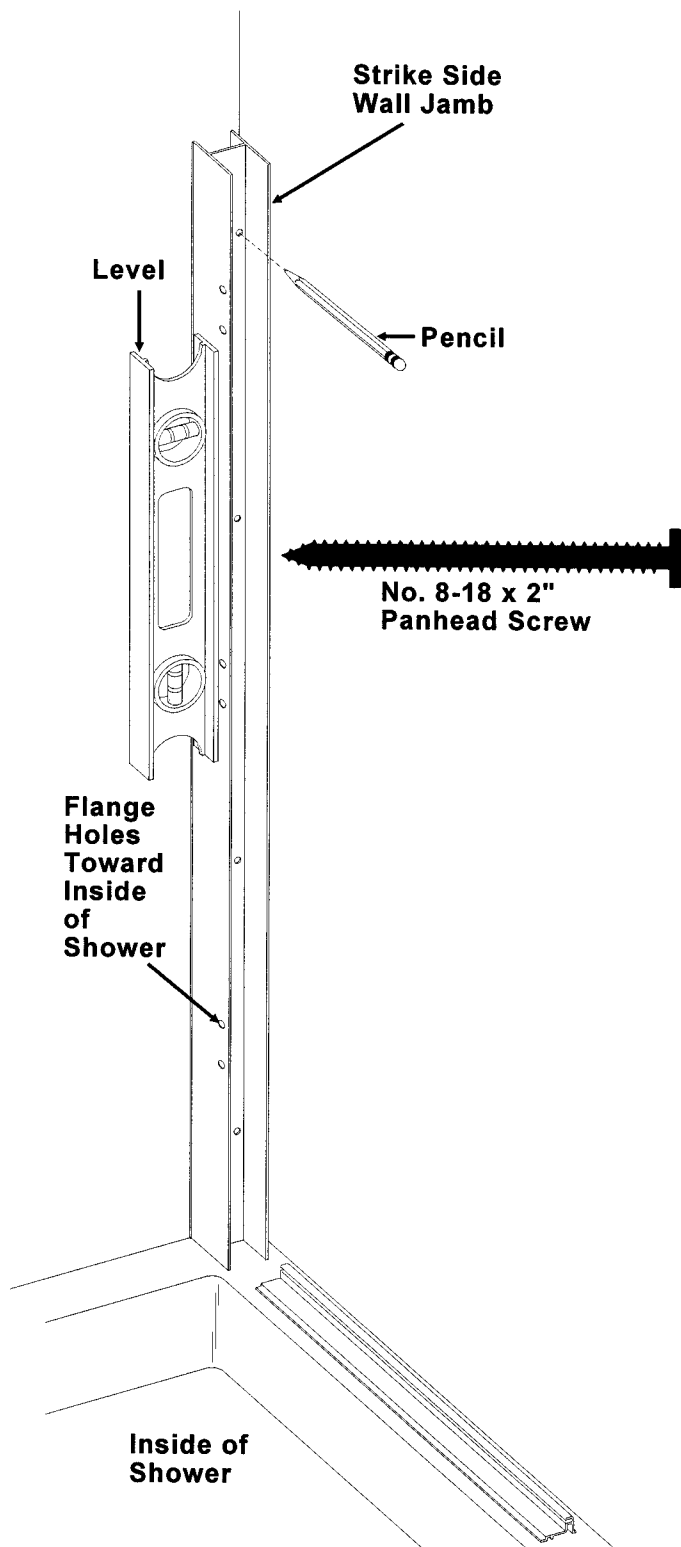

9 INSTALLING STRIKE EXPANDER JAMB ASSEMBLY

- A. Place the strike expander jamb assembly over the wall jamb with the bottom end of the jamb resting on the bottom track. *The legs of the expander jamb must be fully engaged with the bottom track.*
- B. Adjust the bottom end of the expander jamb against the end of the bottom track. Use a level to plumb the strike expander jamb assembly as shown.
- C. Secure the strike expander jamb assembly to the wall jamb with 3 No. 8-18 x 1/2" panhead screws.

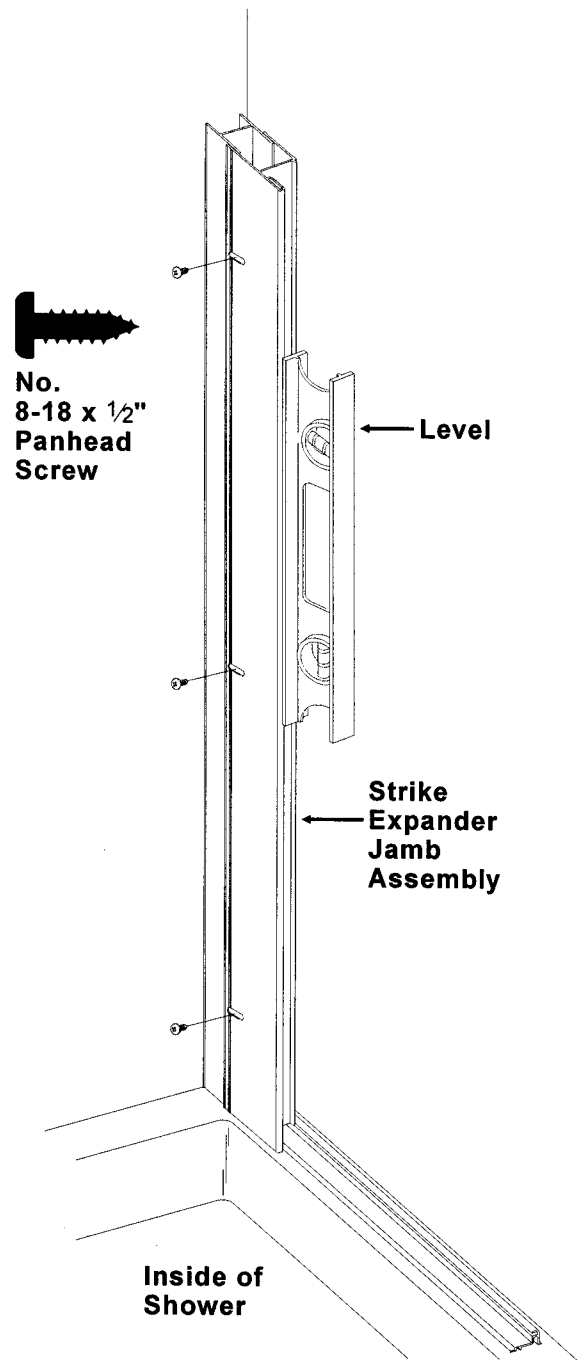

10 INSTALLING CUSHION INTO DOOR PANEL HANDLE SIDE FRAME

- A. Fit the door handle cushion into the groove on one side along the length of the door handle side frame as shown.
- B. Push the door handle cushion into the other groove along the length of the door handle frame and trim excess cushion with a knife or scissors.

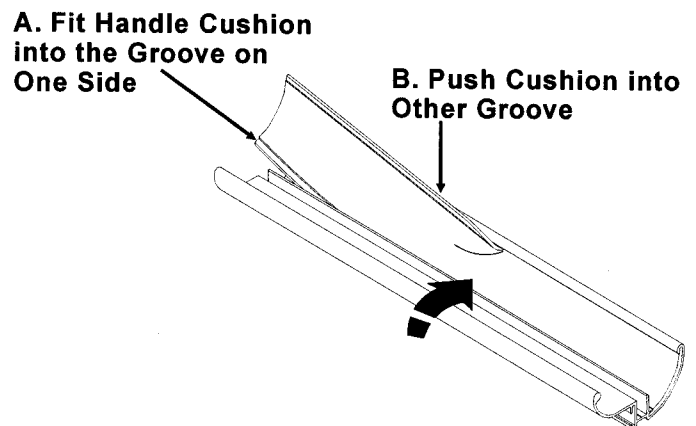

11 INSTALLING BOTTOM TRACK SEAL

A. Measure from the front edge of the strike expander jamb to the edge of bottom bracket as shown.

B. Cut the seal distance measured.

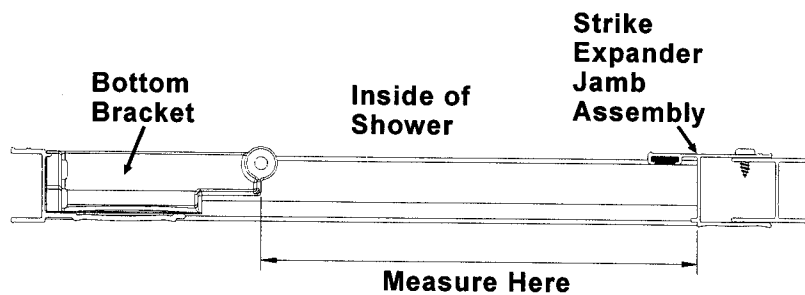

C. Push the seal into the bottom track as shown.

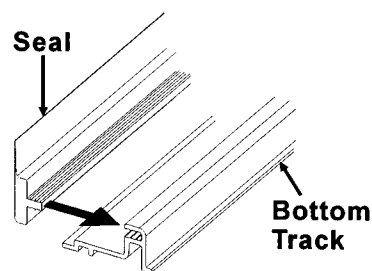

D. Trim the seal leg to fit around the strike expander jamb magnet.

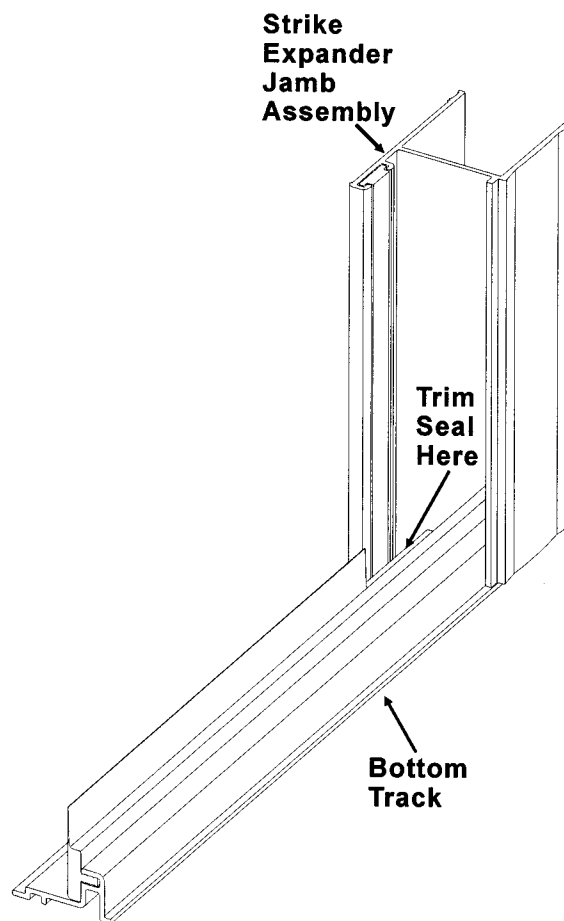

12 LOCATING BLOCKS

- A. Measure distance between bracket pin **at bottom** and the edge of strike expander jamb as shown.
- B. Slide the block in the **top frame** of the door panel toward the pivot side frame.

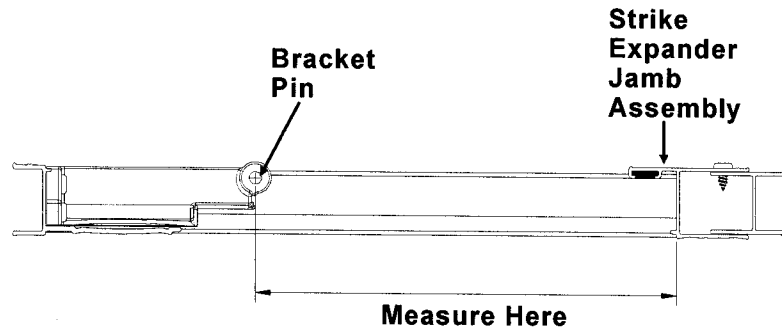

- C. Measure from the edge of door handle to the center of the farthest pin hole in block and locate the block $\frac{1}{4}$ " less than measurement from A.

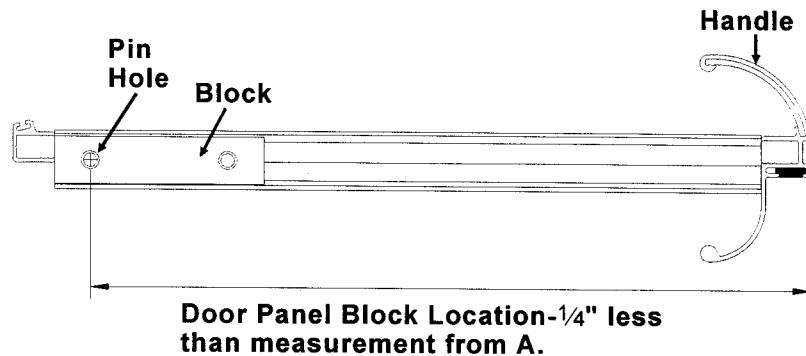

- D. Insert a No. 8-18 x $\frac{1}{2}$ " panhead screw with a No. 8 lockwasher through frame slot of the door panel top frame and into block screwport.
- E. Fasten the screw into block screwport.
- F. Use same procedures to locate the block in the door panel bottom frame.

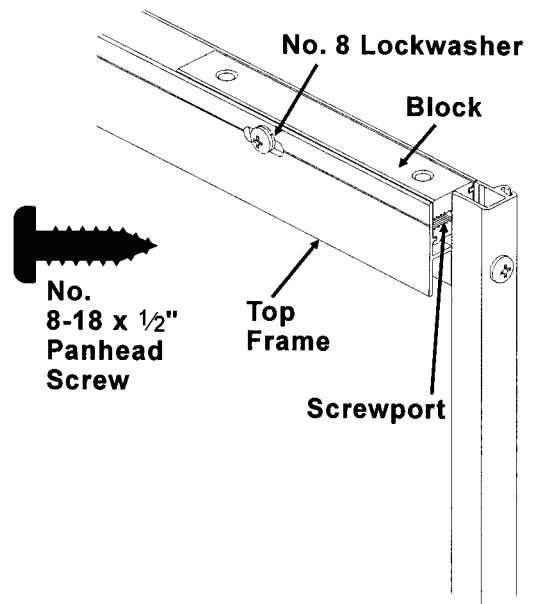

13 INSTALLING DOOR PANEL

- A. Insert a pivot pin into the top bracket hole.
- B. Lift the door panel and position door handle magnet toward strike jamb magnet.
- C. From inside shower, place door panel bottom block's farthest hole from door handle down over bottom bracket pin. **Be sure** not to place side frame of door panel down over pin.
- D. Pull top bracket pivot pin up and align the top block's farthest hole from door handle with the top bracket hole and insert pin through bracket hole and into the block hole.
- F. Loosen the block screws and slowly close door panel and slide blocks in top and bottom frames so that door closes with approximately $\frac{3}{16}$ " clearance from edge of strike jamb. Make sure that the bottom of door panel does not rub on the bottom track seal.
- G. Tighten the block screws.
- H. For final adjustment, loosen the strike expander jamb screws.
- I. Align the strike expander jamb with the door panel handle frame with a $\frac{3}{16}$ " gap at top and bottom of the door panel.
- J. Tighten the strike expander jamb screws.

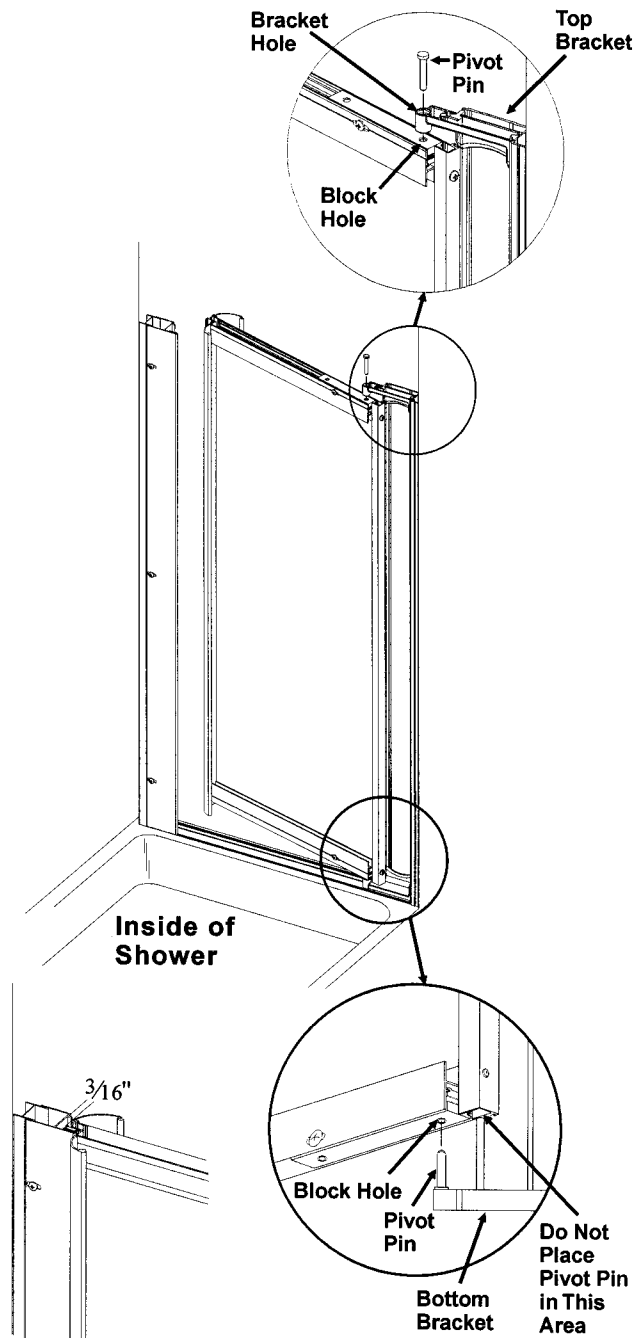

14 INSTALLING WASHER AND SCREW

NOTE: It is necessary to install the No. 8 cup washer and the No.8-32 x $\frac{5}{16}$ " undercut head screw to prevent the top pivot pin from moving upward out of the pivot block.

- A. Place the No. 8 cup washer over the hole in the top bracket.
- B. Insert the No.8-32 x $\frac{5}{16}$ " undercut head screw through the washer into the hole in the bracket and tighten.

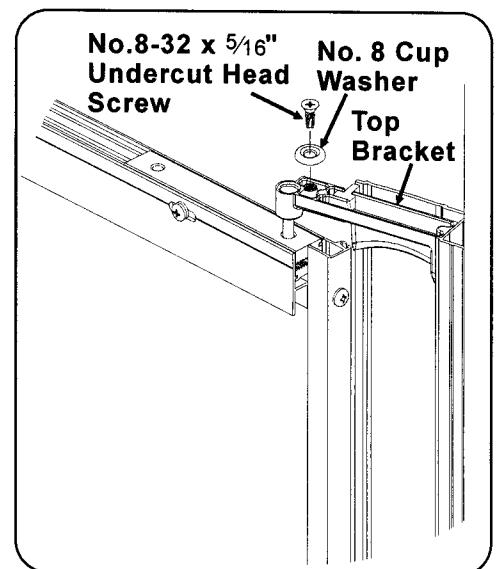

15 INSTALLING FLAT SEAL INTO DOOR PANEL PIVOT SIDE FRAME

- A. From inside the shower and with the door panel open, slide the flat seal into the "T" shaped slot of door panel pivot side frame. Pull the seal down until it is even with the bottom of door panel.
- B. Cut off excess flat seal from the top of door.
- C. With a pair of pliers, squeeze the edge of the "T" shaped slot at the top of door panel to hold the flat seal in place.

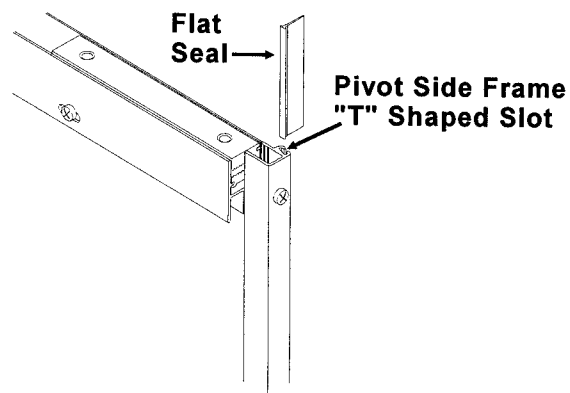

16 SEALING

- A. Carefully seal where the jambs and wall meet (1), bottom track and shower ledge join (2).
- B. Seal at the bottom of the door handle as shown.
- C. Seal the bottom bracket as shown.

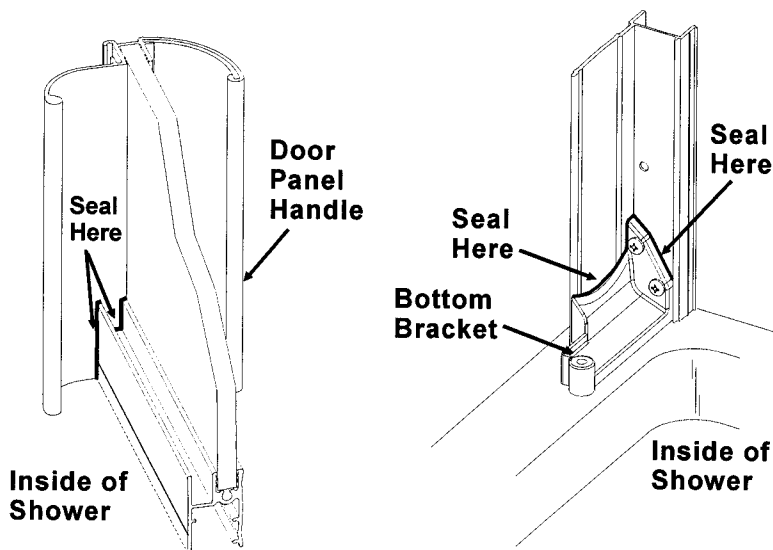
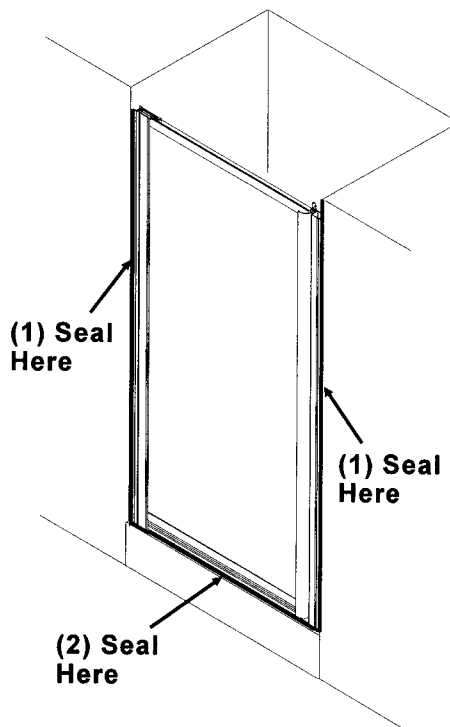

PARTS LIST

When ordering parts, specify model number, part number, quantity and color.

Identification Label Located
Inside of Door Panel Handle

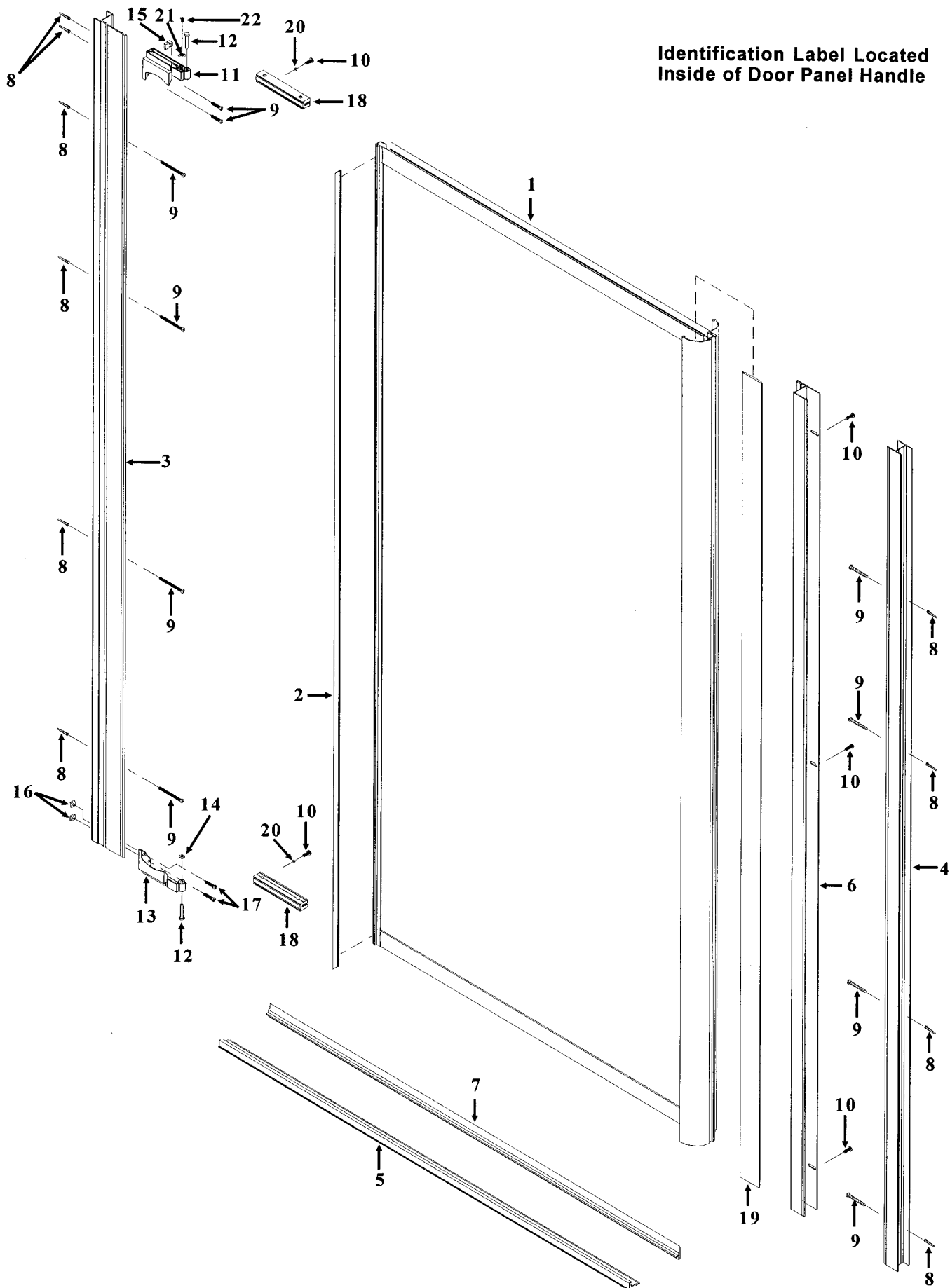

PARTS LIST

When ordering parts, specify model number, part number, quantity and color.

Key No.	Description	Qty.
1	Door Panel Assembly	1
2	Flat Seal	1
3	"L" Jamb	1
4	Wall Jamb	1
5	Bottom Track	1
6	Strike Jamb Assembly	1
7	Bottom Track Seal	1
8	Hollow Wall Anchor	10
9	No. 8 -18 x 2" Panhead Screw	10
10	No. 8 -18 x 1/2" Panhead Screw	5
11	Bracket*	1
12	Pin	2
13	Bracket*	1
14	Washer	1
15	Plug	1
16	No. 8-32 Nut	2
17	No. 8-32 x 3/4" Panhead Screw	2
18	Block (Factory Installed)	2
19	Handle Cushion	1
20	No. 8 Lockwasher	2
21	No. 8 Cup Washer	1
22	No. 8-32 x 5/16" Undercut Head Screw	1

***Bracket Numbers Molded on Part**

KOHLER®

KOHLER CO. KOHLER, WISCONSIN 53044